

Operation Manual

Model 491

100 & 110 Gallon Preservative Applicator



P.O. Box 63 • 2821 Harvey Street • Hudson, WI 54016
800-635-7468 • www.harvesttec.com

(intentionally blank)

Harvest Tec Model 491 Operation Table of Contents

	<u>Page</u>
Introduction	4
Installation Kit Reference Chart	4-5
Safety	5
Safety Decals	6
Safety Location	7
Preparing the applicator for operation	8
Filling the tank	8
Operation of the main ball valve	8
Connecting the power harness	9
Operation of the control	9
Understanding and using the control	9
Message light	9
First time and annual start up	10
Field operation	10
Calibration	10
Determining tons per hour for large square balers	10
Determining the rate of chemical	11
Selecting tips and setting pressure	11
General calibration chart for two nozzles	12
Maintenance	13-14
Maintenance schedule	13
Filter bowl cleaning	13
Miscellaneous maintenance	13
Tip & tip screen cleaning	14
Tank lid cleaning	14
Dielectric grease connections	14
Rebuilding pump	14
Battery connection	14
Winter storage	14
Troubleshooting	15
Parts breakdown	16-45
Tank, Saddle & Legs	16-18
Vermeer, Claas & Krone Balers	16
CNH, AGCO, Krone, John Deere L330 / L340 balers	17-18
Control Box, Wiring Harnesses, Gauge, Pump Assembly	19
Installation Kits	20-45
4438 Installation Kit	20
4439 Installation Kit	21
4490 Installation Kit	22
4491 Installation Kit	23
4492 Installation Kit	24
4494 Installation Kit	25
4495 & 4528 Installation Kit	26
4497 & 4529 Installation Kit	27
4498 Installation Kit	28
4499 Installation Kit	29
4500 Installation Kit	30
4501 Installation Kit	31
4509 Installation Kit	32
4510 Installation Kit	33
4511 Installation Kit	34
4514 Installation Kit	35
4515 Installation Kit	36

Table of Contents (continued)	Page
4518 Installation Kit	37
4519 Installation Kit	38
4525 Installation Kit	39
4525J Installation Kit	40
4527 Installation Kit	41
4530 Installation Kit	42
4539 Installation Kit	43
4540 Installation Kit	44
4541 Installation Kit	45
4542 Installation Kit	46
Warranty Statement	47

Introduction

Thank you and Congratulations on purchasing a Harvest Tec Model 491 Applicator. This applicator is designed to apply a buffered propionic acid on to the forage crop as it is being baled. The applicator is designed to allow the operator to adjust the rate of preservative on the go for changing moisture and baler throughput. This manual will take you through the steps of operation of the applicator and also point out all safety precautions that need to be made while using the applicator. Read this manual carefully to learn how to operate the equipment correctly. Failure to do this can result in personal injury or equipment malfunction. If you are unsure about operating the system after consulting this manual, contact your local authorized dealership for additional assistance. If you are in need of parts for the system please see the parts breakdown in the back of this manual and contact your local authorized dealer to order the parts. This applicator is designed to apply Harvest Tec buffered propionic acid.

Right and Left sides are determined by facing in the direction of forward travel.

Installation Kit Reference Chart:

Baler Make	Model	Install kit
AGCO	4750-4755	030-4490
	4760	030-4494
	4790	030-4492
	4900-4910	030-4491
	4760 Roto-Cutter	030-4500
	4790 Roto-Cutter	030-4501
	7430	030-4494
	7430 Roto-Cutter	030-4500
	7433-7444	030-4518
	7433-7434 Roto-Cutter	030-4519
CASE IH	8570-8575	030-4490
	8585	030-4492
	8580-8590	030-4491
	LBX331-432 Std or Packer	030-4495
	LBX331-432 Roto-Cutter	030-4497
	LB 333 – LB343 Std or Packer	030-4495
	LB 333 – LB433 Roto-Cutter	030-4497
	LB 433 (2011 and newer) Std or Packer	030-4528
	LB 433 (2011 and newer) Roto-Cutter	030-4529
CHALLENGER	LB33	030-4494
	LB34	030-4492
	LB44	030-4491
	LB33B – LB44B	030-4518
	LB33B – LB34B Roto-Cutter	030-4519
	LB33B – LB34B Packer Cutter	030-4527

CLAAS	2200 / 1200 / 3200 / 3400	030-4499
	2100	030-4509
	3300	030-4537
KRONE	VFS 88 & 128	030-4498
	VFS 88 & 128 Cutter	030-4495
	890 – 12130 XC	030-4514
	890 – 12130	030-4515
	BP 4x4, BP 4x4 HS	030-4539
	890 XC High Speed	030-4540
	1270, 1290, 1290HDP, 4x4 XC HS	030-4541
KUHN	LSB 870 – 890	030-4510
	LSB1270 – 1290	030-4511
	Omni-Cut	030-4525
JOHN DEERE	L330 / L340	030-4525J
MASSEY FERGUSON	2050	030-4494
	2050 ROTO-CUTTER	030-4500
	2140 – 2190, 2250 - 2290	030-4518
	2140 – 2190, 2250 – 2290 Roto-Cutter	030-4519
	2150 – 2190 Packer Cutter	030-4527
	2170 XD Roto-Cutter	030-4530
	2250 & 2270 ProCut	030-4542
NEW IDEA	7233	030-4490
	7234	030-4492
	7244	030-4491
	7333	030-4494
NEW HOLLAND	590-BB940A Std or Packer	030-4495
	595-BB960A Std or Packer	030-4495
	BB940-BB940A Roto-Cutter	030-4497
	BB960-BB960A Roto-Cutter	030-4497
	BB9060 – BB9080 Std or Packer	030-4495
	BB9060 – BB9080 Roto-Cutter	030-4497
	BB9080 (2011 and newer) Std or Packer	030-4528
BB9080 (2011 and newer) Roto-Cutter	030-4529	
VERMEER	SQ2731	030-4438
	SQ3347	030-4439
VICON	LB 8200	030-4510
	LB 12200	030-4511

Safety

Carefully read all the safety information and decals in this manual and on the applicator before use. Keep signs clean and in good working order. Replace missing or damaged safety signs. Replacement signs are available from your local authorized dealer. See your installation manual for under the replacement parts section for the correct part numbers.

Keep your applicator in proper working condition. Unauthorized modifications to the applicator may impair the function and/or safety of the machine.

Carefully read and understand all of the baler safety signs before installing or servicing the baler. Always use the supplied safety equipment on the baler to service the applicator.

Safety Decals

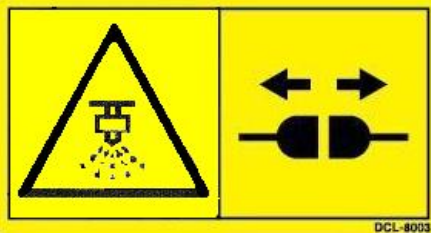

Number 1
Spraying hazard. Disconnect power before servicing the applicator
Part no. DCL-8003



Number 2
Falling hazard. Do not step in this area.
Part no. DCL-8002



Number 3
Use caution when working around chemicals. **Wear all protective equipment according to the label of the product.**
Part no. DCL-8001



Number 4
Read and understand the operator's manual before using or working around the equipment.
Part no. DCL-8000

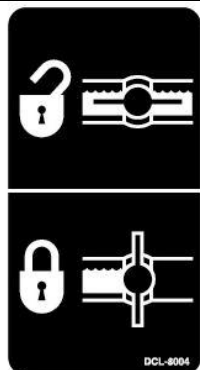

Number 5
Open (unlocked) and closed (locked) position of the ball valve.
Part no. DCL-8004

Safety Decal Locations

1

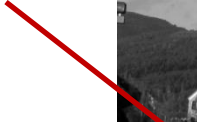

2

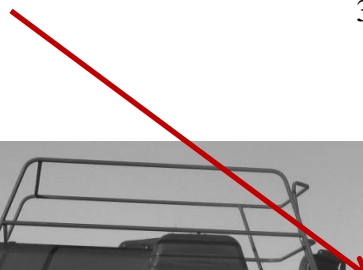

3, 4, 5



3, 5



Preparing the applicator for operation

After the Applicator has been installed on the baler, follow the below steps to prepare for operating the applicator both safely and correctly.

Filling the tank:

Read the label of the product being filled into the tank to determine what individual protective measures need to be taken. Locate the drain/fill line on the baler. Open the cam-couplers (A) and remove the protective plug (B). Insert the male coupler (found on transfer pump) into the female cam and close the cams (A). To open the ball valve (C) turn the handle so it is vertical. After the ball valve has been turned on switch the pump to the On position. Monitor the level on the tank visually and shut off the pump before over filling. Once the pump is turned off, close the ball valve and remove the male coupler. The handle of the ball valve (C) will be horizontal when closed. Reinstall the protective plug and close the cams. The Harvest Tec model 9212 transfer pump is recommended for this process.

Water is recommended for first time and annual start up procedures.

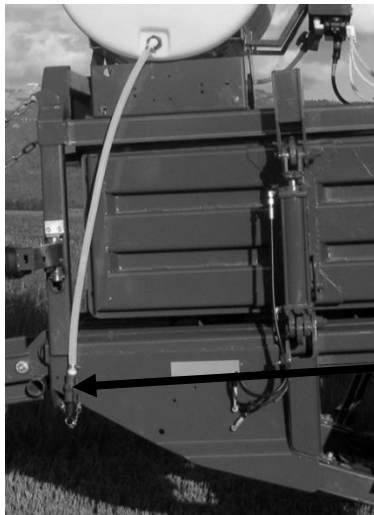

Drain/Fill line on the baler

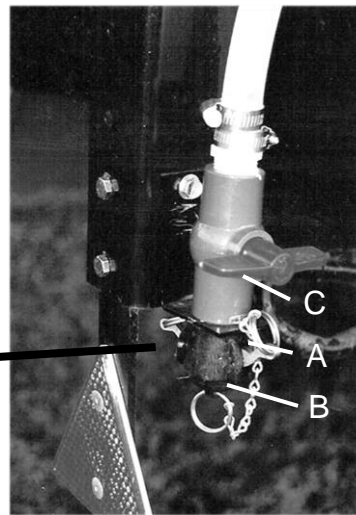

Enlarged view of the drain/fill line valve and cam-coupler assembly.

Operation of the main ball valve

The ball valve should be closed at all times when the applicator is not being used. The valve should also be closed when any service work is being done to the baler or applicator.

The valve is located next to the pump and by the applicator tank. The arrow below points at the valve.

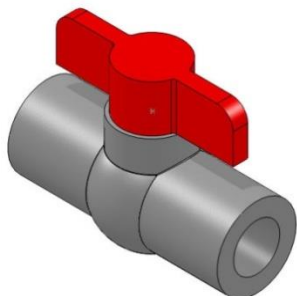

Valve open

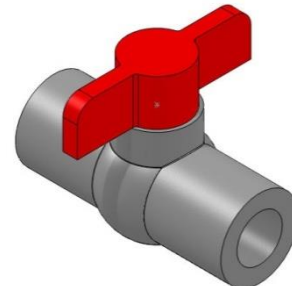

Valve closed

Connecting the power harness

The power harness that supplies power from the tractor battery to the applicator pump has a disconnect at the hitch. Connect the two together for operation. Always disconnect before servicing the applicator or baler.

Operation of the Control

Understanding and using the control

The model 457 control is pictured below. The toggle switch (A) is used to supply and cut off power to the pump. With the switch in down (shown) the power is off. Lift the switch up to supply power. The dial (B) is used to adjust the pressure to the tips when power is applied. Use the numbers on the dial only as reference. The PSI on the gauge determines the exact flow. Apply the correct rate decal found with your manual to the front of the control box. The message light (C) will always be illuminated when the power is on. If the light ever blinks during operation please reference the manual section "Message light".

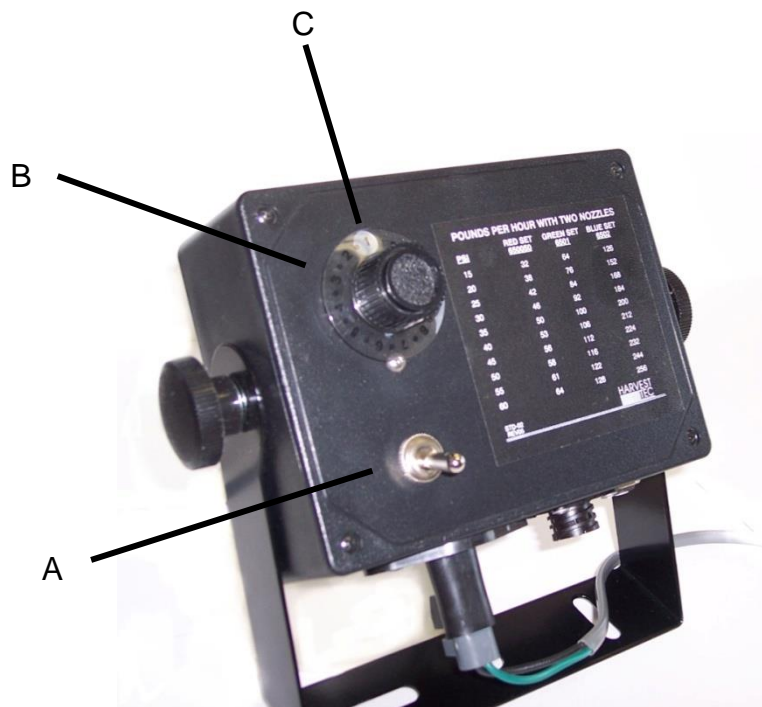

Message Light

The LED under the speed dial will be steady on when the applicator is running under normal situations. If the light blinks on and off use the information below to interpret the message.

Slow steady on and off blink: The system is attached to hay indicators (474A) or a foot switch. This message means that the pump is paused. Light will come on constant once the baler is back in the windrow.

Two quick blinks: The pump motor or pump harness is shorted.

Three quick blinks: Pump motor is over the current limit (10 amps).

Four quick blinks: Power is under current from a bad connection.

Control box must have the on/off switch toggled to clear the message after the fault has been fixed to clear.

First time and annual start up

After familiarizing yourself with the model 457 control, fill the tank with 5 gallons of water. Turn on the power to the pump by pushing the toggle switch up. You might hear the buzzing of the motor. Turn the dial on the control box until the pressure gauge starts to climb. By turning the dial clockwise the pressure will go up. By turning the dial counter clockwise the pressure will decrease. With the applicator spraying at about 30 PSI, look for leaks at all the hose connections and fittings. When you are comfortable with the operation of the controls you can set the applicator to apply the amount of chemical you would like it to put on.

Field operation

Calibration

There are three things that you need to know when calibrating your applicator. First you need know how many tons per hour you bale. Second you need to know the rate, or how many pounds of product to apply for a given ton per hour. Finally you need to know what tips to use and at what pressure to set the gauge.

Determining your tons per hour

1. Time 3 bales and average the time it takes to make a bale.
2. Estimate the weight of the bale.
3. Use the Bale Rate Chart below to determine the tons you are harvesting per hour.

Example: You are baling 1000 pound bales, with 2 minutes of time per bale. Looking at the chart below your tons per hour is 14.

Large Square Bale Rate Chart (tons per hour)

Weight per bale

Average time to make a bale	600	800	1000	1200	1400	1600	1800	2000
1.0 MN	18	24	30	36	42	48	54	60
1.5 MN	12	16	20	24	28	32	36	40
2.0 MN	9	12	14	18	21	24	27	30
2.5 MN	7	10	12	14	17	19	22	25
3.0 MN	6	8	10	12	14	16	18	20
4.0 MN	5	6	8	9	10	12	14	16
5.0 MN	4	5	6	7	8	9	11	13
6.0 MN	3	4	5	6	7	8	9	10
8.0 MN	3	3	4	5	5	6	7	8
10.0 MN	2	3	3	4	4	5	6	7

Determine the Rate of Chemical

The number of pounds of chemical required to be applied to a given ton of hay, depends on the moisture and the type of chemical used. The moisture of the hay is important in determining how much chemical to use. By knowing the moisture, you can make sure you are treating the hay correctly. Under applying will save money but spoilage most likely occurs. Over applying will waste money however, the hay will be saved. Some chemicals require more or less to treat the same amount of hay. To find the exact number of pounds required, for a given hay moisture, refer to the label on the drum or contact the manufacture. Harvest Tec applicators come with a set of low, medium, and high tips. If your chemical requires rates other than what these tips deliver you will need to purchase them through your dealer.

Selecting Tips and Setting Pressure

Once you have determined your tons per hour and the amount of chemical needed for the moisture you are applying at, you can select your tips and determine your gauge settings.

1. Multiply the tons per hour by the amount of chemical required for the moisture you are applying at. This sum will give you the application rate.
2. Select the proper set of tips from the application rate chart and install them.
3. For the tips you have selected, you will need to keep the gauge at the recommended PSI to achieve the proper application rate.
4. Set the pressure by adjusting the dial on the control box and by reading the pressure of the gauge to match the desired rates. The numbers on the dial are for reference only. Rate is determined by watching the pressure gauge.

Example: You are baling at 12 tons per hour with your large square baler. The moisture that you are baling at requires you to apply 6 pounds per ton. Multiply the 12 tons x 6lbs = 72 lbs per hour. Using the chart on page 28 you will notice the orange set of tips at 20 PSI will give you that output.

General calibration charts

Pounds per hour with two nozzles

PSI	YELLOW SET 800067PT	Comes w/ applicator kit			
		ORANGE SET TT11001VP	GREEN SET TT10015VP	BLUE SET TT11003VP	BROWN SET TT11005VP
15	42	64	95	196	323
20	49	74	111	222	376
25	53	80	122	249	413
30	60	90	138	275	461
35	65	98	148	296	
40	70	106	159	317	
45	74	111	170	336	
50	78	117	180	354	
55	81	122	188	370	
60	85	127	196	386	

Gallons per hour with two nozzles

PSI	YELLOW SET 800067PT	Comes w/ applicator kit			
		ORANGE SET TT11001VP	GREEN SET TT10015VP	BLUE SET TT11003VP	BROWN SET TT11005VP
15	5.2	7.3	10.7	22.0	31.9
20	5.6	8.4	12.7	24.1	42.2
25	6.3	9.5	14.1	28.3	47.3
30	7.0	10.3	15.5	31.0	52.2
35	7.5	11.3	16.6	33.5	
40	8.0	12.2	17.8	36.0	
45	8.4	12.6	19.2	38.3	
50	8.9	13.2	20.6	40.7	
55	9.3	13.8	21.3	42.5	
60	9.7	14.4	22.0	44.4	

***ONLY THE OPERATOR CAN DETERMINE HOW MUCH PRODUCT IS APPLIED.**

Maintenance

- If you are unsure how to perform any of the maintenance steps have your local authorized dealer perform the tasks.

Maintenance Schedule

	Daily	10 hrs	400 hrs	Weekly	Monthly	Season
Filter bowl cleaning		X				X
Tips & tip screen cleaning		X				X
Tank lid cleaning		X				X
Dielectric grease connections					X	X
Rebuild pump			X			
Battery connections				X		X
Visually inspect hoses				X		X

Filter bowl cleaning: Before cleaning the filter bowl all personal protective equipment must be worn (Face shield or goggles, chemically resistant apron, boots, and gloves).

Verify that the ball valve located next to the pump is turned off. Locate the filter bowl on the side of the pump manifold (A). Unscrew the bottom section of the filter bowl and remove the strainer (B). Clean off any debris and soak in warm water with a mild soap if necessary. Once the screen is clean reinstall by following the directions in reverse.

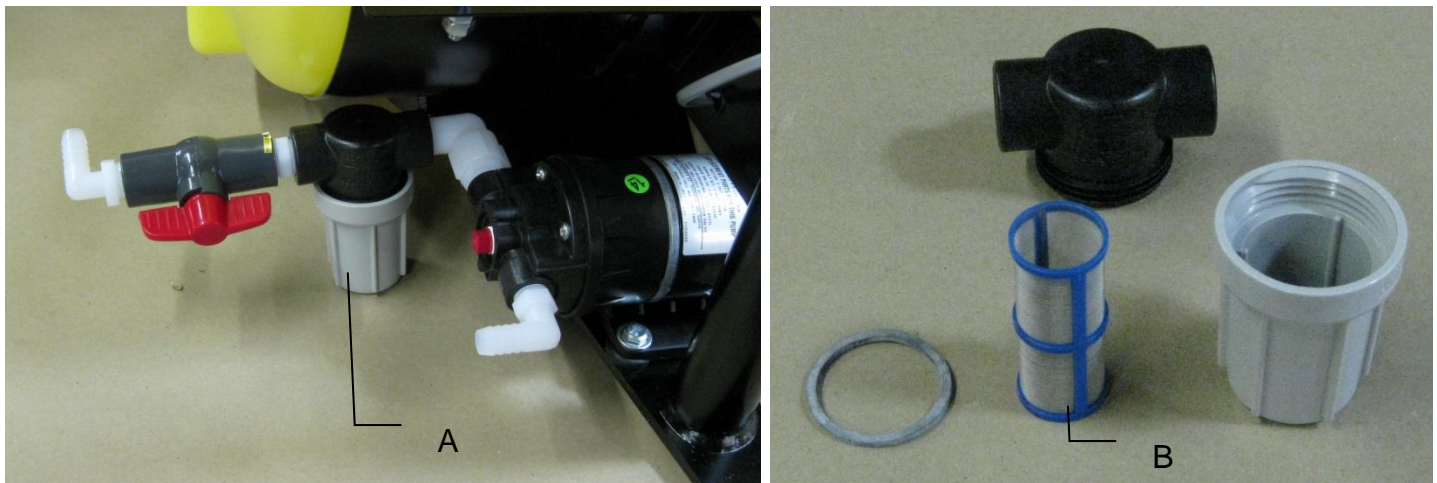

Miscellaneous maintenance:

1. Depending on the product being used, the system may need to be flushed with water at a regular interval (consult with manufacturer of the chemical). If Harvest Tec product is being used, flushing is not necessary.
2. Although the pump can run dry, extended operation of a dry pump will increase wear. Watch the preservative level in the tank.
3. If you are using bacterial inoculants, flush your system daily after every use.

Tips & tip screen cleaning: Before cleaning the tips and screens all personal protective equipment must be worn (Face shield or goggles, chemically resistant apron, boots, and gloves).

Verify that the ball valve located next to the pump is turned off. Disconnect spray shield from hangers if possible or remove tips in place. Remove the tip, and screen. Some models may require a wrench to remove. Clean off any debris and soak tip and screen in warm water with a mild soap if necessary. Once the tips and screens are cleaned reinstall by following the directions in reverse.

Tank lid cleaning: Before cleaning the tank lid all personal protective equipment must be worn (Face shield or goggles, chemically resistant apron, boots, and gloves).

The tank lid is located on the top of the tank. Use the supplied handle on the tank to secure your person and use the other hand to remove any debris from the top of the tank. Unscrew the tank lid and bring down ground level. Use compressed air clean out the tank screen (D). If the screen cannot be thoroughly cleaned with compressed air, replace fitting (005-9022B3). Once the screen is cleaned reinstall the cover.

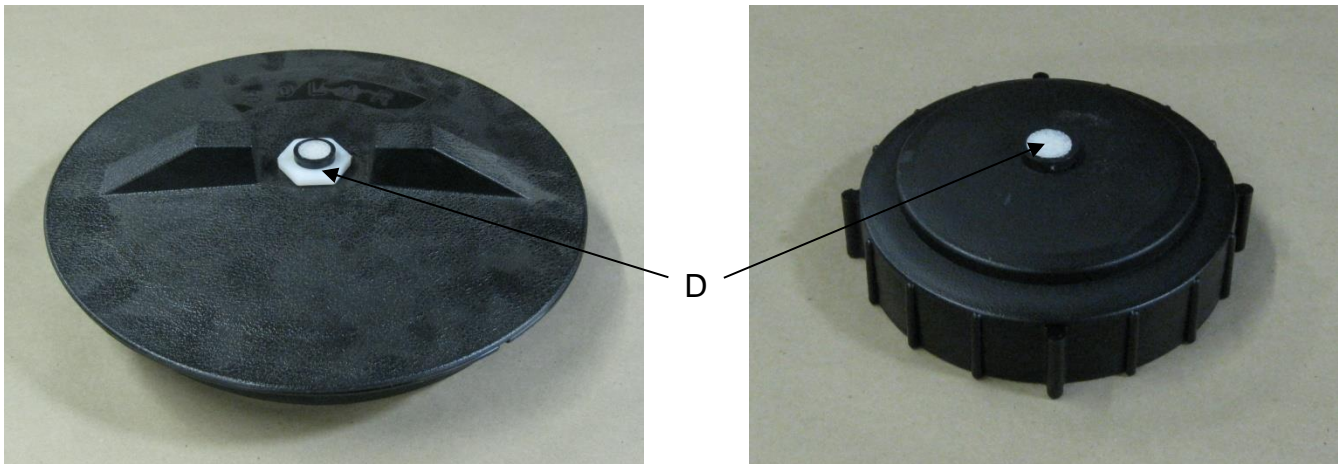

Dielectric grease connections: Disconnect all harnesses on the applicator, clean the connections, and repack with dielectric grease.

Rebuild pump: If the pump is not working up to specifications a pump rebuild kit may fix the problems. Verify that the ball valve is turned off. Before working around the pump all personal protective equipment must be worn (Face shield or goggles, chemically resistant apron, boots, and gloves). Disconnect all pump fittings and remove pump from saddle. Follow rebuild instructions supplied with pump rebuild kit. Reinstall after rebuild is complete.

Battery connections: Follow the batteries safety warnings and clean the battery connections. If the connections cannot be cleaned, replace harness.

Winter Storage

1. Thoroughly flush the system with water.
2. Remove the filter bowl and run dry until the water has cleared out of the intake side.
3. Remove the red plug from the bottom of pump, drain, and run the pump for 30 seconds or until dry.
4. Drain all lines on the outlet side.
5. Never use oils or alcohol based anti-freeze in the system.
6. For spring start-up, if the pump is frozen, turn off the power immediately to avoid burning the motor out or blowing a fuse. The pump head can be disassembled and freed or rebuilt in most cases. Check the fuses after the pump has been freed.
7. Disconnect power from the applicator
8. Remove display from tractor and store in a warm, dry place.

Troubleshooting

PROBLEM	POSSIBLE CAUSE	SOLUTION
Pump will not run.	1. Circuit breaker tripped on electronic unit.	1. Check for short, low voltage, and reset breaker.
	2. Pump locked up.	2. Clean or rebuild pump.
	3. Damaged wire.	3. Repair damaged wire.
	4. Vapor locked.	4. Loosen hose by check valve at gauge and bleed air.
Pump runs but will not prime.	1. Air leak in intake.	1. Tighten fittings on intake side.
	2. Clogged intake.	2. Clean.
	3. Restricted outlet.	3. Check and clean tips.
	4. Check valve on outlet stuck closed.	4. Clean or repair check valve.
	5. Dirt inside pump.	5. Replace pump check valve.
Pump does not develop enough output.	1. Air leaks or clogs on inlet side.	1. Tighten or clean filter bowl assembly.
	2. Electronic box out of adjustment.	2. Refer to box adjustment page.
	3. Pump worn or dirty.	3. Rebuild pump.
	4. Low supply voltage.	4. Check voltage at connection with voltmeter.
	5. Bad gauge.	5. Gauge should read less than 10 PSI when not in use. Also tips should lose spray pattern below 10 PSI. Check accuracy.
Pump output varies.	1. Clogged or restricted inlet.	1. Clean
	2. Worn pump parts.	2. Rebuild pump.
Message light blinks two times	1. Pump or wire harness shorted.	1. Check harness running to pump and verify no shorts or problems. 2. Check to see if pump motor is locked up. Repair or replace.
Message light blinks three times	1. Pump is drawing greater than 10 amps.	1. Check to see if motor is running correctly. Repair or replace.
Message light blinks four times	1. Undercurrent coming to control box.	1. Check all battery connections and connections running up to control box.

Parts Breakdown Tank, Saddle & Legs 100 Gallon

Vermeer, Claas, and Krone Balers with 100 gallon tank

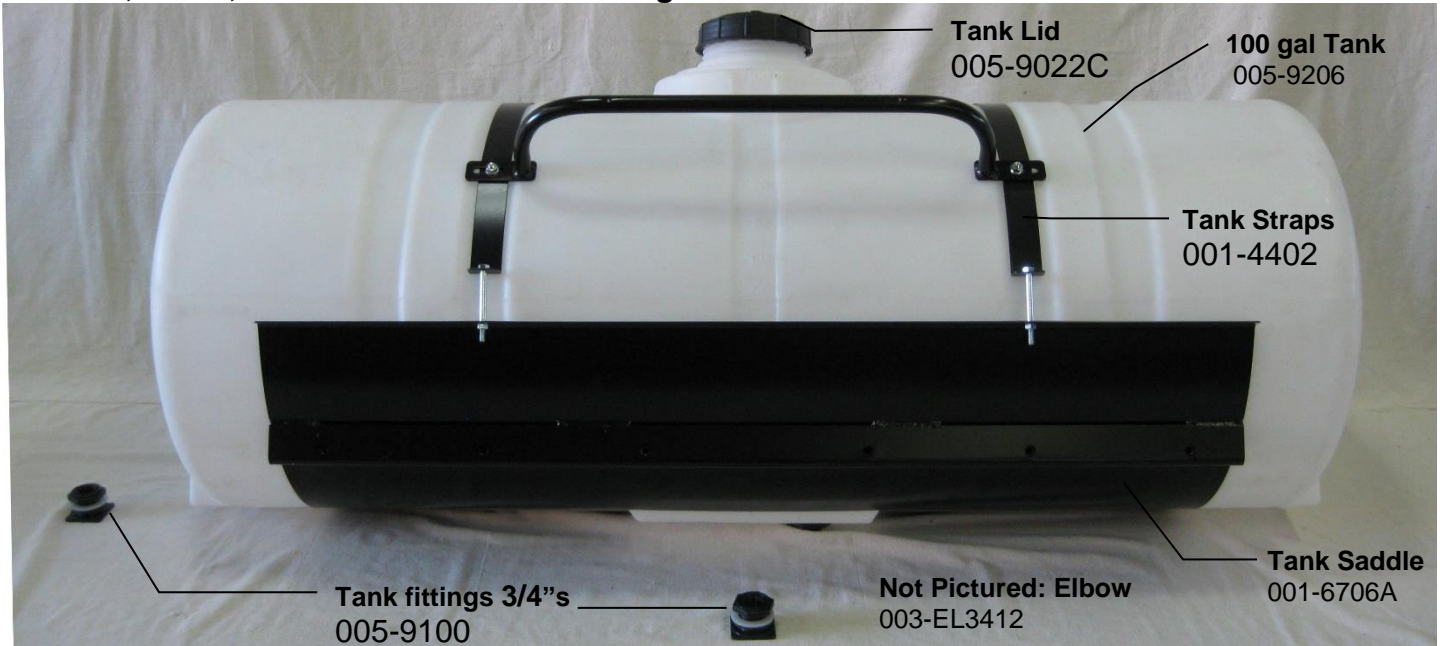

**Vermeer, Claas and Krone
Balers Saddle Legs**

Part#: 001-6706V

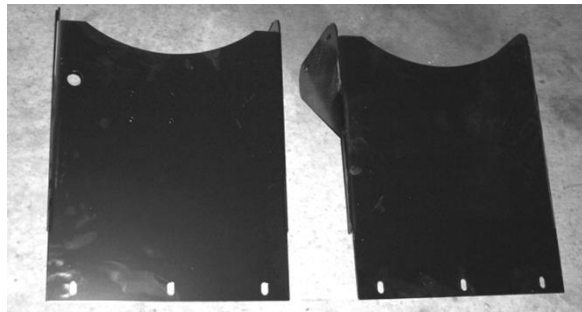

*If the applicator is being mounted on a **Krone 870 HDP** baler, two leg adapter brackets will be needed for proper tank leg installation (below). Part number 001-6707KV.

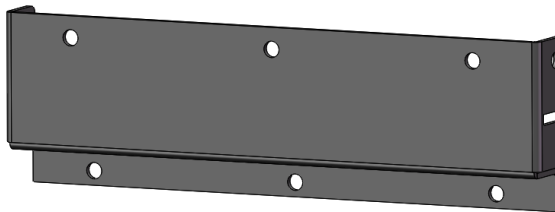

Claas 3300 Saddle Legs

Part #: 001-6706C



Tank, Saddle and Legs 110 Gallon



- Tank Lid**
Part#: 005-9022E
or 005-9208L
- Tank-110 gallon**
Part#: 005-9208
- Hand Rail**
Part#: 001-6707HR
- Tank Straps**
Part#: 001-4402B
- Tank Saddle**
Part#: 001-6707A
- Tank Fitting**
Part#: 005-9100

Not Pictured: Elbow
Part#:003-EL3412

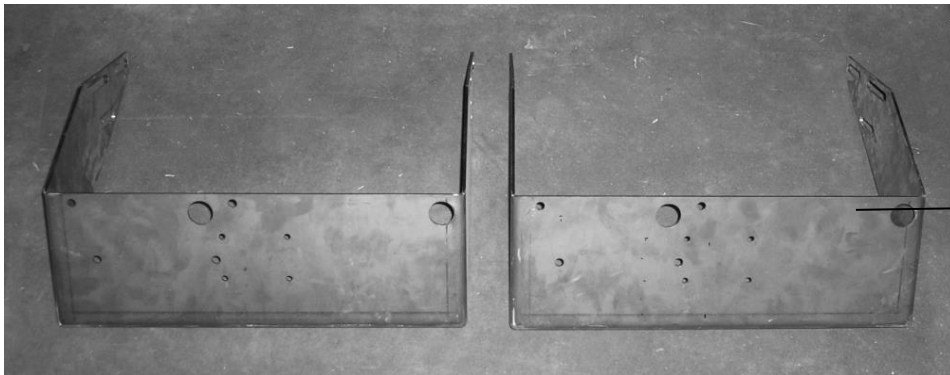

Agco, Hesston, Massey & Challenger Saddle Legs

Part#: 001-6707C

**New Holland BB940A, BB960A,
Case IH LBX 332, LBX 432 Series
Saddle Legs**

Not Pictured:
Vicon Leg Spacers:
Part#: 001-6707BS (x2)

Handrail:
Part#: 001-6707HR (x1)

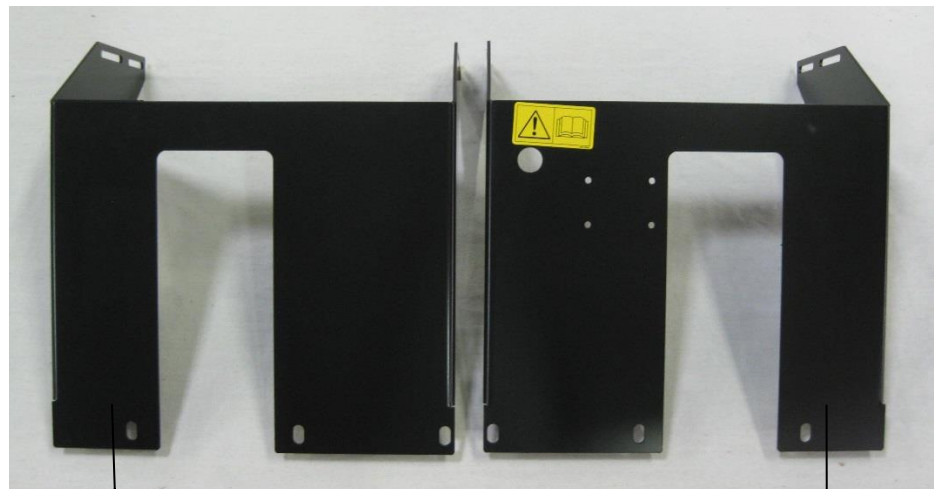

Left Leg Part#:001-6707BL
(2010 and older 4 ft wide)

Right Leg Part #:001-6707BR
(2010 and older 4 ft wide)

Tank, Saddle and Legs 110 Gallon (continued)

New Holland BB940A, BB960A,
Case IH LBX 332, LBX 432 Series
Saddle Legs



Left Leg Part#: 001-6707DL
(2011 and newer 4 ft wide)

Right Leg Part #: 001-6707DR
(2011 and newer 4 ft wide)

Krone Balers

Part#: 001-6707KA

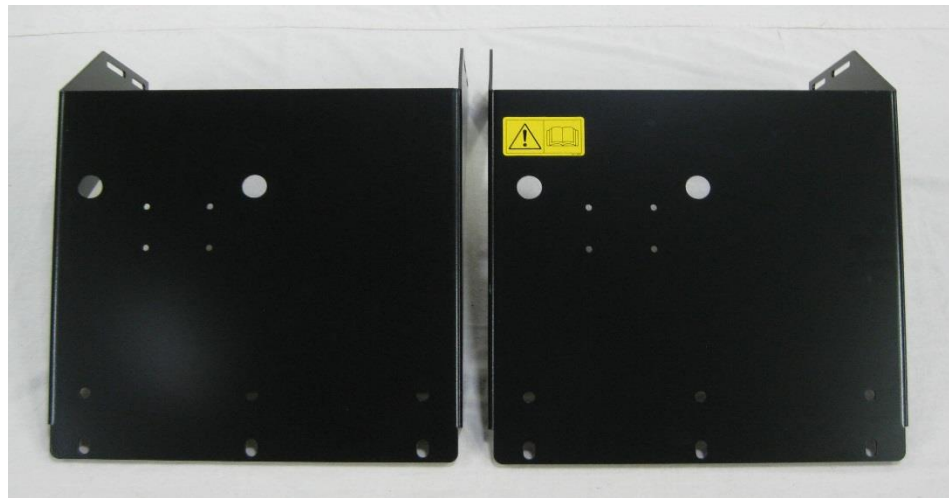

John Deere L330 / L340

Part#: 001-6707J

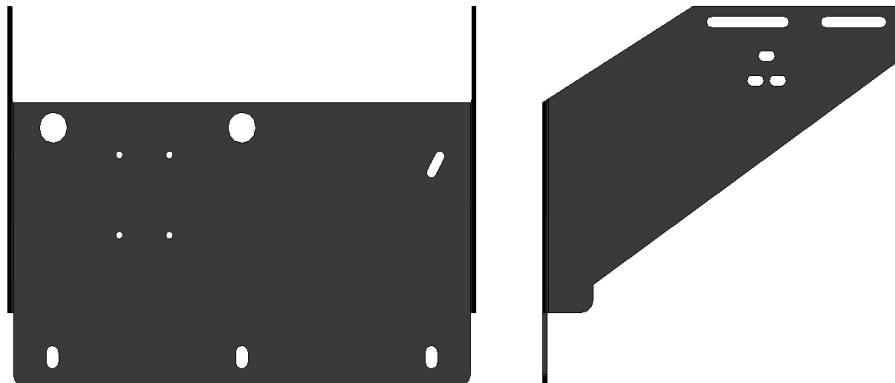

Parts Breakdown for Control Box and Wiring Harnesses, Gauge, and Pump Assembly

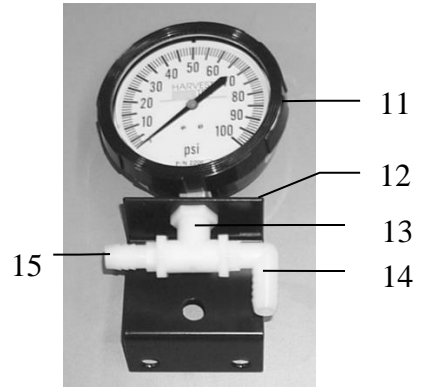
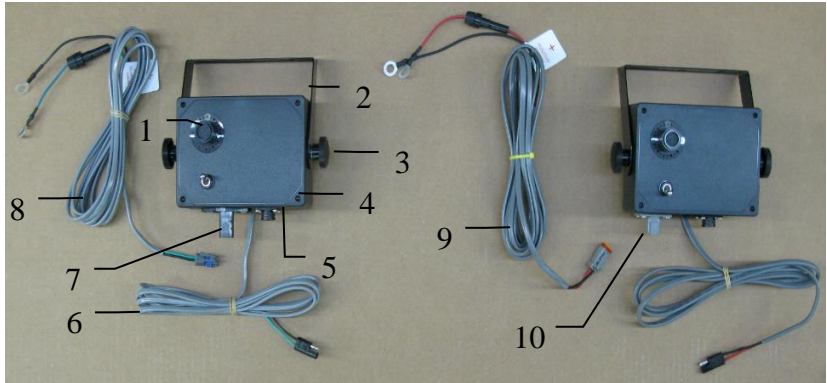

Ref	Description	Part #	Qty	Ref	Description	Part #	Qty
1	Speed dial	006-2022A	1	9	Power lead After Serial # 4550	006-4580M	1
2	U-bracket	001-2012E	1	10	Box Plug After Serial # 4550	006-4581M	1
3	Control box knob	008-0923	2	11	Gauge	002-2208Z	1
4	Control box enclosure	006-2015A	1	12	Gauge Bracket	001-4714	1
5	Control box cover	006-2015B	1	13	Tee	004-TT14	1
6	Pump lead	006-4583	1	14	Elbow Fitting	003-EL1412	1
7	Box Plug Pre-Serial # 4549	006-4581		15	Straight Fitting	003-A1212	1
8	Power lead Pre-Serial # 4549	006-4580C	1				

AGCO Balers Only

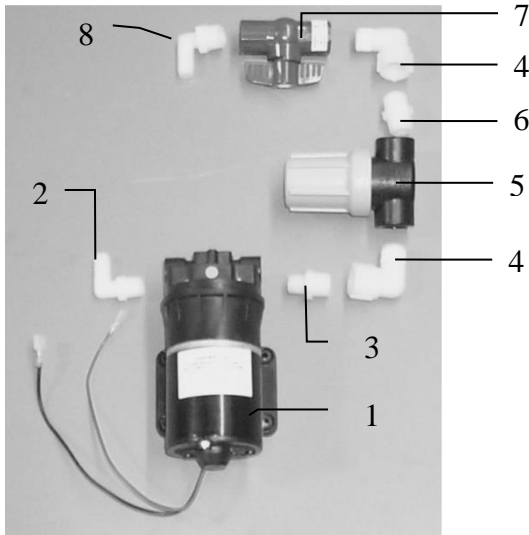

Non-AGCO Balers

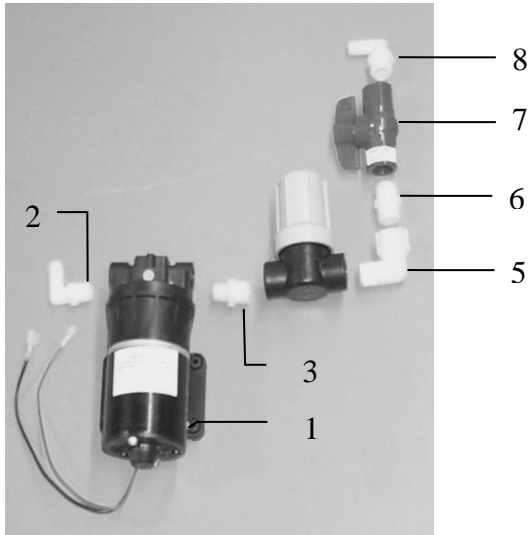

Ref	Description	Part #	Qty
1	Pump	007-4120S	1
2	Elbow	003-EL3812	1
3	Reducing Nipple	003-M1238	1
4	Street Elbow	003-SE12	2
5	Filter Bowl	002-4315	1
6	Nipple	003-M1212	1
7	Ball Valve	002-2212	1
8	Elbow	003-EL1212	1

Ref	Description	Part #	Qty
1	Pump	007-4120S	1
2	Elbow	003-EL3812	1
3	Reducing Nipple	003-M1238	1
4	Filter Bowl	002-4315	1
5	Street Elbow	003-SE12	1
6	Nipple	003-M1212	1
7	Ball Valve	002-2212	1
8	Elbow	003-EL1212	1
NP	Straight Fitting (L330/L340 Only, Replaces 003-EL1212)	003-A1212	1

Harvest Tec Model 4438

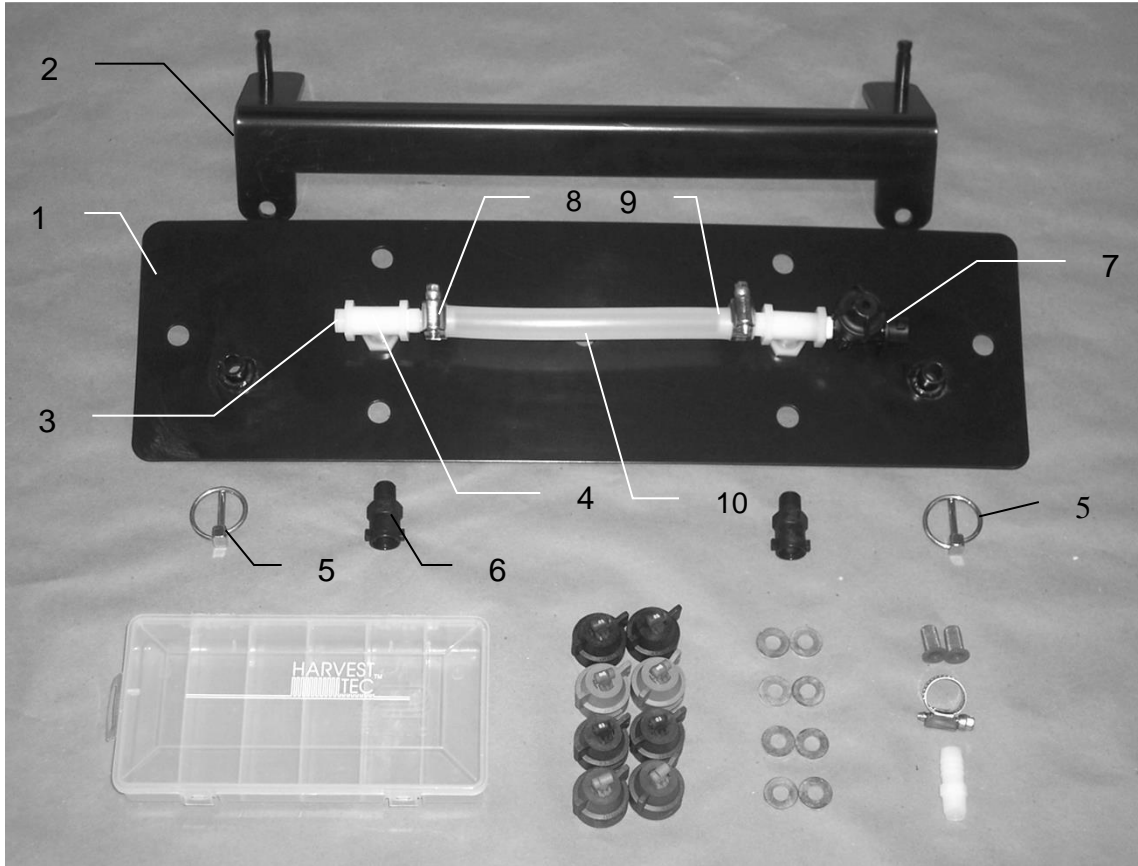

<u>Ref #</u>	<u>Description</u>	<u>Part #</u>	<u>Qty</u>	<u>Description</u>	<u>Part #</u>	<u>Qty</u>
1	Spray shield	001-4438A	1	Tip Kit (Complete)	030-9007	1
2	Shield holder	001-4438B	1	Tip Kit Includes:		
3	Plug	003-F14	1	Plastic Box	008-9000	1
4	Tee	003-TT14	2	Orange cap (Orange Set)	004-1207J	2
5	Lynch pin	008-4576	2	Tip (Orange Set)	004-TT11001VP	2
6	Nozzle body	004-4710	2	Green cap (Green Set)	004-1207A	2
7	Check valve	004-1207V	1	Tip (Green Set)	004-TT110015VP	2
8	Hose clamp	003-9003	3	Blue cap (Blue Set)	004-1207C	2
9	Straight Fitting	003-A1412	3	Tip (Blue Set)	004-TT11003VP	2
10	Hose	002-9001	1	Brown Cap (Brown Set)	004-1207K	2
				Tip (Brown Set)	004-TT11005VP	2
				Washer	004-1207W	8
				Tip Strainer	004-1203-100	2

Harvest Tec Model 4439

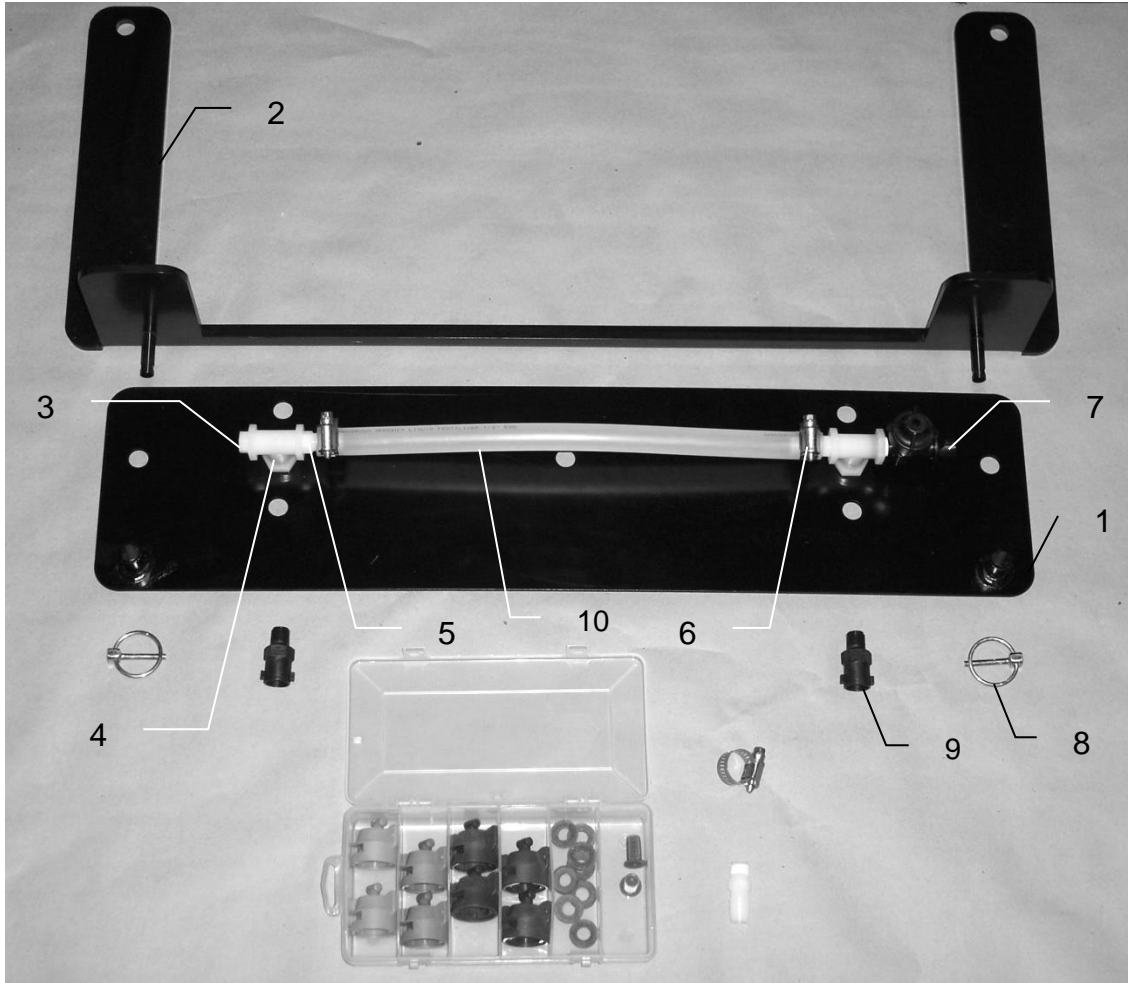

<u>Ref #</u>	<u>Description</u>	<u>Part #</u>	<u>Qty</u>	<u>Description</u>	<u>Part #</u>	<u>Qty</u>
1	Spray shield	001-4439A	1	Tip Kit (Complete)	030-9007	1
2	Shield holder	001-4439B	1	Tip Kit Includes:		
3	Plug	003-F14	1	Plastic Box	008-9000	1
4	Tee	003-TT14	2	Orange cap (Orange Set)	004-1207J	2
5	Straight Fitting	003-A1412	3	Tip (Orange Set)	004-TT11001VP	2
6	Hose clamp	003-9003	3	Green cap (Green Set)	004-1207A	2
7	Check valve	004-1207V	1	Tip (Green Set)	004-TT110015VP	2
8	Lynch pin	008-4576	2	Blue cap (Blue Set)	004-1207C	2
9	Nozzle body	004-4710	2	Tip (Blue Set)	004-TT11003VP	2
10	Hose	002-9001	2	Brown Cap (Brown Set)	004-1207K	2
				Tip (Brown Set)	004-TT11005VP	2
				Washer	004-1207W	8
				Tip Strainer	004-1203-100	2

Harvest Tec Model 4490

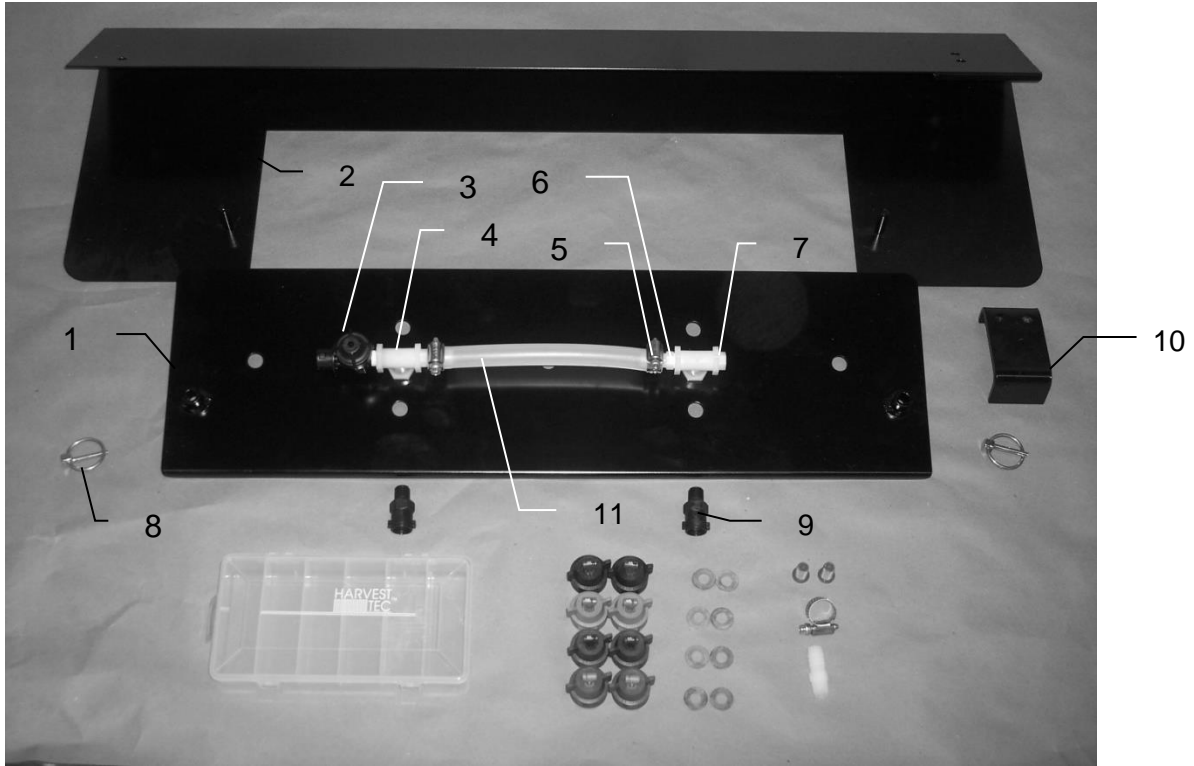

<u>Ref #</u>	<u>Description</u>	<u>Part #</u>	<u>Qty</u>	<u>Description</u>	<u>Part #</u>	<u>Qty</u>
1	Spray shield	001-4421	1	Tip Kit (Complete)	030-9007	1
2	Shield holder	001-4421B	1	Tip Kit Includes:		
3	Check valve	004-1207V	1	Plastic Box	008-9000	1
4	Tee	003-TT14	2	Orange cap (Orange Set)	004-1207J	2
5	Hose clamp	003-9003	3	Tip (Orange Set)	004-TT11001VP	2
6	Straight Fitting	003-A1412	3	Green cap (Green Set)	004-1207A	2
7	Plug	003-F14	1	Tip (Green Set)	004-TT110015VP	2
8	Lynch pin	008-4576	2	Blue cap (Blue Set)	004-1207C	2
9	Nozzle body	004-4710	2	Tip (Blue Set)	004-TT11003VP	2
10	Backing plate	001-4421A	1	Brown Cap (Brown Set)	004-1207K	2
11	Hose	002-9001	1	Tip (Brown Set)	004-TT11005VP	2
				Washer	004-1207W	8
				Tip Strainer	004-1203-100	2

Harvest Tec Model 4491

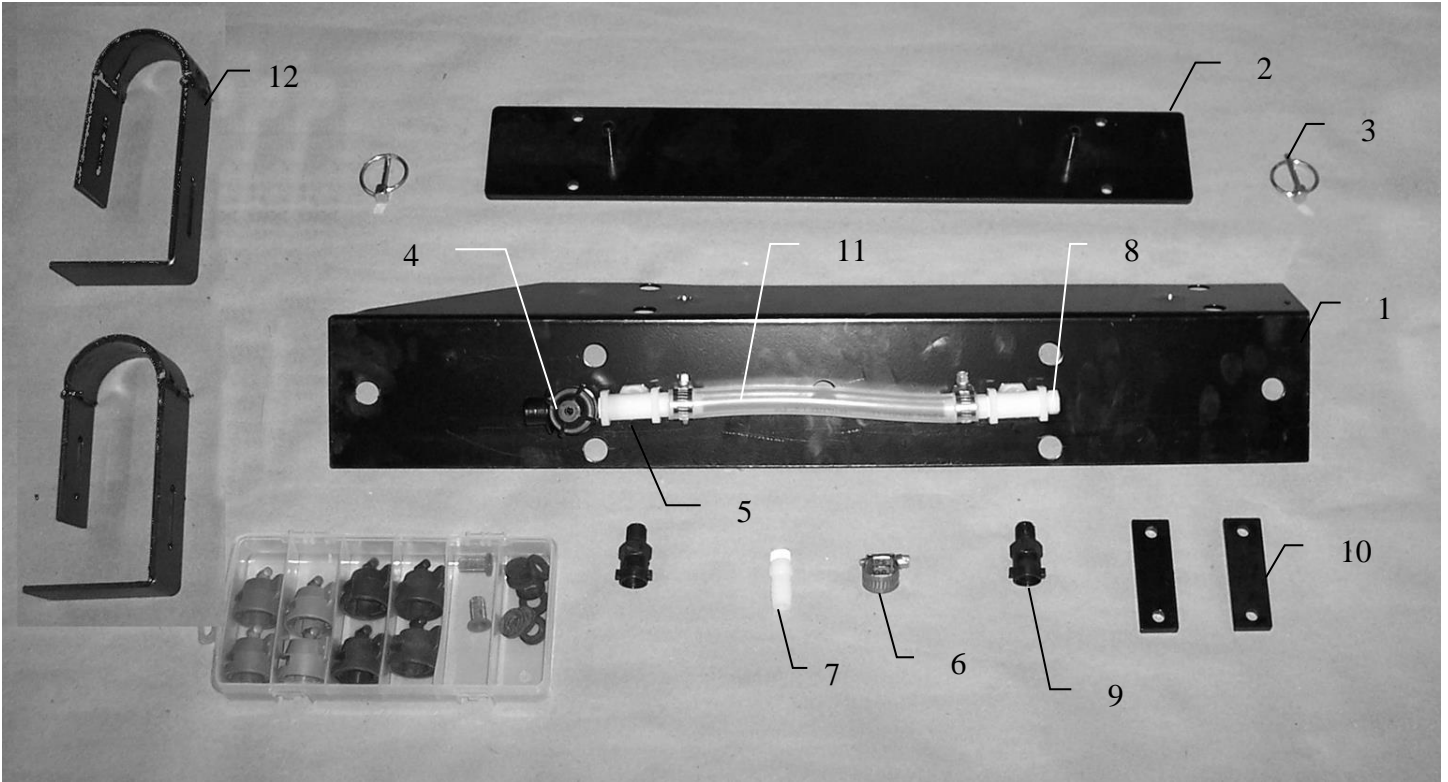

<u>Ref #</u>	<u>Description</u>	<u>Part #</u>	<u>Qty</u>	<u>Description</u>	<u>Part #</u>	<u>Qty</u>
1	Spray shield	001-4422	1	Tip Kit (Complete)	030-9007	1
2	Shield holder	001-4422B	1	Tip Kit Includes:		
3	Lynch pin	008-4576	2	Plastic Box	008-9000	1
4	Check valve	004-1207V	1	Orange cap (Orange Set)	004-1207J	2
5	Tee	003-TT14	2	Tip (Orange Set)	004-TT11001VP	2
6	Hose clamp	003-9003	3	Green cap (Green Set)	004-1207A	2
7	Straight Fitting	003-A1412	3	Tip (Green Set)	004-TT110015VP	2
8	Plug	003-F14	1	Blue cap (Blue Set)	004-1207C	2
9	Nozzle body	004-4710	2	Tip (Blue Set)	004-TT11003VP	2
10	Backing plate	001-4422A	2	Brown Cap (Brown Set)	004-1207K	2
11	Hose	002-9001	1ft	Tip (Brown Set)	004-TT11005VP	2
12	Ladder bracket	001-6707H	2	Washer	004-1207W	8
				Tip Strainer	004-1203-100	2

Harvest Tec Model 4492

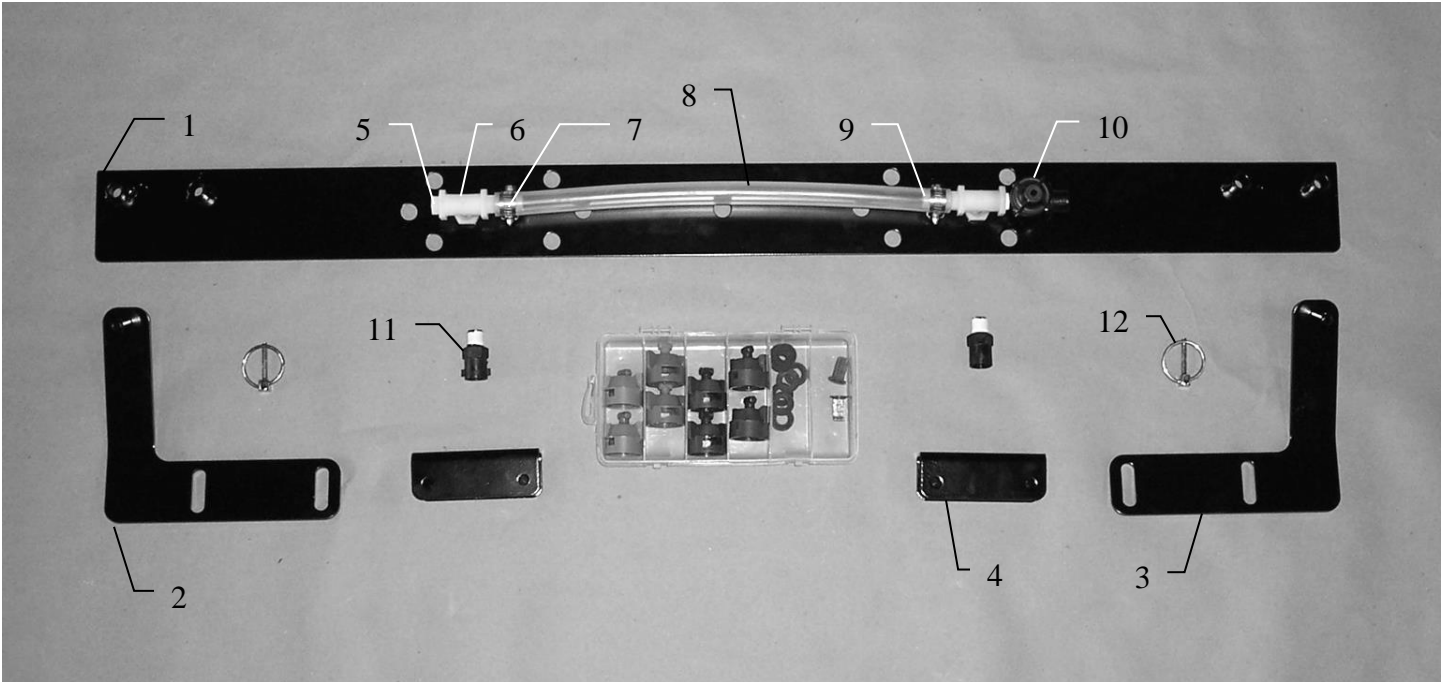

<u>Ref #</u>	<u>Description</u>	<u>Part #</u>	<u>Qty</u>	<u>Description</u>	<u>Part #</u>	<u>Qty</u>
1	Spray shield	001-4811A	1	Tip Kit (Complete)	030-9007	1
2	Left shield hanger	001-4436DL	1	Tip Kit Includes:		
3	Right shield hanger	001-4436DR	1	Plastic Box	008-9000	1
4	Spacer	001-4436S	2	Orange cap (Orange Set)	004-1207J	2
5	Plug	003-F14	1	Tip (Orange Set)	004-TT11001VP	2
6	Tee	003-TT14	2	Green cap (Green Set)	004-1207A	2
7	Hose clamp	003-9003	3	Tip (Green Set)	004-TT110015VP	2
8	Hose	002-9001	1	Blue cap (Blue Set)	004-1207C	2
9	Straight fitting	003-A1412	3	Tip (Blue Set)	004-TT11003VP	2
10	Check valve	004-1207V	1	Brown Cap (Brown Set)	004-1207K	2
11	Nozzle body	004-4710	2	Tip (Brown Set)	004-TT11005VP	2
12	Lynch pin	008-4576	2	Washer	004-1207W	8
				Tip Strainer	004-1203-100	2

Harvest Tec Model 4494

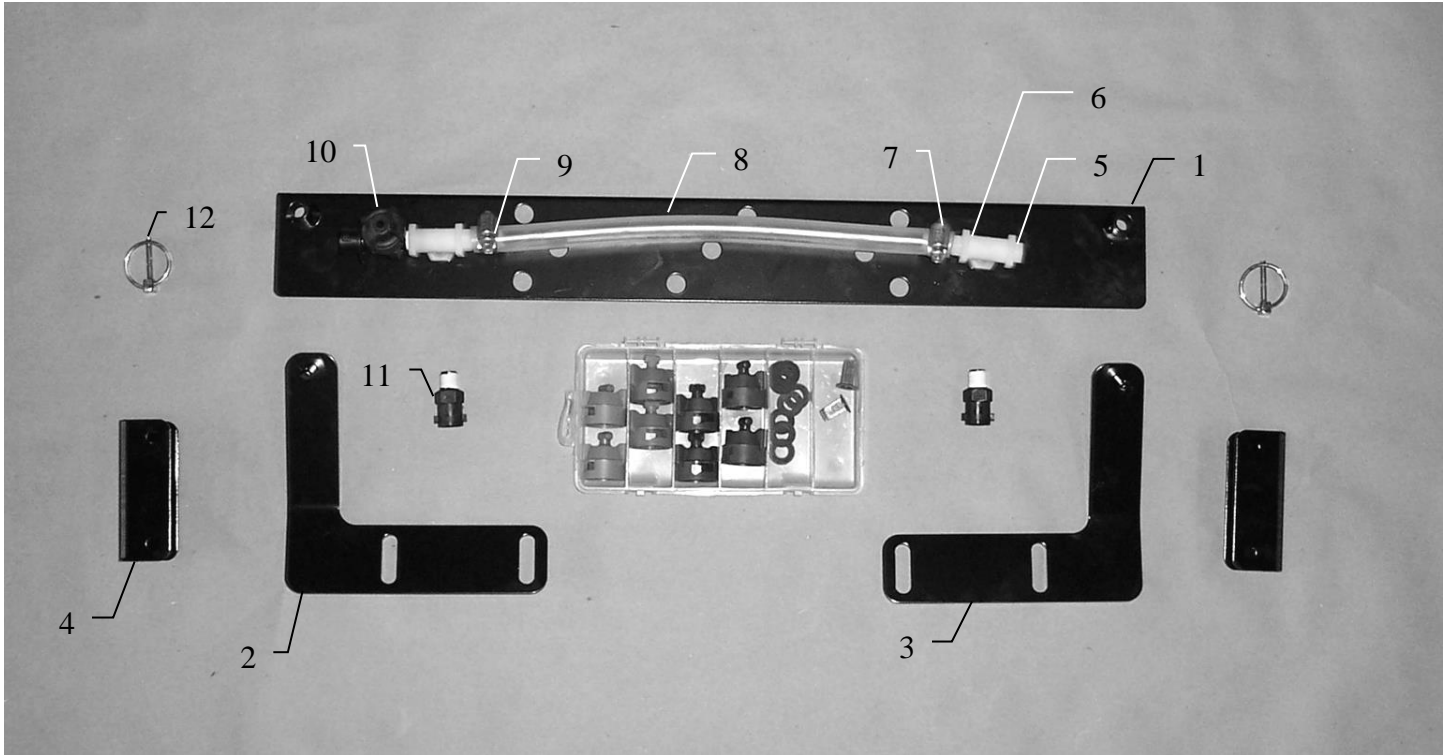

<u>Ref #</u>	<u>Description</u>	<u>Part #</u>	<u>Qty</u>	<u>Description</u>	<u>Part #</u>	<u>Qty</u>
1	Spray shield	001-4810	1	Tip Kit (Complete)	030-9007	1
2	Left shield hanger	001-4436DL	1	Tip Kit Includes:		
3	Right shield hanger	001-4436DR	1	Plastic Box	008-9000	1
4	Spacer	001-4436S	2	Orange cap (Orange Set)	004-1207J	2
5	Plug	003-F14	1	Tip (Orange Set)	004-TT11001VP	2
6	Tee	003-TT14	2	Green cap (Green Set)	004-1207A	2
7	Hose clamp	003-9003	3	Tip (Green Set)	004-TT110015VP	2
8	Hose	002-9001	1	Blue cap (Blue Set)	004-1207C	2
9	Straight fitting	003-A1412	3	Tip (Blue Set)	004-TT11003VP	2
10	Check valve	004-1207V	1	Brown Cap (Brown Set)	004-1207K	2
11	Nozzle body	004-4710	2	Tip (Brown Set)	004-TT11005VP	2
12	Lynch pin	008-4576	2	Washer	004-1207W	8
				Tip Strainer	004-1203-100	2

Harvest Tec Model 4495 & 4528

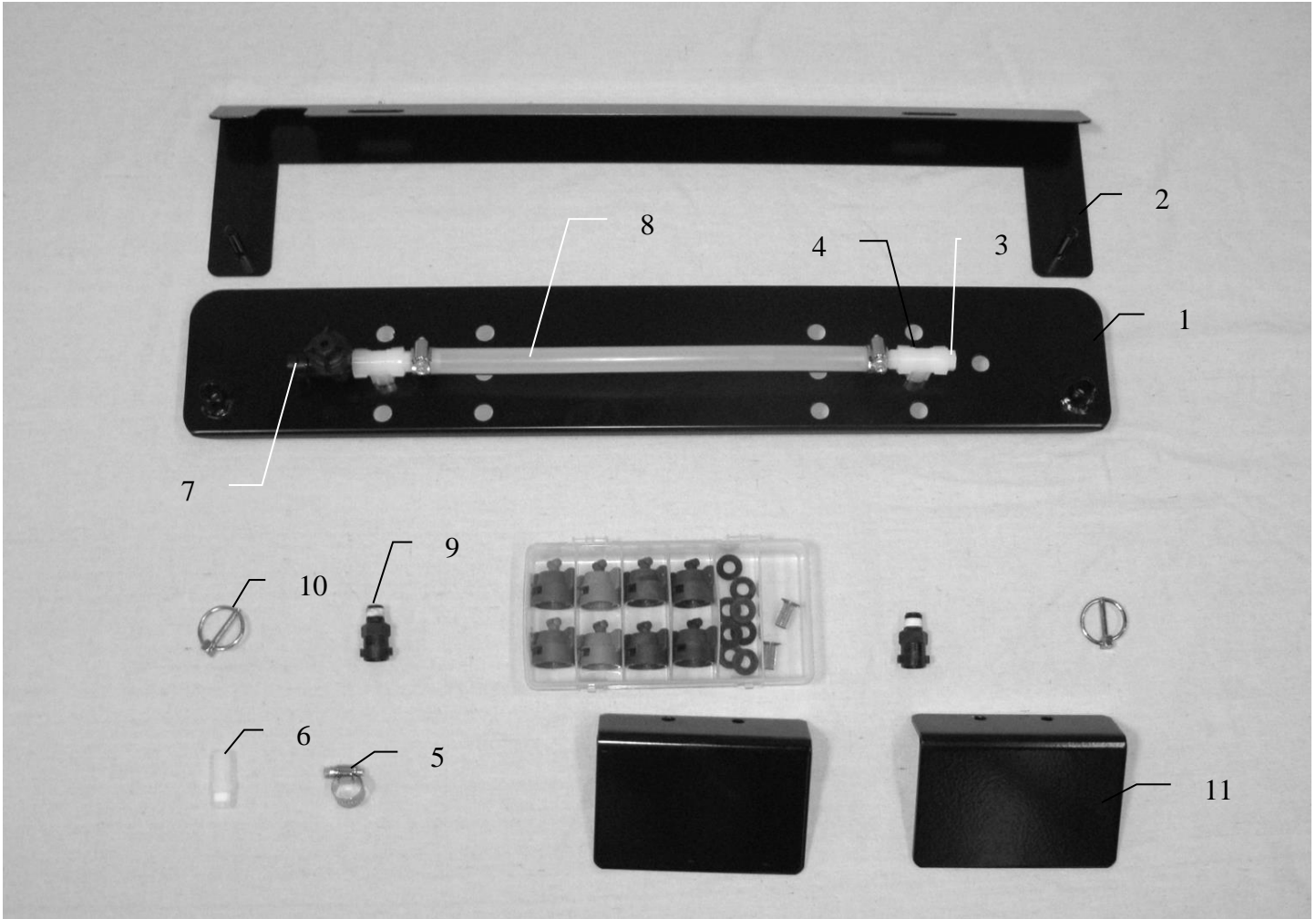

<u>Ref #</u>	<u>Description</u>	<u>Part #</u>	<u>Qty</u>	<u>Description</u>	<u>Part #</u>	<u>Qty</u>
1	Spray shield	001-4431B	1	Tip Kit (Complete)	030-9007	1
2	Shield holder	001-4431	1	Tip Kit Includes:		
3	Plug	003-F14	1	Plastic Box	008-9000	1
4	Tee	003-TT14	2	Orange cap (Orange Set)	004-1207J	2
5	Hose clamp	003-9003	3	Tip (Orange Set)	004-TT11001VP	2
6	Straight Fitting	003-A1412	3	Green cap (Green Set)	004-1207A	2
7	Check valve	004-1207V	1	Tip (Green Set)	004-TT110015VP	2
8	Hose	002-9001	1	Blue cap (Blue Set)	004-1207C	2
9	Nozzle body	004-4710	2	Tip (Blue Set)	004-TT11003VP	2
10	Lynch pin	008-4576	2	Brown Cap (Brown Set)	004-1207K	2
11	Wind guard stop	001-4431D	2	Tip (Brown Set)	004-TT11005VP	2
				Washer	004-1207W	8
				Tip Strainer	004-1203-100	2

Harvest Tec Model 4497 & 4529

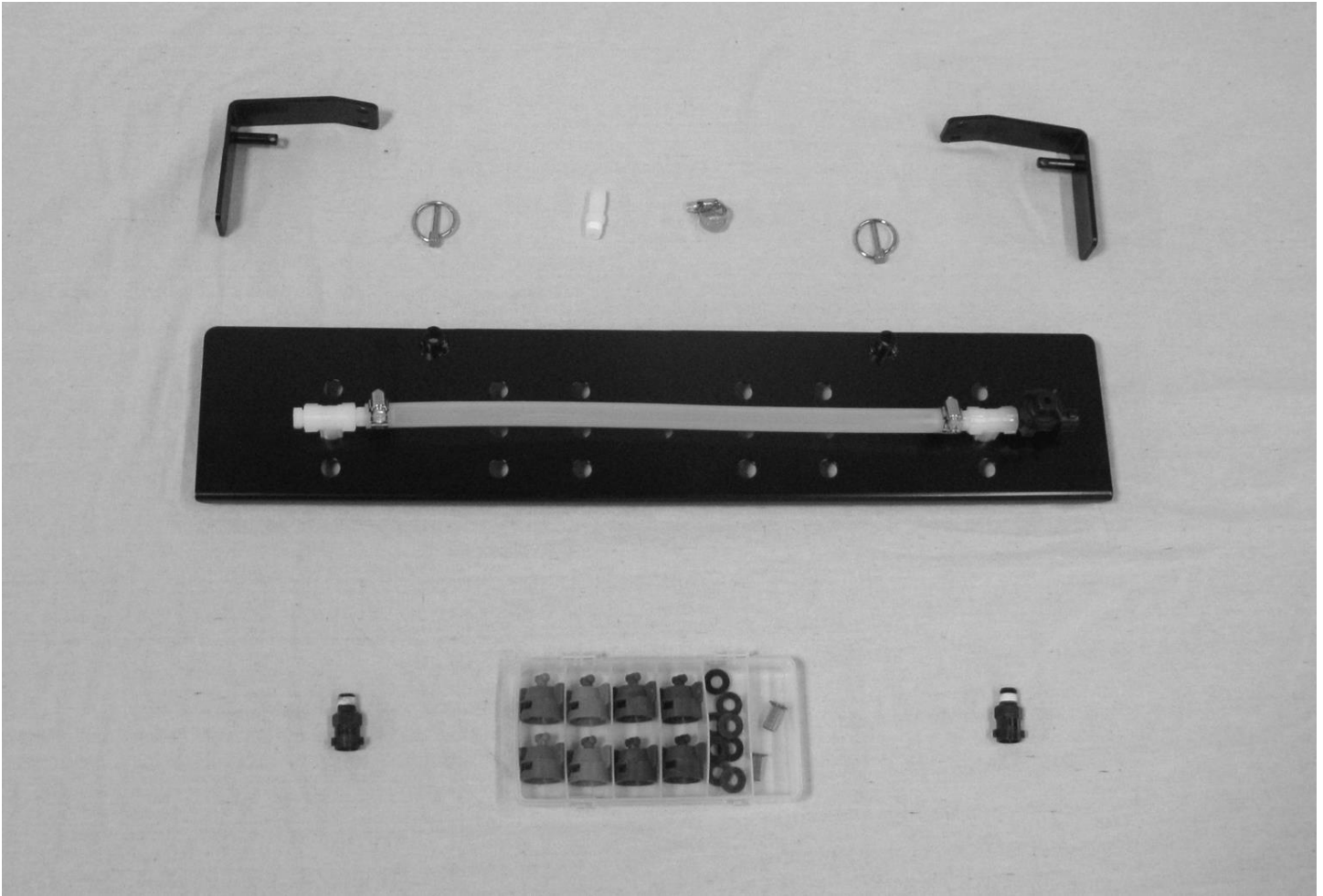

<u>Ref #</u>	<u>Description</u>	<u>Part #</u>	<u>Qty</u>	<u>Description</u>	<u>Part #</u>	<u>Qty</u>
1	Spray shield	001-4435ES	1	Tip Kit (Complete)	030-9007	1
2	Shield holder	001-4435E	2	Tip Kit Includes:		
3	Plug	003-F14	1	Plastic Box	008-9000	1
4	Hose clamp	003-9003	3	Orange cap (Orange Set)	004-1207J	2
5	Hose	002-9001	2	Tip (Orange Set)	004-TT11001VP	2
6	Straight Fitting	003-A1412	3	Green cap (Green Set)	004-1207A	2
7	Tee	003-TT14	2	Tip (Green Set)	004-TT110015VP	2
8	Check valve	004-1207V	1	Blue cap (Blue Set)	004-1207C	2
9	Nozzle body	004-4710	2	Tip (Blue Set)	004-TT11003VP	2
10	Lynch pin	008-4576	2	Brown Cap (Brown Set)	004-1207K	2
				Tip (Brown Set)	004-TT11005VP	2
				Washer	004-1207W	8
				Tip Strainer	004-1203-100	2

Harvest Tec Model 4498

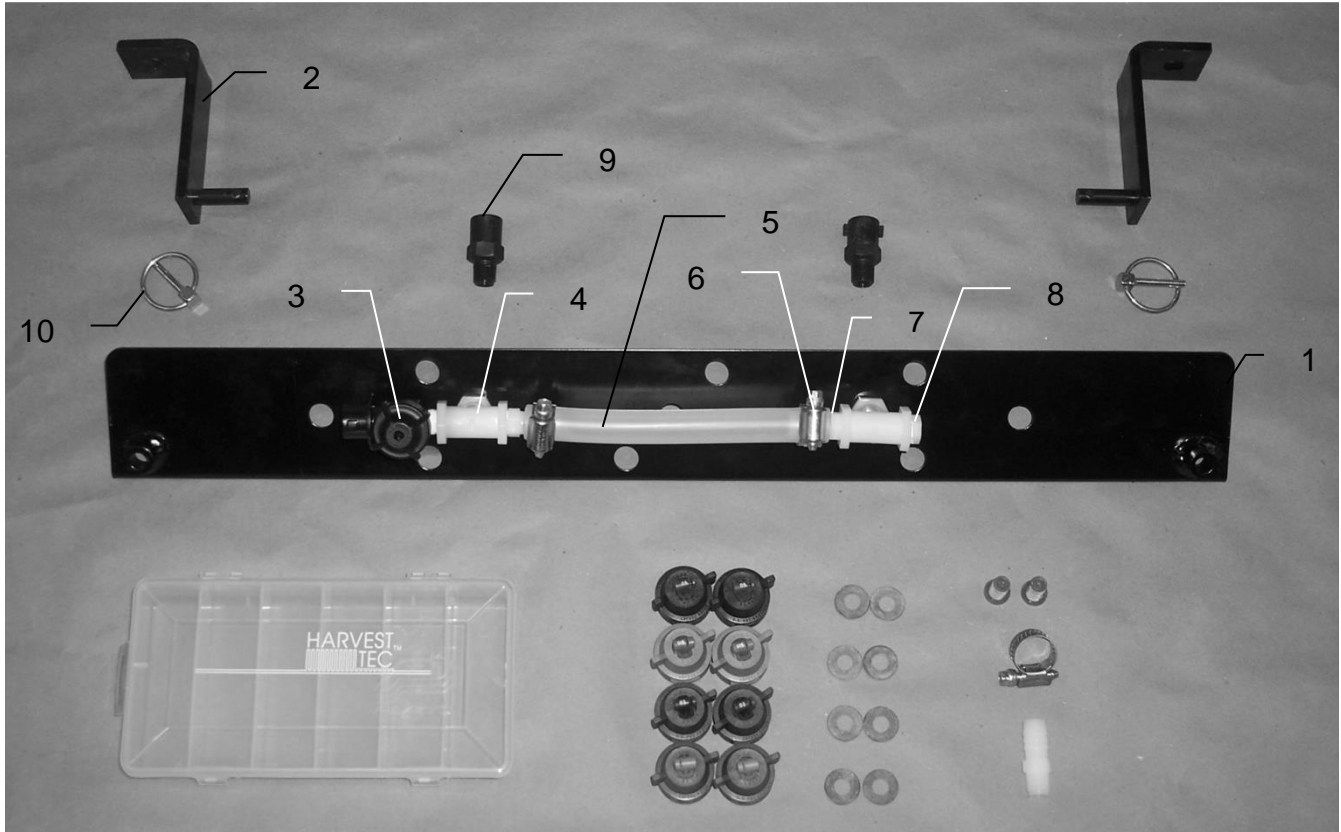

<u>Ref #</u>	<u>Description</u>	<u>Part #</u>	<u>Qty</u>	<u>Description</u>	<u>Part #</u>	<u>Qty</u>
1	Spray shield	001-4810	1	Tip Kit (Complete)	030-9007	1
2	Shield holder	001-4810A	2	Tip Kit Includes:		
3	Check valve	004-1207V	1	Plastic Box	008-9000	1
4	Tee	003-TT14	2	Orange cap (Orange Set)	004-1207J	2
5	Hose	002-9001	1	Tip (Orange Set)	004-TT11001VP	2
6	Hose clamp	003-9003	3	Green cap (Green Set)	004-1207A	2
7	Straight Fitting	003-A1412	3	Tip (Green Set)	004-TT110015VP	2
8	Plug	003-F14	1	Blue cap (Blue Set)	004-1207C	2
9	Nozzle body	004-4710	2	Tip (Blue Set)	004-TT11003VP	2
10	Lynch pin	008-4576	2	Brown Cap (Brown Set)	004-1207K	2
				Tip (Brown Set)	004-TT11005VP	2
				Washer	004-1207W	8
				Tip Strainer	004-1203-100	2

Harvest Tec Model 4499

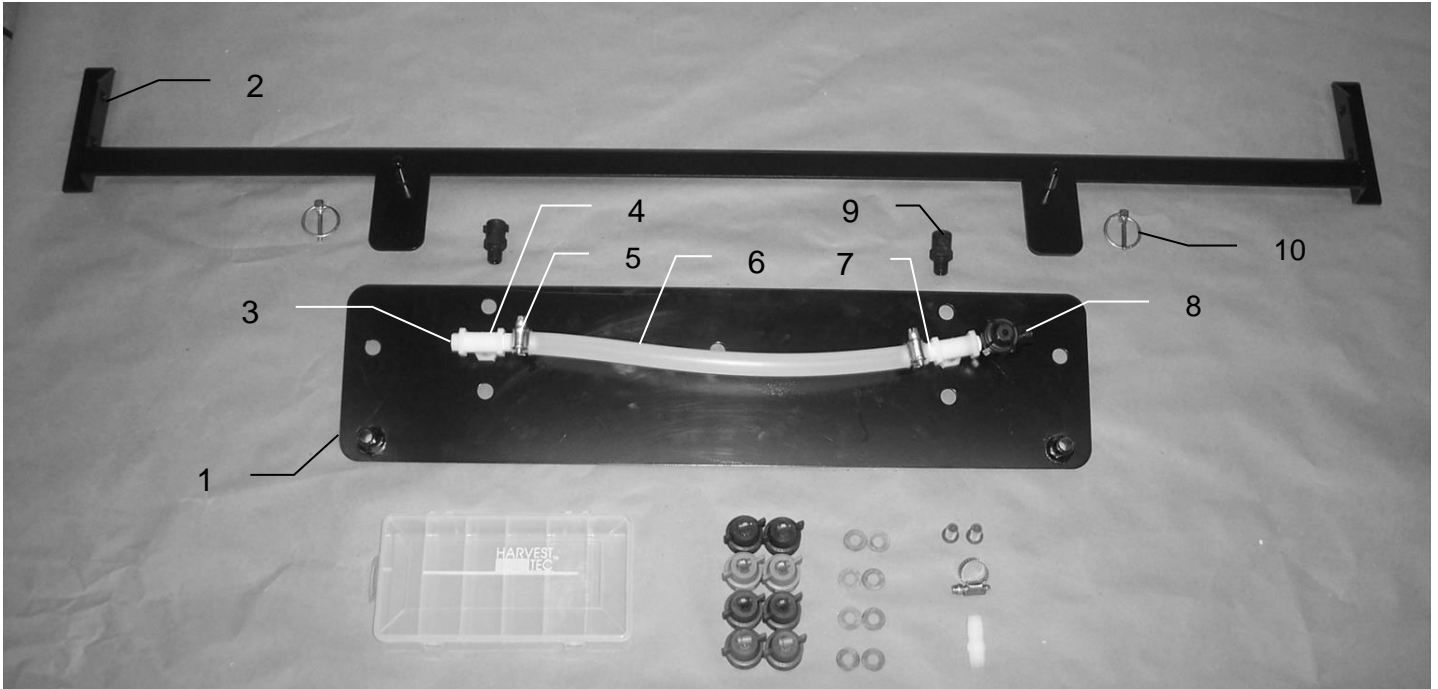

<u>Ref #</u>	<u>Description</u>	<u>Part #</u>	<u>Qty</u>	<u>Description</u>	<u>Part #</u>	<u>Qty</u>
1	Spray shield	001-4439A	1	Tip Kit (Complete)	030-9007	1
2	Shield holder	001-4440	1	Tip Kit Includes:		
3	Plug	003-F14	1	Plastic Box	008-9000	1
4	Tee	003-TT14	2	Orange cap (Orange Set)	004-1207J	2
5	Hose clamp	003-9003	3	Tip (Orange Set)	004-TT11001VP	2
6	Hose	002-9001	1	Green cap (Green Set)	004-1207A	2
7	Straight Fitting	003-A1412	3	Tip (Green Set)	004-TT110015VP	2
8	Check valve	004-1207V	1	Blue cap (Blue Set)	004-1207C	2
9	Nozzle body	004-4710	2	Tip (Blue Set)	004-TT11003VP	2
10	Lynch pin	008-4576	2	Brown Cap (Brown Set)	004-1207K	2
				Tip (Brown Set)	004-TT11005VP	2
				Washer	004-1207W	8
				Tip Strainer	004-1203-100	2

Harvest Tec Model 4500

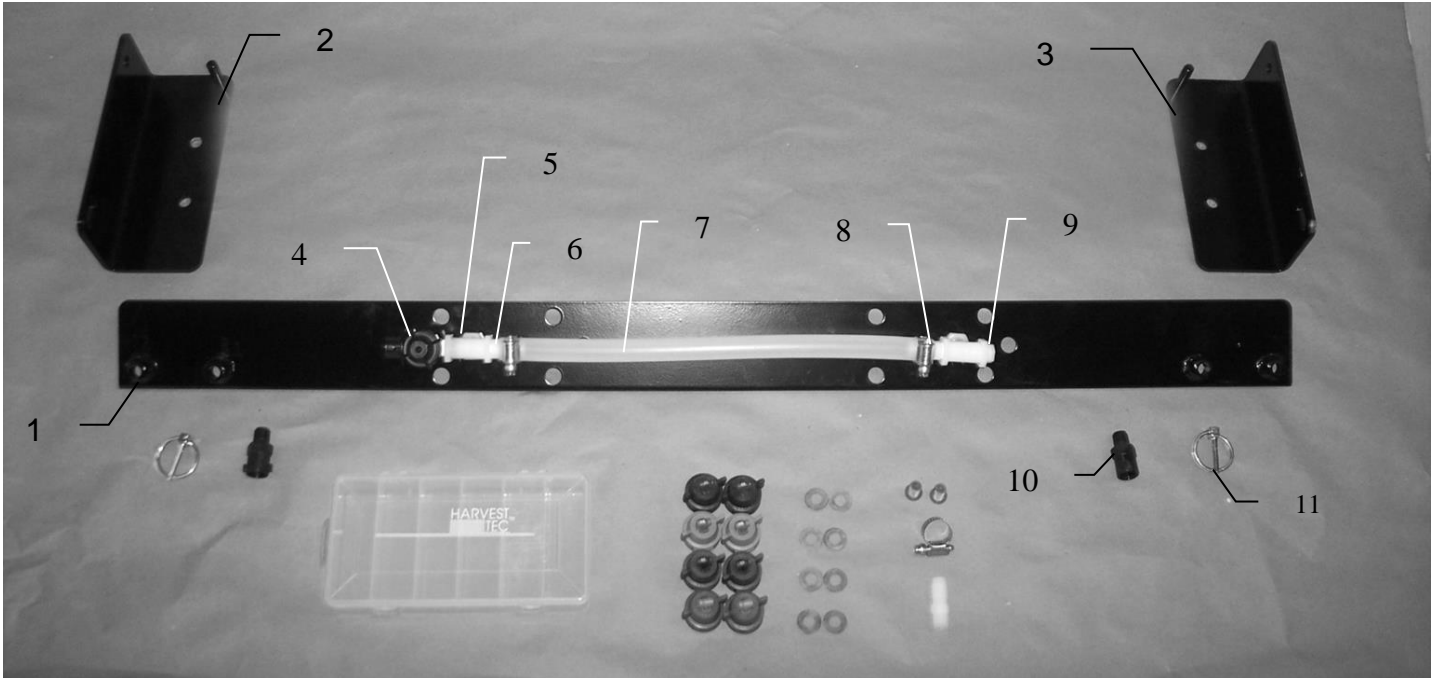

<u>Ref #</u>	<u>Description</u>	<u>Part #</u>	<u>Qty</u>	<u>Description</u>	<u>Part #</u>	<u>Qty</u>
1	Spray shield	001-4811A	1	Tip Kit (Complete)	030-9007	1
2	Shield holder	001-4436CL	1	Tip Kit Includes:		
3	Shield holder	001-4436CR	1	Plastic Box	008-9000	1
4	Check valve	004-1207V	1	Orange cap (Orange Set)	004-1207J	2
5	Tee	003-TT14	2	Tip (Orange Set)	004-TT11001VP	2
6	Straight Fitting	003-A1412	3	Green cap (Green Set)	004-1207A	2
7	Hose	002-9001	2	Tip (Green Set)	004-TT110015VP	2
8	Hose clamp	003-9003	3	Blue cap (Blue Set)	004-1207C	2
9	Plug	003-F14	1	Tip (Blue Set)	004-TT11003VP	2
10	Nozzle body	004-4710	2	Brown Cap (Brown Set)	004-1207K	2
11	Lynch pin	008-4576	2	Tip (Brown Set)	004-TT11005VP	2
				Washer	004-1207W	8
				Tip Strainer	004-1203-100	2

Harvest Tec Model 4501

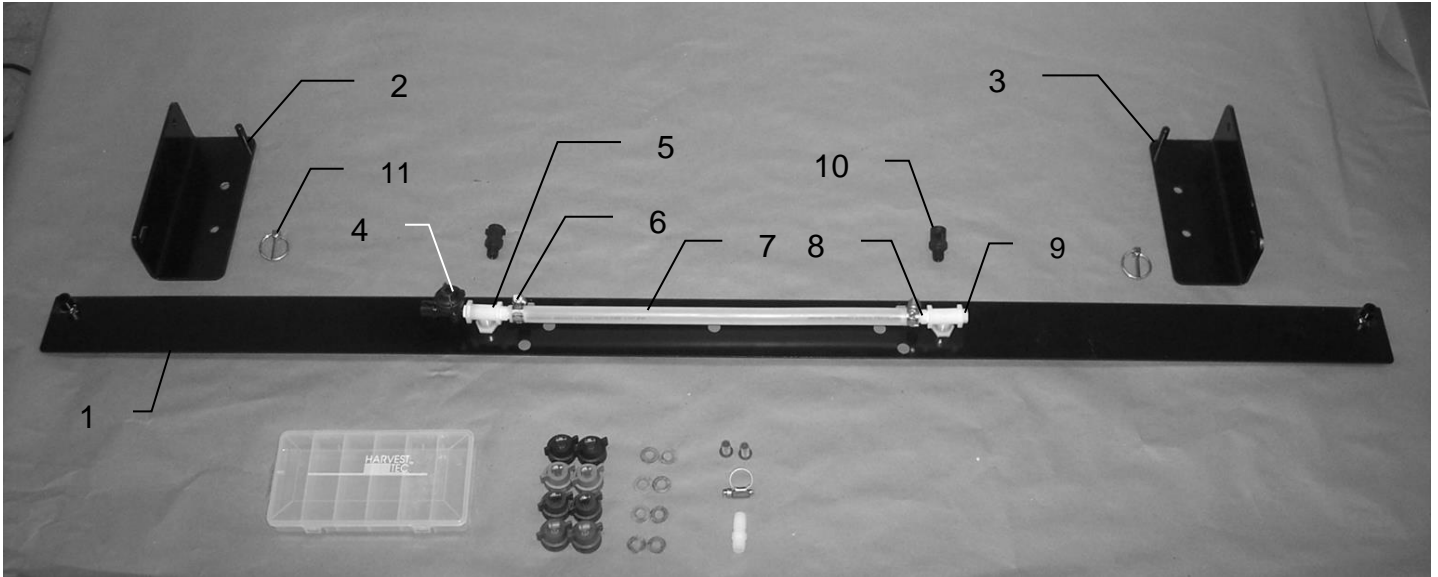

<u>Ref #</u>	<u>Description</u>	<u>Part #</u>	<u>Qty</u>	<u>Description</u>	<u>Part #</u>	<u>Qty</u>
1	Spray shield	001-4436CS	1	Tip Kit (Complete)	030-9007	1
2	Shield holder	001-4436CL	1	Tip Kit Includes:		
3	Shield holder	001-4436CR	1	Plastic Box	008-9000	1
4	Check valve	004-1207V	1	Orange cap (Orange Set)	004-1207J	2
5	Tee	003-TT14	2	Tip (Orange Set)	004-TT11001VP	2
6	Hose clamp	003-9003	3	Green cap (Green Set)	004-1207A	2
7	Hose	002-9001	2	Tip (Green Set)	004-TT110015VP	2
8	Straight Fitting	003-A1412	3	Blue cap (Blue Set)	004-1207C	2
9	Plug	003-F14	1	Tip (Blue Set)	004-TT11003VP	2
10	Nozzle body	004-4710	2	Brown Cap (Brown Set)	004-1207K	2
11	Lynch pin	008-4576	2	Tip (Brown Set)	004-TT11005VP	2
				Washer	004-1207W	8
				Tip Strainer	004-1203-100	2

Harvest Tec Model 4509

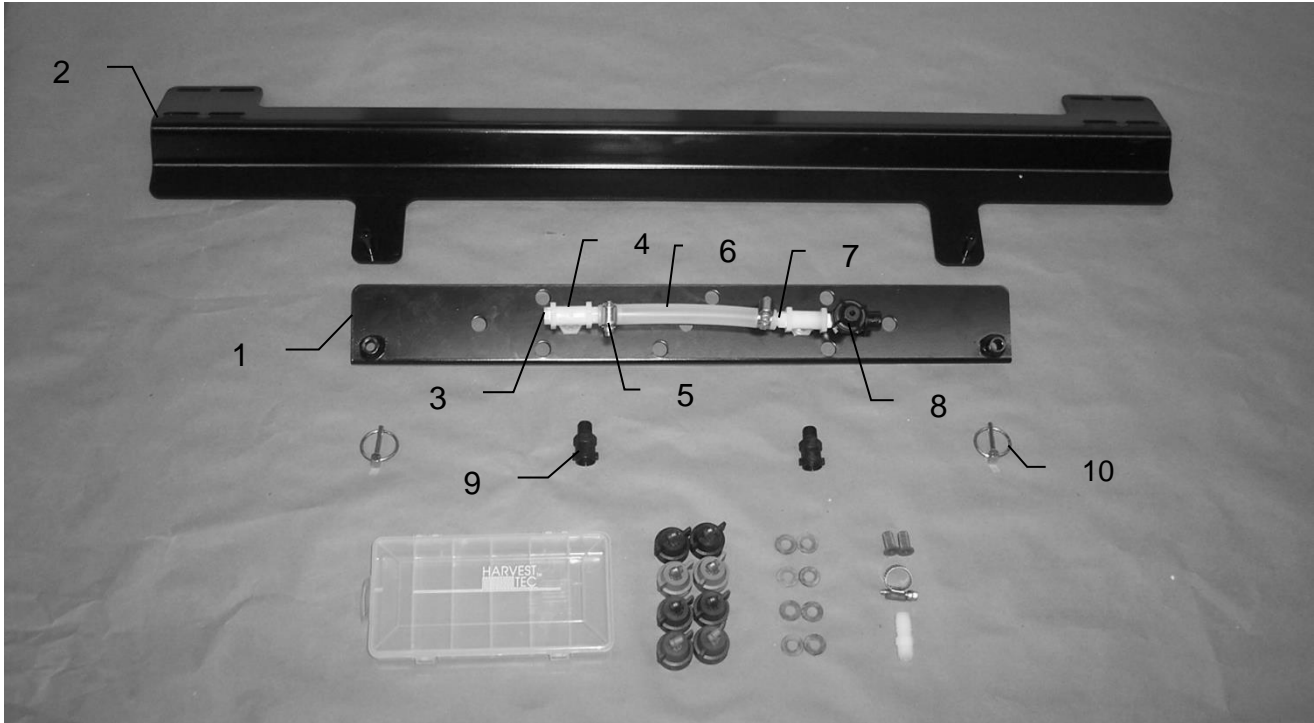

<u>Ref #</u>	<u>Description</u>	<u>Part #</u>	<u>Qty</u>	<u>Description</u>	<u>Part #</u>	<u>Qty</u>
1	Spray shield	001-4810	1	Tip Kit (Complete)	030-9007	1
2	Shield holder	001-4440A	1	Tip Kit Includes:		
3	Plug	003-F14	1	Plastic Box	008-9000	1
4	Tee	003-TT14	2	Orange cap (Orange Set)	004-1207J	2
5	Hose clamp	003-9003	3	Tip (Orange Set)	004-TT11001VP	2
6	Hose	002-9001	1	Green cap (Green Set)	004-1207A	2
7	Straight Fitting	003-A1412	3	Tip (Green Set)	004-TT110015VP	2
8	Check valve	004-1207V	1	Blue cap (Blue Set)	004-1207C	2
9	Nozzle body	004-4710	2	Tip (Blue Set)	004-TT11003VP	2
10	Lynch pin	008-4576	2	Brown Cap (Brown Set)	004-1207K	2
NP	U bolts	001-4714UBS	4	Tip (Brown Set)	004-TT11005VP	2
				Washer	004-1207W	8
				Tip Strainer	004-1203-100	2

Harvest Tec Model 4510

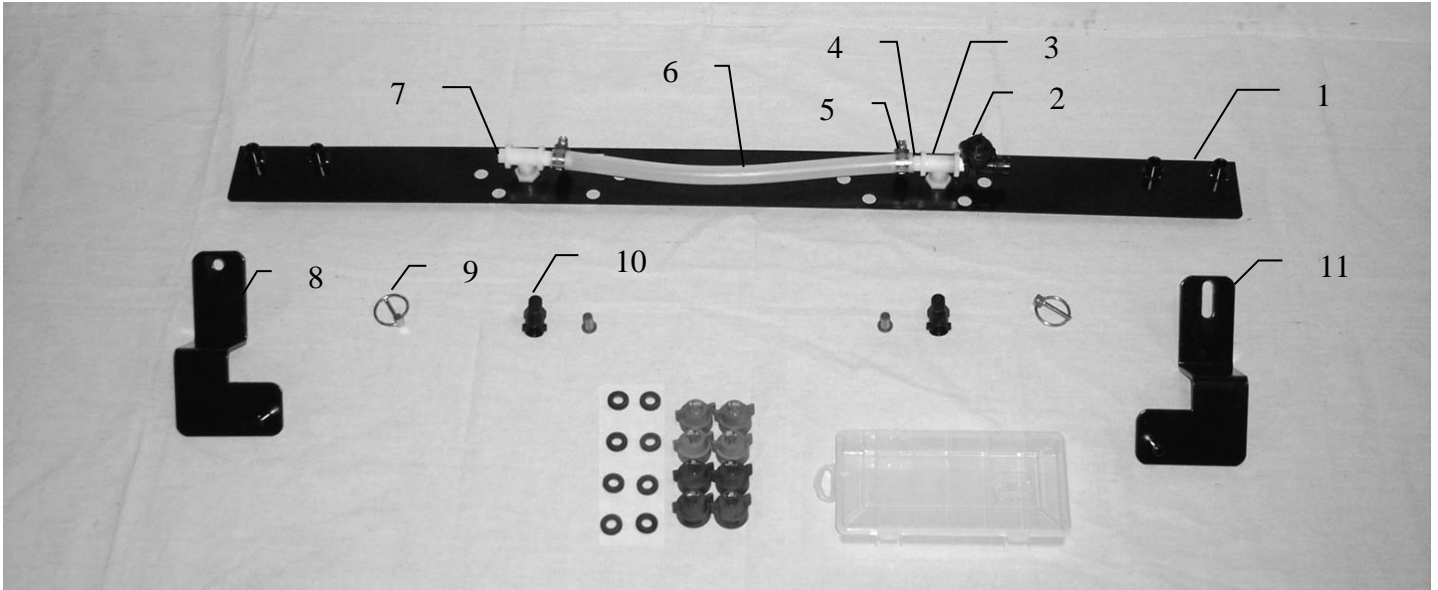

<u>Ref #</u>	<u>Description</u>	<u>Part #</u>	<u>Qty</u>	<u>Description</u>	<u>Part #</u>	<u>Qty</u>
1	Spray shield	001-4811A	1	Tip Kit (Complete)	030-9007	1
2	Check valve	004-1207V	1	Tip Kit Includes:		
3	Tee	003-TT14	2	Plastic Box	008-9000	1
4	Straight fitting	003-A1412	3	Orange cap (Orange Set)	004-1207J	2
5	Hose clamp	003-9003	3	Tip (Orange Set)	004-TT11001VP	2
6	Hose	002-9001	2	Green cap (Green Set)	004-1207A	2
7	Plug	003-F14	1	Tip (Green Set)	004-TT110015VP	2
8	Shield holder	001-4704A	1	Blue cap (Blue Set)	004-1207C	2
9	Lynch pin	008-4576	2	Tip (Blue Set)	004-TT11003VP	2
10	Nozzle body	004-4710	2	Brown Cap (Brown Set)	004-1207K	2
11	Shield holder	001-4704B	1	Tip (Brown Set)	004-TT11005VP	2
				Washer	004-1207W	8
				Tip Strainer	004-1203-100	2

Harvest Tec Model 4511

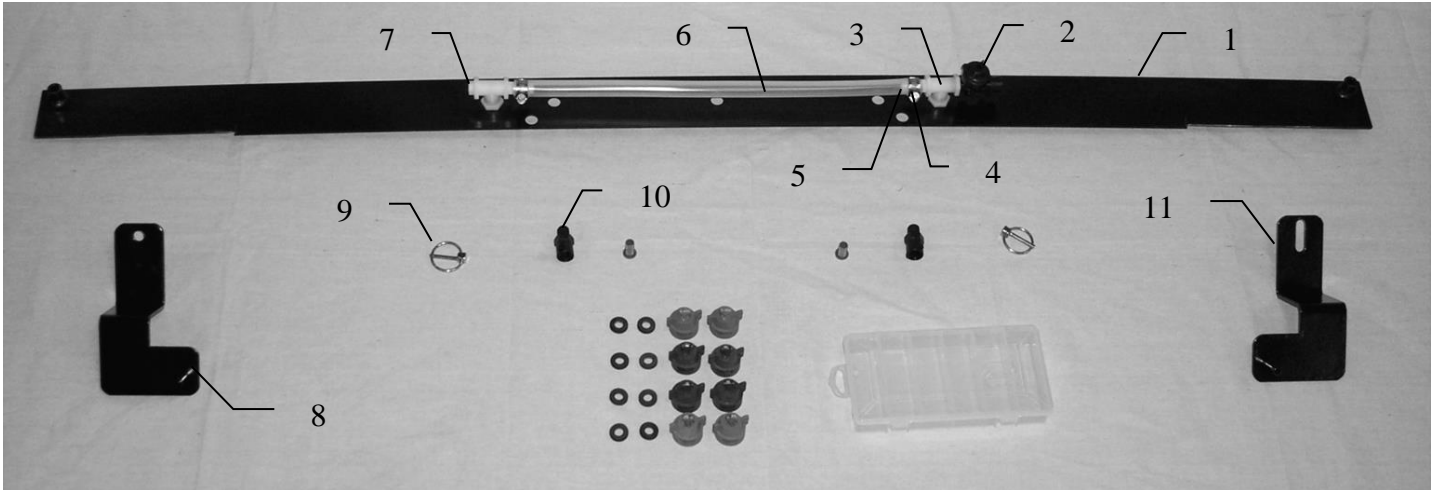

<u>Ref #</u>	<u>Description</u>	<u>Part #</u>	<u>Qty</u>	<u>Description</u>	<u>Part #</u>	<u>Qty</u>
1	Spray shield	001-4704C	1	Tip Kit (Complete)	030-9007	1
2	Check valve	004-1207V	1	Tip Kit Includes:		
3	Tee	003-TT14	2	Plastic Box	008-9000	1
4	Hose clamp	003-9003	3	Orange cap (Orange Set)	004-1207J	2
5	Straight fitting	003-A1412	3	Tip (Orange Set)	004-TT11001VP	2
6	Hose	002-9001	2	Green cap (Green Set)	004-1207A	2
7	Plug	003-F14	1	Tip (Green Set)	004-TT110015VP	2
8	Shield holder	001-4704A	1	Blue cap (Blue Set)	004-1207C	2
9	Lynch pin	008-4576	2	Tip (Blue Set)	004-TT11003VP	2
10	Nozzle body	004-4710	2	Brown Cap (Brown Set)	004-1207K	2
11	Shield holder	001-4704B	1	Tip (Brown Set)	004-TT11005VP	2
				Washer	004-1207W	8
				Tip Strainer	004-1203-100	2

Harvest Tec Model 4514

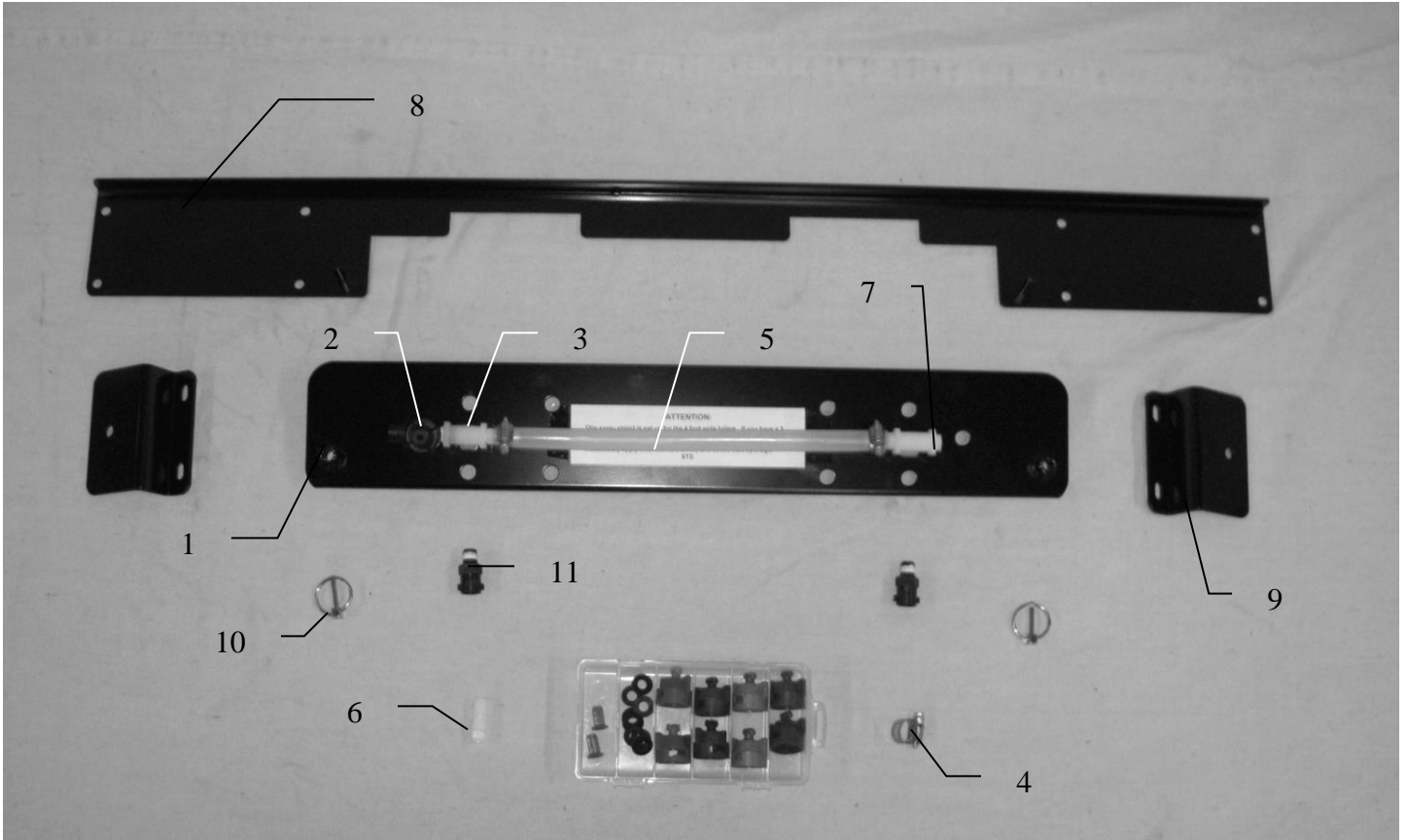

<u>Ref #</u>	<u>Description</u>	<u>Part #</u>	<u>Qty</u>	<u>Description</u>	<u>Part #</u>	<u>Qty</u>
1	Spray shield	001-4431B	1	Tip Kit (Complete)	030-9007	1
2	Check valve	004-1207V	1	Tip Kit Includes:		
3	Tee	003-TT14	2	Plastic Box	008-9000	1
4	Hose clamp	003-9003	3	Orange cap (Orange Set)	004-1207J	2
5	Hose	002-9001	2	Tip (Orange Set)	004-TT11001VP	2
6	Straight fitting	003-A1412	3	Green cap (Green Set)	004-1207A	2
7	Plug	003-F14	1	Tip (Green Set)	004-TT110015VP	2
8	Shield holder	001-4431KA	1	Blue cap (Blue Set)	004-1207C	2
9	Shield mtg bkt	001-4431KB	2	Tip (Blue Set)	004-TT11003VP	2
10	Lynch pin	008-4576	2	Brown Cap (Brown Set)	004-1207K	2
11	Nozzle body	004-4710	2	Tip (Brown Set)	004-TT11005VP	2
				Washer	004-1207W	8
				Tip Strainer	004-1203-100	2

Harvest Tec Model 4515

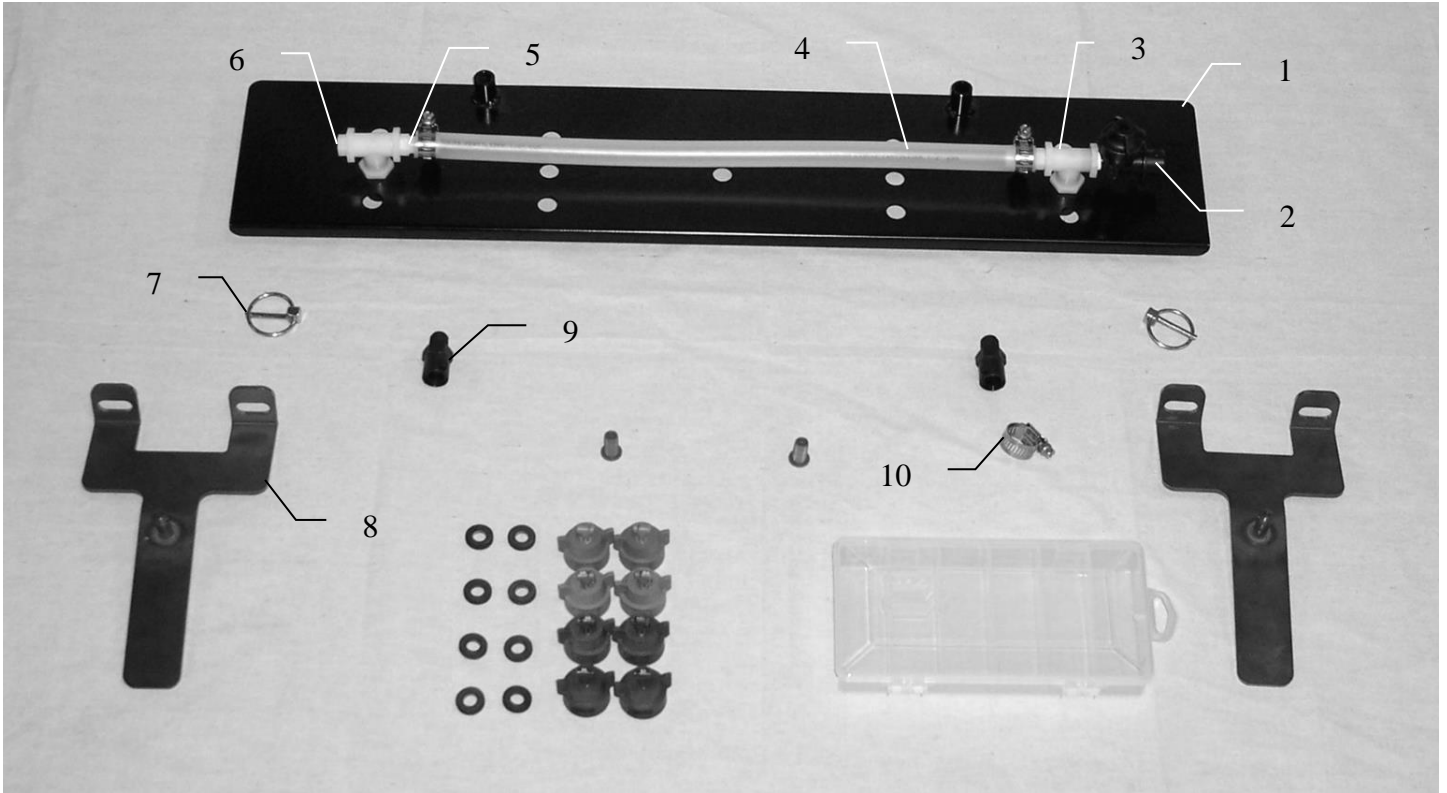

<u>Ref #</u>	<u>Description</u>	<u>Part #</u>	<u>Qty</u>	<u>Description</u>	<u>Part #</u>	<u>Qty</u>
1	Spray shield	001-4435ES	1	Tip Kit (Complete)	030-9007	1
2	Check valve	004-1207V	1	Tip Kit Includes:		
3	Tee	003-TT14	2	Plastic Box	008-9000	1
4	Hose	002-9001	2	Orange cap (Orange Set)	004-1207J	2
5	Straight fitting	003-A1412	3	Tip (Orange Set)	004-TT11001VP	2
6	Plug	003-F14	1	Green cap (Green Set)	004-1207A	2
7	Lynch pin	008-4576	2	Tip (Green Set)	004-TT110015VP	2
8	Shield holder	001-4435K	2	Blue cap (Blue Set)	004-1207C	2
9	Nozzle body	004-4710	2	Tip (Blue Set)	004-TT11003VP	2
10	Hose clamp	003-9003	3	Brown Cap (Brown Set)	004-1207K	2
				Tip (Brown Set)	004-TT11005VP	2
				Washer	004-1207W	8
				Tip Strainer	004-1203-100	2

Harvest Tec Model 4518

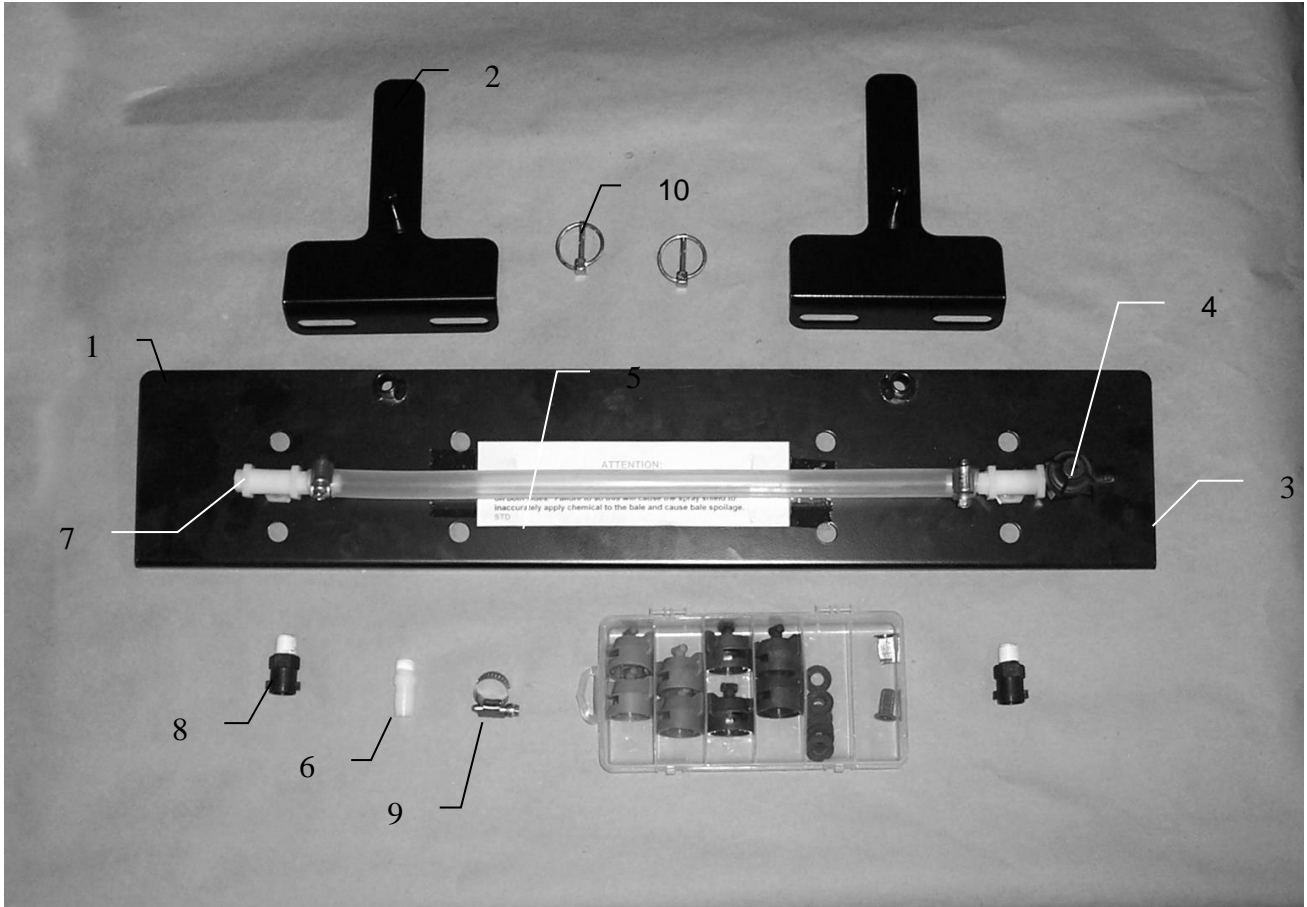

<u>Ref #</u>	<u>Description</u>	<u>Part #</u>	<u>Qty</u>	<u>Description</u>	<u>Part #</u>	<u>Qty</u>
1	Spray shield	001-4435ES	1	Tip Kit (Complete)	030-9007	1
2	Shield holder	001-4435H	2	Tip Kit Includes:		
3	Check valve	004-1207V	1	Plastic Box	008-9000	1
4	Tee	003-TT14	2	Orange cap (Orange Set)	004-1207J	2
5	Hose	002-9001	2	Tip (Orange Set)	004-TT11001VP	2
6	Straight fitting	003-A1412	2	Green cap (Green Set)	004-1207A	2
7	Plug	003-F14	1	Tip (Green Set)	004-TT110015VP	2
8	Nozzle body	004-4710	2	Blue cap (Blue Set)	004-1207C	2
9	Hose clamp	003-9003	3	Tip (Blue Set)	004-TT11003VP	2
10	Lynch pin	008-4576	2	Brown Cap (Brown Set)	004-1207K	2
				Tip (Brown Set)	004-TT11005VP	2
				Washer	004-1207W	8
				Tip Strainer	004-1203-100	2

Harvest Tec Model 4519

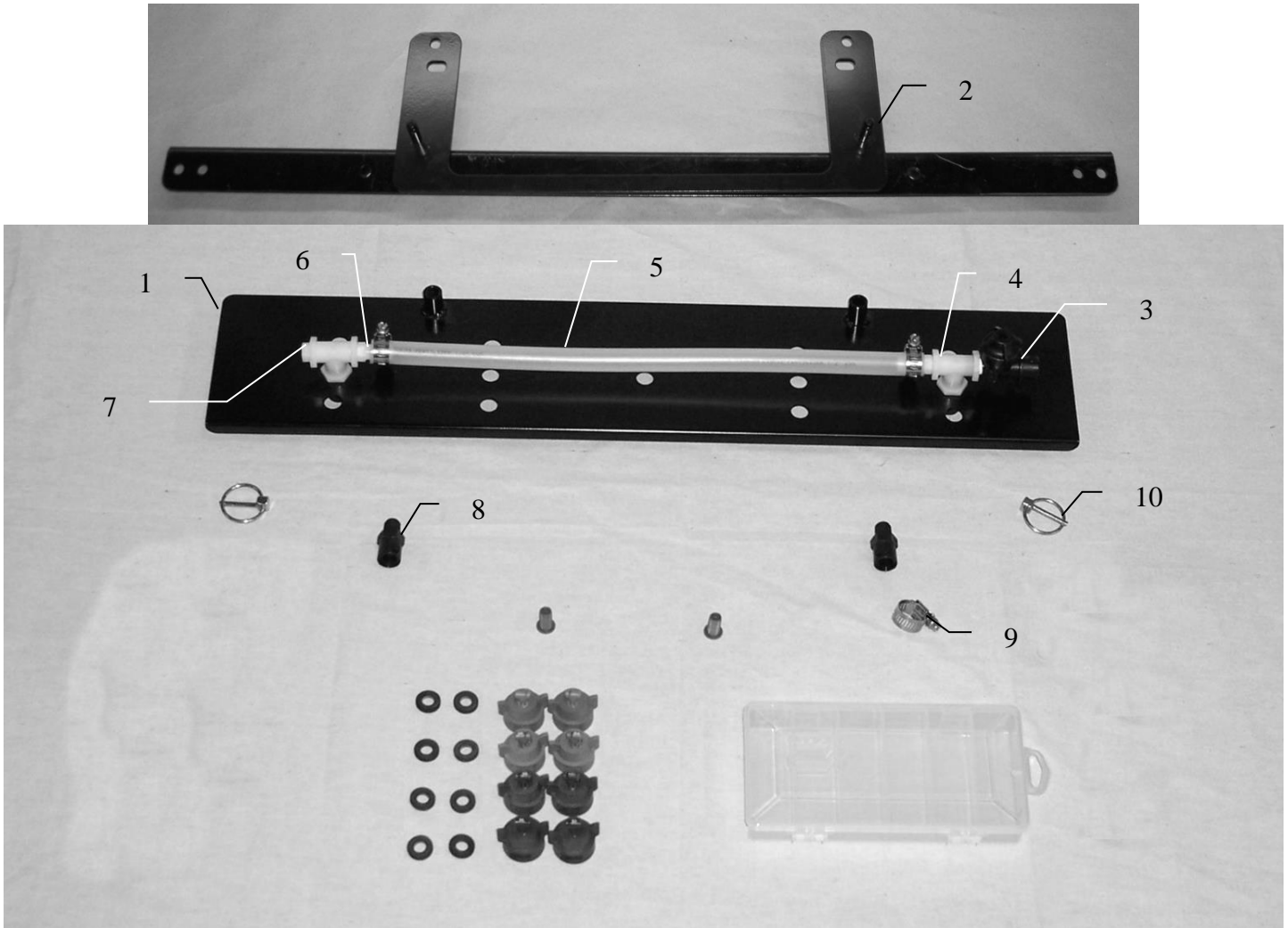

<u>Ref #</u>	<u>Description</u>	<u>Part #</u>	<u>Qty</u>	<u>Description</u>	<u>Part #</u>	<u>Qty</u>
1	Spray shield	001-4435AS	1	Tip Kit (Complete)	030-9007	1
2	Shield holder	001-4435J	1	Tip Kit Includes:		
3	Check valve	004-1207V	1	Plastic Box	008-9000	1
4	Tee	003-TT14	2	Orange cap (Orange Set)	004-1207J	2
5	Hose	002-9001	2	Tip (Orange Set)	004-TT11001VP	2
6	Straight fitting	003-A1412	2	Green cap (Green Set)	004-1207A	2
7	Plug	003-F14	1	Tip (Green Set)	004-TT110015VP	2
8	Nozzle body	004-4710	2	Blue cap (Blue Set)	004-1207C	2
9	Hose clamp	003-9003	3	Tip (Blue Set)	004-TT11003VP	2
10	Lynch pin	008-4576	2	Brown Cap (Brown Set)	004-1207K	2
				Tip (Brown Set)	004-TT11005VP	2
				Washer	004-1207W	8
				Tip Strainer	004-1203-100	2

Harvest Tec Model 4525

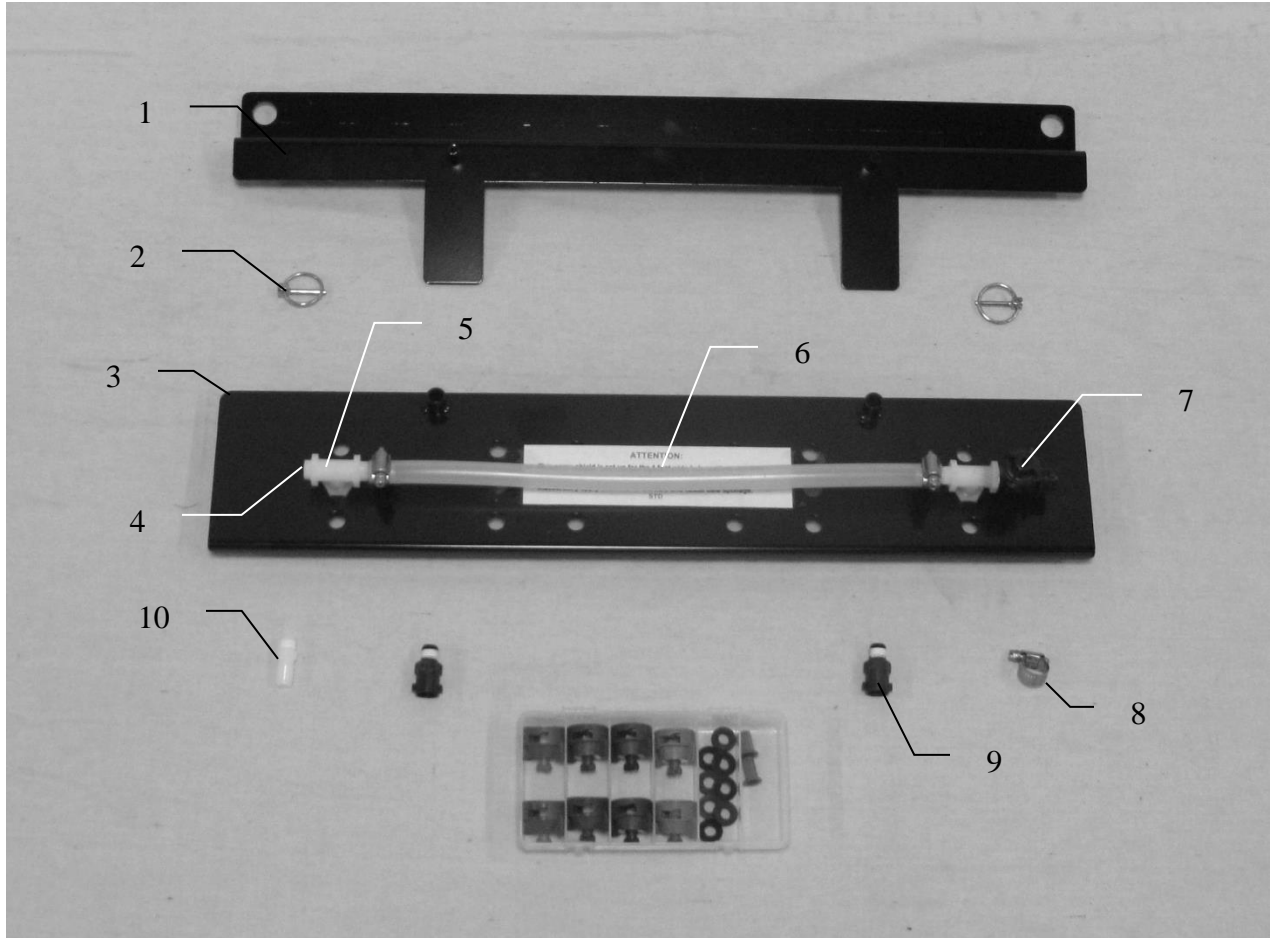

<u>Ref #</u>	<u>Description</u>	<u>Part #</u>	<u>Qty</u>	<u>Description</u>	<u>Part #</u>	<u>Qty</u>
1	Shield holder	001-4435EK	1	Tip Kit (Complete)	030-9007	1
2	Lynch pin	008-4576	2	Tip Kit Includes:		
3	Spray shield	001-4435ES	1	Plastic Box	008-9000	1
4	Plug	003-F14	1	Orange cap (Orange Set)	004-1207J	2
5	Tee	003-TT14	2	Tip (Orange Set)	004-TT11001VP	2
6	Hose	002-9001	2	Green cap (Green Set)	004-1207A	2
7	Check valve	004-1207V	1	Tip (Green Set)	004-TT110015VP	2
8	Hose clamp	003-9003	3	Blue cap (Blue Set)	004-1207C	2
9	Nozzle body	004-4710	2	Tip (Blue Set)	004-TT11003VP	2
10	Straight fitting	003-A1412	2	Brown Cap (Brown Set)	004-1207K	2
				Tip (Brown Set)	004-TT11005VP	2
				Washer	004-1207W	8
				Tip Strainer	004-1203-100	2

Harvest Tec Model 4525J

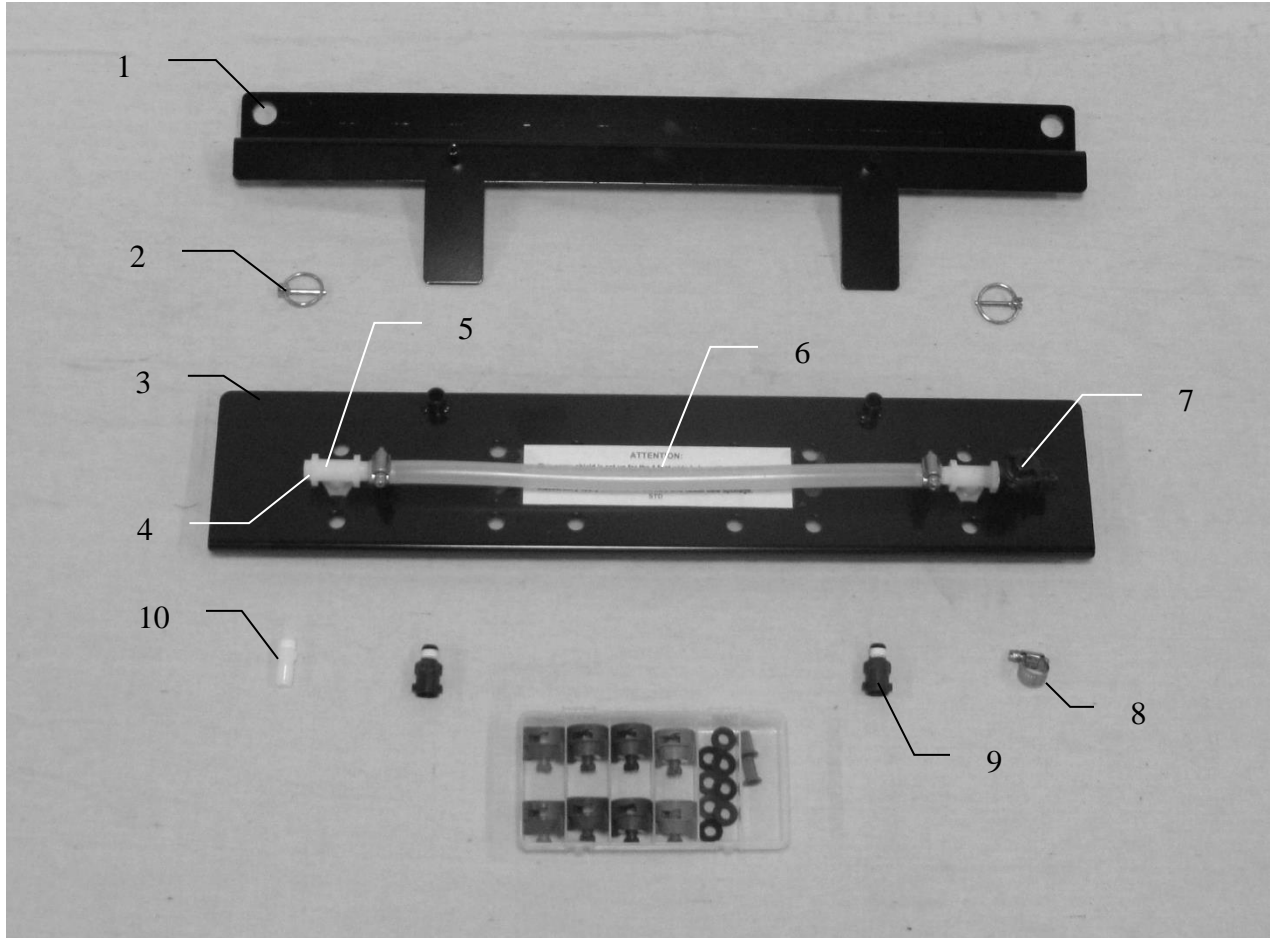

<u>Ref #</u>	<u>Description</u>	<u>Part #</u>	<u>Qty</u>	<u>Description</u>	<u>Part #</u>	<u>Qty</u>
1	Shield holder	001-4435EJ	1	Tip Kit (Complete)	030-9007	
2	Lynch pin	008-4576	2	Tip Kit Includes:		
3	Spray shield	001-4435ES	1	Plastic Box	008-9000	1
4	Hex Plug	003-F14	1	Orange cap (Orange Set)	004-1207J	2
5	Tee	003-TT14	2	Tip (Orange Set)	004-TT11001VP	2
6	Hose	002-9001	1.5ft	Green cap (Green Set)	004-1207A	2
7	Check valve	004-1207V	1	Tip (Green Set)	004-TT110015VP	2
8	Hose clamp	003-9003	3	Blue cap (Blue Set)	004-1207C	2
9	Nozzle body	004-4710	2	Tip (Blue Set)	004-TT11003VP	2
10	Straight fitting	003-A1412	3	Brown Cap (Brown Set)	004-1207K	2
				Tip (Brown Set)	004-TT11005VP	2
				Washer	004-1207W	8
				Tip Strainer	004-1203-100	2

Harvest Tec Model 4527

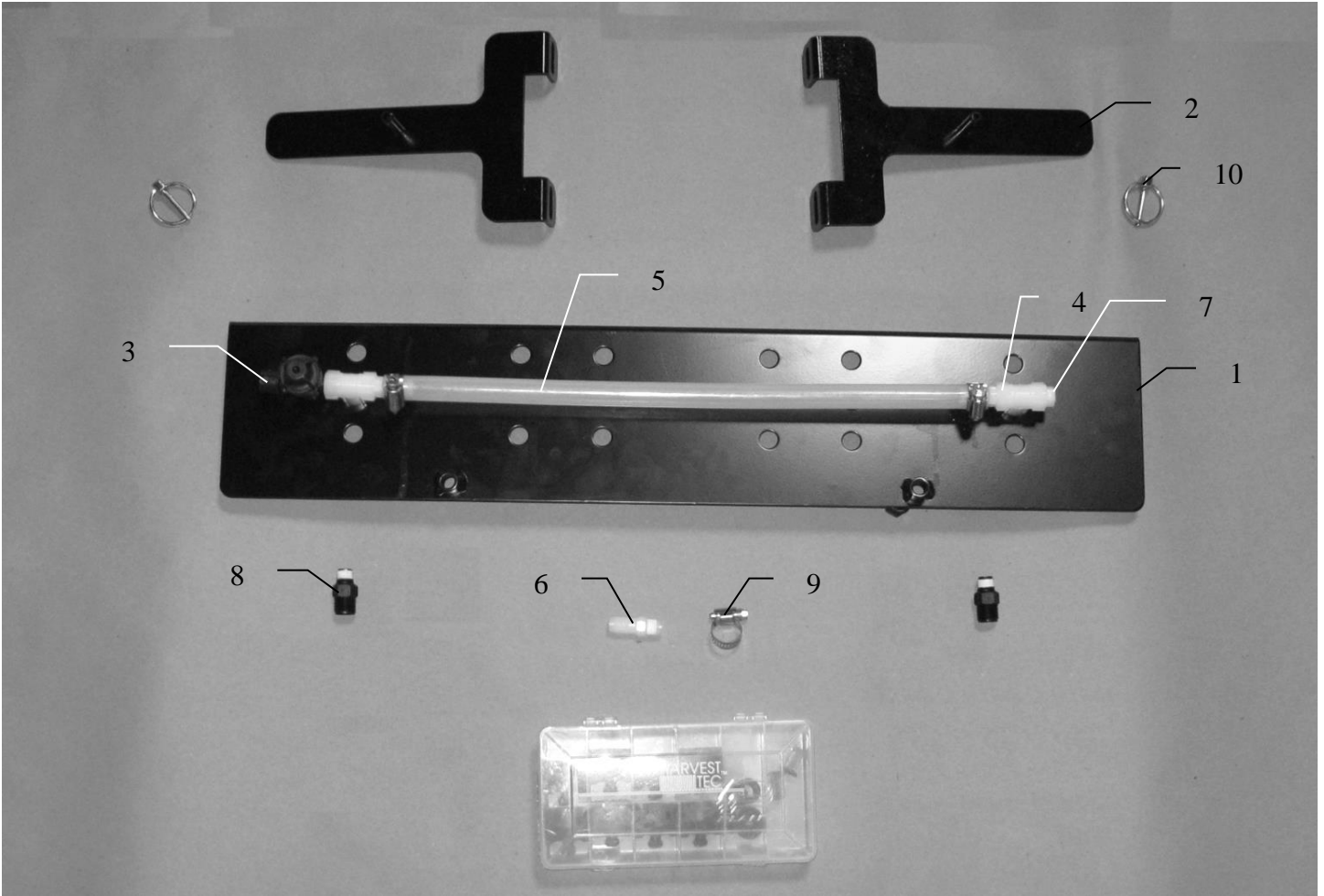

<u>Ref #</u>	<u>Description</u>	<u>Part #</u>	<u>Qty</u>	<u>Description</u>	<u>Part #</u>	<u>Qty</u>
1	Spray shield	001-4435ES	1	Tip Kit (Complete)	030-9007	1
2	Shield holder	001-4435HPC	2	Tip Kit Includes:		
3	Check valve	004-1207V	1	Plastic Box	008-9000	1
4	Tee	003-TT14	2	Orange cap (Orange Set)	004-1207J	2
5	Hose	002-9001	2	Tip (Orange Set)	004-TT11001VP	2
6	Straight fitting	003-A1412	2	Green cap (Green Set)	004-1207A	2
7	Plug	003-F14	1	Tip (Green Set)	004-TT110015VP	2
8	Nozzle body	004-4710	2	Blue cap (Blue Set)	004-1207C	2
9	Hose clamp	003-9003	3	Tip (Blue Set)	004-TT11003VP	2
10	Lynch pin	008-4576	2	Brown Cap (Brown Set)	004-1207K	2
				Tip (Brown Set)	004-TT11005VP	2
				Washer	004-1207W	8
				Tip Strainer	004-1203-100	2

Harvest Tec Model 4530

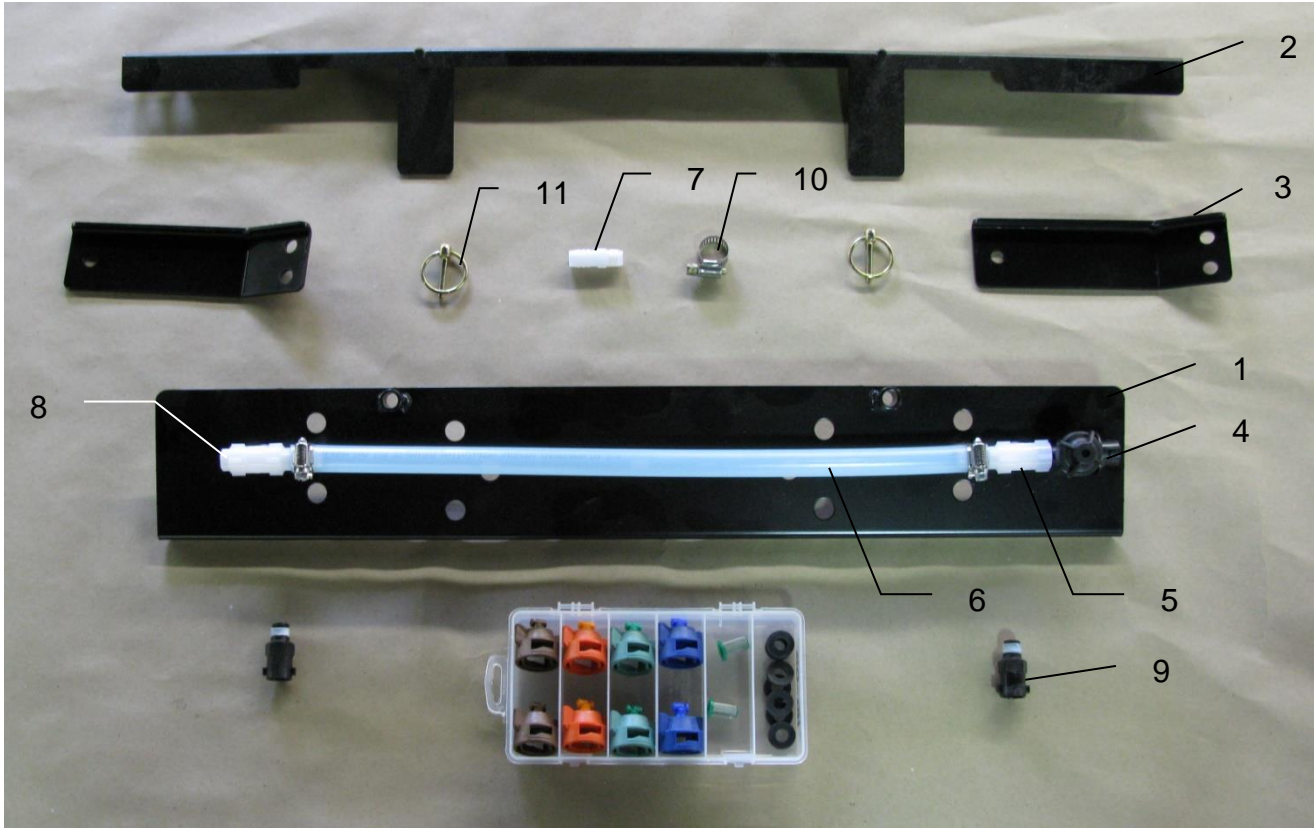

<u>Ref #</u>	<u>Description</u>	<u>Part #</u>	<u>Qty</u>	<u>Description</u>	<u>Part #</u>	<u>Qty</u>
1	Spray shield	001-4435AS	1	Tip Kit (Complete)	030-9007	1
2	Shield holder	001-4435XA	1	Tip Kit Includes:		
3	Mounting brackets	001-4435XB	2	Plastic Box	008-9000	1
4	Check valve	004-1207V	1	Orange cap (Orange Set)	004-1207J	2
5	Tee	003-TT14	2	Tip (Orange Set)	004-TT11001VP	2
6	Hose	002-9001	2	Green cap (Green Set)	004-1207A	2
7	Straight fitting	003-A1412	2	Tip (Green Set)	004-TT110015VP	2
8	Plug	003-F14	1	Blue cap (Blue Set)	004-1207C	2
9	Nozzle body	004-4710	2	Tip (Blue Set)	004-TT11003VP	2
10	Hose clamp	003-9003	3	Brown Cap (Brown Set)	004-1207K	2
11	Lynch pin	008-4576	2	Tip (Brown Set)	004-TT11005VP	2
				Washer	004-1207W	8
				Tip Strainer	004-1203-100	2

Harvest Tec Model 4539

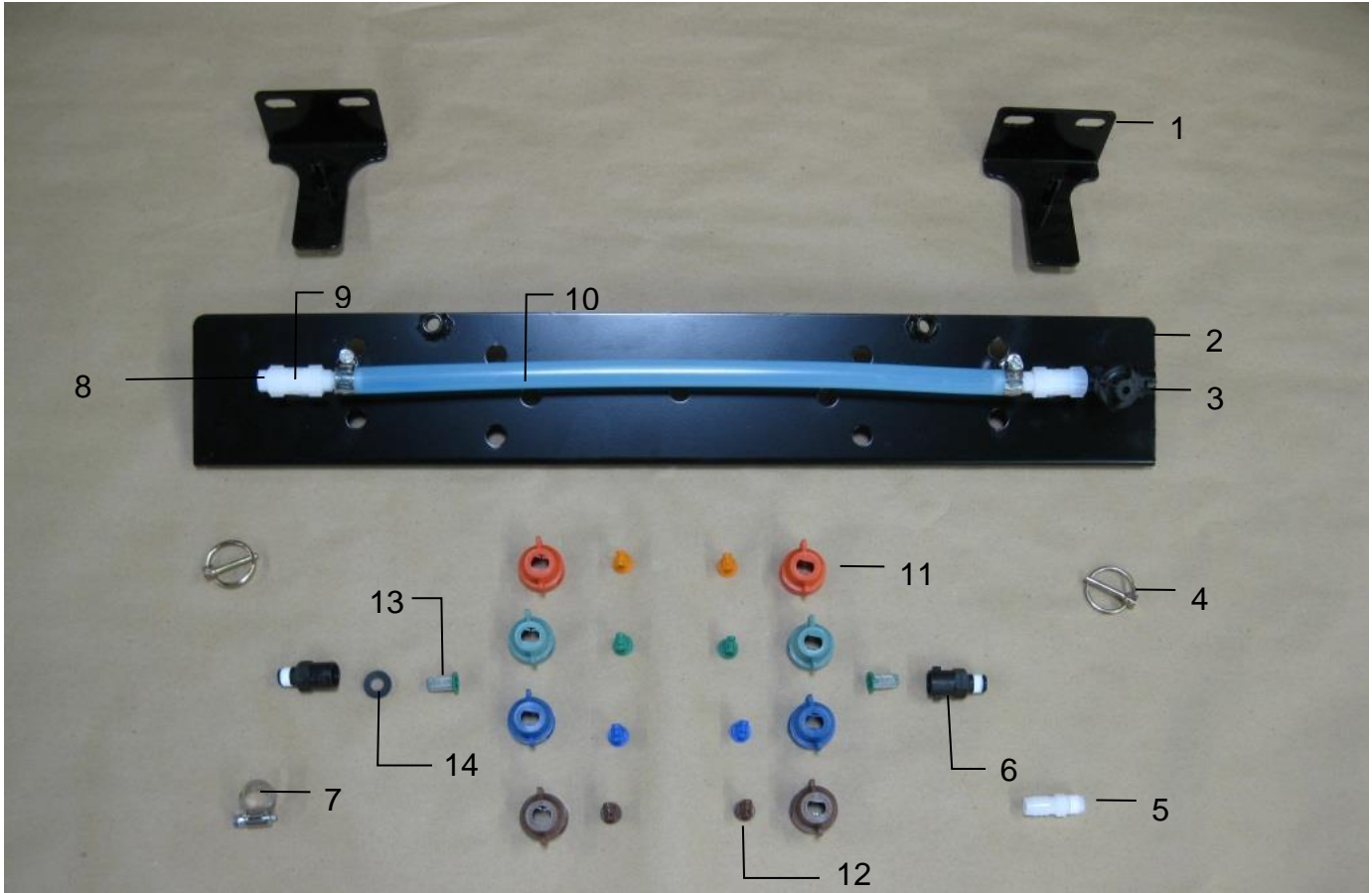

<u>Ref</u>	<u>Description</u>	<u>Part #</u>	<u>Qty</u>	<u>Ref</u>	<u>Description</u>	<u>Part #</u>	<u>Qty</u>
1	Shield Holders	001-4435KX	2		Tip Kit (Complete)	030-9007	1
2	Spray Shield	001-4435AS	1		Tip Kit Includes:		
3	Check Valve	004-1207V	1	11	Orange cap (Orange Set)	004-1207J	2
4	Lynch Pins	008-4576	2		Green cap (Green Set)	004-1207A	2
5	Straight Fitting	003-A1412	3		Blue cap (Blue Set)	004-1207C	2
6	Nozzle Body	004-4710	2		Brown Cap (Brown Set)	004-1207K	2
7	Hose Clamp	003-9003	3	12	Tip (Orange Set)	004-TT11001VP	2
8	Hex Plug	003-F14	2		Tip (Green Set)	004-TT110015VP	2
9	Tee Fitting	003-TT14	2		Tip (Blue Set)	004-TT11003VP	2
10	1/2" Hose	002-9001	2 ft		Tip (Brown Set)	004-TT11005VP	2
				13	Tip Strainer	004-1203-100	2
				14	Washer	004-1207W	8
				NP	Plastic Box	008-9000	1

Harvest Tec Model 4540

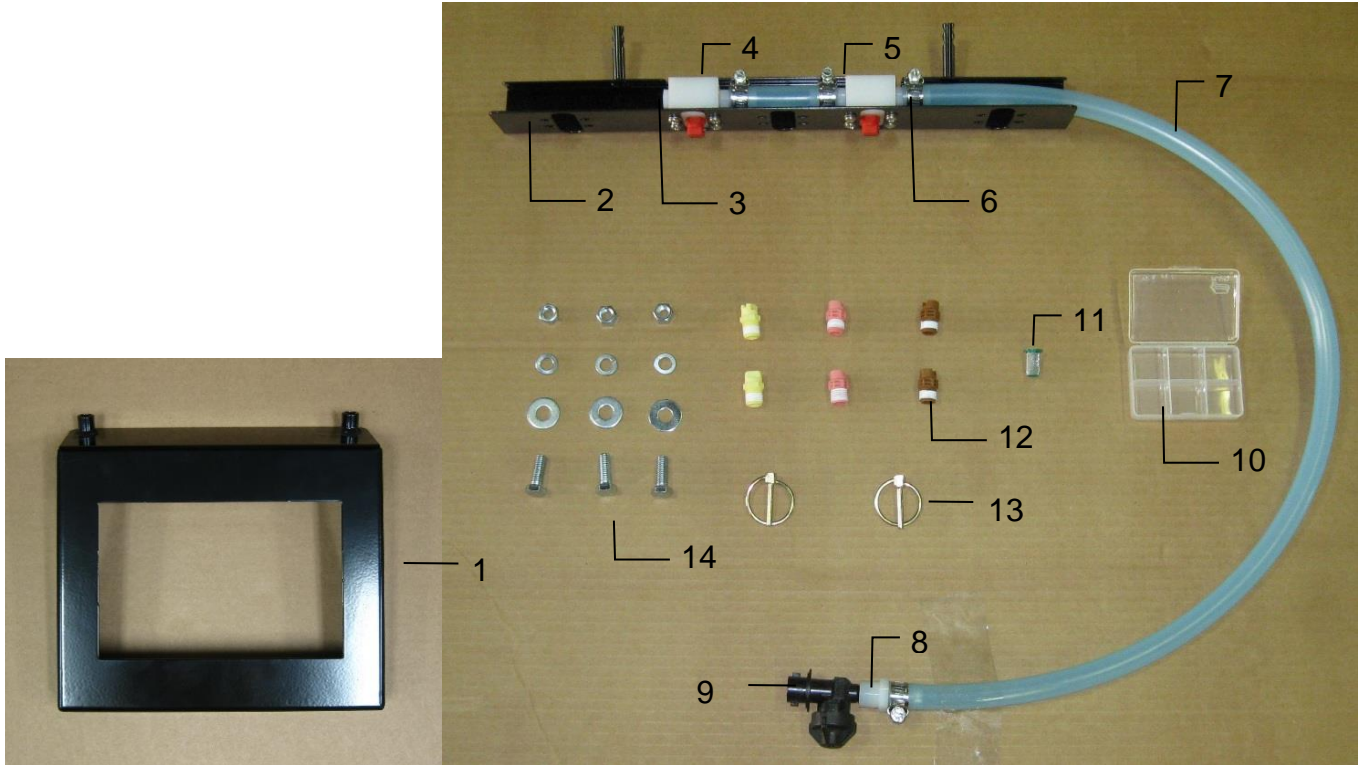

<u>Ref</u>	<u>Description</u>	<u>Part #</u>	<u>Qty</u>	<u>Ref</u>	<u>Description</u>	<u>Part #</u>	<u>Qty</u>
1	Shield Holder	001-4435KC	1	10	Plano Box	008-9001	1
2	Spray Shield	001-4435NSX	1	11	Strainer	004-1203-100	1
3	Hex Plug	003-F14	1	12	Tip (Pink)	004-T8001-PT	2
4	Manifold Block	001-4435NSB	2		Tip (Red)	004-T8003-PT	2
5	Straight Fitting	003-A1412	3		Tip (Yellow)	004-T8005-PT	2
6	Hose Clamp	003-9003	4		Tip (Brown)	004-T80015-PT	2
7	Hose	002-9001	4 ft	13	Lynch Pin	008-4576	2
8	Straight Fitting	003-A1412F	1	14	Hardware		
9	Check Valve	004-1207V	1				

Harvest Tec Model 4541

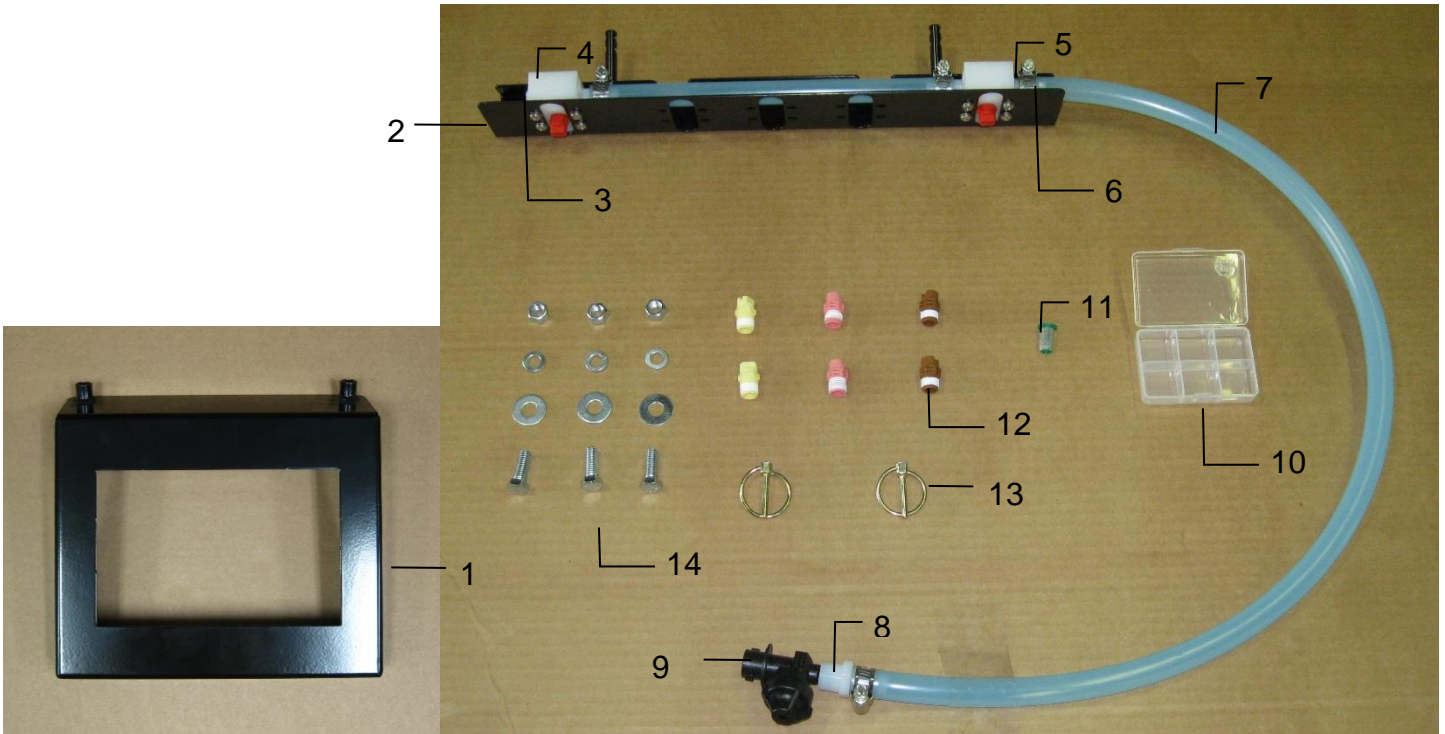

<u>Ref</u>	<u>Description</u>	<u>Part #</u>	<u>Qty</u>	<u>Ref</u>	<u>Description</u>	<u>Part #</u>	<u>Qty</u>
1	Shield Holder	001-4435KC	1	10	Plano Box	008-9001	1
2	Spray Shield	001-4435NSX	1	11	Strainer	004-1203-100	1
3	Hex Plug	003-F14	1	12	Tip (Pink)	004-T8001-PT	2
4	Manifold Block	001-4435NSB	2		Tip (Red)	004-T8003-PT	2
5	Straight Fitting	003-A1412	3		Tip (Yellow)	004-T8005-PT	2
6	Hose Clamp	003-9003	4		Tip (Brown)	004-T80015-PT	2
7	Hose	002-9001	5 ft	13	Lynch Pin	008-4576	2
8	Straight Fitting	003-A1412F	1	14	Hardware		
9	Check Valve	004-1207V	1				

Harvest Tec Model 4542

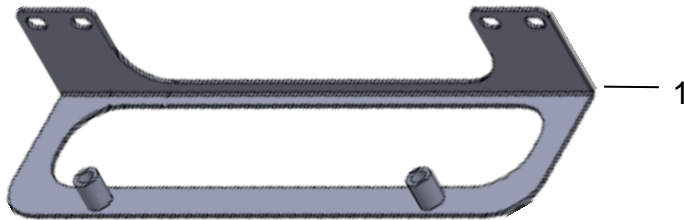
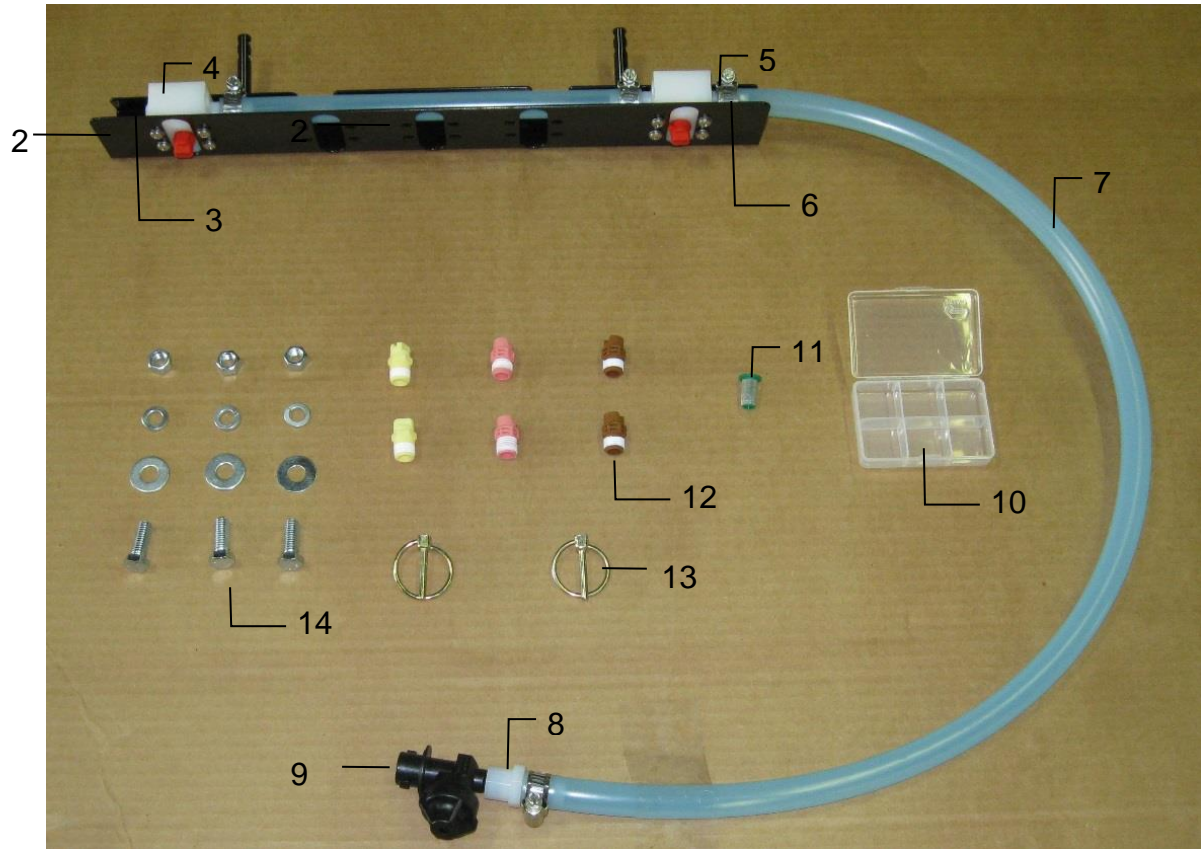

<u>Ref</u>	<u>Description</u>	<u>Part #</u>	<u>Qty</u>	<u>Ref</u>	<u>Description</u>	<u>Part #</u>	<u>Qty</u>
1	Shield Holder	001-4435NAX	1	10	Plano Box	008-9001	1
2	Spray Shield	001-4435NSB	1	11	Strainer	004-1203-100	1
3	Hex Plug	003-F14	1	12	Tip (Pink)	004-T8001-PT	2
4	Manifold Block	001-4435NSB	2		Tip (Red)	004-T8003-PT	2
5	Straight Fitting	003-A1412	3		Tip (Yellow)	004-T8005-PT	2
6	Hose Clamp	003-9003	4		Tip (Brown)	004-T80015-PT	2
7	Hose	002-9001	4 ft	13	Lynch Pin	008-4576	2
8	Straight Fitting	003-A1412F	1	14	Hardware		
9	Check Valve	004-1207V	1				

Harvest Tec Inc. Warranty and Liability Agreement

Harvest Tec, Inc. will repair or replace components that are found to be defective within 12 months from the date of manufacture. Under no circumstances does this warranty cover any components which in the opinion of Harvest Tec, Inc. have been subjected to negligent use, misuse, alteration, accident, or if repairs have been made with parts other than those manufactured and obtainable from Harvest Tec, Inc.

Our obligation under this warranty is limited to repairing or replacing free of charge to the original purchaser any part that in our judgment shows evidence of defective or improper workmanship, provided the part is returned to Harvest Tec, Inc. within 30 days of the failure. If it is determined that a non-Harvest Tec branded hay preservative has been used inside the Harvest Tec applicator system where the failure occurred, then Harvest Tec reserves the right to deny the warranty request at their discretion. Parts must be returned through the selling dealer and distributor, transportation charges prepaid.

This warranty shall not be interpreted to render Harvest Tec, Inc. liable for injury or damages of any kind, direct, consequential, or contingent, to persons or property. Furthermore, this warranty does not extend to loss of crop, losses caused by delays or any expense prospective profits or for any other reason. Harvest Tec, Inc. shall not be liable for any recovery greater in amount than the cost or repair of defects in workmanship.

There are no warranties, either expressed or implied, of merchantability or fitness for particular purpose intended or fitness for any other reason.

This warranty cannot guarantee that existing conditions beyond the control of Harvest Tec, Inc. will not affect our ability to obtain materials or manufacture necessary replacement parts.

Harvest Tec, Inc. reserves the right to make design changes, improve design, or change specifications, at any time without any contingent obligation to purchasers of machines and parts previously sold.

Revised 4/17

HARVEST TEC, INC.
P.O. BOX 63
2821 HARVEY STREET
HUDSON, WI 54016
PHONE: 715-386-9100
1-800-635-7468
FAX: 715-381-1792