

MODEL 436 DRAIN/FILL KIT, CONTROL BOX, & INSTALLATION KIT

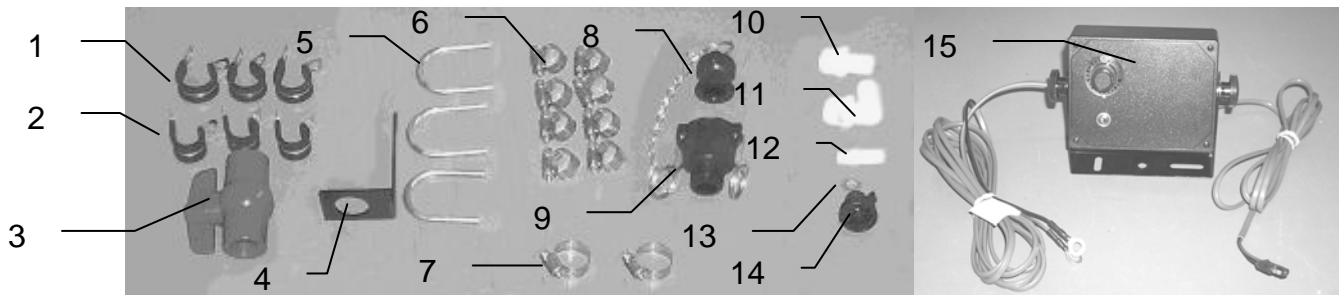

<u>Ref</u>	<u>Description</u>	<u>Part #</u>	<u>Qty</u>	<u>Ref</u>	<u>Description</u>	<u>Part #</u>	<u>Qty</u>
1	Jiffy clip-large	008-9009	3	8	Male shut-off	002-2205G	1
2	Jiffy clip-small	008-9010	3	9	Female coupler	002-2204A	1
3	Ball valve	002-2200	1	10	Straight fitting	003-A3434	1
4	Valve bracket	001-6702H	1	11	Elbow fitting	003-EL3434	1
5	U-bolt – small	001-4714UBS	2	12	Straight fitting	003-A1412	1
	U-bolt – large	001-4714UBL	1	13	Washer	004-1207W	1
6	Hose clamp	003-9003	8	14	Female disconnect	004-1207H	1
7	Hose clamp	003-9004	2	15	Control box**	030-0457	1

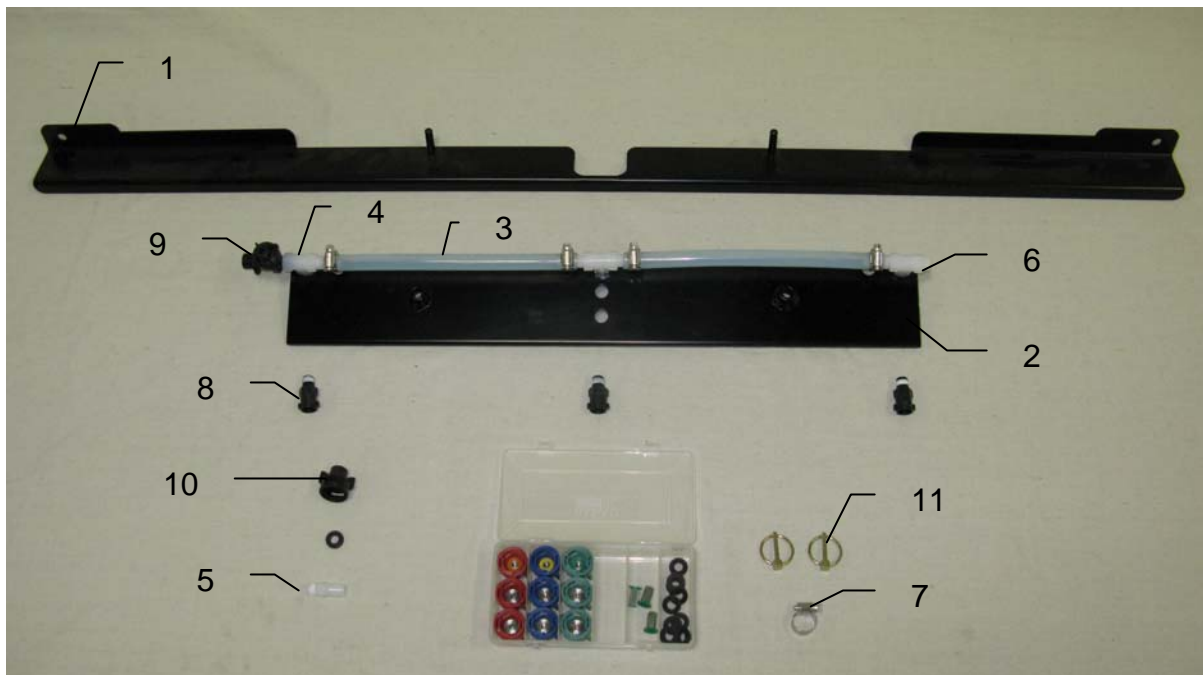

<u>Ref</u>	<u>Description</u>	<u>Part #</u>	<u>Qty</u>	<u>Description</u>	<u>Part #</u>	<u>Qty</u>
1	Shield bracket	001-4704E2	1	Tip Kit (Complete)	030-9002	1
2	Spray shield	001-4703GK	1	Plastic Box	008-9000	1
3	Hose	002-9001	3	Red Cap	004-1207B	3
4	Tee	003-TT14	3	Outside Tip (Red Set)	004-650050-SS	2
5	Straight fitting	003-A1412	5	Inside Tip (Red Set)	004-XR11001VS	1
6	Plug	003-F14	1	Green Cap	004-1207A	3
7	Hose clamp	003-9003	5	Outside Tip (Green Set)	004-6501-SS	2
8	Male quick fitting	004-4710	3	Inside Tip (Green Set)	004-XR110015VS	1
9	Check valve	004-1207V	1	Blue Cap	004-1207C	3
10	Female disconnect	004-1207H	1	Outside Tip (Blue Set)	004-6502-SS	2
11	Lynch pin	008-4576	2	Inside Tip (Blue Set)	004-XR11002VS	1
				Tip strainer	004-1203-100	3
				Washer	004-1207W	9