

Parts Breakdown

600BB Series Controls and Harnesses Dual Channel Processor (DCP)

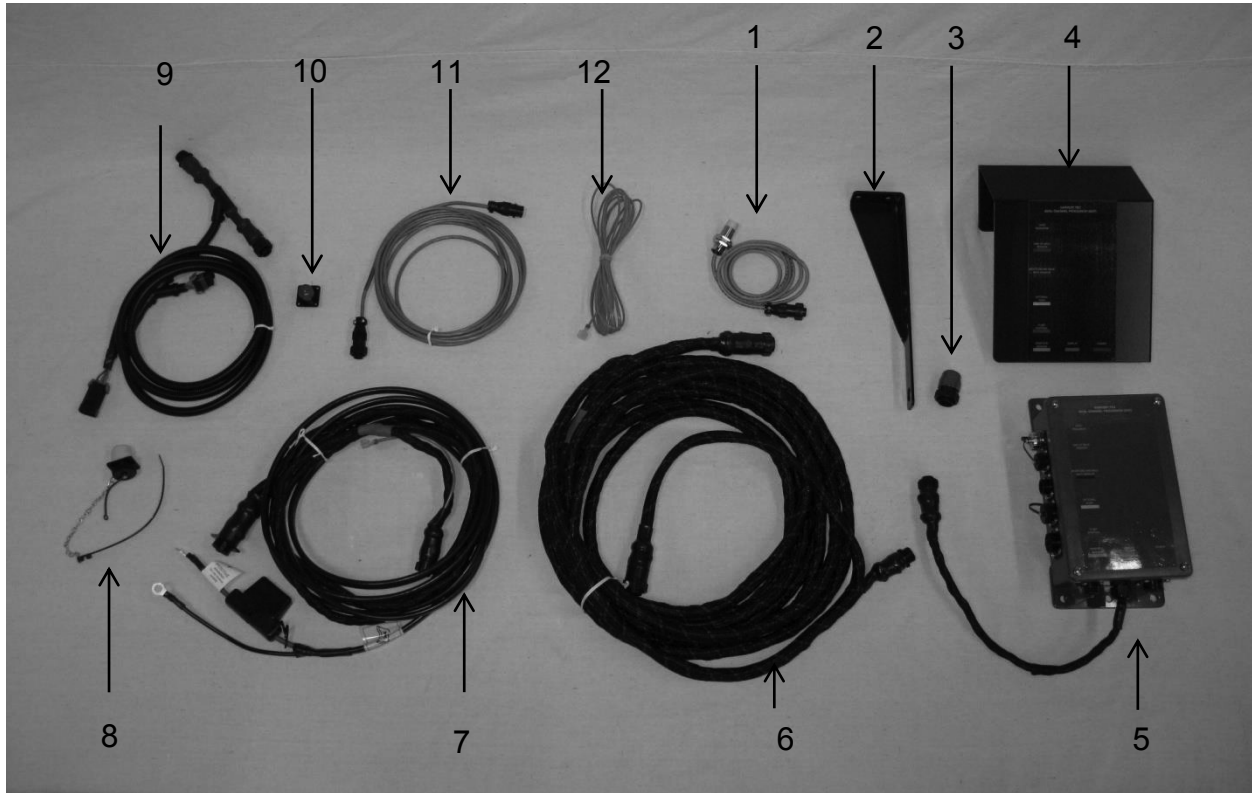

| <u>Ref</u> | <u>Description</u> | <u>Part Number</u> | <u>Qty</u> |
|------------|--|--------------------|------------|
| 1 | End of Bale Sensor 600 Series | 006-7400 | 1 |
| 2 | End of Bale Sensor Bracket | 001-4648 | 1 |
| 3 | Terminating Connector 600 Series w green cap | 006-5650Z | 1 |
| 4 | DCP Shield/Cover | 001-5650X | 1 |
| 5 | DCP Main Control LS 600 AUTO | 006-6671LS | 1 |
| 6 | DCP Baler Harness 15 FT | 006-6650LS | 1 |
| 7 | DCP Tractor Harness | 006-6650TM | 1 |
| 8 | Dust Plugs | 006-5651PLUGS | 1 |
| 9 | DCP Baler ISO/VT Harness | 006-6650VA | 1 |
| 10 | DCP TSD Terminating Resistor w red cap | 006-6650Z | 1 |
| 11 | EOB Extension for CNH BB Series | 006-7400BBEXT | 1 |
| 12 | Key Switch Wire | 006-5650K | 1 |

Parts Breakdown for Star Wheel Moisture Sensor And Bale Rate Sensors

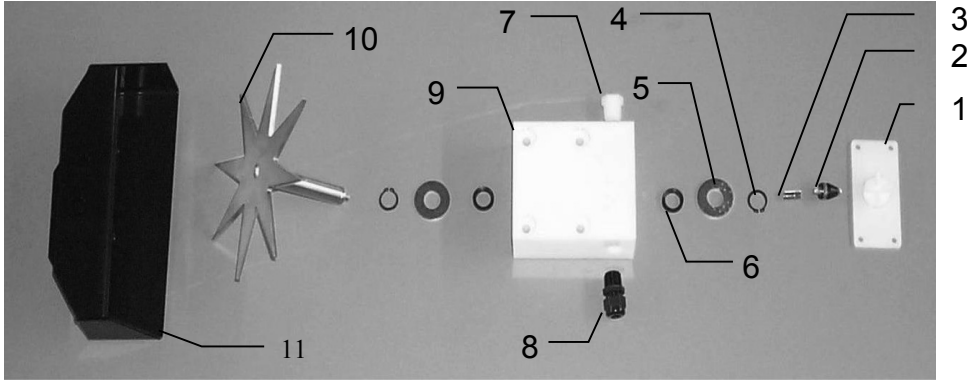

| <u>Ref</u> | <u>Description</u> | <u>Part Number</u> | <u>Qty</u> | <u>Ref</u> | <u>Description</u> | <u>Part Number</u> | <u>Qty</u> |
|------------|----------------------|--------------------|------------|------------|---------------------------|--------------------|------------|
| 1. | Block cover | 006-4641B | 2 | 9. | Star wheel block | 006-4641A | 2 |
| 2. | Electronic swivel | 006-4642A | 2 | 10. | Star wheel sensor | 030-4641C | 2 |
| 3. | Swivel insert | w/ Ref # 10 | 2 | 11. | Twine guard-left | 001-4645 | 1 |
| 4. | Snap ring (per side) | 006-4641K | 2 | | Twine guard-right (prox) | 001-4644 | 1 |
| 5. | Washer (per side) | w/006-4641K | 2 | | And with bale rate sensor | | |
| 6. | Dust seal (per side) | w/006-4641K | 2 | | holes in it | | |
| 7. | Plug fitting | 003-F38 | 2 | 1-10 | Star wheel assembly | 030-4641 | 2 |
| 8. | Wiring grommet | 008-0821A | 2 | | | | |

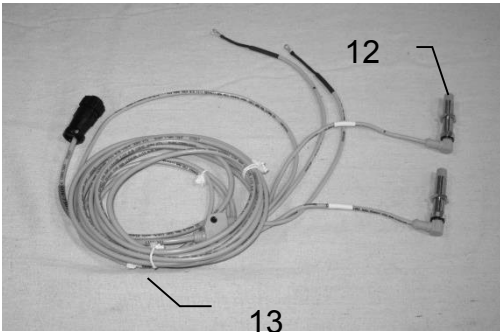

| <u>Ref</u> | <u>Description</u> | <u>Part Number</u> | <u>Qty</u> |
|------------|--------------------------------|--------------------|------------|
| 12 | Bale rate sensor | 006-7303S | 2 |
| 13 | Moisture and bale rate harness | 006-7303HL | 1 |

Optional Touch Screen Display (TSD) and Bluetooth Receiver

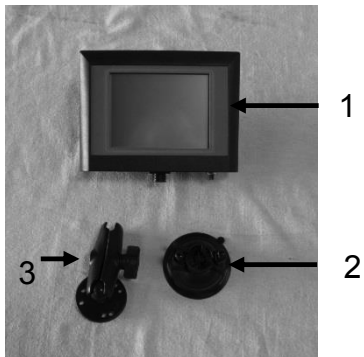

| | | |
|---|----------------------|-------------|
| 1 | Touch Screen Display | 006-6670 |
| 2 | Suction Cup Mount | 001-2012SCM |
| 3 | RAM Mount | 001-2012H |
| | Complete Kit | 030-5670A |
| 4 | Bluetooth Receiver | 030-6672A |

