

Parts Breakdown for Star Wheel Moisture Sensors

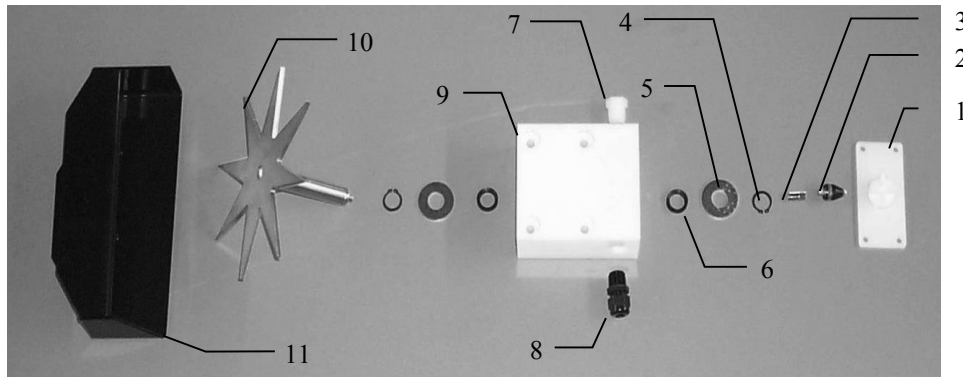

<u>Ref</u>	<u>Description</u>	<u>Part#</u>	<u>Qty</u>	<u>Ref</u>	<u>Description</u>	<u>Part#</u>	<u>Qty</u>
1	Block cover	006-4641B	2	9	Star wheel block	006-4641A	2
2	Electronic swivel	006-4642A	2	10	Star wheel sensor	030-4641C	2
3	Swivel insert	w/ Ref # 10	2	11	Twine guard-left	001-4645	1
4	Snap ring (per side)	006-4641K	2		Twine guard-right (prox)	001-4644	1
5	Washer (per side)	w/006-4641K	2				1
6	Dust seal (per side)	w/006-4641K	2				1
7	Plug fitting	003-F38	2	1-10	Star wheel assembly	030-4641	2
8	Wiring grommet	008-0821A	2				

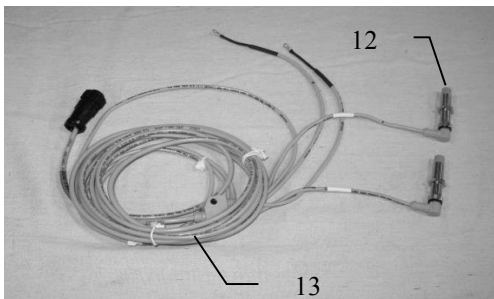

<u>Ref</u>	<u>Description</u>	<u>Part#</u>	<u>Qty</u>
12	Bale rate sensor	006-7303S	2
13	Moisture and bale rate harness	006-7303H	1
	Complete Assembly	006-7202	

Vicon, Kuhn, Claas 3200-3400, John Deere L330 / L340

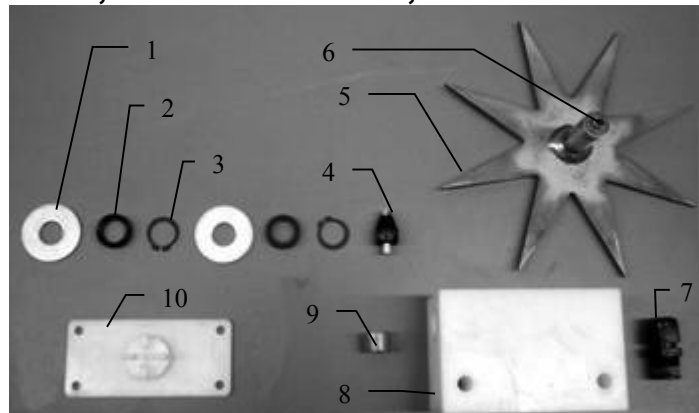

<u>Ref</u>	<u>Description</u>	<u>Part#</u>	<u>Qty</u>	<u>Ref</u>	<u>Description</u>	<u>Part#</u>	<u>Qty</u>
1	Washer (per side)	006-4642K	2	8	Star wheel block	006-4641A	2
2	Dust seal (per side)	w/006-4642K	1	9	Plug fitting	003-F38	2
3	Snap ring (per side)	w/006-4642K	2	10	Block Cover	006-4641B	2
4	Swivel	006-4642A	2	1-10	Star wheel assembly	030-4642	2
5	Star wheel	030-4641E	2	NP	Twine guard – right (prox)	001-4644	1
6	Insert	w/ Ref # 5	2	NP	Twine guard – left	001-4645	1
7	Wiring grommet	008-0821A	2				