

4490A INSTALLATION KIT

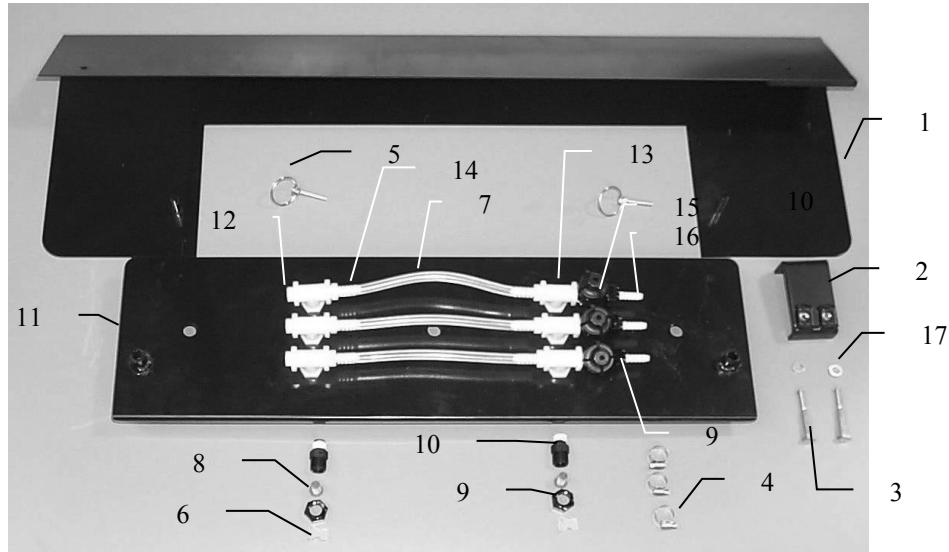

Ref	Description	Part#	Ref	Description	Part#
1.	Shield holder	001-4421B	10.	Nozzle body	004-4722
2.	Shield clip	001-4421A	11.	Spray shield	001-4421
3.	Bolts-5/16"x2 1/4"		12.	Plug	003-F14
4.	#4 Hose clamp	003-9003	13.	Tee	003-TT14
5.	Lynch pins	008-4576	14.	Straight fitting	003-A1414
6.	Tips	004-TT11002VP	15.	Check valve	004-1207VB
	Tips	004-TT11001VP	16.	Straight fitting	004-A1414VB
	Tips	004-TT110015VP	17.	Lock washers-5/16"	
7.	Eva hose-1/4"	002-9006	18NP.	Spacer plate	004-6702S
8.	Strainer-100 mesh	004-1203-100			
9.	Nozzle cap	004-4723			

4491A INSTALLATION KIT

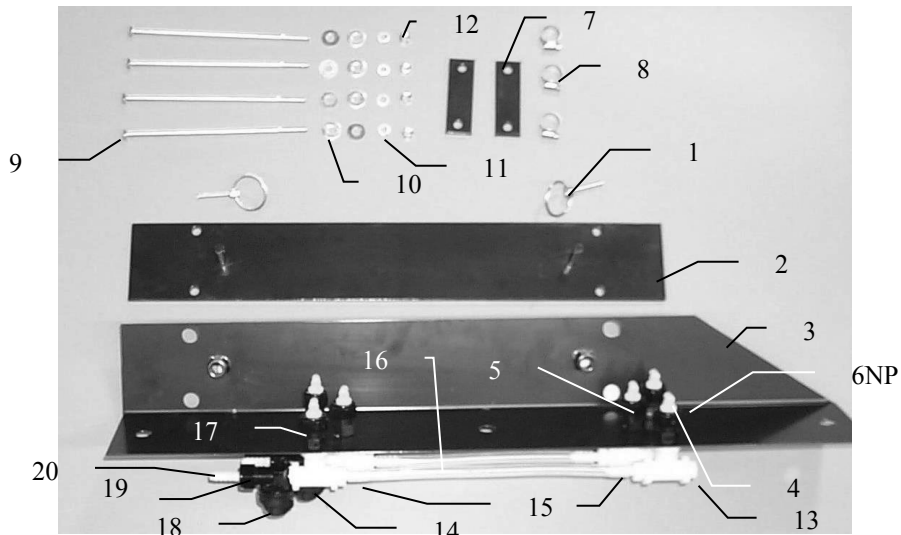

Ref	Description	Part #	Ref	Description	Part #
1.	Lynch pin	008-4576	11.	1/4" lock washers	
2.	Shield holder	001-4422B	12.	1/4" nuts	
3.	Spray shield	001-4422	13.	Plug	003-F14
4.	Tip	004-TT11002VP	14.	Tee	003-TT14
	Tip	004-TT11001VP	15.	Straight fitting	003-A1414
	Tip	004-TT110015VP	16.	Eva hose- 1/4"	002-9006
5.	Nozzle cap	004-4723	17.	Nozzle body	004-4722
6NP.	Strainer-100mesh	004-1203-100	18.	Check valve	004-1207VB
7.	Backing plates	001-4422A	19.	Nut	004-4723
8.	#4 Hose clamps	003-9002	20.	Straight fitting	003-A1414VB
9.	Bolts-1/4"x7"		NP.	Not pictured	
10.	Washers- 1/4"				