

### 4492A INSTALLATION KIT

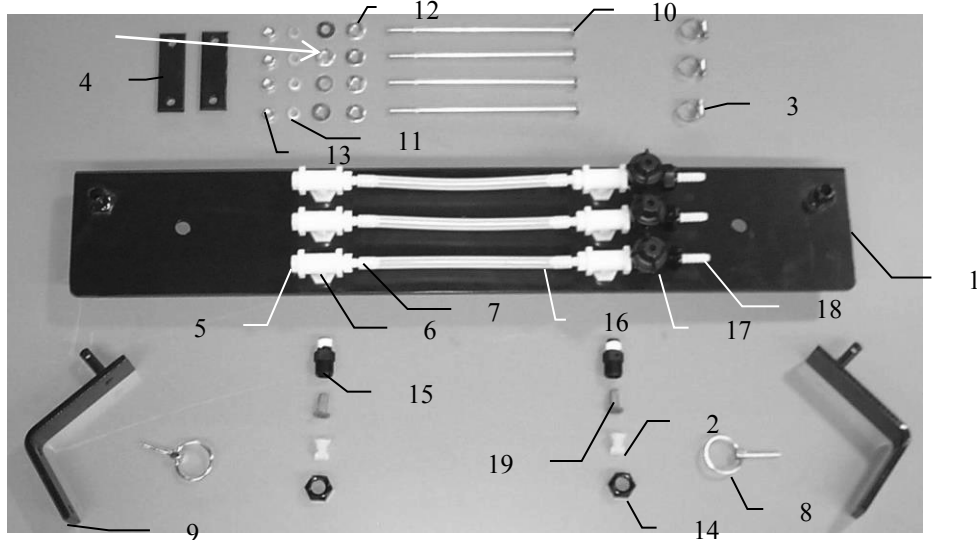

Ref	Description	Part #	Ref	Description	Part#
1.	Spray shield	001-4432A	11.	Lock washers-1/4"	
2.	Tip	004-TT11002VP	12.	Washers-1/4"	
	Tip	004-TT11001VP	13.	Nuts-1/4"	
	Tip	004-TT110015VP	14.	Nozzle cap	004-4723
3.	#4 Hose clamp	003-9002	15.	Nozzle body	004-4722
4.	Backing plates	001-4432C	16.	Eva hose-1/4"	002-9006
5.	Plug	003-F14	17.	Check valve	004-1207VB
6.	Tee	003-TT14	18.	Straight Fitting	003-A1414VB
7NP.	Straight fitting	003-A1414	19.	Strainers-100mesh	004-1203-100
8.	Lynch pin	008-4576	NP.	Not pictured	
9.	Shield holders	001-4432B			
10.	Bolts-1/4"x7"				

### 4494A INSTALLATION KIT

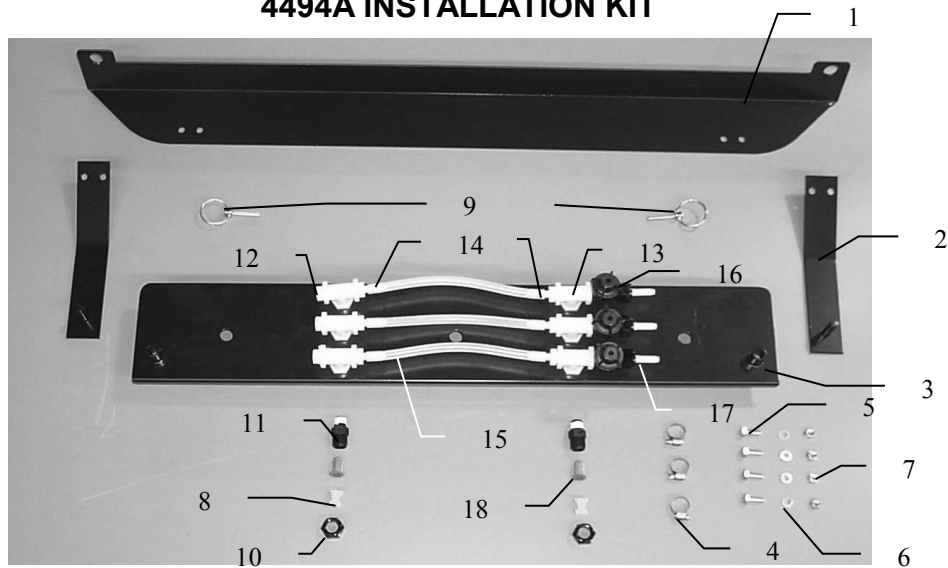

Ref	Description	Part #	Ref	Description	Part #
1.	Mounting plate	001-4436A	11.	Nozzle body	004-4722
2.	Mounting brackets	001-4436B	12.	Plug	003-F14
3.	Spray shield	001-4432A	13.	Tee	003-TT14
4.	Hose clamp	003-9002	14.	Straight fitting	003-A1414
5.	Bolt-1/4"x3/4"		15.	Hose-1/4"	002-9006
6.	Lock washer-1/4"		16.	Check valve	004-1207VB
7.	Nut-1/4"		17.	Straight fitting	003-A1414VB
8.	Tip	004-TT11002VP	18.	Strainer-100 mesh	004-1203-100
	Tip	004-TT11001VP	19NP.	Spacer plate	001-6702S
	Tip	004-TT110015VP	NP.	Not pictured	
9.	Lynch pins	008-4576			
10.	Nozzle body cap	004-4723			