

# PARTS BREAKDOWN FOR STAR WHEEL SENSOR

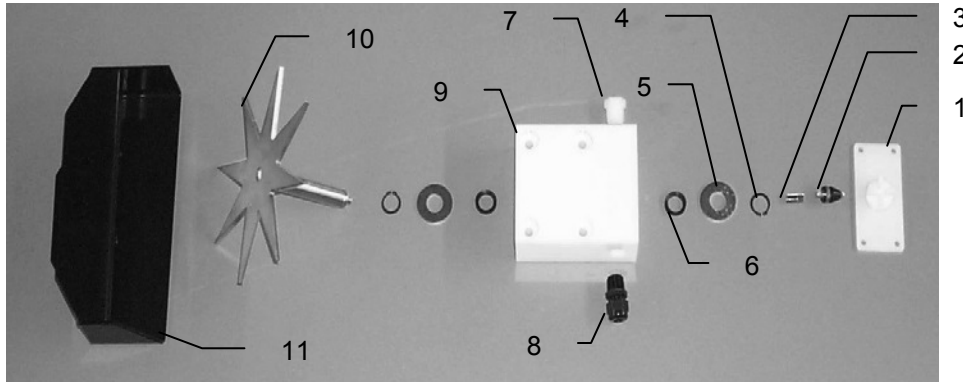

<u>Ref</u>	<u>Description</u>	<u>Part#</u>	<u>Qty</u>	<u>Ref</u>	<u>Description</u>	<u>Part#</u>	<u>Qty</u>
1.	Block cover	006-4641B	2	9.	Star wheel block	006-4641A	2
2.	Electronic swivel	006-4642A	2	10.	Star wheel sensor	030-4641C	2
3.	Swivel insert	w/ Ref # 10	2	11.	Twine guard-left	001-4645	1
4.	Snap ring		4		Twine guard-right (prox)	001-4644	1
5.	Washer		4		Twine guard-left for Agco	001-4645H	1
6.	Dust seal		4		Twine guard-Right for Agco	001-4644H	1
7.	Plug fitting	003-F38	2	1-10	Star wheel assembly	030-4641	2
8.	Wiring grommet	008-0821A	2	12.	Spacer plate for Agco	001-6707E	2

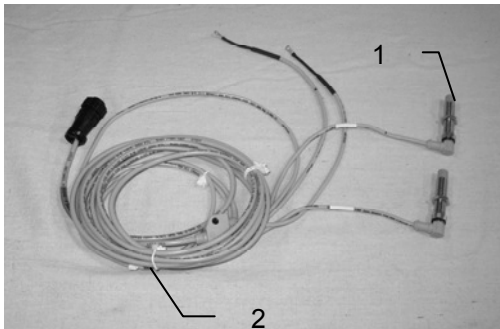

<u>Ref</u>	<u>Description</u>	<u>Part#</u>	<u>Qty</u>
1	Bale rate sensor	006-7303S	2
2	Moisture and bale rate harness	006-7303H	1

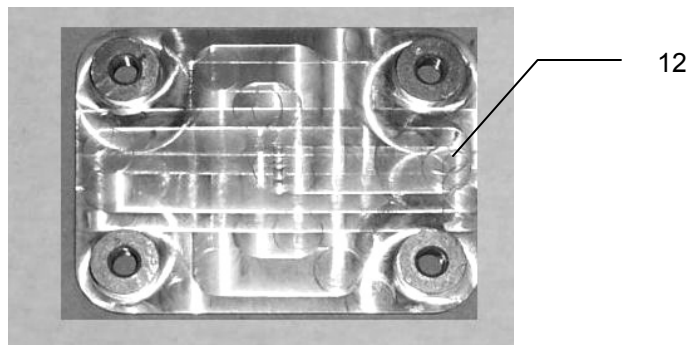

For AGCO part cross-reference visit: [www.harvesttec.com/system.html](http://www.harvesttec.com/system.html)