

# 4511B installation kit

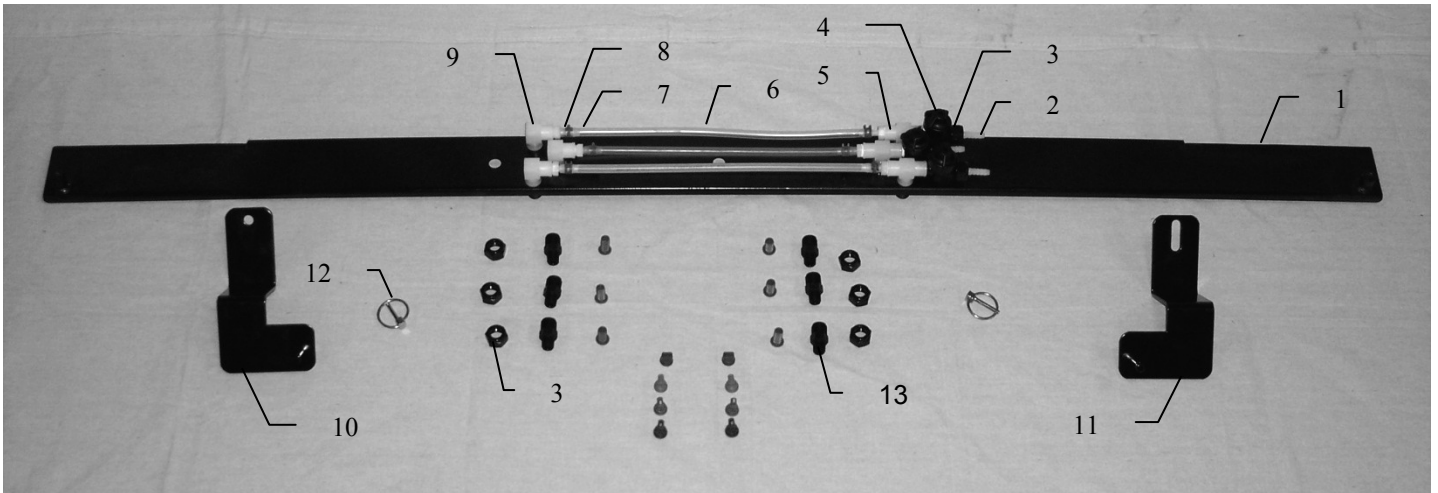

<u>Ref</u>	<u>Description</u>	<u>Part #</u>	<u>Qty</u>	<u>Description</u>	<u>Part #</u>	<u>Qty</u>
1	Spray shield	001-4704C	1	Tip	004-TT11001VP	2
2	Straight fitting	003-A1414VB	3	Tip	004-TT110015VP	2
3	Nozzle cap	004-4723	9	Tip	004-TT11003VP	2
4	Check valve	003-1207VB	3	Tip	004-800067-PT	2
5	Tee	003-TT14SQ	3	Tip Strainers	004-1203-100	6
6	Hose	002-9016	3			
7	Straight fitting	003-A1414	6			
8	Hose clamp	003-9002	9			
9	Elbow	003-SE14F	3			
10	Shield hanger	001-4704A	1			
11	Shield hanger	001-4704B	1			
12	Lynch pin	008-4576	2			
13	Nozzle body	004-4722	6			