

# Harvest Tec Model 4535B Installation Kit

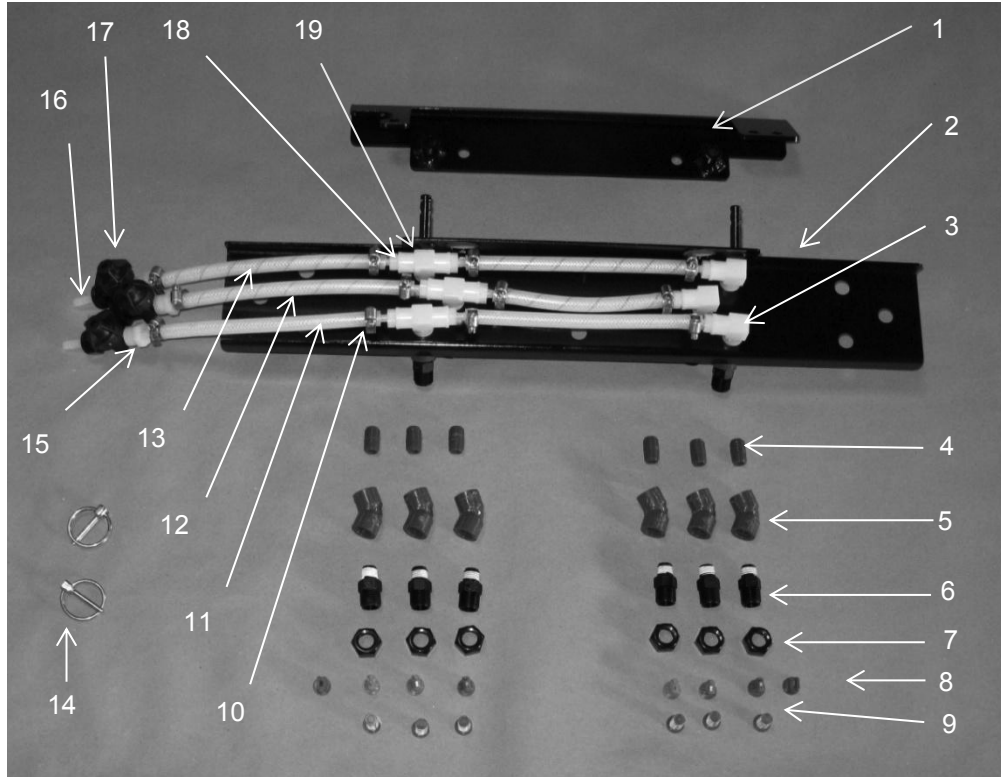

| <u>Ref</u> | <u>Description</u> | <u>Part #</u>  | <u>Qty</u> | <u>Ref</u> | <u>Description</u> | <u>Part #</u> | <u>Qty</u> |
|------------|--------------------|----------------|------------|------------|--------------------|---------------|------------|
| 1          | Holder             | 001-4435NC     | 1          | 9          | Strainer           | 004-1203-100  | 6          |
| 2          | Shield             | 001-4435N      | 1          | 10         | Hose Clamps        | 003-9002      | 15         |
| 3          | Elbow              | 003-SE14F      | 1          | 11         | Clear White Hose   | 002-9016      | 3 ft       |
| 4          | Fitting            | 003-M1414      | 6          | 12         | Green Stripe Hose  | 002-9016G     | 3 ft       |
| 5          | Fitting            | 003-SE4514F    | 6          | 13         | Blue Strip Hose    | 002-9016B     | 3 ft       |
| 6          | Fitting            | 004-4722       | 6          | 14         | Lynch Pins         | 008-4576      | 2          |
| 7          | Cap                | 004-4723       | 9          | 15         | Fitting            | 003-A1414F    | 3          |
| 8          | Tips:              |                |            | 16         | Fitting            | 003-A1414VB   | 3          |
|            | Tip-Orange         | 004-TT11001VP  | 2          | 17         | Check Valve        | 004-1207VB    | 3          |
|            | Tip-Green          | 004-TT110015VP | 2          | 18         | Tee                | 003-TT14SQ    | 3          |
|            | Tip-Blue           | 004-TT11003VP  | 2          | 19         | Fitting            | 003-A1414     | 9          |
|            | Tip-Olive          | 004-800067PT   | 2          |            |                    |               |            |