

CNH (3 x 4) Wind Guard Installation Guide (030-6707WG4)

Materials Provided:

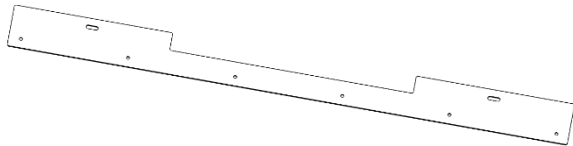

1x 001-6707MA



2x 001-6707MB



1x 001-6707MC

Materials Needed:

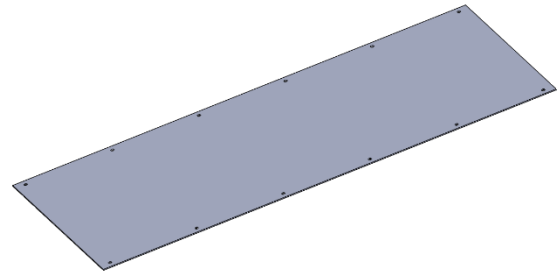

1x 001-6707GM4

2x 5/16x1.5" Hex Bolt

16x 5/16x1" Hex Bolt

18x 5/16 Hex Nut

36x 5/16 Flat Washer

Drill

Drill Bit Set

½" Socket

Installation

For a visual of the task about to be performed, the images below display a before and after representation of the wind guard installation.



Step 1: Locate the ledge near the spray shield (1) and with 001-6707MA in hand, mark out drill locations for the four slots of the 6707MA bracket. Bracket should be as centered as possible for correct alignment later on. If you're confident with drill locations, drill the holes and move to step 2. Also note the factory drilled holes on the tongue of the baler (2), locate part 001-6707MC and ensure holes align on both sides. If not, drill part 6707MC appropriately.

Step 2: Assemble the wind guard. Start by locating all of the materials listed above. Using the 1" length bolts and washers place the guard material (001-6707GM4) to the top bracket. Guard material should now be held in place with only the bolts. Locate part (001-6707MB) and place over protruding bolts, secure with flat washers and nuts. Note: Ensure nuts are fastened to the side opposite the mounting flange with the slots, this mitigates spray shield interference in the mounting process.

Step 3: Again using the hardware from step 2 fasten the guard material to the bottom bracket (001-6707MC) utilizing the remaining 001-6707MB backing bracket for security.

Step 4: Bring assembled wind guard to the baler. Start by securing the top bracket to the ledge where holes were previously drilled. Secure with 5/16 x 1" hardware. Now locate the 5/16 x 1.5" bolts. Use the bolts, flat washers and nuts to secure the bottom bracket to the baler factory drilled holes.

Finished Install

