

4514B Installation Kit

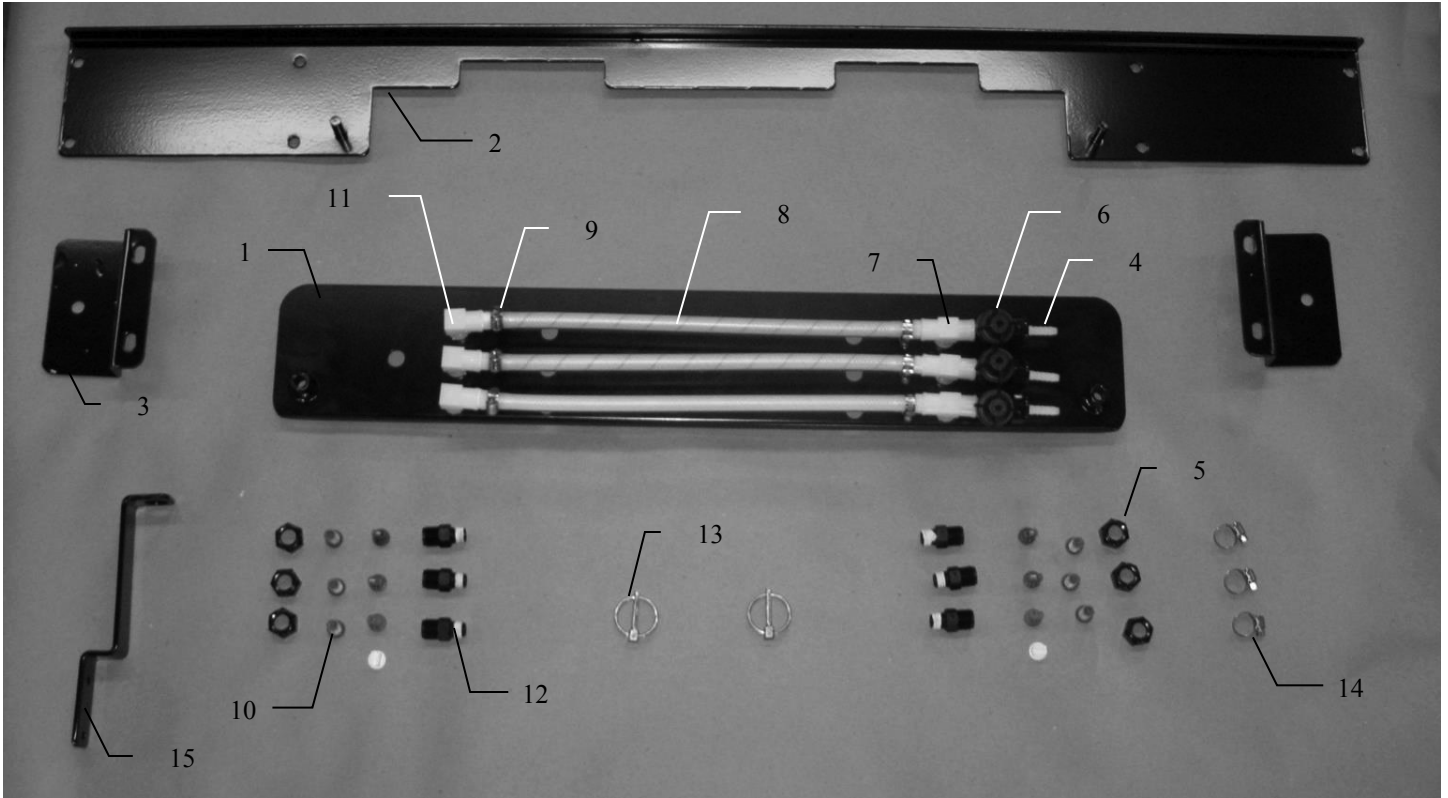

<u>Ref</u>	<u>Description</u>	<u>Part #</u>	<u>Qty</u>	<u>Description</u>	<u>Part #</u>	<u>Qty</u>
1	Spray shield	001-4431B	1	Tip (orange)	004-TT11001VP	2
2	Shield holder	001-4431KA	1	Tip (green)	004-TT110015VP	2
3	Mounting brackets	001-4431KB	2	Tip (blue)	003-TT11003VP	2
4	Straight fitting	003-A1414VB	3	Tip (olive green)	004-800067-PT	2
5	Nozzle cap	003-4723	9			
6	Check valve	004-1207VB	3			
7	Tee	003-TT14SQ	3			
8	Hose	002-9016	6			
9	Straight fitting	003-A1414	6			
10	Tip Strainers	004-1203-100	6			
11	Elbow	003-SE14F	3			
12	Nozzle body	004-4722	6			
13	Lynch pin	008-4576	2			
14	Hose clamp	002-9002	9			
15	End of bale sensor mount	001-4648K	1			
NP	End of bale sensor mount (Krone 12130 only)	001-4648K2	1			
NP	Not pictured					