

Parts Breakdowns

Installation Option A

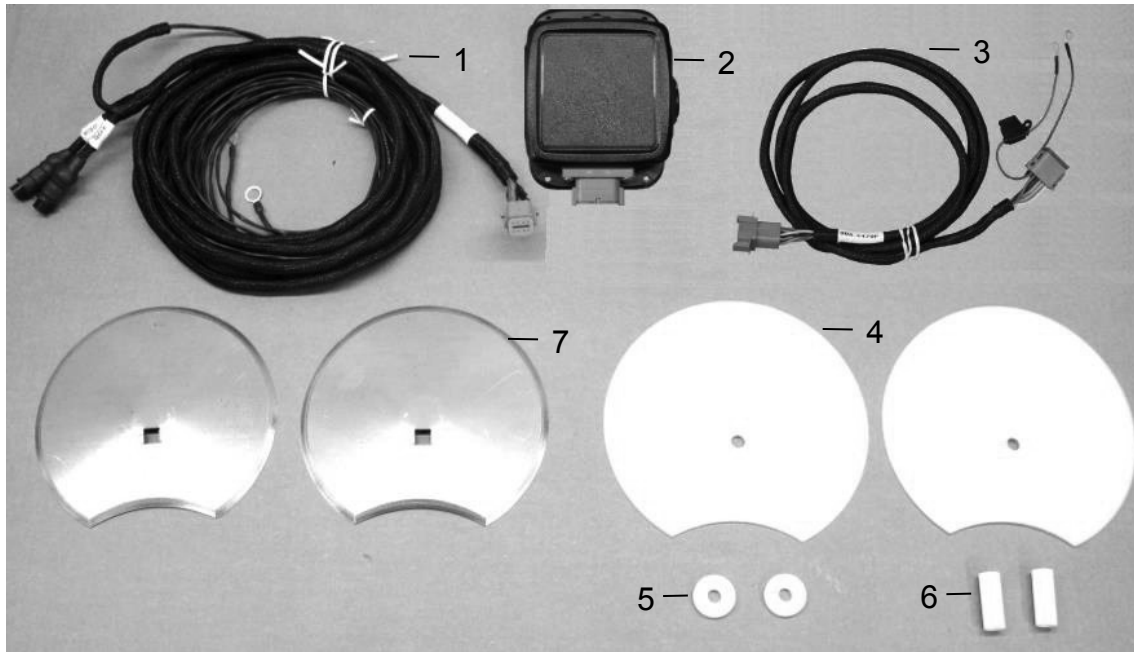

<u>Ref</u>	<u>Description</u>	<u>Part #</u>	<u>Qty</u>	<u>Ref</u>	<u>Description</u>	<u>Part #</u>	<u>Qty</u>
1	Baler Pwr/Comm Harness	006-2470RB	1	5	Plastic Isolator	006-4641I	2
2	201 Series Control Box	006-2473RB	1	6	Plastic Bushing	006-4641G	2
3	Tractor Power Harness	006-2470P	1	7	Moisture Disc	006-4641HX	2
4	Plastic Pad	006-4641FX	2	NP	8' Pwr/Comm Ext. (optional)	006-2470BL	
					Moisture Assembly (Ref 4-7)	030-4643C	

Installation Options B → G

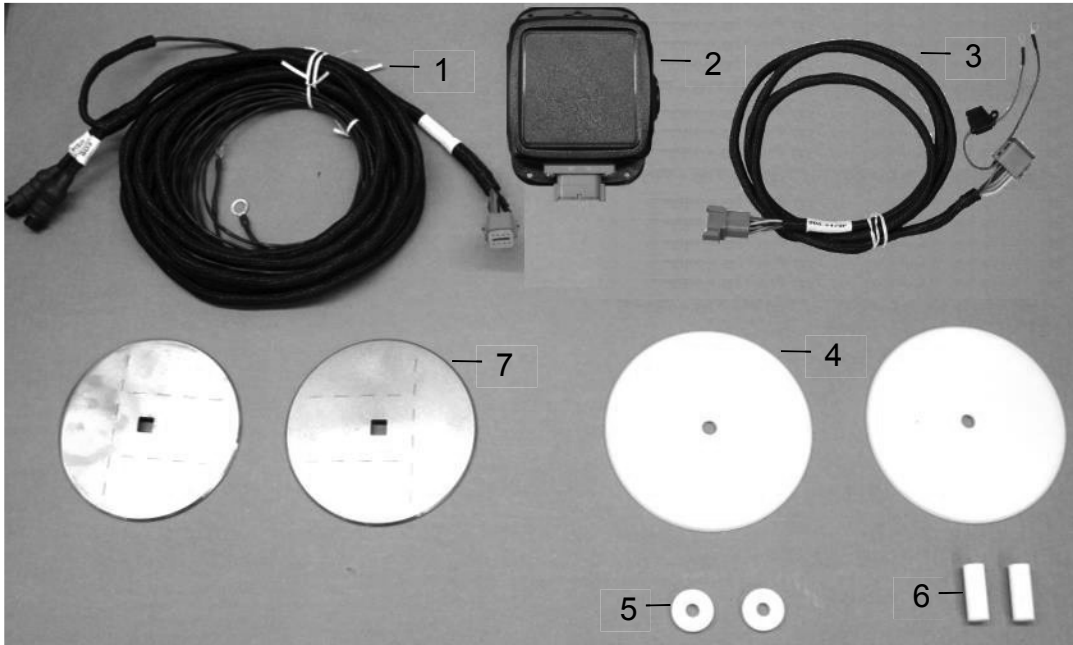

<u>Ref</u>	<u>Description</u>	<u>Part #</u>	<u>Qty</u>	<u>Ref</u>	<u>Description</u>	<u>Part #</u>	<u>Qty</u>
1	Baler Pwr/Comm Harness	006-2470RB	1	5	Plastic Isolator	006-4641I	2
2	201 Series Control Box	006-2473RB	1	6	Plastic Bushing	006-4641G	2
3	Tractor Power Harness	006-2470P	1	7	Moisture Disc	006-4641H	2
4	Plastic Pad	006-4641F	2	NP	8' Pwr/Comm Ext. (optional)	006-2470BL	
Moisture Assembly (Ref 4-7)						030-4643	

Fixed Chamber End of Bale Sensor Kit

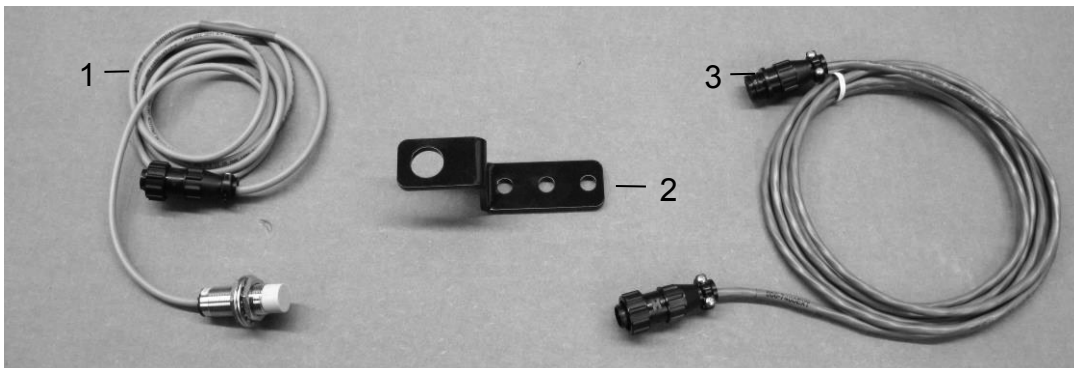

<u>Ref</u>	<u>Description</u>	<u>Part #</u>	<u>Qty</u>	<u>Ref</u>	<u>Description</u>	<u>Part #</u>	<u>Qty</u>
1	End of Bale Sensor	006-7400	1	3	EOB Extension Complete Kit	006-7400EXT 200FCA	1
2	End of Bale Bracket	001-4648RB	1				

Precision Moisture Dye Marker

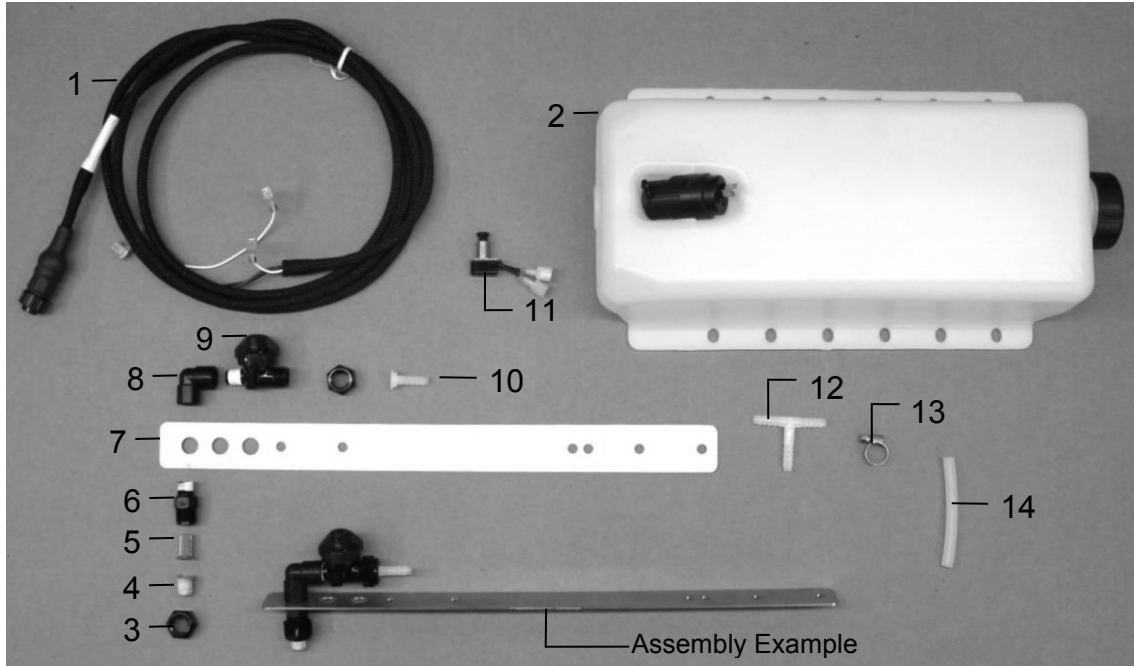

<u>Ref</u>	<u>Description</u>	<u>Part #</u>	<u>Qty</u>	<u>Ref</u>	<u>Description</u>	<u>Part #</u>	<u>Qty</u>
1	H2O Harness (10')	006-2470C	1	8	1/4" Street Elbow	003-SE14F	2
2	Tank & Pump	005-9015	1	9	Check Valve	007-1207VB	2
3	Nozzle Cap	004-4723	4	10	1/4" Straight Fitting	003-A1414VB	2
4	Tip - Yellow	004-TX-26	2	11	Push Switch	006-2850	1
5	Tip Strainer (Green)	004-1203-100	2	12	1/4" All Barb Tee	003-T1414	1
6	Nozzle Body	004-4722	2	13	Mini Hose Clamp	003-9002	6
7	Nozzle Holder	001-4215	2	14	1/4" Hose	002-9006	40
				NP	Red Dye	009-0800	1
				NP	End of Bale Sensor Kit	200FCA	1
					Complete Assembly	030-200DM	