

Parts Breakdown- Valve Assembly

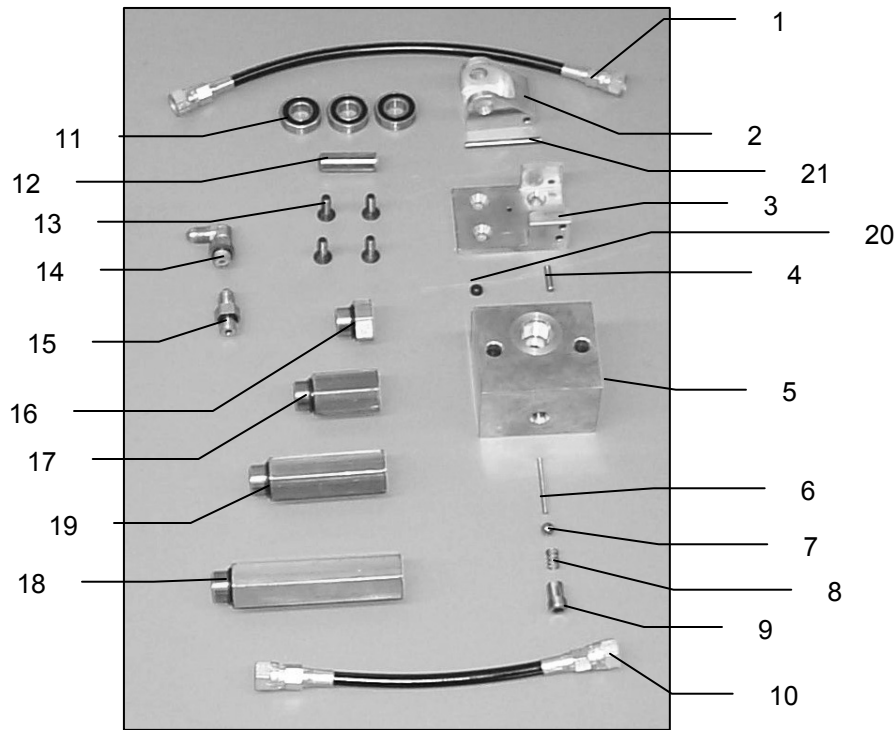

<u>Ref #</u>	<u>Description</u>	<u>Part #</u>	<u>Qty</u>
1	Valve to cross tube hose	002-7104B	12
2	Valve actuator	001-7104VA	1
3	Valve actuator support plate	001-7104VB	1
4	Valve actuator stop pin	001-7104VC	1
5	Valve block	001-7104VD	1
6	Flow pin	001-7104VE	1
7	Ball	001-7104VF	1
8	Spring	001-7104VG	1
9	Spring retainer	001-7104VH	1
10	Hub to valve hose	002-7104A	10
11	Valve rollers	001-7104VI	1
12	Valve roller pin	001-7104VJ	1
13	Screw	001-7104VK	4
14	1/4" high pressure elbow	003-DS1414EL	30
15	1/4" high pressure straight fitting	003-DS1414A	10
16	Brass standoff 3/8"	001-7105A	4
17	Brass standoff 1 1/2"	001-7105B	6
18	Brass standoff 3 3/4"	001-7105D	4
19	Brass standoff 2 5/8"	001-7105C	6
20	Quad ring	001-7104VL	1
21	Pivot pin & retainer clip	001-7104VM	1
22	Valve block assembly 2-9,11-13,20-21	001-7104	10
23	Valve rebuild kit-4,6-9, 20-21	001-7104R	1

Quantities for parts 1,10, 14-19 & 22 are the total for the machine. All others parts are quantity per valve.