

Installation Manual

Electronic XHI System **High Output Electronic Preservative Applicator** ***Metric***



P.O. Box 63 • 2821 Harvey Street • Hudson, WI 54016
800-635-7468 • www.harvesttec.com

DECLARATION OF INCORPORATION



MANUFACTURER: Harvest Tec Inc.
2821 Harvey St.
P.O. Box 63
Hudson, WI 54016, U.S.A.

REPRESENTATIVE ESTABLISHED IN COMMUNITY: Profitable Farming Company
Middle Barlington, Roborough
Winkleigh, Devon, EX19 8AG
ENGLAND

The person above certifies and declares that:

VIRTUAL MACHINE: Equipment mounted on a farm press and for the application of inoculants onto forage crops.

MODEL: Electronic XHI

BRAND: Harvest Tec

SERIAL NUMBER:

This application preservatives for hay Harvest Tec system meets the Directive 2006/42/EC of the European Parliament and the Council of 17 May 2006 and other applicable European Directives including Directive 2004/108/EC on the Electromagnetic compatibility.

The application of preservatives for hay Harvest Tec system will be turned on after being installed on a farm press has been declared in conformity with the Machinery Directive.

Person in the community authorized to provide information on the partly completed machinery and making this statement:

Richard Snell, President, Profitable Farming Company
Signed on May 21, 2011: Middle Barlington, Roborough
Winkleigh, Devon, EX19 8AG
ENGLAND

Electronic XHI Installation Table of Contents

	Page
Introduction	4
Tools Needed	4
Installation of Saddle, Legs & Mounting on Large Square Balers	5-7
491A-TK & 460-TK Tank Kits	5
491BB-TK Tank Kit	6
Installation of Saddle and Legs	7
Installation of Pump and Hand Rail	7
Installation of Saddle, Legs & Mounting on Round Balers	8-10
442C-TK Tank Kit	8-10
448-TK Tank Kit	10
Installation of Spray Shield Assembly Large Square Balers	11-12
Install Kit 4518XHI	11
Install Kit 4534XHI	11
Install Kit 4542XHI	12
Installation of Spray Shield Assembly Round Balers	13-14
Install Kit 442CXHI	13
Install Kit 44255XHI	13
Install Kit 4523XHI	14
Install Kit 4526XHI	14
Install Kit 4714JSX	15
Installation of Gauge and Hose	16
Installation of Drain / Fill Line	16
Installation of Controls	16
Parts Breakdown	17-32
Tank Kit 442C-TK	17
Tank Kit 448-TK	18
Tank Kit 491BB-TK	19
Tank Kit 491A-TK	20
Tank Kit 460-TK	21
Controls & Wiring Harnesses	22
Gauge	22
Pump Assembly PMP-4210X-A	23
Pump Assembly PMP-4210X-B	23
Parts Bag #18	24
442C Pump Plate	24
BBXHI Pump Mount	24
Drain / Fill Kit	24
Install Kit 442CXHI-SO	25
Install Kit 44255XHI-SO	26
Install Kit 4518XHI	27
Install Kit 4523XHI-SO	28
Install Kit 4526XHI-SO	29
Install Kit 4534XHI	30
Install Kit 4536XHI	31
Install Kit 4542XHI	32
Install Kit 4714JSX-SO	33
Notes	34
Warranty Statement	35

Introduction

Read this manual carefully to ensure correct steps are done to attach the applicator to the baler. This applicator is designed to apply Harvest Tec buffered propionic acid. Use of alternative products may cause complications. Including inaccurate readings from the flow meter and damage to all parts. Resulting in the warranty being void. The applicator can be installed on many square balers with the proper installation kit. Before installing the unit on the baler, make sure you have the proper installation kit (See the chart below). If you are unsure about your installation kit contact your local authorized dealer for specifications. There is a parts break down in the back of this manual for the applicator.

Left and Right sides are determined by facing in the direction of forward travel.

Tools Needed:

- Standard wrench set
- Electric drill and bits
- Side cutter
- Crescent wrench
- Standard screwdriver
- Standard nut driver set
- Standard socket set
- Hammer
- Metal cutting tools
- Hose cutter
- Center punch

Installation of Saddle, Legs & Mounting on Large Square Balers

491A-TK Tank Kit

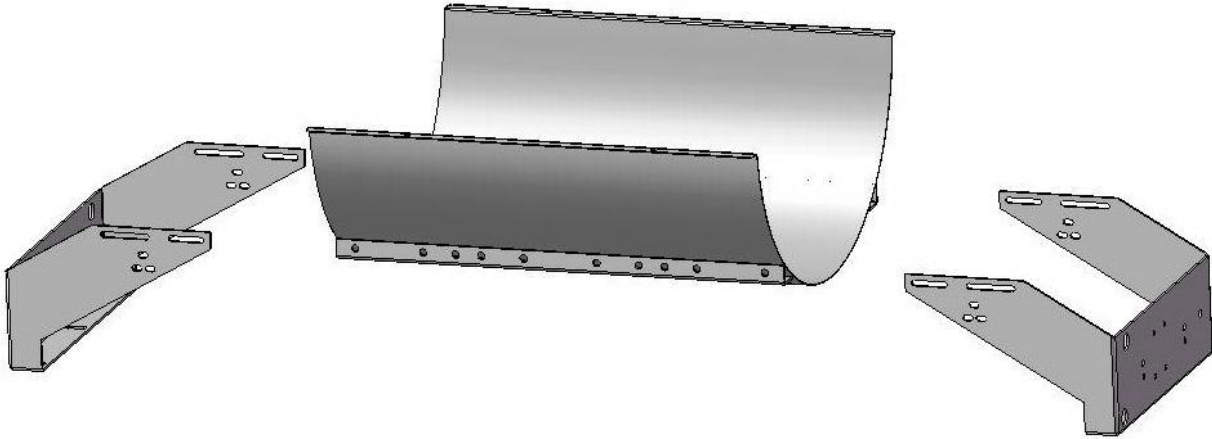

3 X 3 balers only

Locate parts bag 2. Install both saddle legs (001-6707C) onto the saddle (001-6707A) with eight 3/8" x 1-1/4" bolts, locks and flat washers. The mounting slots in the legs will attach to the second and third weld nuts in from each end, of the saddle, on both sides.

1. Once legs and saddle are loosely attached measure the distance from the top outside corners of the bale chamber where the saddle will be attached. Move legs in or out so the inside edges will match this dimension. Also try to center the saddle within these dimensions. Do not fully tighten down bolts until unit is mounted on the baler.
2. Raise the assembly on to the baler and proceed on to the next page.

3 X 4 and 4 x 4 balers only

Locate parts bag 2. Install both saddle legs (001-6707C) onto the saddle (001-6707A) with eight 3/8" x 1-1/4" bolts, locks and flat washers. The mounting slots in the legs will attach to the first and second weld nuts in from each end, of the saddle, on both sides.

1. Once legs and saddle are loosely attached measure the distance from the top outside corners of the bale chamber where the saddle will be attached. Move legs in or out so the inside edges will match this dimension. Also try to center the saddle within these dimensions. Do not fully tighten down bolts until unit is mounted on the baler.
2. Raise the assembly on to the baler and proceed on to the next page.

491BB-TK Tank Kit

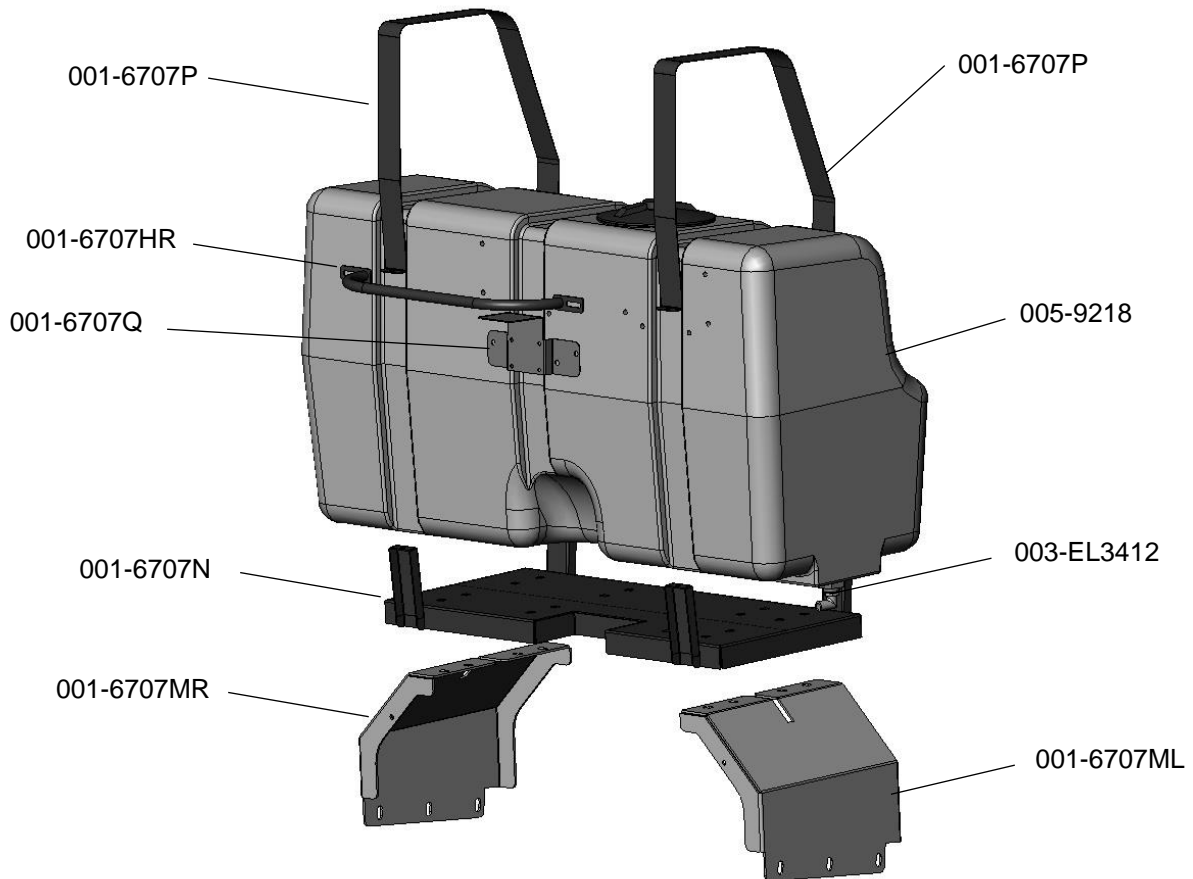

1. Remove the two tank straps (001-6707P) by removing all eight 3/8" hex nuts.
2. Lift the tank (005-9218) away from the saddle (001-6707N) and place the tank on a smooth flat surface.
3. Install the pump supply elbow (003-EL3434) on the bottom of the tank.
4. Install the drain/fill elbow (003-EL3434) on the side of the tank below the sight gauge.

Installation of Saddle and Legs

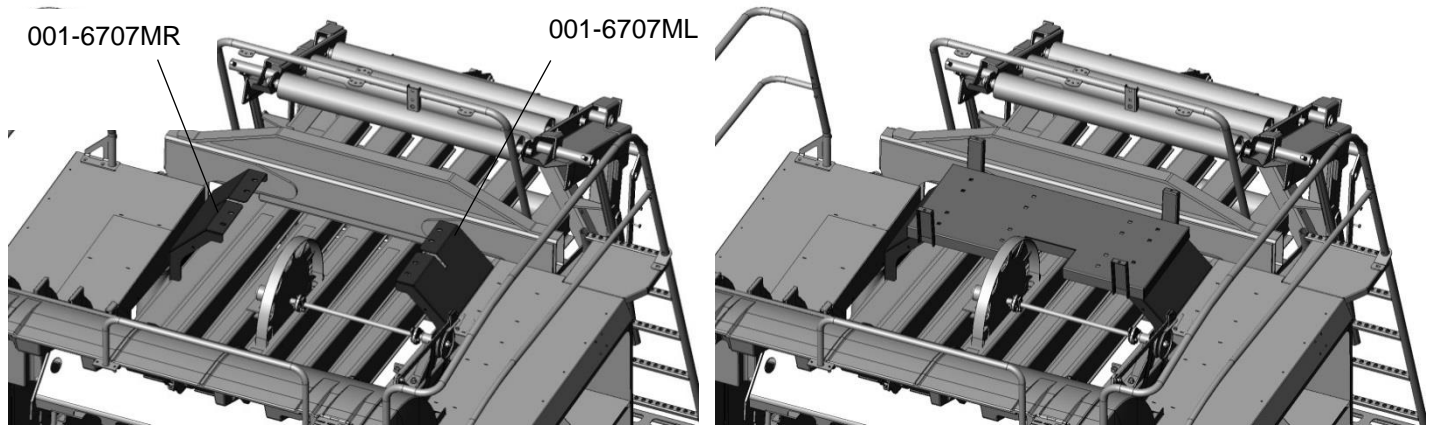

Figure 1

Figure 2

1. Locate parts bag 5.
2. Install the two saddle legs (001-6707MR & 001-6707ML) on to the top of baler chute as shown. Figure 1
3. Secure the two legs with six (three per side) 1/2" x 1-3/4" carriage bolts, flats washers, locks washers, and hex nuts. The six holes will be already punched out of the baler frame and will line up with the saddle legs. Make sure the bolt head is in the chamber.
4. Install the tank saddle (001-6707N) on top of the saddle legs. Figure 2
5. Secure the tank saddle to the saddle legs using eight (four per side) 1/2" x 1-3/4" carriage bolts, flat washers, lock washers, and hex nuts. Use the outside set of holes for four foot wide balers and the inside set of holes for three foot wide balers. Figure 2
6. Make sure the carriage bolt heads are on top of the saddle and the bolt points towards the bale chamber.
7. Install the tank and secure with the straps and hardware removed from before. The tank straps will need to be secured with a double nut.

Installation of Pump and Hand Rail

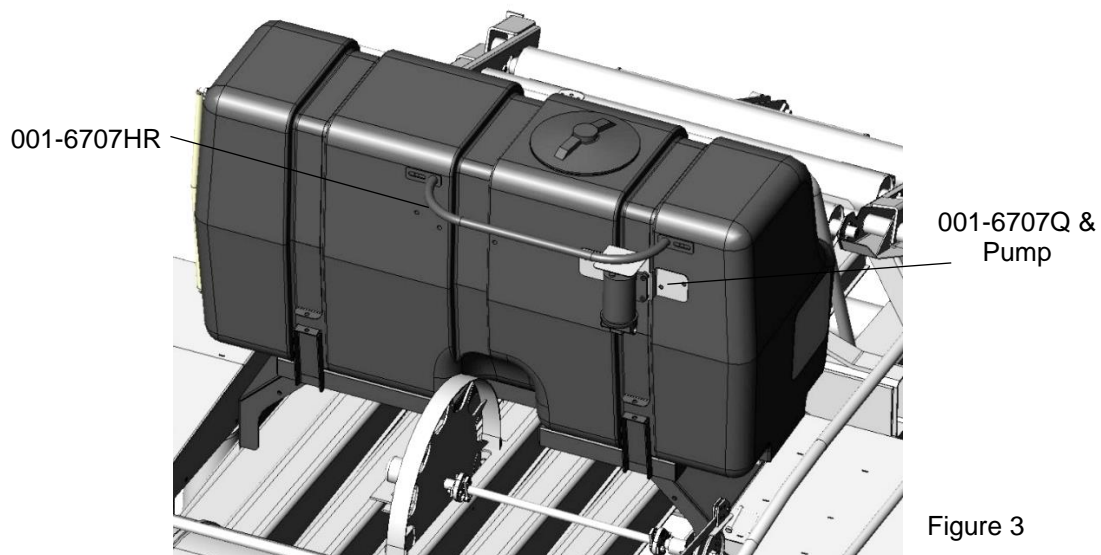

Figure 3

1. Locate parts bag 5.
2. Install the handrail (001-6707HR) above the pump manifold using two 3/8" x 3/4" flange bolts. Figure 3
3. Install the pump bracket to the tank using four 3/8" x 3/4" flange bolts.
4. Locate the 1/2" hose and connect the filter bowl assembly to the tank fitting using the supplied two hose clamps. Connect the 3/4" hose to the pump using the supplied straight fitting (003-A3434). Figure 3

Installation of Saddle, Legs & Mounting on Round Balers

442C-TK Tank Kit

1. Locate the left saddle leg, 001-4703XL, and mount to left side sheet of baler using two 1/2" x 1-1/2" hex bolts, 1/2" lock washers, and 1/2" flat washers. Do not fully tighten.
2. Locate the right saddle leg, 001-4703XR, and mount to right side sheet of baler using two 1/2" x 1-1/2" hex bolts, 1/2" lock washers, and 1/2" flat washers. Do not fully tighten.
3. **Roll Belt 460 / 560 and RB465 Installation only!** Locate the two anchor extension brackets, 001-4703XAX, and attach one extension bracket to the outside of each leg with two 1/2"x 1-1/2" hex bolts, 1/2" lock washers, and 1/2" flat washers.
4. Locate the anchor bracket, 001-4703XA, and attach to the side of the extension bracket, 001-4703XAX for 4 X 6 balers (or 001-4703XR and 001-4703XL for other balers) using two 1/2"x 1-1/2" hex bolts, 1/2" flat washers, 1/2" lock washers, and 1/2" hex nuts. Do not fully tighten. Note that 001-4703XA should be positioned so it is angled toward the round pipe that runs across the width of the baler behind the legs. Repeat procedure for the opposite side.
5. Locate the U-bolts, 001-4703XAB, and attach the 001-4703XA brackets to the round pipe running across the baler. Tighten the U-bolts evenly. ***Due to minimal clearance between the anchor bracket and the side sheet, use a deep socket and long extension on a ratchet to tighten u-bolts.*
6. With the U-bolts, 001-4703XAB, securely tightened around the round pipe, tighten the bolts connecting the anchor brackets, 001-4703XA, to the saddle legs, 001-4703XL & 001-4703XR.
7. Tighten the hardware attaching the saddle legs, 001-4703XL & 001-4703XR, to side sheets of the baler.
8. Install the tank assembly (tanks, straps, handrail, and saddle pan) on the legs. Secure the saddle pan, 001-4703X, to the saddle legs with 1/2" flat washer, 1/2" lock washer, and 1/2" hex nut from the bottom side in four locations. Tighten hardware.

****001-4703XAX (x2) are ONLY used on 4x6 models**

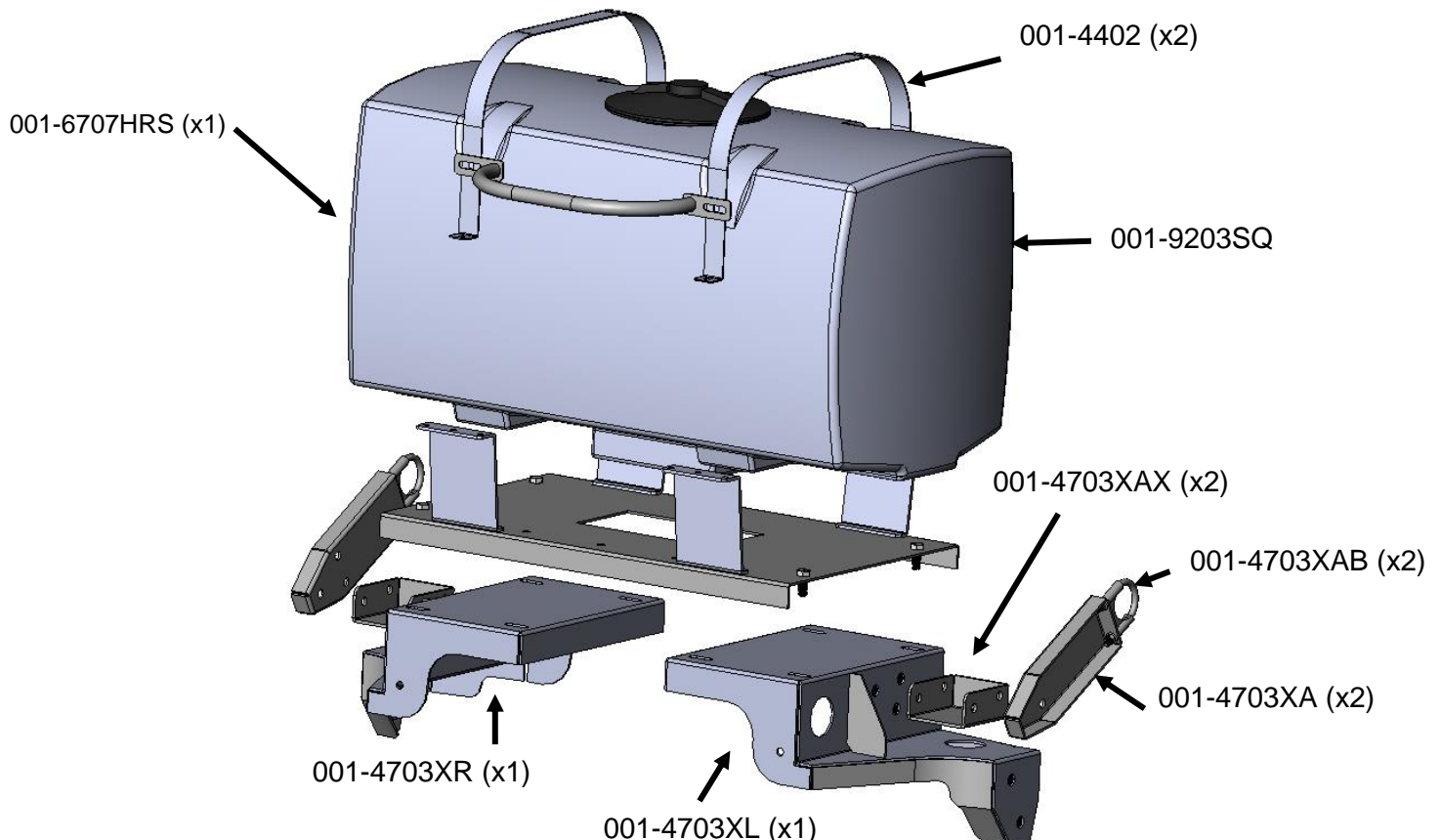

4x5 Baler Expanded

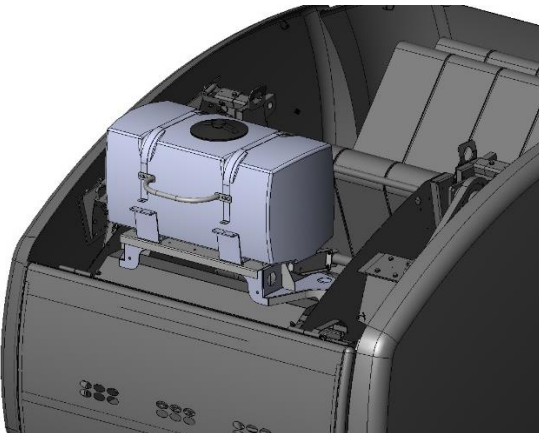
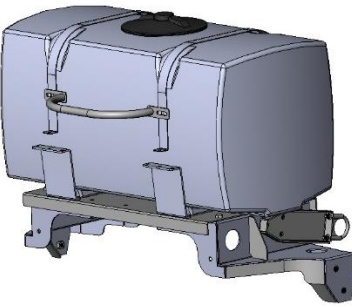
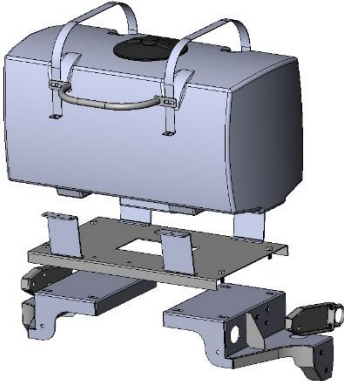

4x6 Baler Expanded

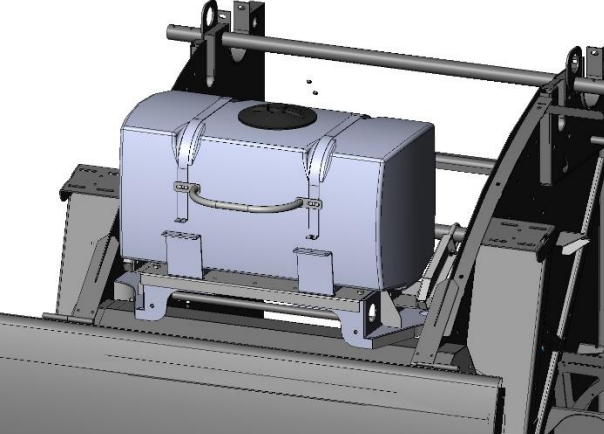
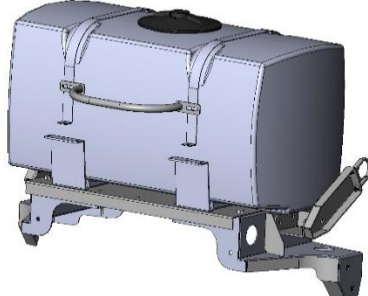
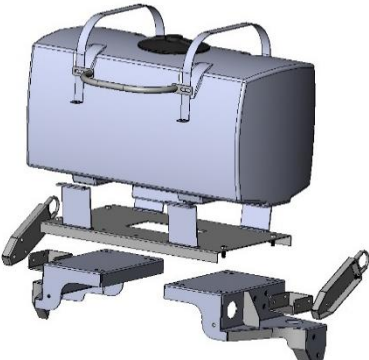

5x5 Baler Expanded

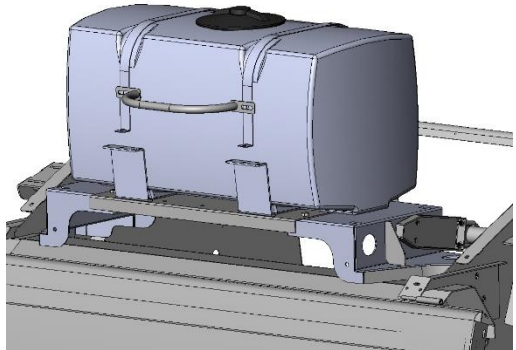
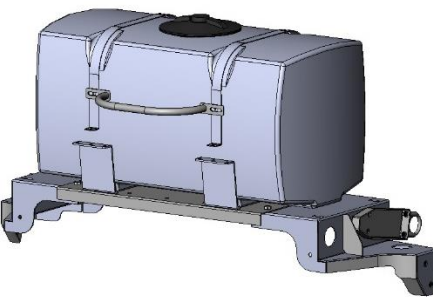
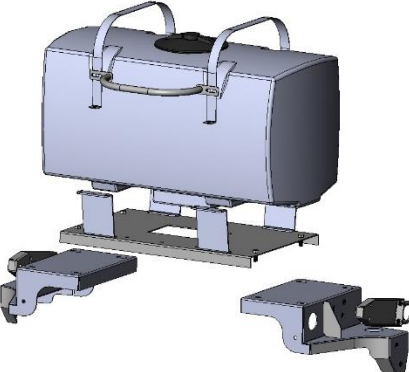

5x6 Baler Expanded

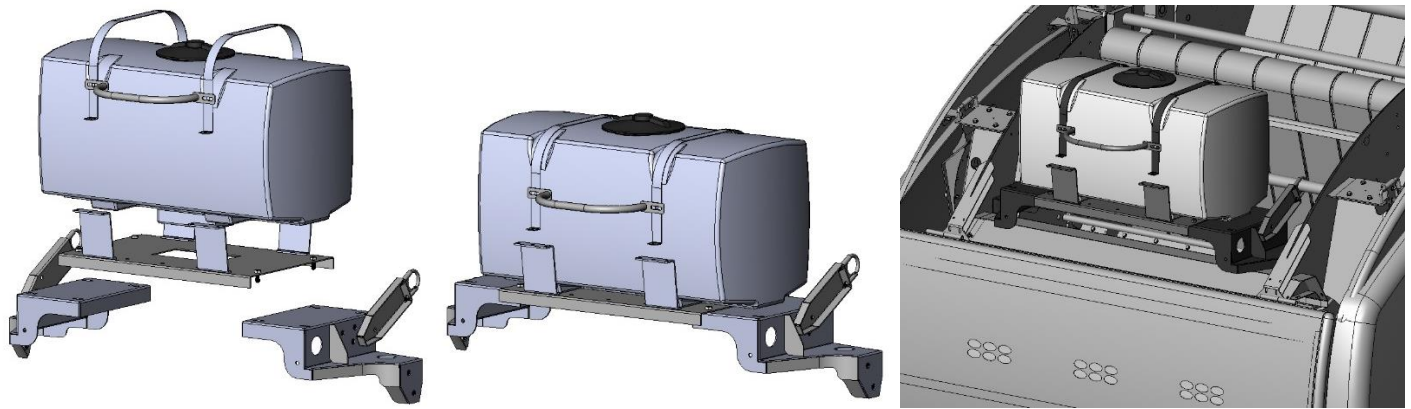

448-TK Tank Kit

Locate parts bag 7. Locate legs part #001-4703K and part #001-4703L. Use the diagram below to locate the placement of the holes you will need to drill. You will need to drill three 1/2" holes per side of tongue. After drilling the holes you will need to loosely attach the legs to the tongue with 1/2" X 2" bolts with locks, nuts, and flat washers (Figure 1). Attach the saddle (001-4703) and tank assembly on top of the legs using 3/8" x 1" bolts and lock washers (Figure 2). Do not tighten down 3/8" bolts all the way. Once saddle is attached to legs tighten down bolts and nuts attaching the legs to the tongue. Now tighten bolts attaching saddle to legs.

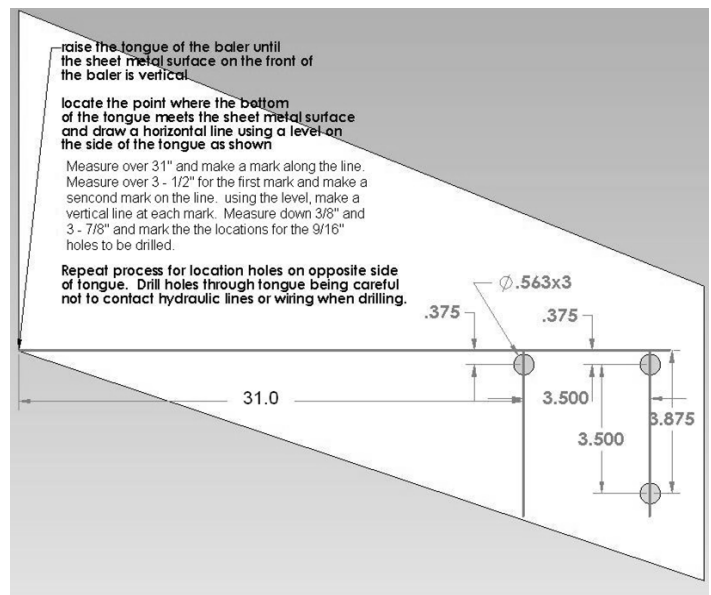
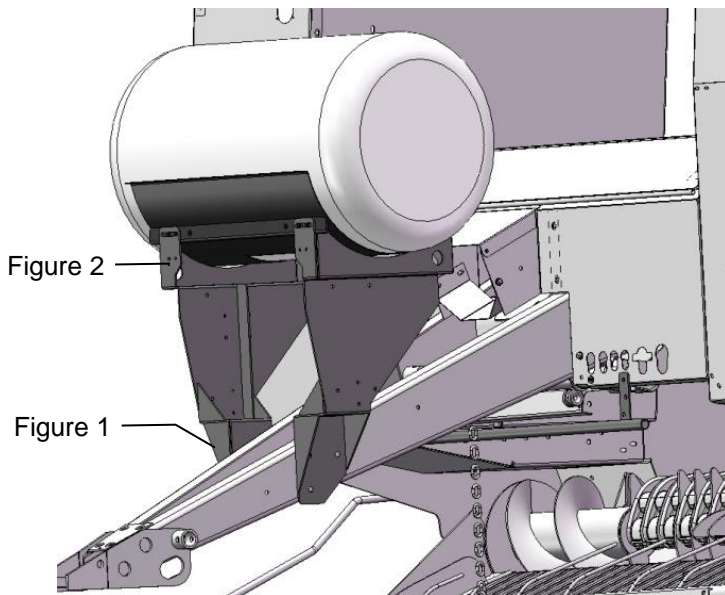

Installation of Spray Shield Assembly Large Square Balers

Installation Kit 4518XHI

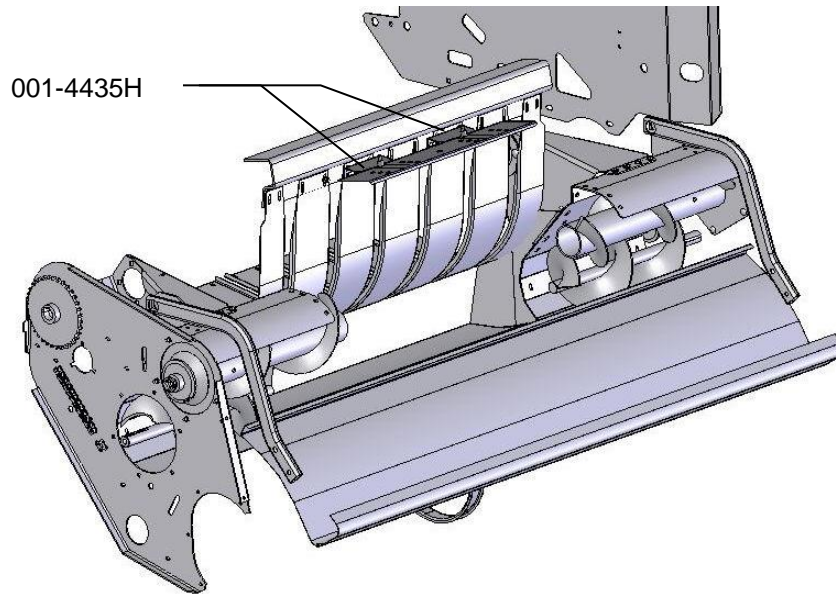

Remove the four bolts attached to the wrapper stripper plates as shown above. Replace with the four supplied $3/8$ " x $1-1/4$ " carriage bolts, nuts, locks, and flat washers. Mount the spray shield holders (001-4435H) and loosely tighten down hardware. Install spray shield and secure with the two supplied lynch pins. Tighten all hardware. A parts breakdown is located in the back of the manual.

Installation Kit 4534XHI

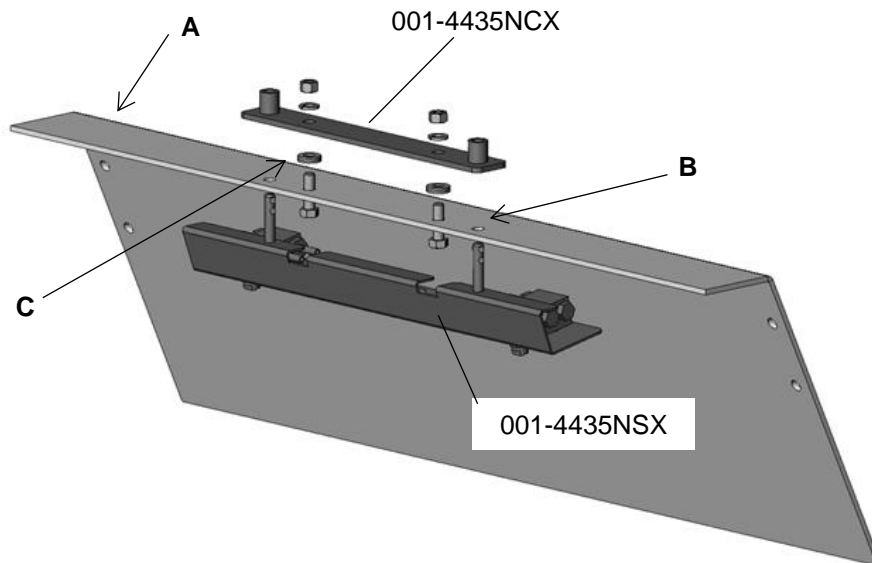

Locate the flat steel directly above the stuffer forks (A). Align the spray shield holder (001-4435NCX) to the center of the flat steel. Using the shield holder (001-4435NCX) as a template clamp the holder to the baler, mark the four holes and drill them to $7/16$ " diameter (B).

Attach the shield holder (001-4435NCX) to the baler through the two center holes using the two $3/8$ " x $1-1/4$ " hex bolts, six flat washers, two lock washers, and two hex nuts. Six washers (three per side) may need to go between the baler and the spray shield holder (C). Install the spray shield (001-4435NSX) to the holder and secure by using two lynch pins. Remove washers if necessary (C), but allow for a tight fit.

Installation of Spray Shield Kit 4542XHI

Locate the baler cross support bar below the baler's flywheel. Connect the mounting bracket (001-4435NAX) as shown in figure A. Connect the mounting bracket to baler using two 3/8" x 1 1/4" hex bolts, lock washers, and hex nuts. Install the spray shield assembly (001-4435NSX) as shown in figure B and secure with supplied lynch pins.

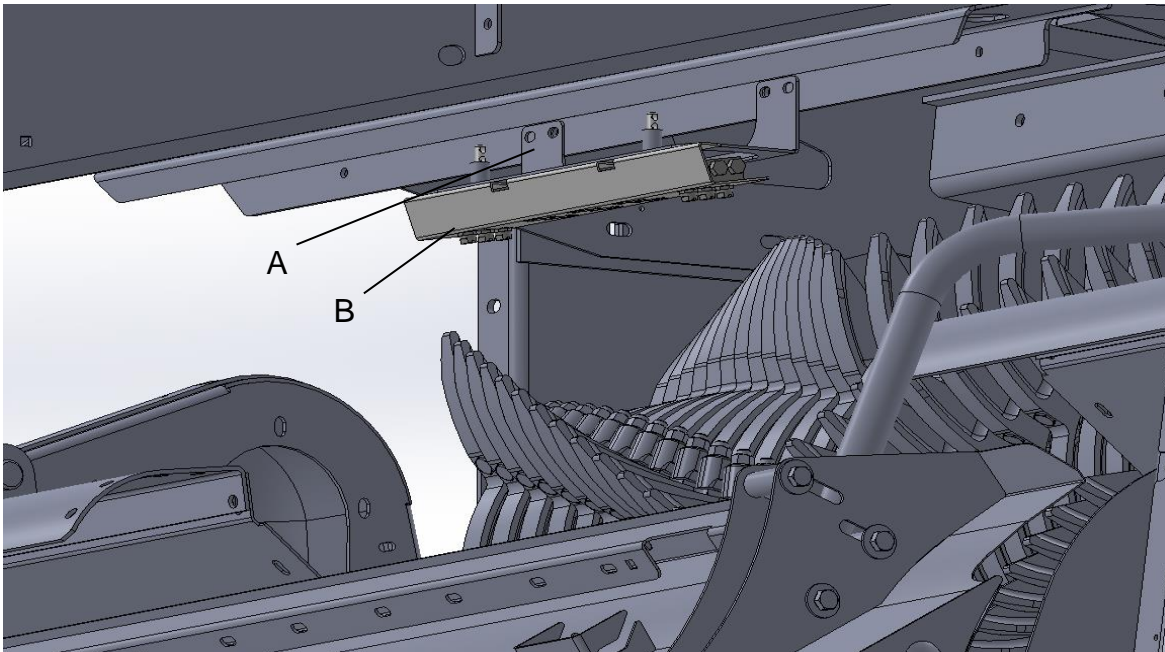

Installation of Spray Shield Assembly Round Balers

Installation Kit 442CXHI

- A. Locate nozzle block hanger assemblies with tips pre-installed.
- B. The assembly with the check valve will be mounted to the left hitch support plate when standing next to the PTO just in front of and under the large round cross support tube. Use 1/2" x 1 1/4" bolt, flat washer, lock washer, and nut to secure to baler. Repeat for the other assembly on the other side.
- C. Loosen Philip screw on nozzle block and turn them slightly in toward each other.
- D. Measure distance between hose barb fittings and cut 1/2" hose to that length. Attach them to the nozzle assemblies and secure them with hose clamps.

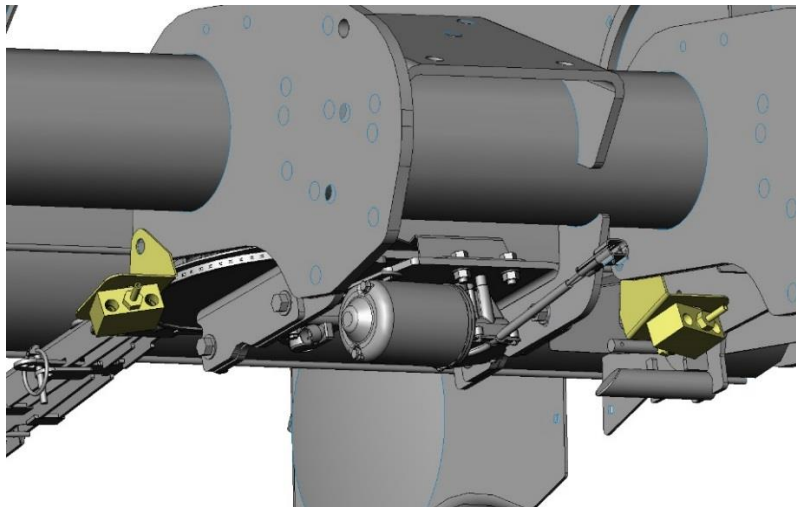

Installation Kit 44255XHI

Locate the spray shield (001-4810B) and the spray shield holder (001-4810BRH). The assembly will mount as shown in figure 1. The location shown in figure 1 is directly above the balers pickup. Four 3/8" holes will need to be drilled to mount the shield holder to the baler (Figure 2). Mount the spray shield holder using four 5/16 x 1-1/2" bolts, locks, flats, and nuts. Attach the shield to the holder using the two supplied lynch pins.

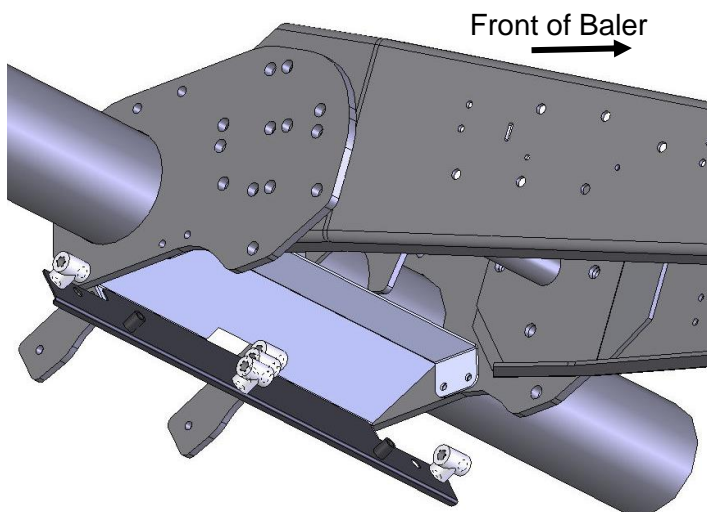

Figure 1

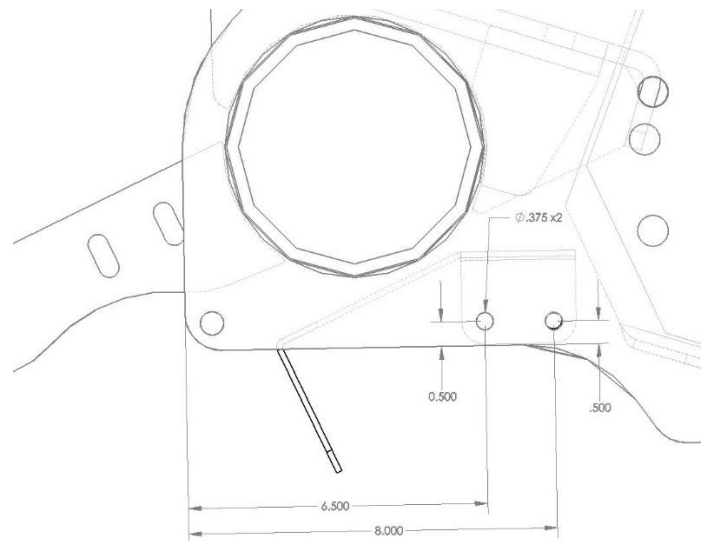
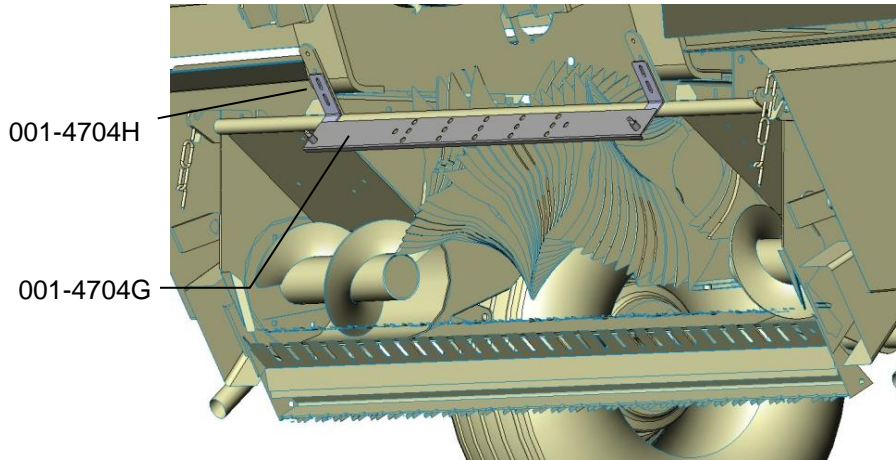

Figure 2

Installation Kit 4523XHI

Locate the spray shield (001-4704G) and spray shield hangers (001-4704H). Mount the spray shield above the pickup reel and directly in front of the rotor on the baler. Use the two existing holes to mount the shield using four 3/8" x 1-1/2" bolts, locks, flats, and nuts. Tighten all hardware.



Installation Kit 4526XHI

Locate the spray shield (001-4704G) and spray shield hangers (001-4704MC). Mount the spray shield above the pickup reel as shown below. Attach the shield to the baler using the supplied two 3/8" x 1-1/2" bolts, locks, flats and nuts. Tighten all hardware.

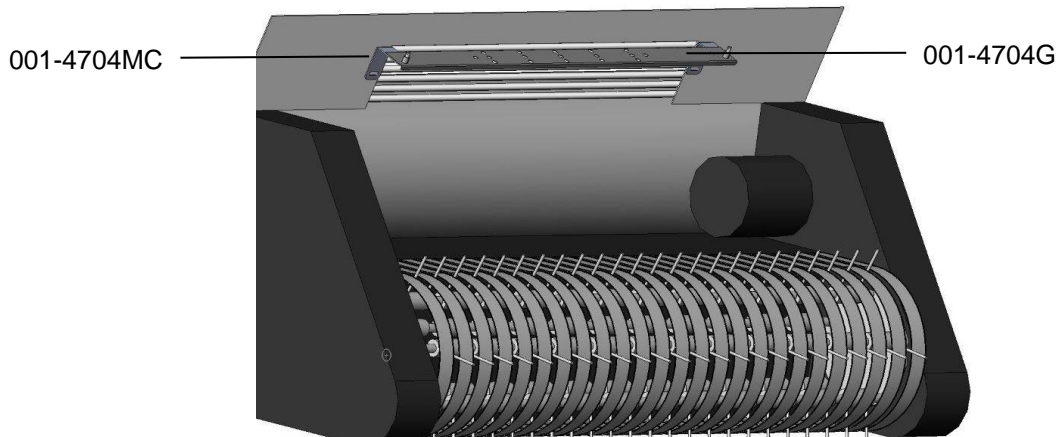

Installation Kit 4714JSX

Attach the nozzle tube pipe (001-4703TP) to the pipe mounting brackets (001-4703TH) with the supplied U Bolts. Do not tighten U-bolts, to allow mounting brackets to move. Attach the nozzle mounts (001-4714JS) to the nozzle tube pipe with U-bolts and secure. The nozzle mounts should be about 6" (12.5cm) apart for 4' (11cm) wide balers and 9" (23cm) apart for 5' (12.5cm) wide balers.

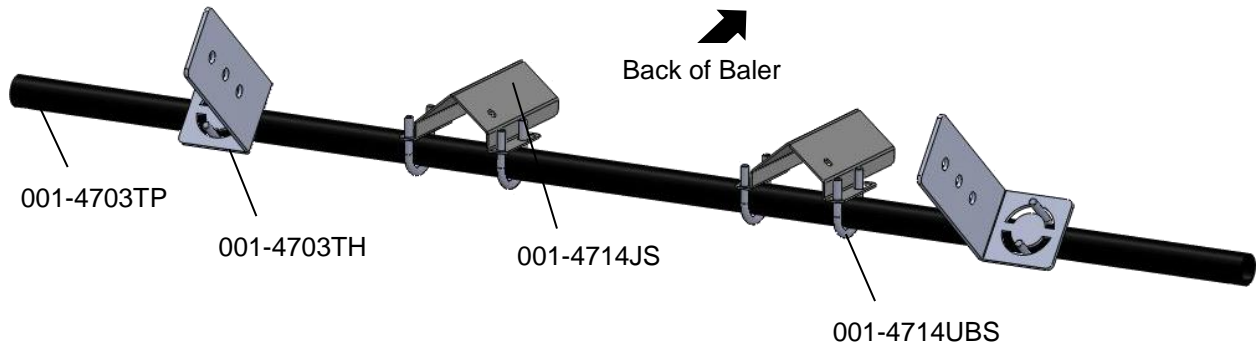

Attach Spray Bar Assembly

Position mounting brackets (001-4703TH) on the baler tongue above the pick-up as shown in figure 1 at roughly a 45 degree angle. If your baler is equipped with a roller wind guard, the angle may need to be slightly adjusted to allow clearance and proper coverage of the preservative being applied to the incoming crop. When the exact mounting position has been determined on both sides of the tongue, drill two 3/8" (10mm) holes and secure mounting brackets using four 3/8" x 1 1/4" bolts and hardware in parts bag 7. Ensure that the nozzle mounts (001-4714JS) are pointed toward the back of the baler. Figure 2 shows a side view of the mounting bracket and the nozzle pipe from the left side of the baler.

*Ensure pickup raises and lowers without damaging spray bar assembly.



Figure 1



Figure 2

Installation of Gauge and Hose

- A. Locate parts bag 13. Place gauge on upper right corner of baler, in a location visible from seat of tractor.
- B. Next, run the hose from the pump outlet to the hose fitting on the gauge. Then cut the hose to length. Place hose clamps on hose ends.
- C. Connect the quick connection from your parts bag to the other end of the gauge.
- D. Run hose from that fitting to the spray shield. Then cut the hose to length.

Installation of the Drain / Fill Line

- A. Locate parts bag 1. Thread 3/4" elbow fitting into end of tank.
- B. Run hose from the elbow down the frame to the bottom of the baler.
- C. Drill two 1/4" (7mm) holes to accept the valve holder bracket and use 5/16" x 1" self-tapping screws and secure with two flange nuts.
- D. Connect valve assembly to other end of hose. Place hose clamps on both ends.
- E. Secure hose to frame using cable locks.
- F. Install supplied safety decals (DCL-8001 & DCL-8005) next to the ball valve assembly.

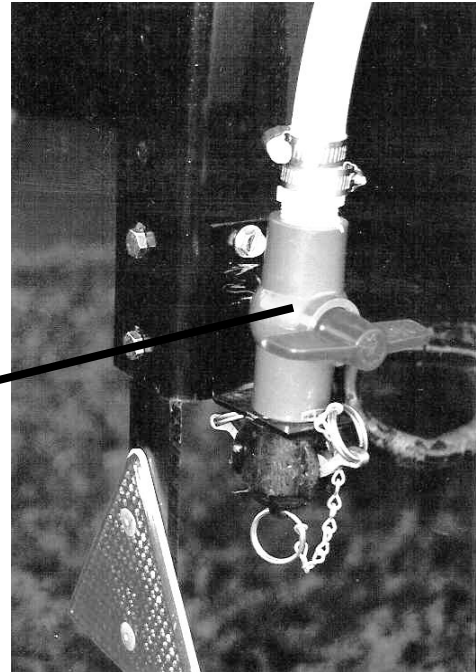

Installation of Controls

Route the wire to the starter solenoid on all 12v tractors. Connect the green lead marked + to the hot terminal on the starter. Connect the black lead to a good ground. **Do not reverse the leads.** Be sure to use a voltmeter to verify that you do have 12 volts running to the box.

Note: For tractors with 24v starters, connect the power leads to the tractor's right hand battery. Do not connect the leads to the starter. Connect the lead marked + to the positive battery terminal and the lead marked - to the negative on the battery. Wiring connections to the battery normally results in corrosion; terminal coating is recommended.

Caution: Do not run a pump or use an electronic control box directly off a battery charger. For stationary use, the applicator can be connected to a new battery and the battery connected to a charger.

Tank Kit 442C-TK

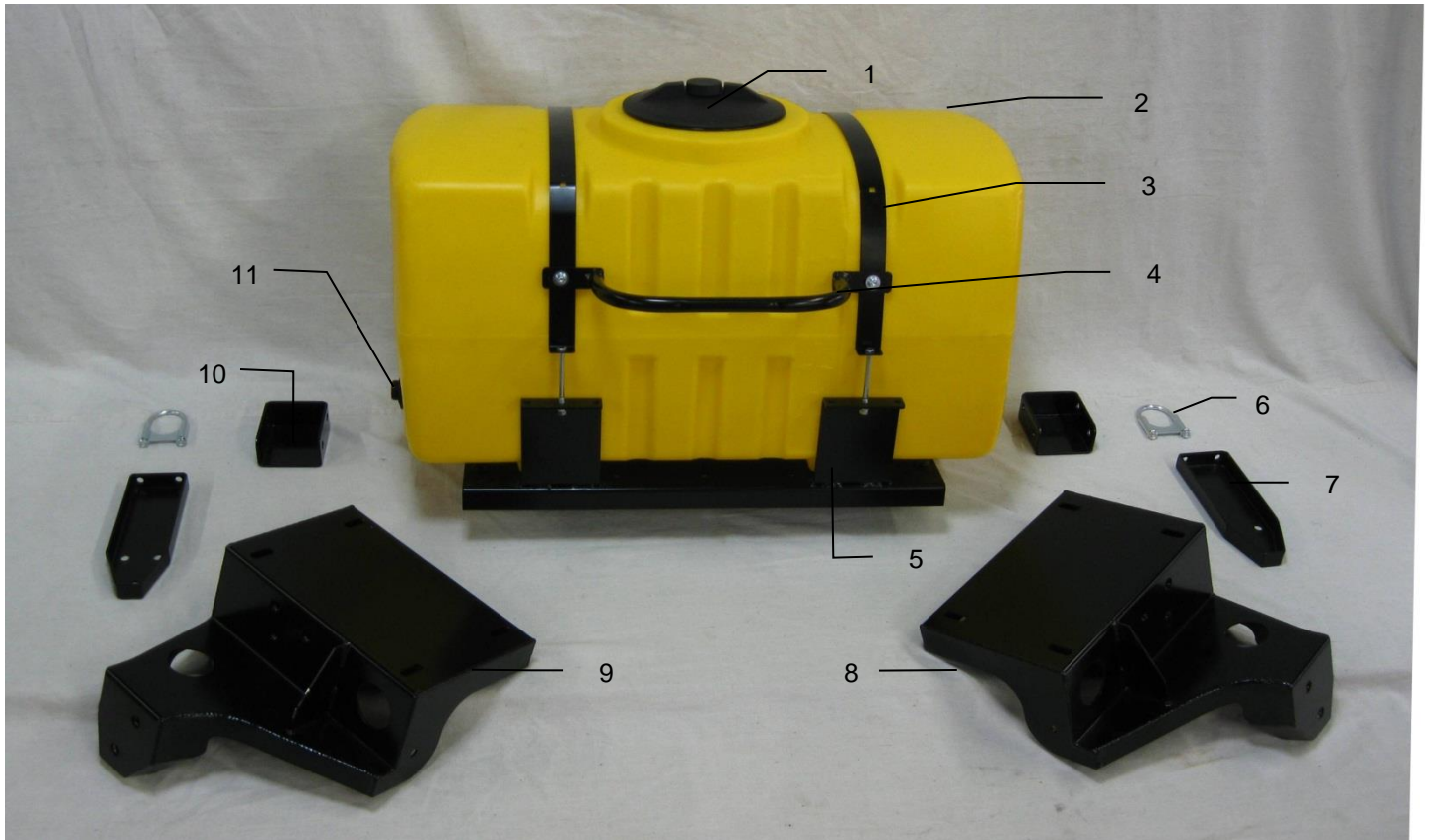

<u>Ref #</u>	<u>Description</u>	<u>Part #</u>	<u>Qty</u>	<u>Ref #</u>	<u>Description</u>	<u>Part #</u>	<u>Qty</u>
1	Tank lid	005-9022H	1	7	Anchor Bracket	001-4703XA	2
2	55 Gallon tank	005-9203SQ	1	8	Left Leg Rollbelt	001-4703XL	1
3	Tank strap	001-4402	2	9	Right Leg Rollbelt	001-4703XR	1
4	Hand Rail	001-6707HRS	1	10	Anchor Bracket Ext.	001-4703XAX	2
5	Tank Saddle	001-4703X	1	11	Tank Fitting	005-9100	1
6	U-Bolt Rollbelt	001-4703XAB	2				
					Tank Kit Assembly	030-0442C-TK (Includes Ref# 1-11)	

Tank Kit 448-TK

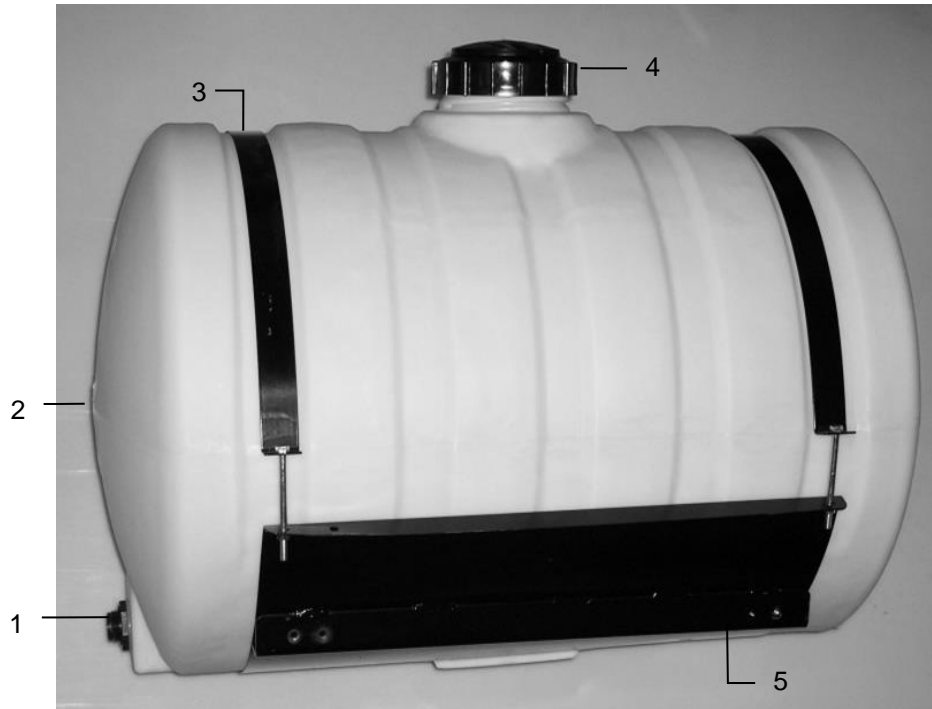

<u>Ref</u>	<u>Description</u>	<u>Part#</u>	<u>Qty</u>	<u>Ref</u>	<u>Description</u>	<u>Part#</u>	<u>Qty</u>
1	3/4" Fitting	005-9100	1	4	Tank Cap	005-9022C	1
2	Tank	005-9203	1	5	Tank Saddle	001-4703	1
3	Tank Strap	001-4402	2		Complete Assembly	030-0448-TK	

Tank Kit 491BB-TK



<u>Ref</u>	<u>Description</u>	<u>Part#</u>	<u>Qty</u>	<u>Ref</u>	<u>Description</u>	<u>Part#</u>	<u>Qty</u>
1	Tank	005-9218	1	8	1/2" hose	002-9001	2
2	1/2" tank fitting	005-9104	2	9	Left Tank Leg	001-6707ML	1
3	Elbow	003-EL1212	2	10	Right Tank Leg	001-6707MR	1
4	Tank straps	001-6707P	2	NP	Tank lid strainer	005-9022HBS	1
5	Handrail	001-6707HR	1	NP	3/4" tank fitting	005-9100	2
6	Tank lid	005-9022H	1	NP	Hose Clamp	003-9003	2
7	Tank saddle	001-6707N	1		Complete Assembly	030-0491BB-TK	



Tank Kit 491A-TK

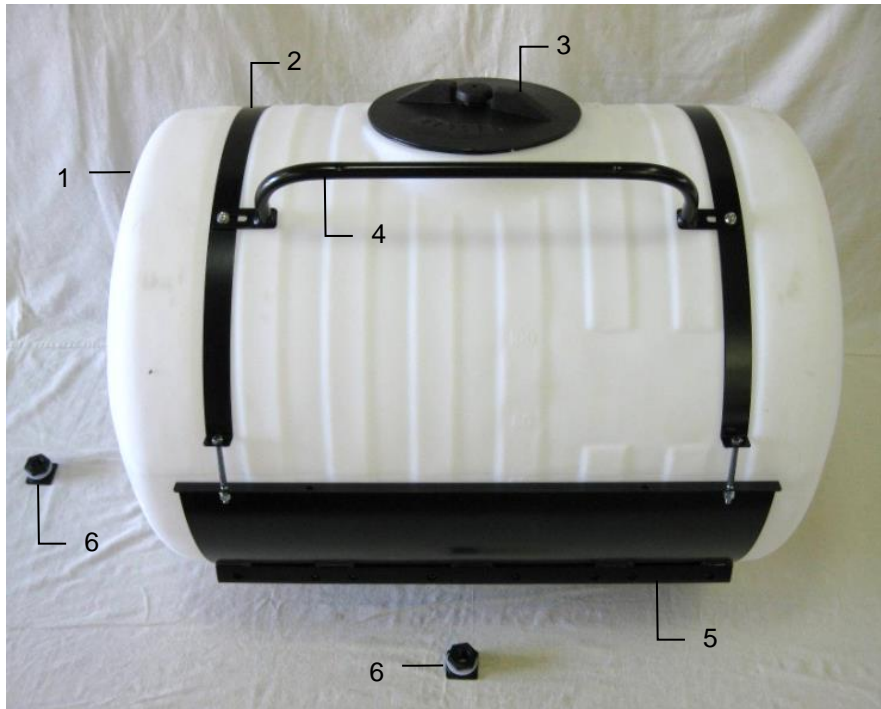

<u>Ref</u>	<u>Description</u>	<u>Part#</u>	<u>Qty</u>	<u>Ref</u>	<u>Description</u>	<u>Part#</u>	<u>Qty</u>
1	110 Gal Tank	005-9208	1	5	Tank Saddle	001-6707A	1
2	Tank Straps	001-4402B	2	6	Bottom & Side Fitting	003-EL3434	2
3	Tank Cap	005-9022E	1	7	Tank Legs	001-6707C	2
4	Handrail	001-6707HR	1				
Complete Assembly						030-0491A-TK	

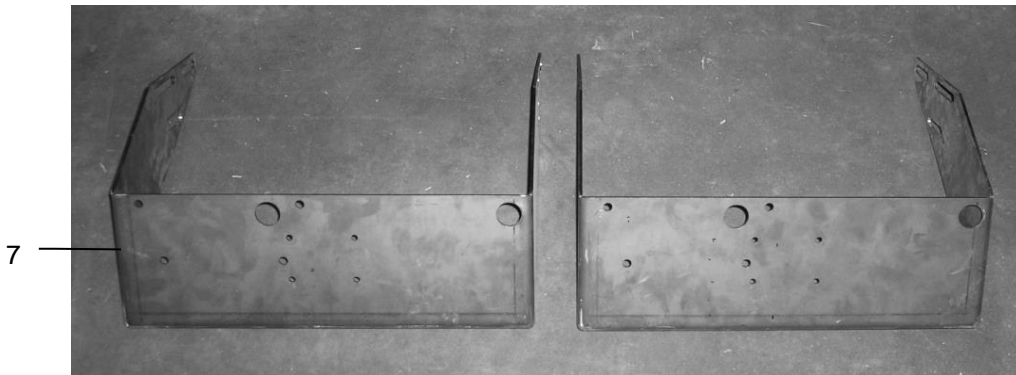

Tank Kit 460-TK



<u>Ref</u>	<u>Description</u>	<u>Part#</u>	<u>Qty</u>	<u>Ref</u>	<u>Description</u>	<u>Part#</u>	<u>Qty</u>
1	110 Gal Tank	005-9208	1	4	Tank Saddle	001-6707A	1
2	Tank Straps	001-4402B	2	5	Bottom Fitting	003-EL3434	1
3	Tank Cap	005-9022E	1				
					Complete Assembly	030-0460-TK	

Control Box and Wiring Harnesses

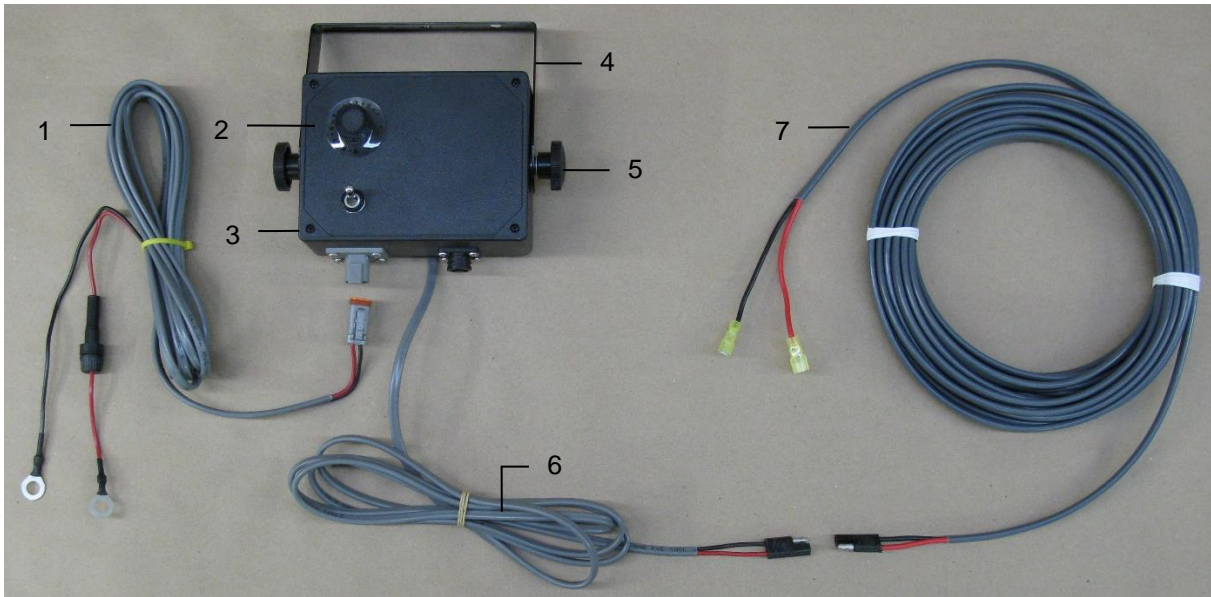

<u>Ref</u>	<u>Description</u>	<u>Part#</u>	<u>Qty</u>	<u>Ref</u>	<u>Description</u>	<u>Part#</u>	<u>Qty</u>
1	Power Cord	006-4580M	1	5	Knobs	008-0923	2
2	Speed Dial	006-2022A	1	6	Pump Lead	006-4583M	1
3	Control Box	030-0457M	1	7	Pump Lead Ext.	006-4575M	1
4	U-Bracket	001-2012E	1				

Gauge

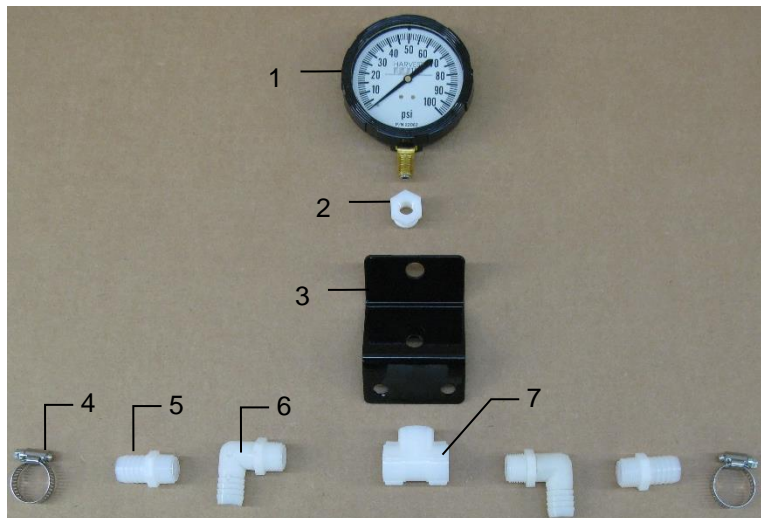

<u>Ref</u>	<u>Description</u>	<u>Part#</u>	<u>Qty</u>	<u>Ref</u>	<u>Description</u>	<u>Part#</u>	<u>Qty</u>
1	Gauge	002-2208Z	1	5	1/2" x 3/4" Straight	003-A1234	2
2	1/2" x 1/4" Reducer	003-RB1214	2	6	1/2" x 3/4" Elbow	003-EL1234	2
3	Gauge Holder	001-4717	1	7	1/2" Tee	003-TT12	1
4	Hose Clamp	003-9004	2				

Pump Assembly PMP-4210X-A

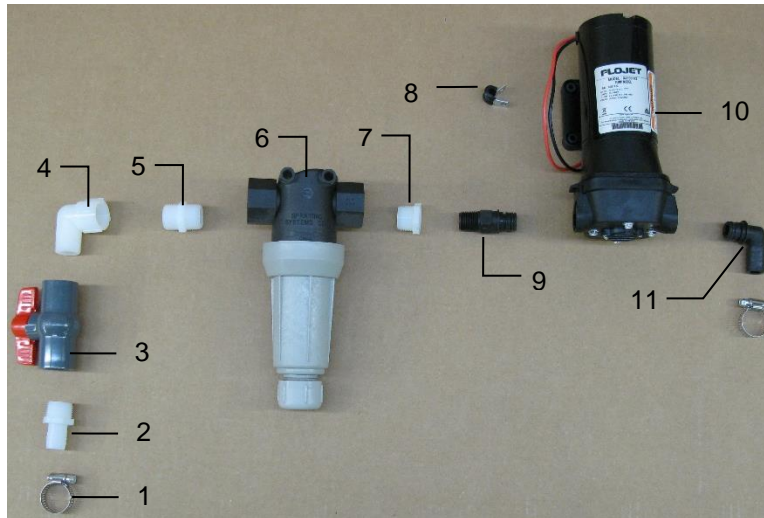

<u>Ref</u>	<u>Description</u>	<u>Part#</u>	<u>Qty</u>	<u>Ref</u>	<u>Description</u>	<u>Part#</u>	<u>Qty</u>
1	Hose Clamp	003-9004	2	7	3/4" x 1/2" Reducer	003-RB3412	1
2	3/4" x 3/4" Straight	003-A3434	1	8	1/4" Jiffy Clip	008-9011	1
3	3/4" Ball Valve	002-2200	1	9	1/2" Straight Coupler	007-4121KS	1
4	3/4" Street Elbow	003-SE34	1	10	Pump	007-4210CE	1
5	3/4" Union	003-M3434	1	11	3/4" Elbow Coupler	007-4121K	1
6	3/4" Filter	002-4318	1				

Pump Assembly PMP-4210X-B

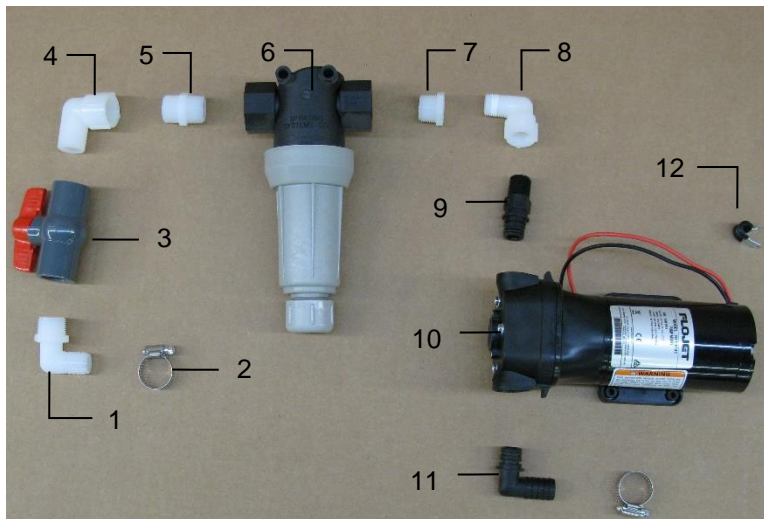

<u>Ref</u>	<u>Description</u>	<u>Part#</u>	<u>Qty</u>	<u>Ref</u>	<u>Description</u>	<u>Part#</u>	<u>Qty</u>
1	3/4" x 3/4" Elbow	003-EL3434	1	7	3/4" x 1/2" Reducer	003-RB3412	1
2	Hose Clamp	003-9004	2	8	1/2" Street Elbow	003-SE12	1
3	3/4" Ball Valve	002-2200	1	9	1/2" Straight Coupler	007-4121KS	1
4	3/4" Street Elbow	003-SE34	1	10	Pump	007-4210CE	1
5	3/4" Union	003-M3434	1	11	3/4" Elbow Coupler	007-4121K	1
6	3/4" Filter	002-4318	1	12	1/4" Jiffy Clip	008-9011	1

Parts Bag #18

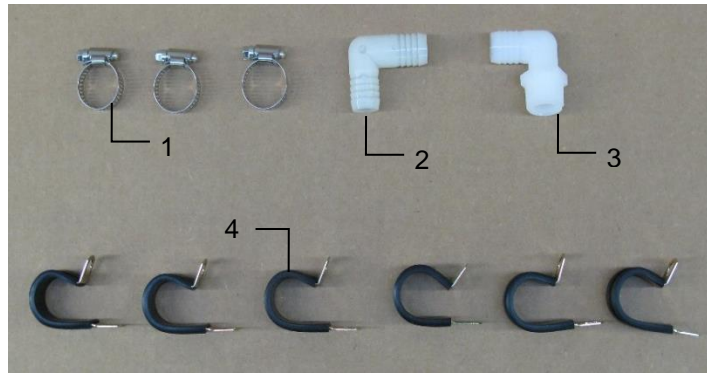

<u>Ref</u>	<u>Description</u>	<u>Part#</u>	<u>Qty</u>	<u>Ref</u>	<u>Description</u>	<u>Part#</u>	<u>Qty</u>
1	Hose Clamp	003-9004	3	3	3/4" x 3/4" Elbow	003-EL3434	1
2	3/4" Elbow	003-EL34	1	4	1" Jiffy Clip	008-9009	1

Complete Assembly PMP-#18

442C Pump Plate

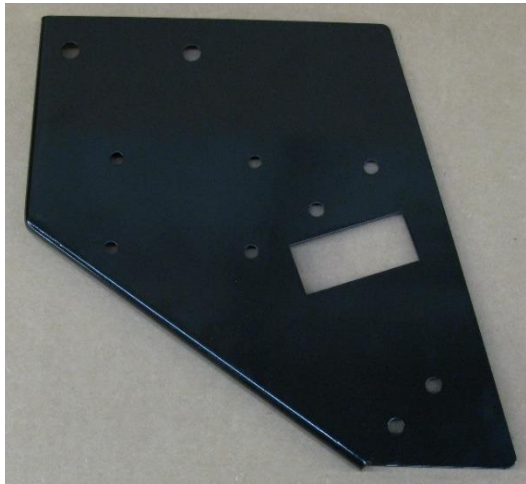

BBXHI Pump Mount

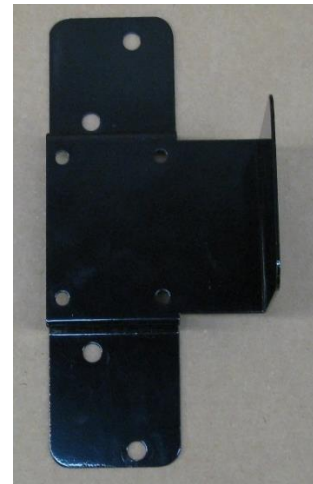

<u>Ref</u>	<u>Description</u>	<u>Part#</u>	<u>Qty</u>	<u>Ref</u>	<u>Description</u>	<u>Part#</u>	<u>Qty</u>
1	Front Pump Plate Mount	001-4703XE	1	1	BB Pump Plate Mount	001-46707Q	1

Parts Breakdown for Drain / Fill Kit

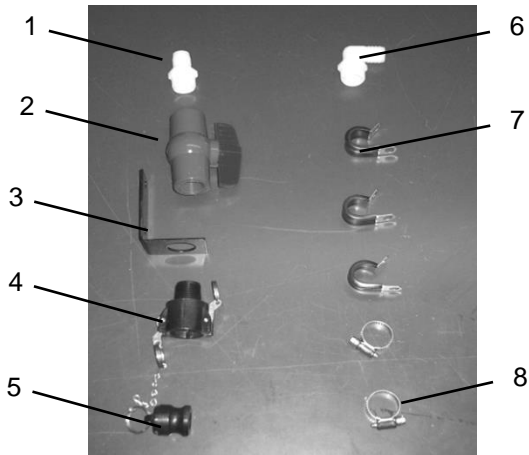

<u>Ref</u>	<u>Description</u>	<u>Part #</u>	<u>Qty</u>
1	Straight fitting	003-A3434	1
2	Ball valve	002-2200	1
3	Valve holder	001-6702H	1
4	Female coupler	002-2204A	1
5	Male coupler	002-2205G	1
6	Elbow	003-EL3434	1
7	Jiffy clip	008-9010	3
8	Hose clamp	003-9004	2
NP	3/4" Hose	002-9002	10ft

Install Kit 442CXHI-SO

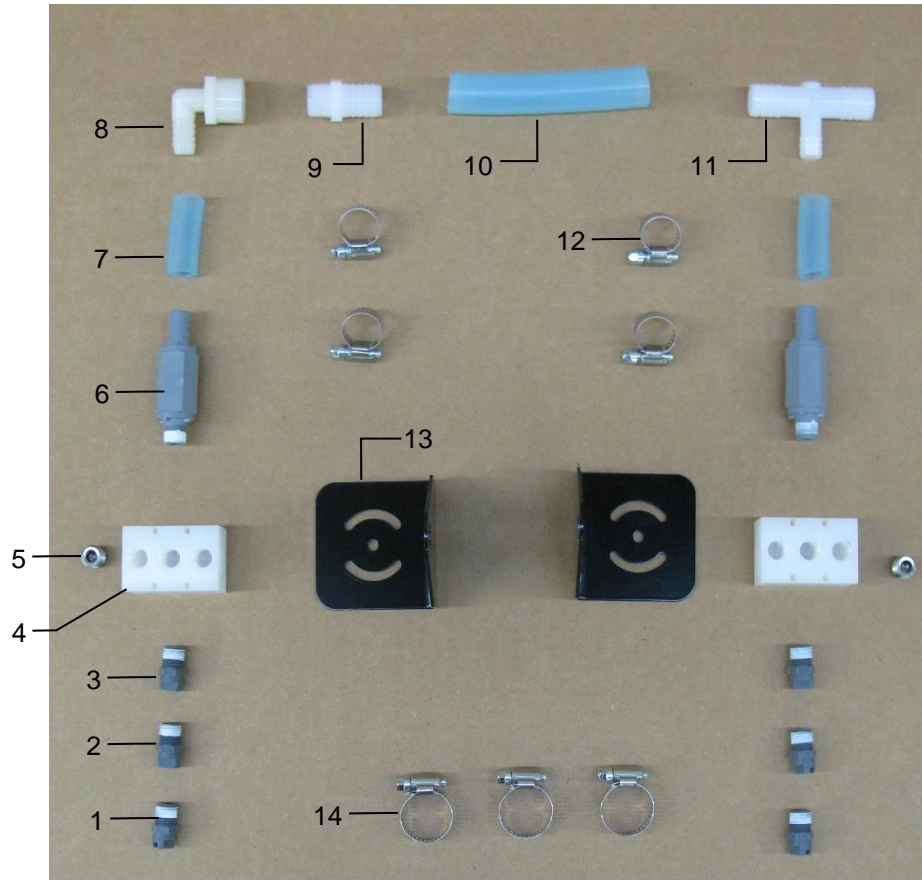

<u>Ref</u>	<u>Description</u>	<u>Part#</u>	<u>Qty</u>	<u>Ref</u>	<u>Description</u>	<u>Part#</u>	<u>Qty</u>
1	Low Output Tip	004-T8004-PT	2	8	1/2" x 1/2" Elbow	003-EL1212F	1
2	Med Output Tip	004-T8008-PT	2	9	1/2" x 3/4" Straight	003-A1234	1
3	High Output Tip	004-T8015-PT	2	10	3/4" Hose	002-9002	3
4	Spray Shield Block	001-4435NSB	2	11	3/4" x 1/2" Tee	003-T3412HB	1
5	1/4" Plug	003-F14A	2	12	#6 Hose Clamp	003-9003	4
6	Check Valve	002-4564X	2	13	Spray Shield Holder	001-4703XD	2
7	1/2" Hose	002-9001	2	14	#10 Hose Clamp	003-9004	3
Complete Assembly						030-0442CXHI-SO	

Install Kit 44255XHI-SO

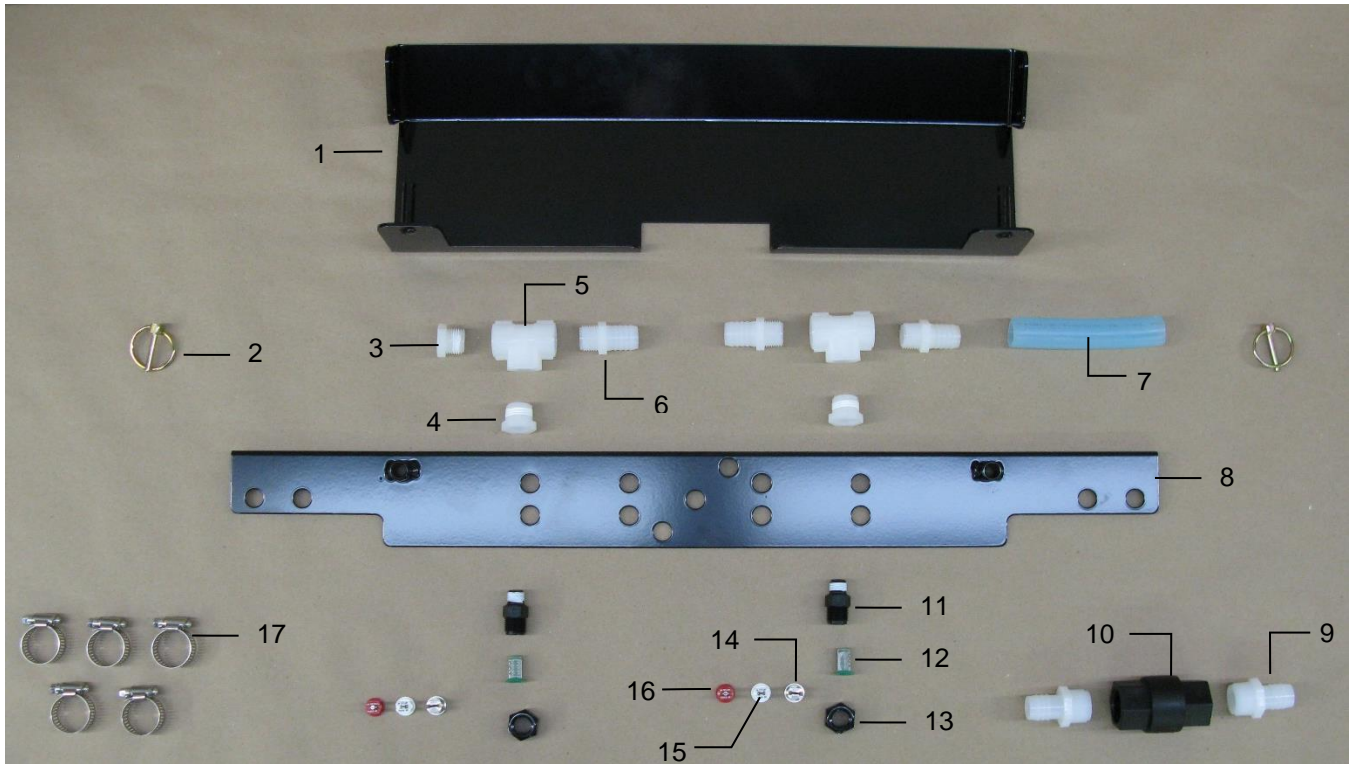

<u>Ref</u>	<u>Description</u>	<u>Part#</u>	<u>Qty</u>	<u>Ref</u>	<u>Description</u>	<u>Part#</u>	<u>Qty</u>
1	Spray Shield Holder	001-4810BRH	1	10	3/4" Check Valve	002-4566X	1
2	Lynch Pin	008-4576	2	11	Nozzle Body	004-4722	2
3	1/2" Plug	003-F12	1	12	Tip Screen	004-1203-100	2
4	1/2" x 1/4" Reducer	003-RB1214	2	13	Nozzle Cap	004-4723	2
5	1/2" Tee	003-TT12	2	14	Low Tip – Silver	004-11015-SS	2
6	1/2" x 3/4" Straight	003-A1234	3	15	High Tip – White	004-XR11008VS	2
7	3/4" Hose	002-9002	2	16	Med Tip – Red	004-XR11004VS	2
8	Spray Shield	001-4810B	1	17	Hose Clamp	003-9004	5
9	3/4" x 3/4" Straight	003-A3434	2				
					Complete Assembly	030-044255XHI-SO	

Install Kit 4518XHI

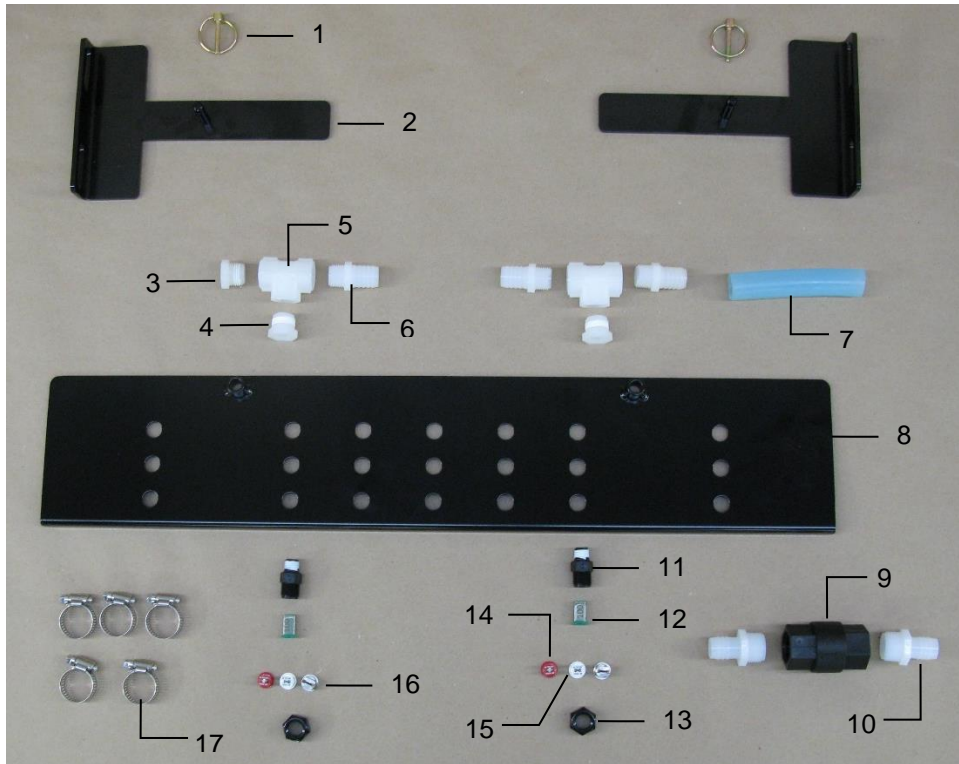

<u>Ref</u>	<u>Description</u>	<u>Part#</u>	<u>Qty</u>	<u>Ref</u>	<u>Description</u>	<u>Part#</u>	<u>Qty</u>
1	Lynch Pin	008-4576	2	10	3/4" x 3/4" Straight	003-A3434	2
2	Spray Shield Holder	001-4435H	2	11	Nozzle Body	004-4722	2
3	1/2" Plug	003-F12	1	12	Tip Screen	004-1203-100	2
4	1/2" x 1/4" Reducer	003-RB1214	2	13	Nozzle Cap	004-4723	2
5	1/2" Tee	003-TT12	2	14	Med Tip – Red	004-XR11004VS	2
6	1/2" x 3/4" Straight	003-A1234	3	15	High Tip – White	004-XR11008VS	2
7	3/4" Hose	002-9002	2	16	Low Tip – Silver	004-11015-SS	2
8	Spray Shield	001-4435ES	1	17	Hose Clamp	003-9004	5
9	3/4" Check Valve	002-4566X	1				
					Complete Assembly	030-4518XHI	

Install Kit 4523XHI-SO

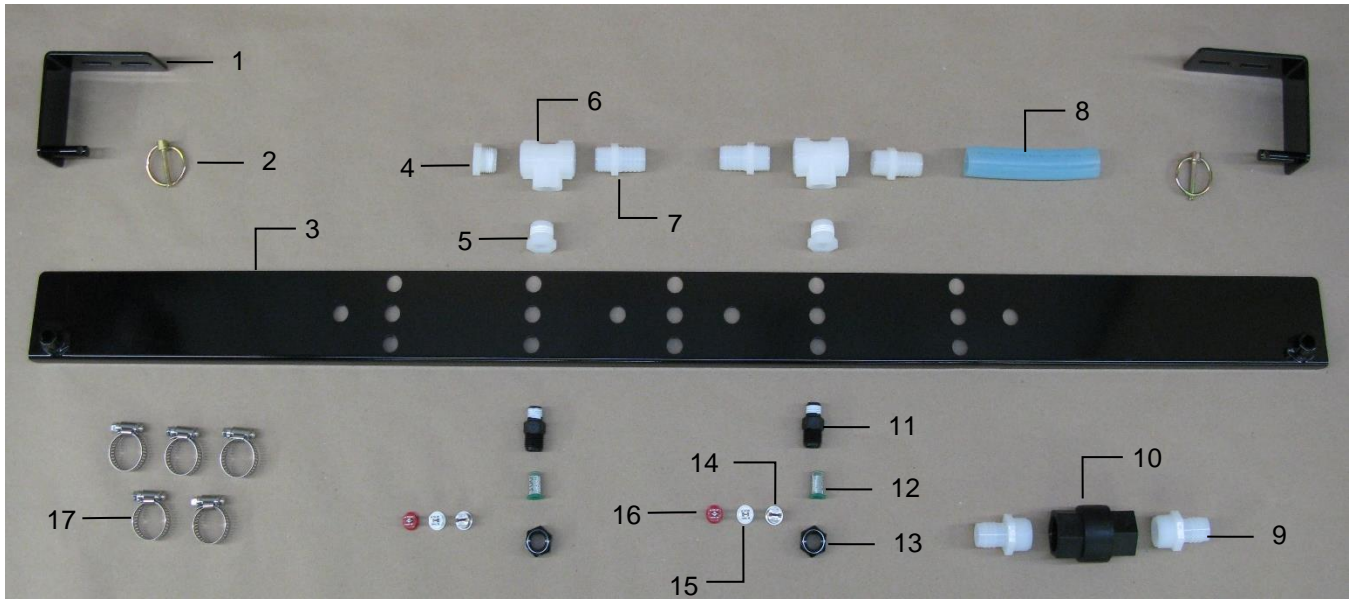

<u>Ref</u>	<u>Description</u>	<u>Part#</u>	<u>Qty</u>	<u>Ref</u>	<u>Description</u>	<u>Part#</u>	<u>Qty</u>
1	Spray Shield Holder	001-4704H	2	10	3/4" Check Valve	002-4566X	1
2	Lynch Pin	008-4576	2	11	Nozzle Body	004-4722	2
3	Spray Shield	001-4704G	1	12	Tip Screen	004-1203-100	2
4	1/2" Plug	003-F12	1	13	Nozzle Cap	004-4723	2
5	1/2" x 1/4" Reducer	003-RB1214	2	14	Low Tip – Silver	004-11015-SS	2
6	1/2" Tee	003-TT12	2	15	High Tip – White	004-XR11008VS	2
7	1/2" x 3/4" Straight	003-A1234	3	16	Med Tip – Red	004-XR11004VS	2
8	3/4" Hose	002-9002	2	17	Hose Clamp	003-9004	5
9	3/4" x 3/4" Straight	003-A3434	2				
					Complete Assembly	030-4523XHI-SO	

Install Kit 4526XHI-SO

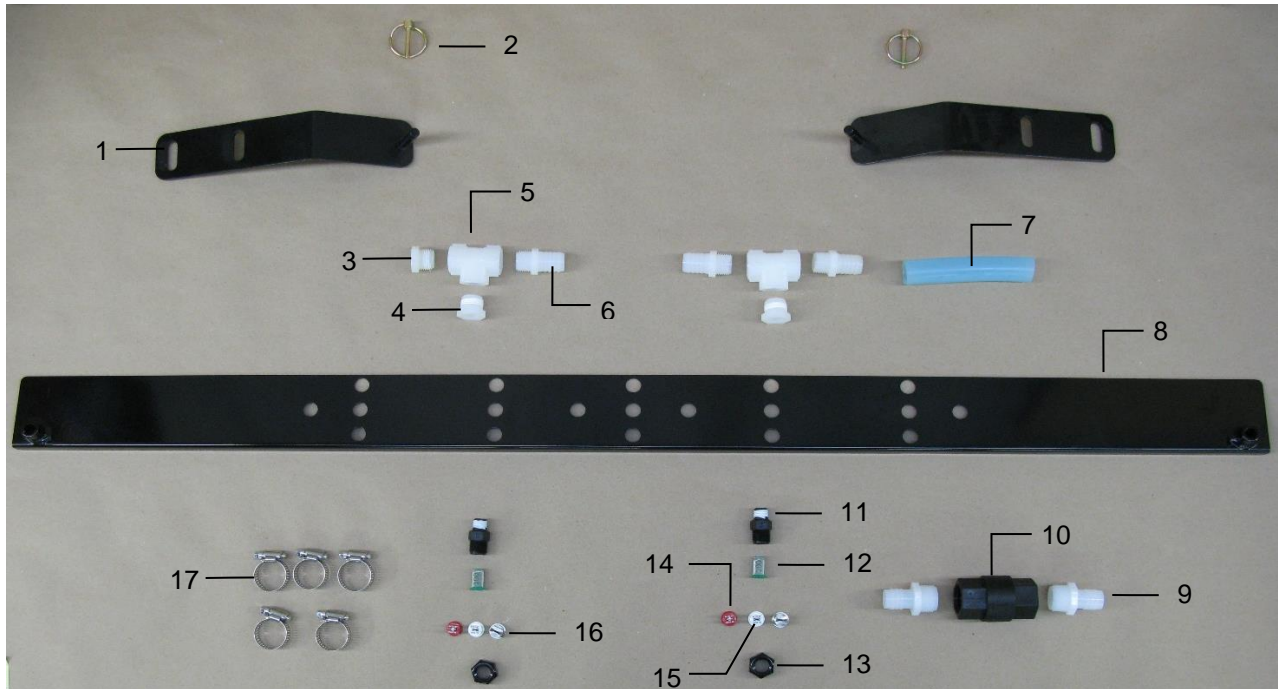

<u>Ref</u>	<u>Description</u>	<u>Part#</u>	<u>Qty</u>	<u>Ref</u>	<u>Description</u>	<u>Part#</u>	<u>Qty</u>
1	Spray Shield Holder	001-4704MC	2	10	3/4" Check Valve	002-4566X	1
2	Lynch Pin	008-4576	2	11	Nozzle Body	004-4722	2
3	1/2" Plug	003-F12	1	12	Tip Screen	004-1203-100	2
4	1/2" x 1/4" Reducer	003-RB1214	2	13	Nozzle Cap	004-4723	2
5	1/2" Tee	003-TT12	2	14	Med Tip – Red	004-XR11004VS	2
6	1/2" x 3/4" Straight	003-A1234	3	15	High Tip – White	004-XR11008VS	2
7	3/4" Hose	002-9002	2	16	Low Tip – Silver	004-11015-SS	2
8	Spray Shield	001-4704G	1	17	Hose Clamp	003-9004	5
9	3/4" x 3/4" Straight	003-A3434	2		Complete Assembly	030-4526XHI-SO	

Install Kit 4534XHI

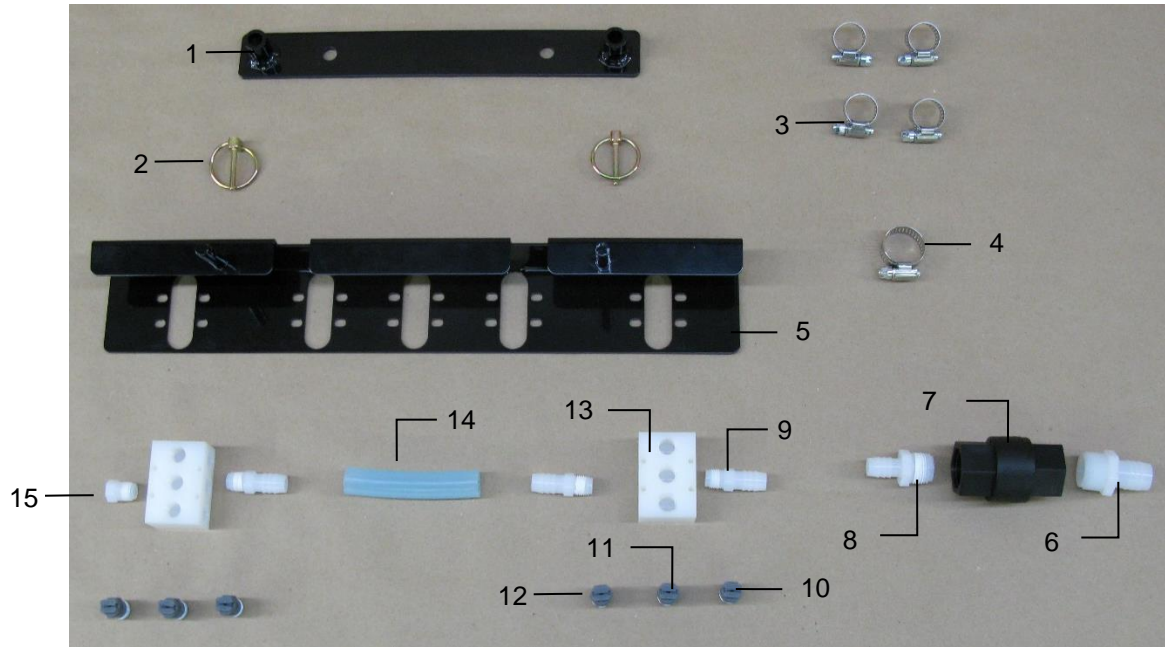

<u>Ref</u>	<u>Description</u>	<u>Part#</u>	<u>Qty</u>	<u>Ref</u>	<u>Description</u>	<u>Part#</u>	<u>Qty</u>
1	Shield Holder	001-4435NCX	1	9	1/4" x 1/2" Straight	002-A1412	3
2	Lynch Pin	008-4576	2	10	Low Tip	004-T8015-PT	2
3	Hose Clamp	003-9003	4	11	Med Tip	004-T8004-PT	2
4	Hose Clamp	003-9004	1	12	High Tip	004-T8008-PT	2
5	Spray Shield	001-4435NSX	1	13	Manifold Block	001-4435NSB	2
6	3/4" x 3/4" Straight	003-A3434	2	14	1/2" Hose	002-9001	4
7	Check Valve	002-4566X	1	15	Plug	003-F14	1
8	3/4" x 1/2" Straight	003-A3412	1				
					Complete Assembly	030-4534XHI	

Install Kit 4536XHI

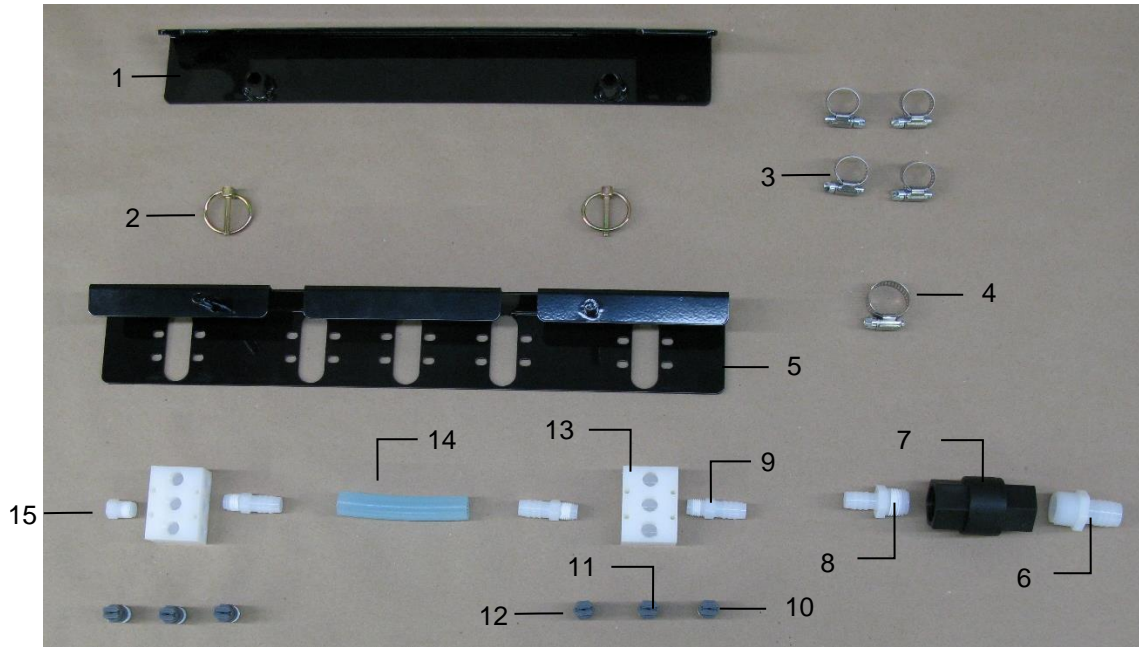

<u>Ref</u>	<u>Description</u>	<u>Part#</u>	<u>Qty</u>	<u>Ref</u>	<u>Description</u>	<u>Part#</u>	<u>Qty</u>
1	Shield Holder	001-4435NC	1	9	1/4" x 1/2" Straight	002-A1412	3
2	Lynch Pin	008-4576	2	10	Low Tip	004-T8015-PT	2
3	Hose Clamp	003-9003	4	11	Med Tip	004-T8004-PT	2
4	Hose Clamp	003-9004	1	12	High Tip	004-T8008-PT	2
5	Spray Shield	001-4435NSX	1	13	Manifold Block	001-4435NSB	2
6	3/4" x 3/4" Straight	003-A3434	2	14	1/2" Hose	002-9001	4
7	Check Valve	002-4566X	1	15	Plug	003-F14	1
8	3/4" x 1/2" Straight	003-A3412	1				
					Complete Assembly	030-4536XHI	

Install Kit 4542XHI

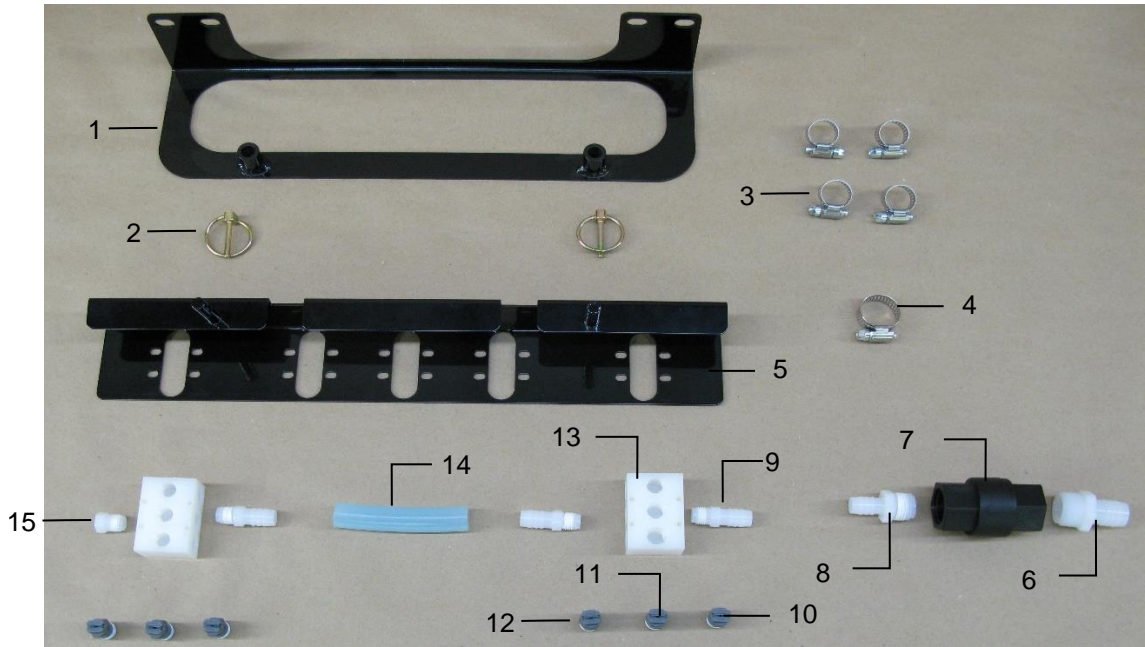

<u>Ref</u>	<u>Description</u>	<u>Part#</u>	<u>Qty</u>	<u>Ref</u>	<u>Description</u>	<u>Part#</u>	<u>Qty</u>
1	Shield Holder	001-4435NAX	1	9	1/4" x 1/2" Straight	002-A1412	3
2	Lynch Pin	008-4576	2	10	Low Tip	004-T8015-PT	2
3	Hose Clamp	003-9003	4	11	Med Tip	004-T8004-PT	2
4	Hose Clamp	003-9004	1	12	High Tip	004-T8008-PT	2
5	Spray Shield	001-4435NSX	1	13	Manifold Block	001-4435NSB	2
6	3/4" x 3/4" Straight	003-A3434	2	14	1/2" Hose	002-9001	4
7	Check Valve	002-4566X	1	15	Plug	003-F14	1
8	3/4" x 1/2" Straight	003-A3412	1				

Complete Assembly 030-4542XHI

Install Kit 4714JSX-SO

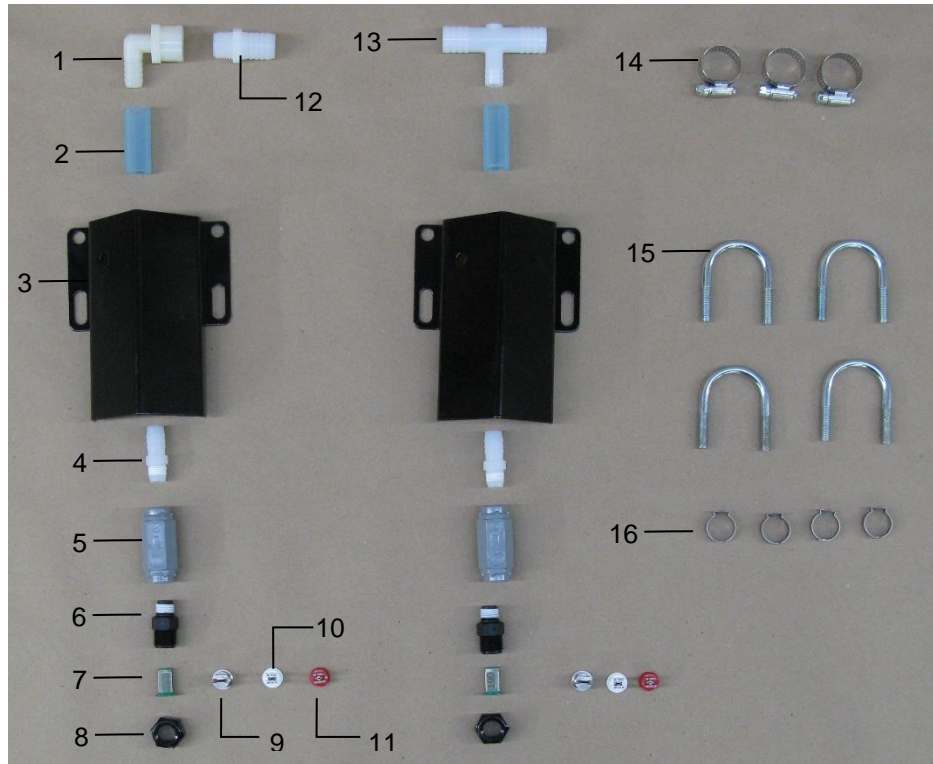

<u>Ref</u>	<u>Description</u>	<u>Part#</u>	<u>Qty</u>	<u>Ref</u>	<u>Description</u>	<u>Part#</u>	<u>Qty</u>
1	1/2" x 1/2" Elbow	003-EL1212F	1	9	Low Tip – Silver	004-11015-SS	2
2	1/2" Hose	002-9001	1	10	High Tip – White	004-XR11008VS	2
3	Nozzle Shield Short	001-4714JS	2	11	Med Tip – Red	004-XR11004VS	2
4	1/4" x 1/2" Straight	002-A1412	2	12	1/2" x 3/4" Straight	003-A1234	1
5	Check Valve	002-4564X	2	13	3/4" x 1/2" Tee	003-T3412HB	1
6	Nozzle Body	004-4722	2	14	3/4" Hose Clamp	003-9004	3
7	Tip Screen	004-1203-100	2	15	U-Bolt	001-4714UBS	4
8	Nozzle Cap	004-4723	2	16	1/2" Otiker Clamp	003-9008	4
					Complete Assembly	030-4714JSX-SO	

Notes

Harvest Tec Inc. Warranty and Liability Agreement

Harvest Tec, Inc. will repair or replace components that are found to be defective within 12 months from the date of manufacture. Under no circumstances does this warranty cover any components which in the opinion of Harvest Tec, Inc. have been subjected to negligent use, misuse, alteration, accident, or if repairs have been made with parts other than those manufactured and obtainable from Harvest Tec, Inc.

Our obligation under this warranty is limited to repairing or replacing free of charge to the original purchaser any part that in our judgment shows evidence of defective or improper workmanship, provided the part is returned to Harvest Tec, Inc. within 30 days of the failure. If it is determined that a non-Harvest Tec branded hay preservative has been used inside the Harvest Tec applicator system where the failure occurred, then Harvest Tec reserves the right to deny the warranty request at their discretion. Parts must be returned through the selling dealer and distributor, transportation charges prepaid.

This warranty shall not be interpreted to render Harvest Tec, Inc. liable for injury or damages of any kind, direct, consequential, or contingent, to persons or property. Furthermore, this warranty does not extend to loss of crop, losses caused by delays or any expense prospective profits or for any other reason. Harvest Tec, Inc. shall not be liable for any recovery greater in amount than the cost or repair of defects in workmanship.

There are no warranties, either expressed or implied, of merchantability or fitness for particular purpose intended or fitness for any other reason.

This warranty cannot guarantee that existing conditions beyond the control of Harvest Tec, Inc. will not affect our ability to obtain materials or manufacture necessary replacement parts.

Harvest Tec, Inc. reserves the right to make design changes, improve design, or change specifications, at any time without any contingent obligation to purchasers of machines and parts previously sold.

Revised 4/17

HARVEST TEC, INC.
P.O. BOX 63
2821 HARVEY STREET
HUDSON, WI 54016
PHONE: 715-386-9100
1-800-635-7468
FAX: 715-381-1792