

Installation Manual

Model 446, 447, & 449 ***25 & 55 gallon Preservative Applicators***



*Equipment and Products
for Quality Hay.™*

P.O. Box 63 • 2821 Harvey Street • Hudson, WI 54016
800-635-7468 • www.harvesttec.com

(Intentionally blank)

Harvest Tec 446 – 447 – 449 Installation Table of Contents

	<u>Page</u>
Introduction	5
Model reference	5
Tools Needed	5
Installation of applicator	6-41
1. Installation of mounting brackets, tank, and reach rods	6-15
Model 446	6-7
Install kit 4483B & 4516B	6
Install kit 4484B	7
Install kit 4486B	7
Model 449	8-14
Install kit 4503B	8-9
Install kit 4504B & 4517B	10
Install kit 4505B	11
Install kit 4508B	12
Install kit 4523B	13
Install kit 4524B	14
Install kit 4526B	15
Model 447	16
2. Installation of pump manifold	17-19
Model 446	17
Model 447	18
Model 449	19
3. Placement of spray nozzle assemblies and nozzle tubes	20-27
Install kits 4483B, 4484B, 4486B & 4504B	20
Install kit 4503B	21
Install kit 4508B	22-23
Install kit 4516B and 4517B	24
Install kit 4523B & 4524B	25
Install kit 4526B	25
Install kit 447-SO	27
4. Installation of drain fill kit (model 447 & 449 only)	28
5. Installation of plumbing	28
6. Installation of latch extension (model 447 only)	29
7. Installation of moisture sensor pads and disks	30-40
Install kit 4484B, 4486B, & 4505B, 4523	30
Install kit 4483B, 4504B, 4516B, & 4517B	31
Install kit 4503B	32-34
Install kit 4508B	35-36
Install kit 4524B	37-38
Install kit 447-SO	39-40
8. Power cable and main wiring Harnesses Installation	41
System wiring diagram	41
Installation of control	42
Pin Outs	43-44
Parts Breakdowns	45-62
446 Base kit	45
447 Base kit	45
449 Base kit	46
Drain Fill Kit (Models 447 & 449 only)	46
Pump Manifold	47
Moisture Sensors and Hoses	48
Control Box and Wiring Harnesses	49
Baler Specific Installation Kits	50-61

Harvest Tec model 4400CB	50
Harvest Tec model 447-SO	51
Harvest Tec model 4483B	52
Harvest Tec model 4484B	53
Harvest Tec model 4486B	54
Harvest Tec model 4503B	55
Harvest Tec model 4504B	56
Harvest Tec model 4505B	57
Harvest Tec model 4516B	58
Harvest Tec model 4517B	59
Harvest Tec model 4523B	60
Harvest Tec model 4524B	61
Harvest Tec model 4526B	62
Selecting Tips-Reference Guide	63
Warranty Statement	64

Introduction

Congratulations and thank you for purchasing a Harvest Tec Model 446, 447 or 449 applicator. Please read this manual carefully to ensure correct steps are taken to attach the applicator to the baler. This applicator is designed to apply Harvest Tec buffered propionic acid. The model 446 & 447 & 449 base kit includes the following parts: Tank, Frame, Pumps, Hose, Baler Mounted Processor, Touchscreen Display, Moisture Sensors, Spray shield assembly and Miscellaneous Hardware. For your convenience we have included a parts break down for the applicator.

Model reference

Baler make	Baler Model	Model	Installation kit	Tank size
Case IH	All RBX & RB series four foot wide	447	447-SO	25 gallon
Case IH	All RBX & RB series five foot wide	447	447-SO	55 gallon
Challenger	RB 46 & 56	449	4508B	55 gallon
Challenger	453, 463 & 563	449	4524B	55 gallon
Claas	All Variant balers	446	4484B	25 gallon
New Holland	640-688 round balers	446	4486B	25 gallon
New Holland	630-638 round balers, & BR 730	446	4484B	25 gallon
New Holland	All BR series four foot wide	447	447-SO	25 gallon
New Holland	All BR series five foot wide	447	447-SO	55 gallon
John Deere	582 & 854 round balers	449	4503B	55 gallon
John Deere	5, 6 & 7 series	446	4483B	26 gallon
John Deere	5, 6 & 7 series	449	4504B	55 gallon
John Deere	8 & 9 series	446	4516B	25 gallon
John Deere	8 & 9 series	449	4517B	55 gallon
Massey Ferguson	800-900 series round balers & 5446-5556 & 2646-2766	449	4508B	55 gallon
Massey Ferguson	2846-2856A	449	4524B	55 gallon
McHale	V660	449	4526B	55 gallon
Other	Round balers	446	4484B	25 gallon
Vermeer	604M & 605M	449	4505B	55 gallon

Tools Needed

Standard wrench set
Standard screw driver or 5/16" nut driver
SAE sock set
Drill bit set
Center punch

Side cutter
Hose cutter
Hammer
Crescent wrench

Installation of the applicator

1. Installation of mounting brackets, tank, and reach rods

Model 446

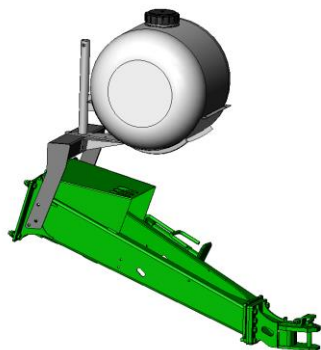

Install kit 4483B & 4516B

The base bracket straddles the baler's tongue resting up against the tongue's intersection with the baler's cross frame (for 8 Series and older). The bracket is bolted to the baler using three bolts on each side holding the tongue to the cross frame. Replace each of these bolts with the longer bolts provided (for 9 Series only two bolts per side are used). The tank mounting bracket may flex when tightening down bolts because some hitches are welded at different angles. Install the tank on top of the stub pipe; the tank saddle will be secured with the 1/2" x 1-1/2" inch hardware. The bottom support plate will attach to the bottom of the saddle and to the front of the mounting bracket. Tighten down and secure all hardware.

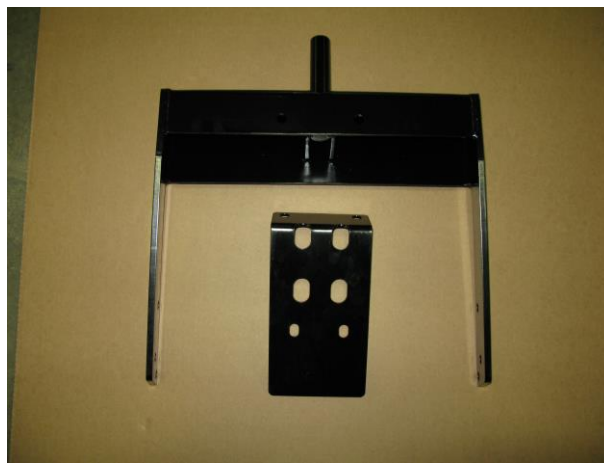
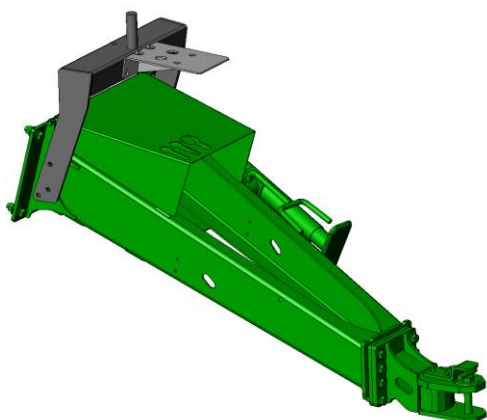

Install kit 4484B

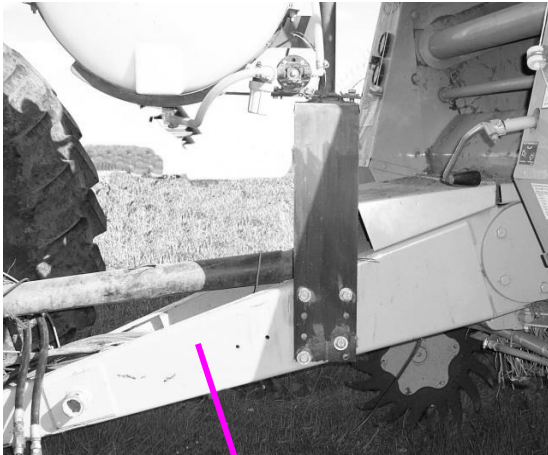
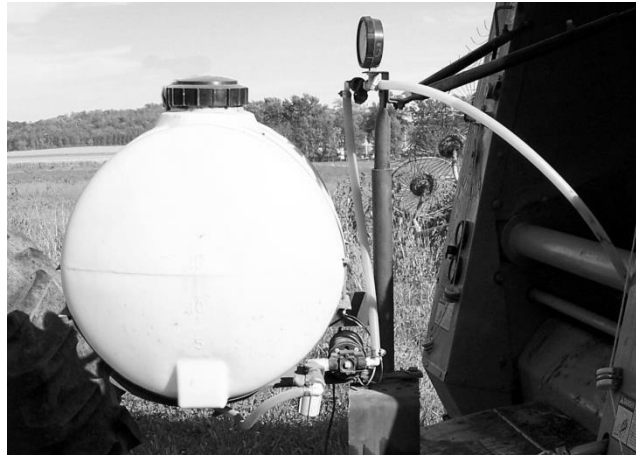

Figure 1



Locate the base bracket (Figure 1) on the baler's tongue or cross frame. Care must be taken to make sure the applicator will be clear of the balers moving parts and the rear wheels of the tractor. Line up the bracket with any existing holes, drill new if necessary. The bracket will be secured with four 1/2" bolts. Mount the tank on top of the stub pipe. Secure with the 1/2" x 1-1/2" bolt and hardware. Secure the reach rods from the top of the stub pipe to the baler forming a V or triangle shape. Note: reach rods may have to be bent on the tab to align properly.

Install kit 4486B



Figure 2



Locate the mounting bracket (Figure 2) on the front of the baler's tongue where it joins the hitch acceptor. Use the bolts 5/8" included to join the two parts of the baler. Orient the bracket so the two holes on top of the bracket will face away from the baler this will allow the applicator to face rearward. Install the tank on top of the mounting bracket using two 1/2" x 1-1/2" bolts and hardware. The tank will face towards the baler when installation is complete. Secure the reach rods from the top of the stub pipe to the baler forming a V or triangle shape. The reach rods will need to be connected to the top of the baler to permit easy opening of the twine or net wrap door. Note: reach rods may have to be bent on the tab to align properly.

Model 449

Installation of tank

Locate parts bag 7. Place tank (005-9203) onto saddle (001-4703). Make sure side tank fitting is placed to the baler's left side when looking at it from the front. Attach straps (001-4402) to saddle using 5/16" x 4" bolts. Make sure to double nut all four bolts.

Installation of mounting brackets

Install kit 4503B for John Deere 582 round balers

The mounting brackets are L-shaped. There is a right and left bracket enclosed in the applicator. This can be determined by setting the right and left bracket next to each other with the longer legs lying flat toward you and the shorter legs pointing up. The short leg of the bracket will either touch each other or angle away from each other. Place the brackets so they angle away from each other and form a **V** (see below). The bracket on the left is the left bracket and the bracket to the right is the right bracket.

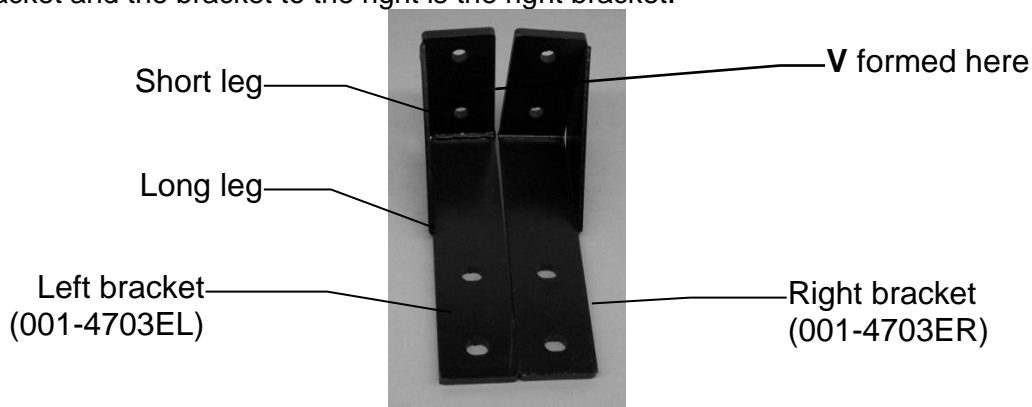

Before installing the brackets, the baler tongue must be supported by some means other than the jack (ex. hooked to a tractor). Looking at the baler from the front, the right bracket bolts to the left side of the hitch using two M16 x 55mm bolts, washers, lock washers, and nuts (labeled **L1** below). Short leg of brackets will point toward the front of the hitch. Next remove the two bolts holding the jack assembly to a baler (labeled **L2** below). Insert the right L-bracket between the jack assembly and baler. Bolt together with two M16 x 70mm bolts. Attach the tank legs (001-4703B) to the tank saddle with 3/8" x 1" bolts, locks, and flat washers. Attach the saddle legs to the mounting bracket with 1/2" x 1-1/2" bolts, locks, nuts and flat washers.

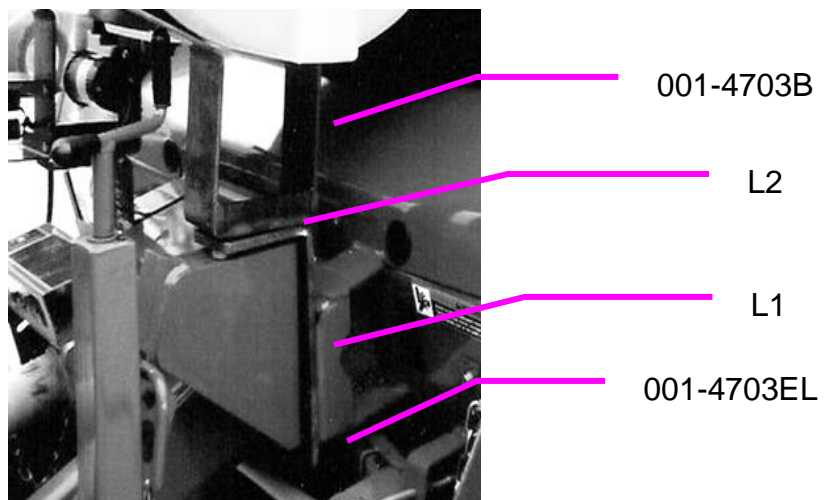

Install kit 4503B for John Deere 854 balers

The mounting brackets are L-shaped. There is a right and left bracket enclosed in the applicator. This can be determined by setting the right and left bracket next to each other with the longer legs lying flat toward you and the shorter legs pointing up. The short leg of the bracket will either touch each other or angle away from each other. Place the brackets so they angle away from each other and form a **V** (see below). The bracket on the left is the left bracket and the bracket to the right is the right bracket.

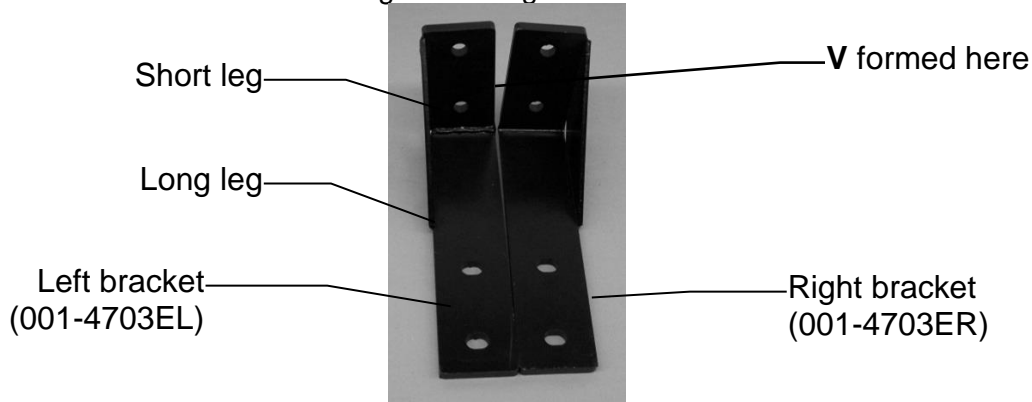

Before installing the brackets, the baler tongue must be supported by some means other than the jack (ex. hooked to a tractor). Looking at the baler from the front, the right bracket bolts to the left side of the hitch using two M16 x 55mm bolts, washers, lock washers, and nuts (labeled **L1** below). Short leg of brackets will point toward the front of the hitch. Next remove the two bolts holding the jack assembly to a baler (labeled **L2** below). Remove the jack from the mounting bracket and install jack extension (001-4703EXT) as shown below (3). Use the supplied hardware to mount the jack to the extension (*hole 4* M16x2mm)(*hole 5* M20x2.5mm)(*hole 6* M12 x 1.75mm), and use the factory jack hardware and mounting plates to mount the extension to the baler. Insert the right L-bracket between the jack assembly and baler. Bolt together with two M16 x 70mm bolts. Attach the tank legs (001-4703B) to the tank saddle with 3/8" x 1" bolts, locks, and flat washers. Attach the leg with 1/2" x 1-1/2" bolts, locks, nuts and flat washers.

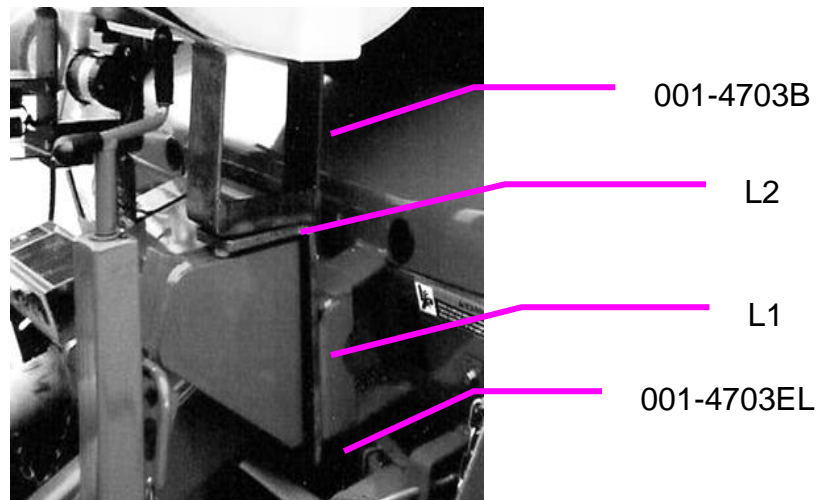
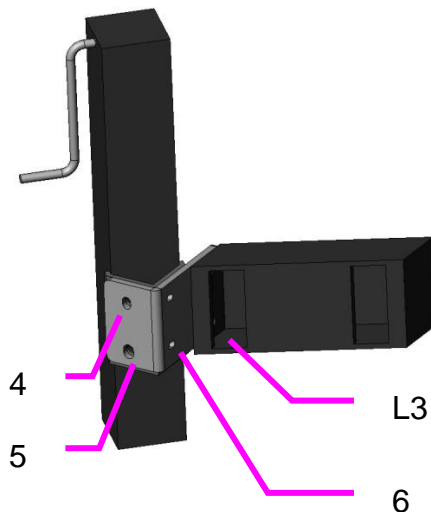

Install kit 4504B & 4517B

Attach legs part #001-4703B to the tank saddle with 3/8" x 1" bolts, lock and flat washers. The L-shaped brackets part #001-4703DL and #001-4703DR will attach to the baler with M12 x 45 mm bolts. Three bolts will be used per side on 8 Series balers and two bolts per side with the 9 Series balers. When both sides have been attached place the legs on top of the bracket. The legs will attach to the brackets with 1/2" x 1-1/2" bolts, nuts, flat, and lock washers. Install both sides of legs before tightening down any of the bolts.

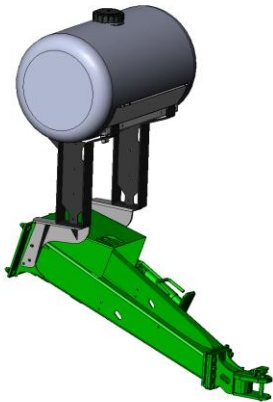
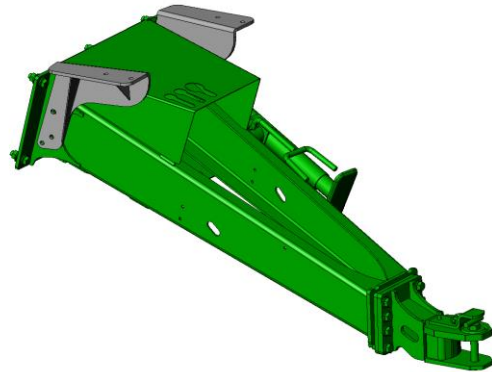

Install kit 4505B

Locate legs part #001-4703FL and part #001-4703FR. These legs will attach to the tongue of the baler using the one existing hole per side as shown by arrow A. Loosely attach the legs to point A and mark the two holes that will need to be drilled as shown by arrow B with a 9/16" bit. Attach legs loosely using the two existing bolts and lock nuts and four 1/2" x 1-1/4" bolt, nuts, locks and flat washers. Install tank and saddle assembly. Tighten all leg hardware after the tank has been installed.

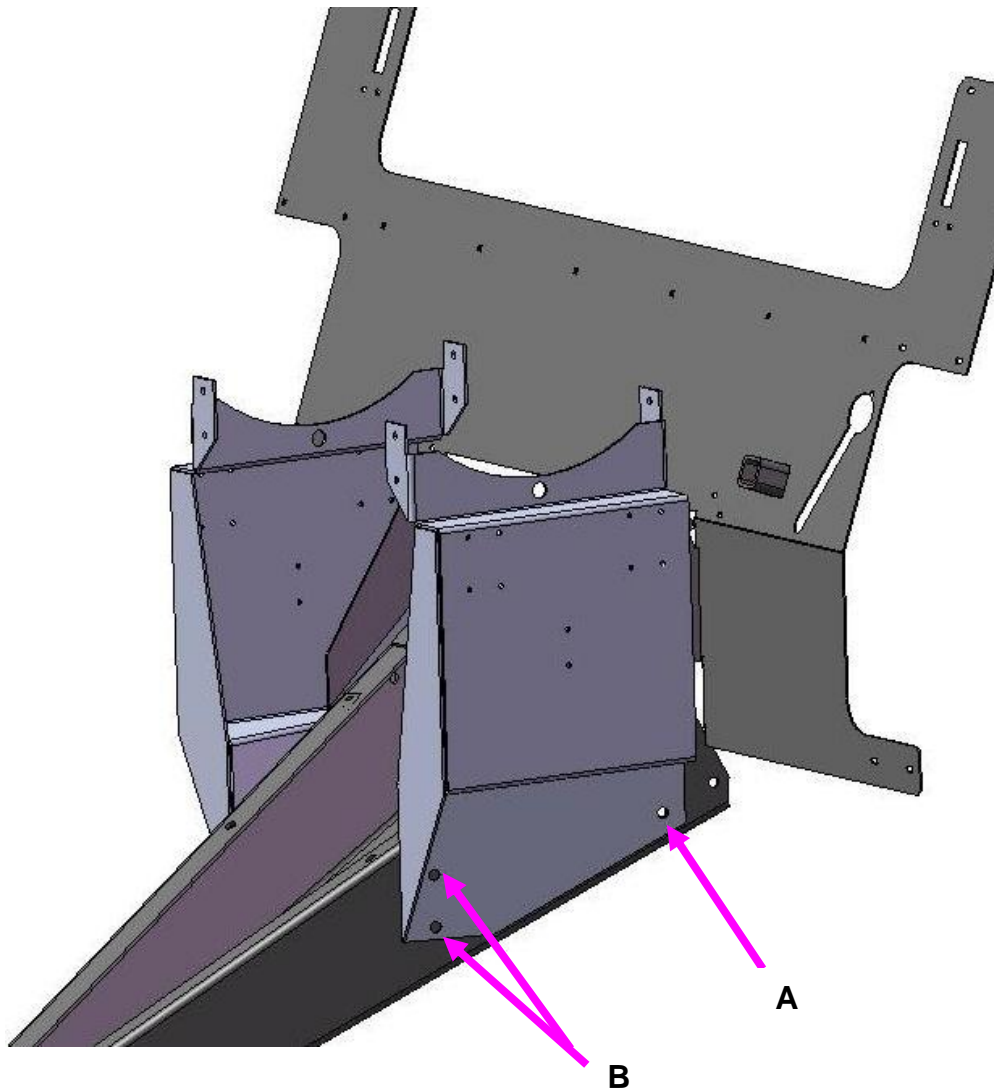

Install kit 4508B

Locate legs part #001-4703K and part #001-4703L. Use the diagram below to locate the placement of the holes you will need to drill. You will need to drill three 1/2" holes per side of tongue. After drilling the holes you will need to loosely attach the legs to the tongue with 1/2" X 2" bolts with locks, nuts, and flat washers. (Figure 1) Attach the saddle (001-4703) and tank assembly on top of the legs using 3/8" x 1" bolts and lock washers. (Figure 2) Do not tighten down 3/8" bolts all the way. Once saddle is attached to legs tighten down bolts and nuts attaching the legs to the tongue. Now tighten down bolts attaching saddle to legs.

Figure 1

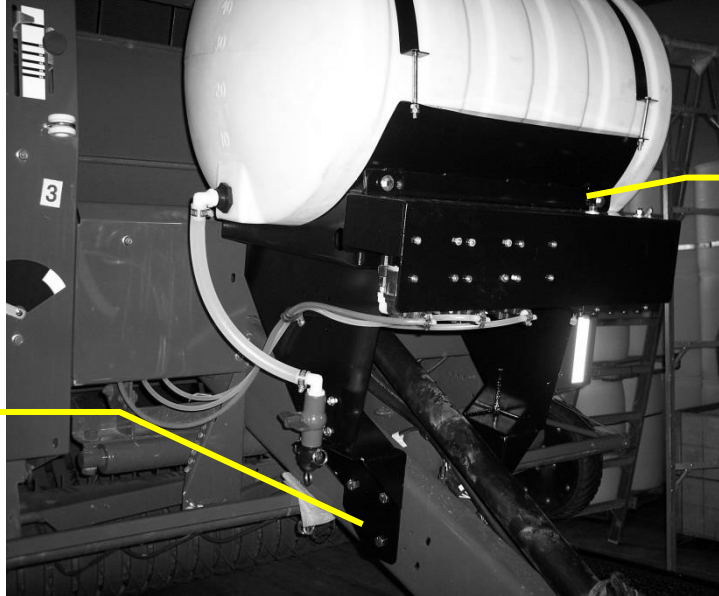
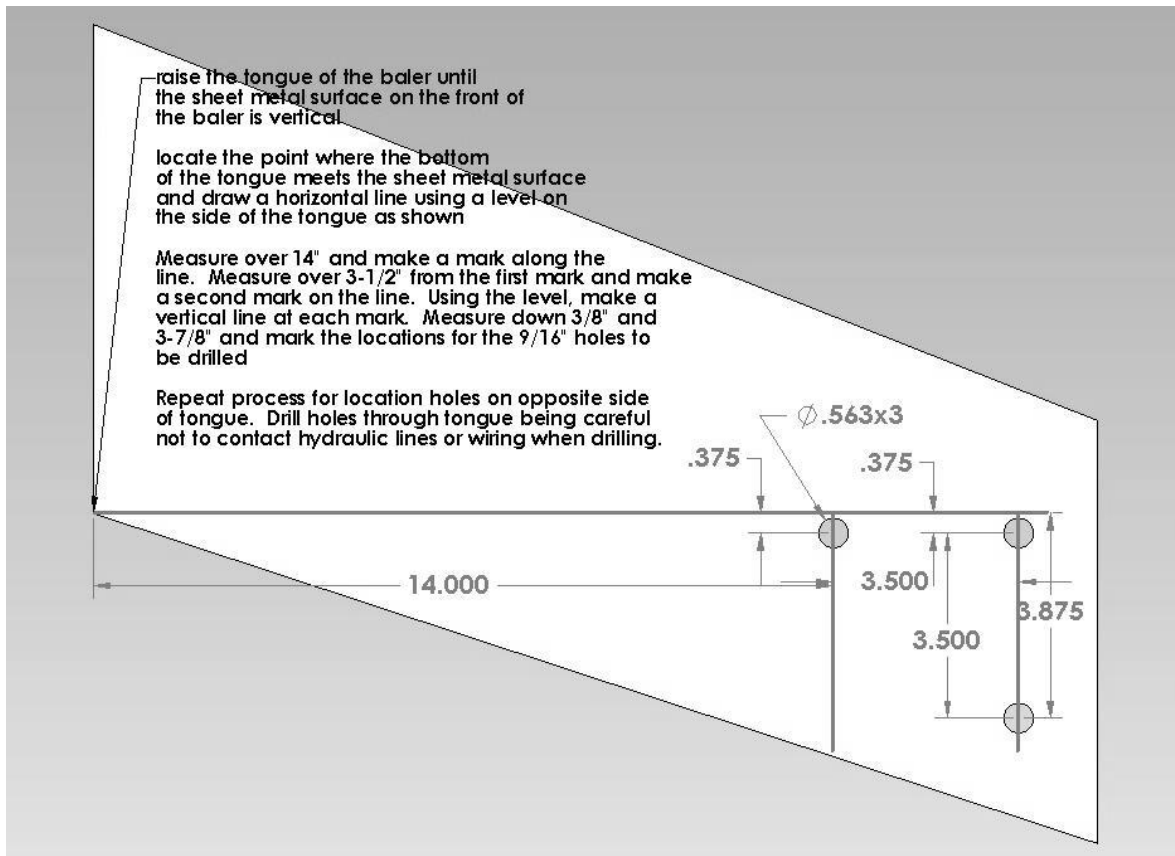
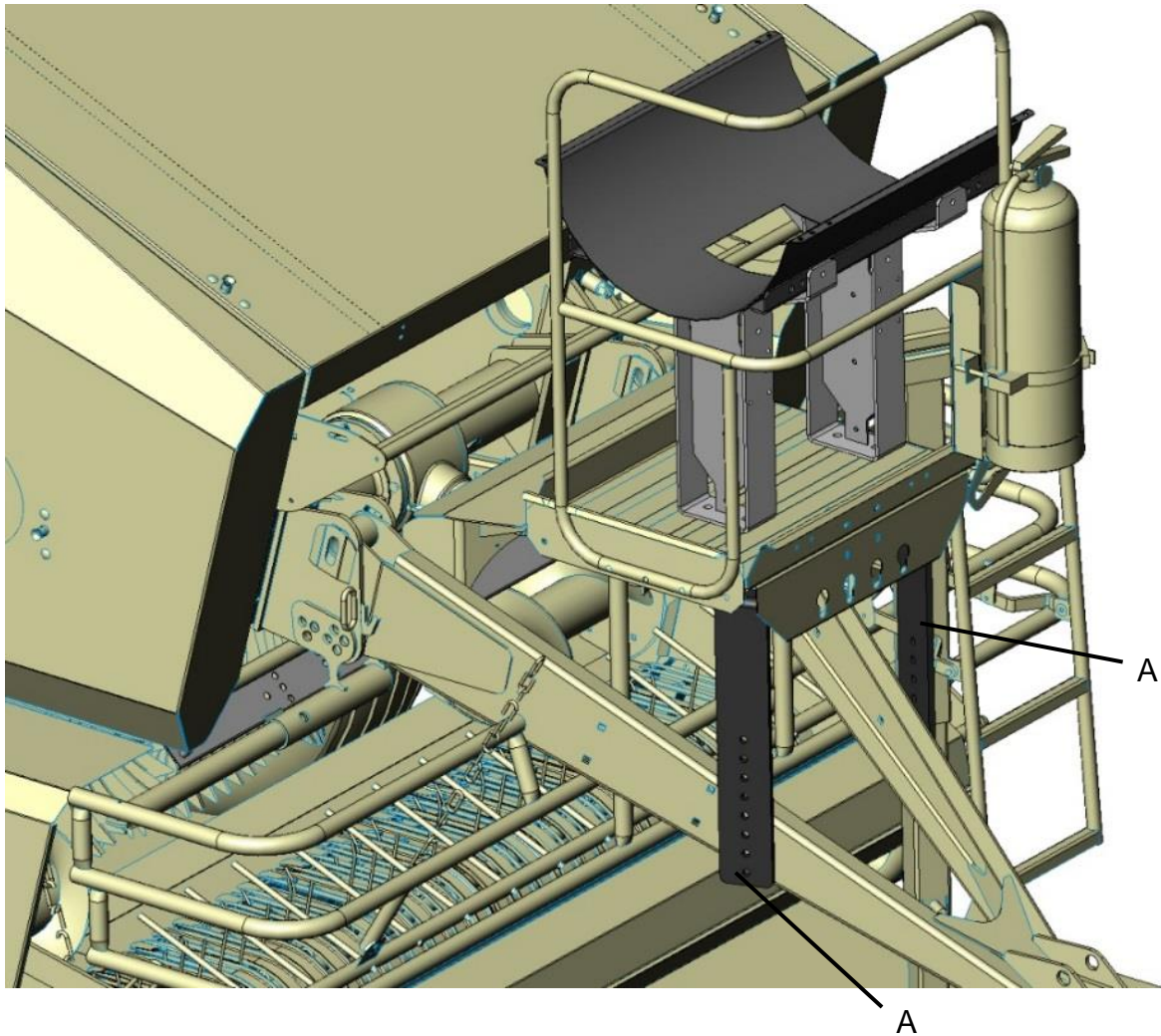

Figure 2



Install Kit 4523B

Mount the saddle and legs on the baler as shown in the picture below. Push the tank as far forward as possible and mark the four 13mm holes that will need to be drilled. Locate the two support legs (001-4704JR & 001-4704JL) shown below (A). Align the support legs below the tank legs and attach through the baler platform using four 1/2" x 1-1/2" bolts, locks, flats and nuts. Mark and drill four 13 mm holes where the support legs (A) meet the baler hitch. Attach the legs to the baler frame using four 1/2" x 1-1/2" bolts, locks, flats and nuts. Tighten all hardware.



Install kit 4524B

Locate legs part #001-4703K and part #001-4703L. Use the diagram below to locate the placement of the holes you will need to drill. You will need to drill three 1/2" holes per side of tongue. After drilling the holes you will need to loosely attach the legs to the tongue with 1/2" X 2" bolts with locks, nuts, and flat washers. (Figure 1) Attach the saddle (001-4703) and tank assembly on top of the legs using 3/8" x 1" bolts and lock washers. (Figure 2) Do not tighten down 3/8" bolts all the way. Once saddle is attached to legs tighten down bolts and nuts attaching the legs to the tongue. Now tighten bolts attaching saddle to legs.

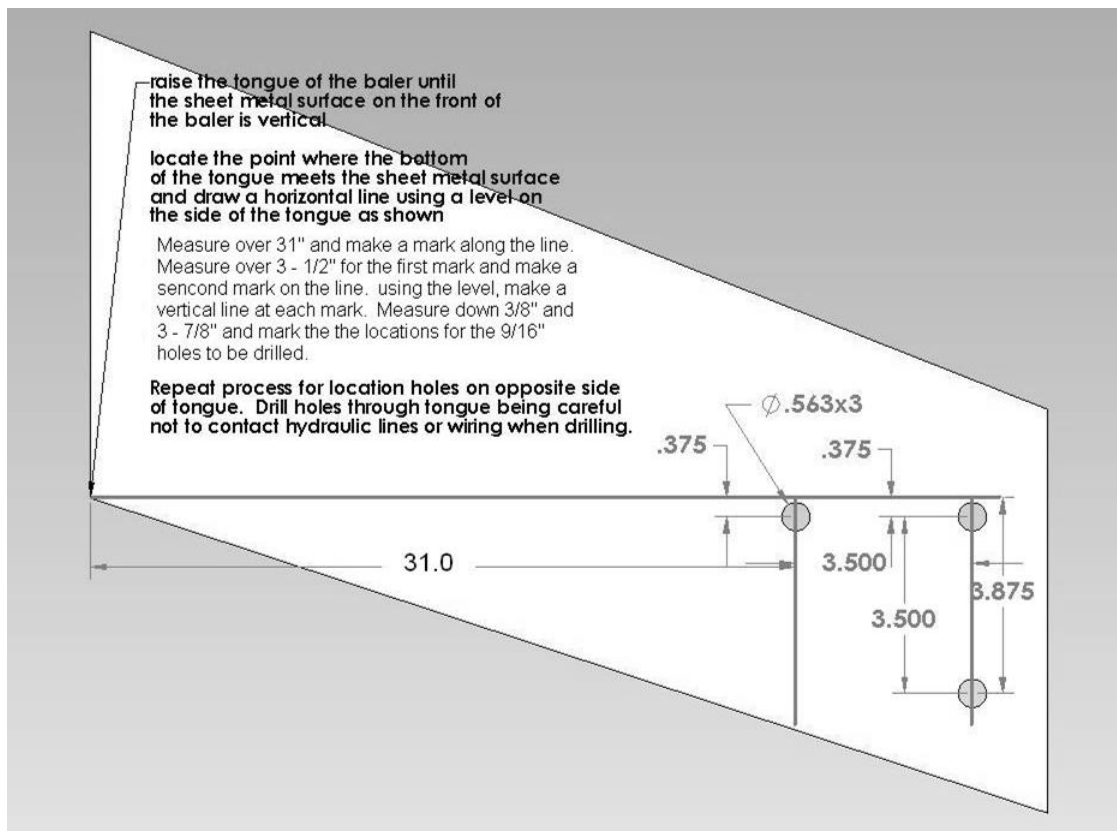
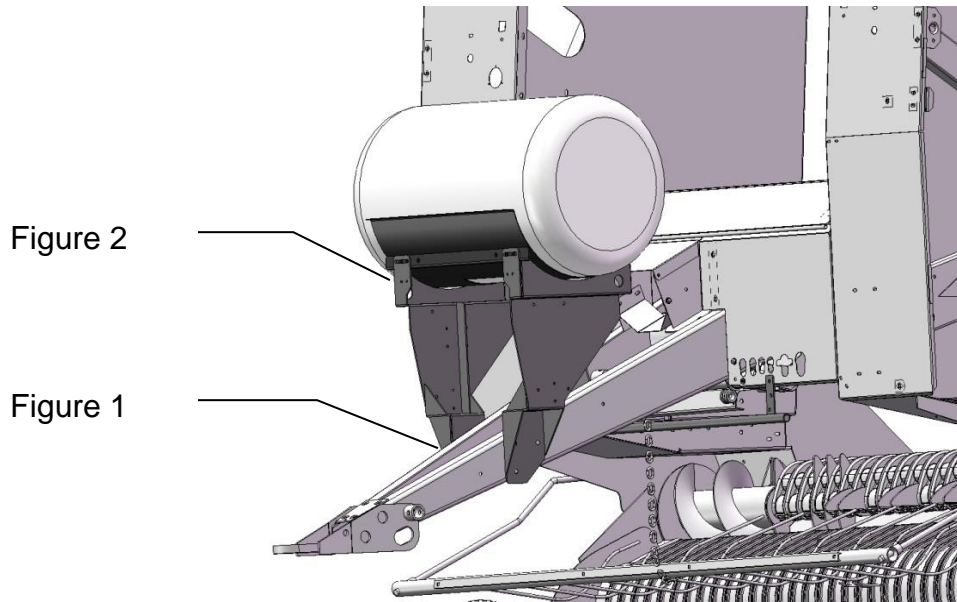

Install kit 4526B

Locate the mounting bracket (001-4704MA). Mount the bracket on the baler hitch and move towards the baler until the mounting bracket contacts both sides of the baler hitch. Mark and drill four 1/2" holes and attach the mounting bracket using four 1/2" x 1-1/2" bolts, locks, flats, and nuts. Tighten hardware.

Mount the legs and saddle to the top of the mounting bracket (001-4704MA). Use four 1/2" x 1-1/2" bolts, locks, flats, and nuts. Tighten hardware.

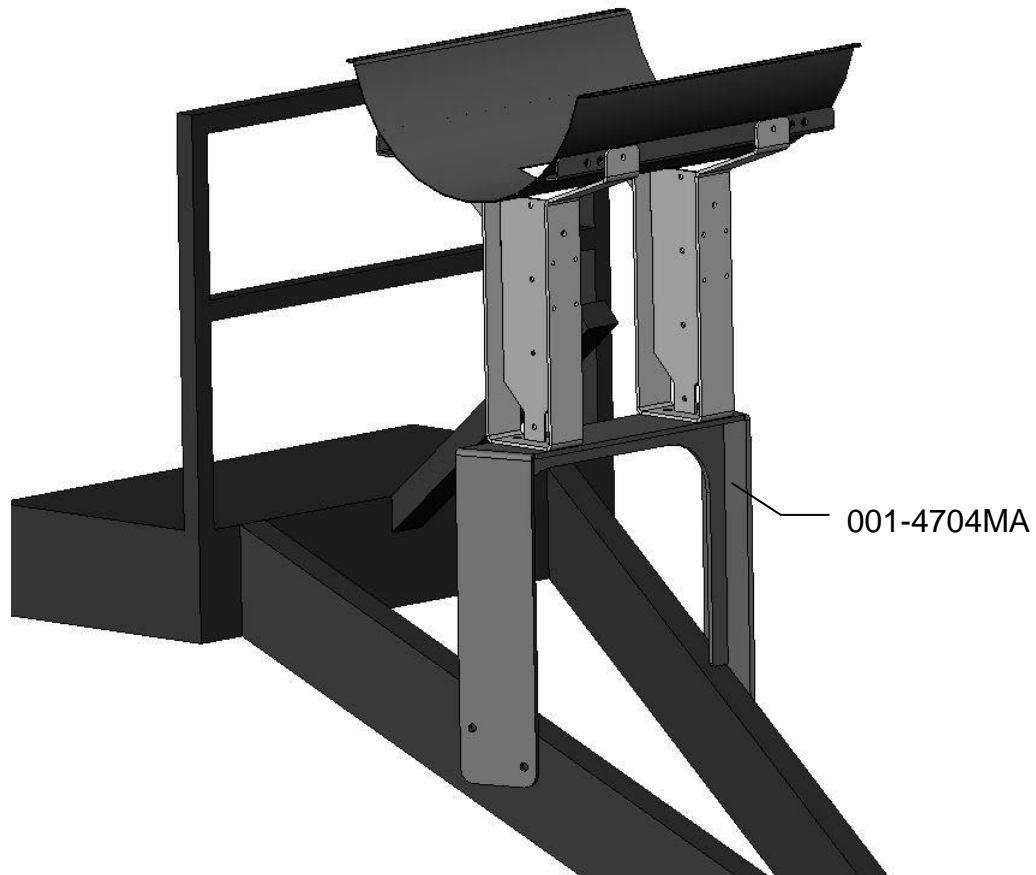

Model 447

Installation of the cross support for 55 gallon model only

Locate parts bag 14. Locate the cross support (001-4445B) on the front shelf of the balers pictured below. It will butt up against the step-up on the shelf and line up flush with its upper surface. Mark and drill a 9/16" hole on each side sheet to hold the cross piece in place with two 1/2" by 1-1/4" bolts, fender, and lock washers provided.

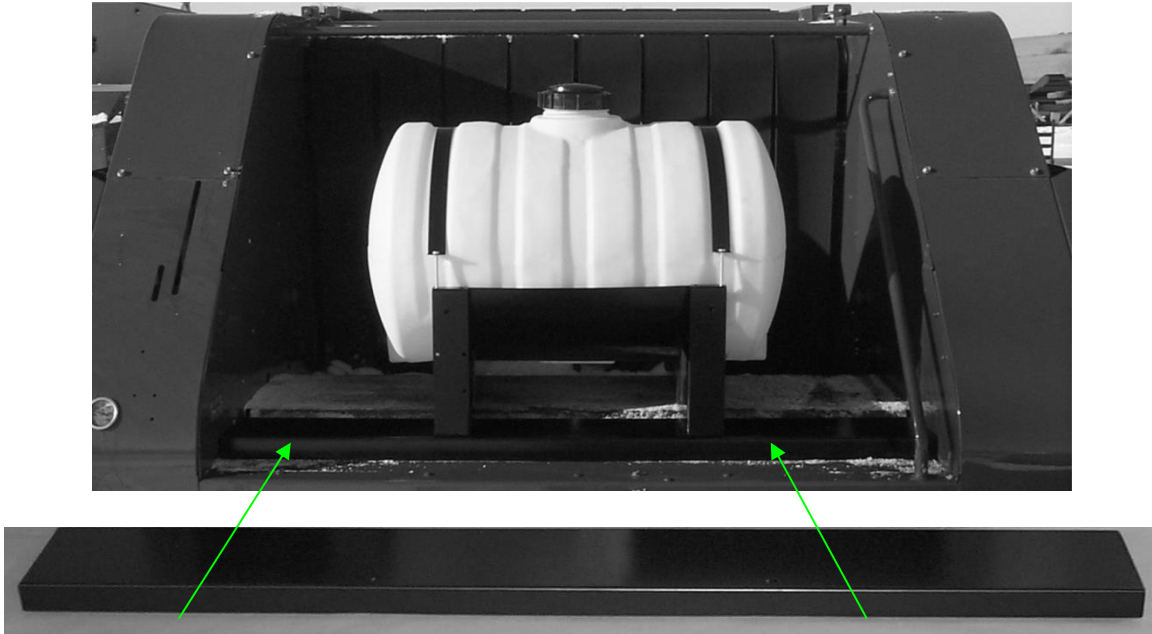

Mounting the tank and saddle on baler

Locate parts bag 11. Locate the tank and frame on the shelf. Center it from side to side. On 55-gallon models, the tank positioning going from front to back is set by lining up the front base holes with the holes in the cross support. On 25-gallon models, line up the front tank legs with the front of the baler's shelf. Mark and drill all base holes with a 9/16" drill. Use the 1/2" by 1-1/4" bolts, lock washers, fender washers, and nuts provided to secure the frame.

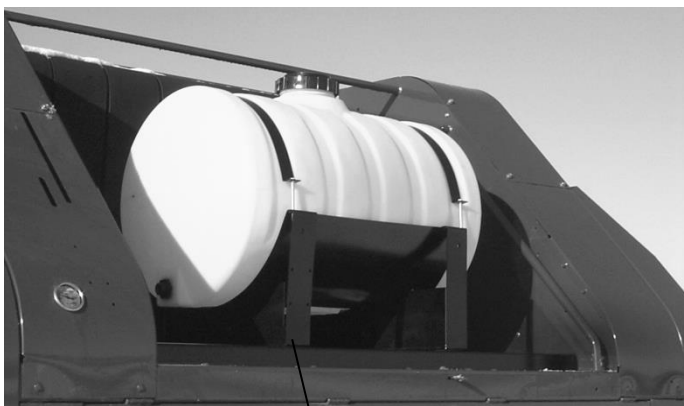

55 Gallon
System



25 Gallon
System

2. Installation of Pump Manifold

Model 446



Figure 1



Figure 2



Figure 3

Locate parts bag 8. The U shaped bracket (001-4647) will already be attached to the saddle as shown in Figure 1. Connect the mounting half of the pump plate (001-4646C), shown in Figure 2, with two 3/8" x 1-1/4" bolts, nuts, locks, and flat washers and connecting to the U shaped bracket (001-4647). Install the rest of the pump plate as shown in Figure 3. Attach the pump plate holder (001-4646D) to pump plate mounting bracket (001-4647) using four 3/8" x 3/4" flange head bolts. The Baler Mounted Processor and pump heads must be pointing down. Failure to mount the pump plate assembly in this specified direction will void all warranty of the Baler Mounted Processor and pumps.

Model 447

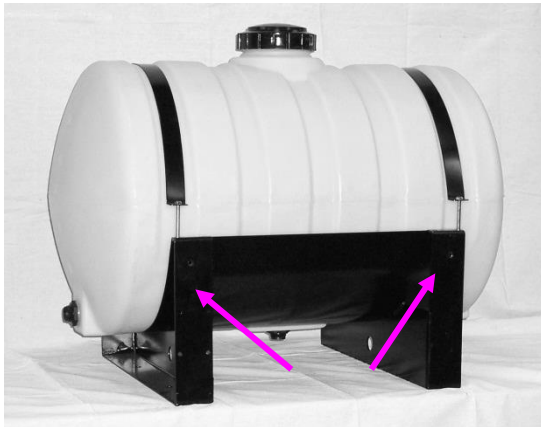

Figure 1

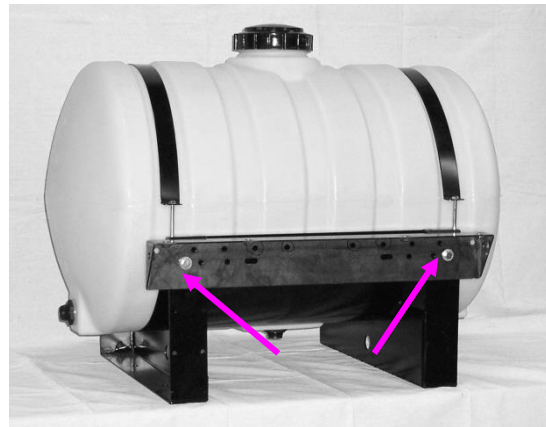

Figure 2



Figure 3

1. Locate parts bag 8.
2. Locate mounting weld nuts on saddle as shown in Figure 1.
3. Connect the pump plate mounting bracket (001-4646C), shown in Figure 2, using two 3/8" x 1-1/4" bolts, locks, and flat washers to the saddle.
4. Attach the pump plate holder (001-4646D) to pump plate mounting bracket (001-4646C) using four 3/8" x 3/4" flange head bolts. Figure 3.

The Baler Mounted Processor and pump heads must be pointing down. Failure to mount the pump plate assembly in this specified direction will void all warranty of the Baler Mounted Processor and pumps.

Model 449

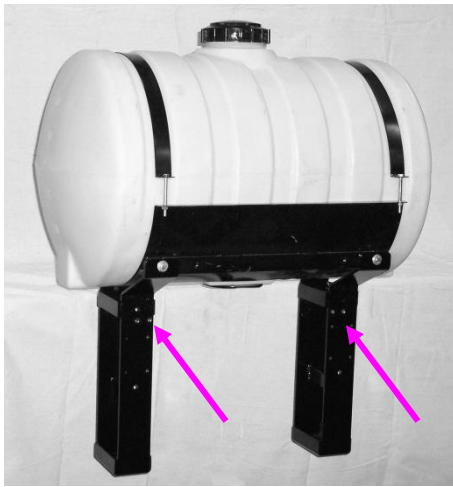

Figure 1

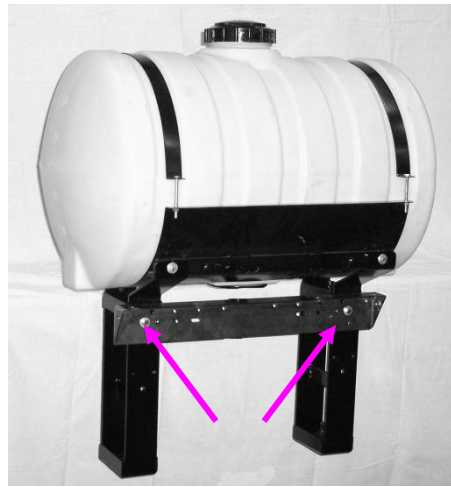

Figure 2



Figure 3

5. Locate parts bag 8.
6. Locate the two mounting holes as shown in Figure 1.
7. Connect the pump plate mounting bracket (001-4646C), shown in Figure 2, using two 3/8" x 1-1/4" bolts, nuts, locks, and flat washers to the saddle.
8. Attach the pump plate holder (001-4646D) to pump plate mounting bracket (001-4646C) using four 3/8" x 3/4" flange head bolts. Figure 3.

The Baler Mounted Processor and pump heads must be pointing down. Failure to mount the pump plate assembly in this specified direction will void all warranty of the Baler Mounted Processor and pumps.

3. Placement of spray assemblies or nozzle tubes

Install kits 4483B, 4484B, 4486B & 4504B

On most large round balers the cross bar on the wind guard above the pick-up head provides a mounting point for the nozzle tubes. Space the nozzle tubes by the chart below. If your "U" bolts do not fit around the cross bar, you may need to mount a 1 inch diameter pipe to your balers tongue to mount them.

PICK-UP HEAD WIDTH	LEFT SIDE (Use elbow fitting)	CENTER (Use 2-way fitting)	RIGHT SIDE (Use 2-way fitting)
48" (1.2m)	12" (30cm) from left	Center	12" (30cm) from right
60" (1.5m)	14" (35cm) from left	Center	14" (35cm) from right
72" (1.8m)	15" (38cm) from left	Center	15" (38cm) from right

Aim the nozzle tubes up so that the tips spray in a generally horizontal direction. Also point the tips toward the starter rolls of the baler. The tips should be located so that they will be somewhere between 14" and 18" (35 to 45 cm) from the normal path of hay. Make sure the tubes do not interfere with the tying system.

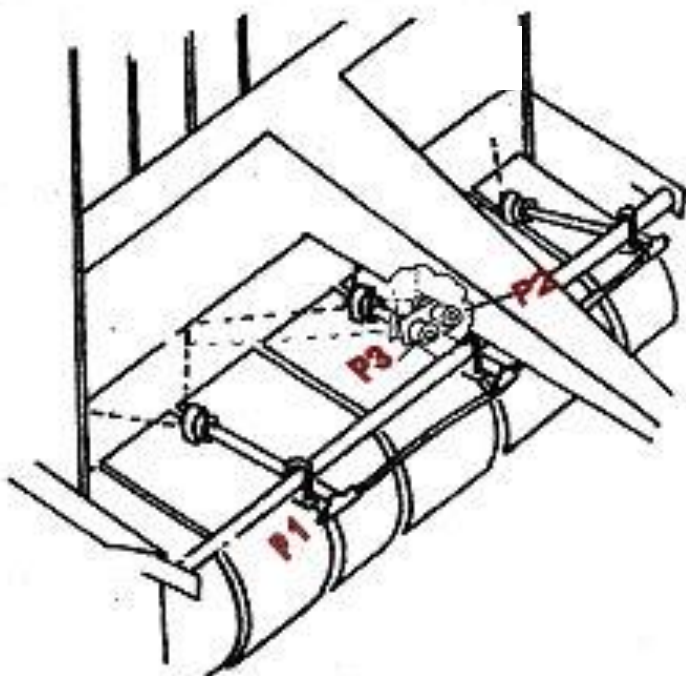

Install kit 4503B

The top cross bar above the full-shielded wind guard provides a mounting point for the short nozzle pipes (Figure 1). The nozzles will point towards the baler, and a notch may need to be cut on the lip of the full-shielded wind guard for clearance of the elbow. Space the nozzles by the chart below:

Figure 1

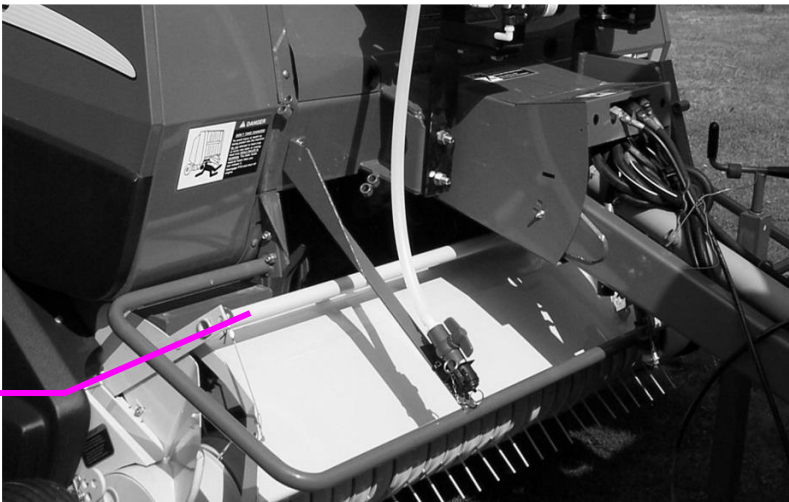

PICK-UP HEAD WIDTH	LEFT SIDE (Use plugged fitting)	CENTER (Use 2-way fitting)	RIGHT SIDE (Use 2-way fitting)
48" (122 cm)	12" from left (30 cm)	Center	12" from right (30 cm)
60" (152 cm)	14" from left (36 cm)	Center	14" from right (36cm)
72" (183 cm)	15" from left (38 cm)	Center	15" from right (38 cm)

Install kit 4508B

Locate the spray shield assembly (030-4508B). Fit shield with tips facing down onto the baler as shown below with the shield hangers (001-4703JB). Mark both sides of the shield (only mark one hole per side) and drill a 3/8" hole to allow the shield to be bolted to the baler using 3/8" x 1 1/2" bolts, locks, nuts, and flat washers. Remove the spray shield from the mounting brackets to install. Attach hoses to shield before installing on bracket. (See installation of plumbing)

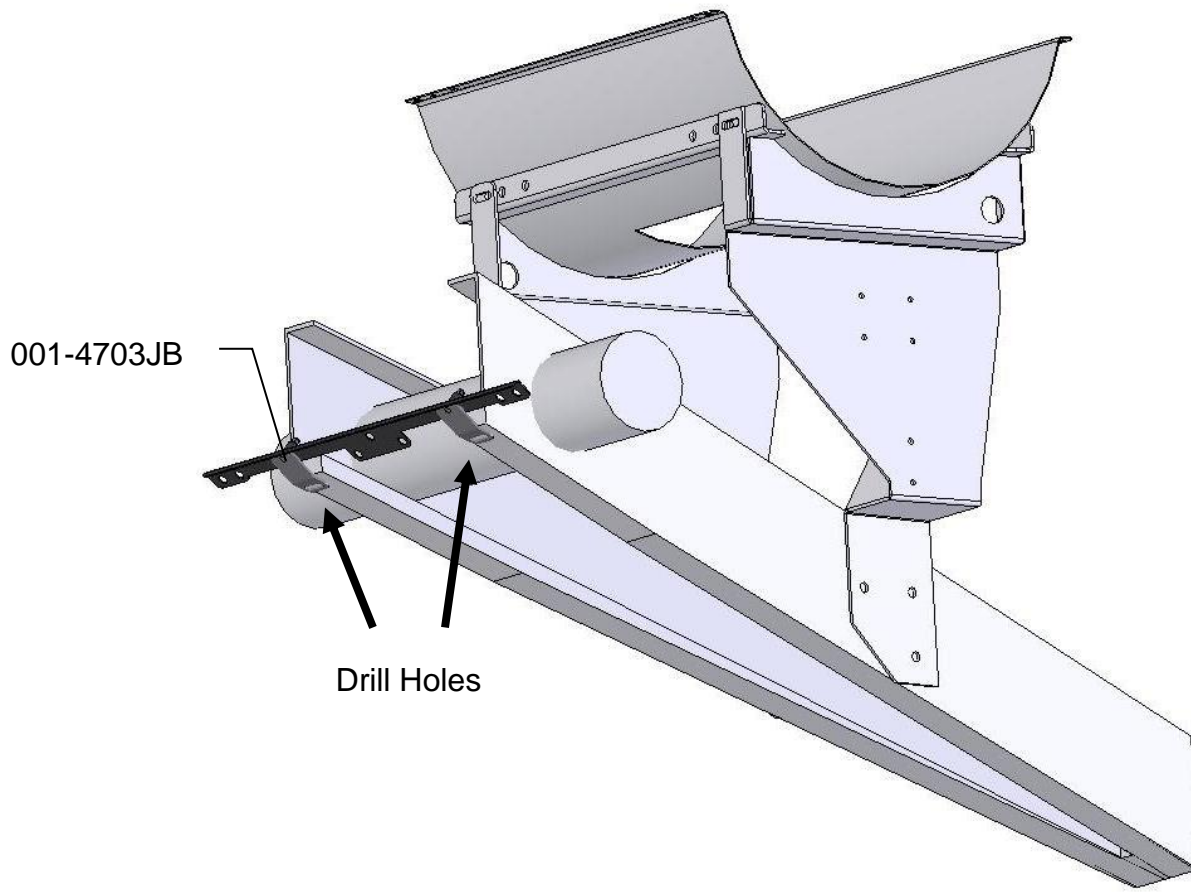

Install kit 4508B continued

Locate the spray shield assembly (030-4508B). Fit shield with tips facing down onto the baler as shown below with the shield hangers (001-4703JC). The shield hangers will be positioned on the sheet metal between the baler's tongue and belts. The shield hangers should be positioned so that the bottom of the sheet metal is aligned with the bottom of the bend below the mounting holes and on the tongue side of the sheet metal. Mark both sides of the shield hangers (two holes per side) and drill four 3/8" holes to allow the shield to be bolted to the baler using 3/8" x 1 1/2" bolts, locks, nuts, and flat washers. Remove the spray shield from the mounting bracket to install. Attach hoses to shield before installing on bracket. (See installation of plumbing).

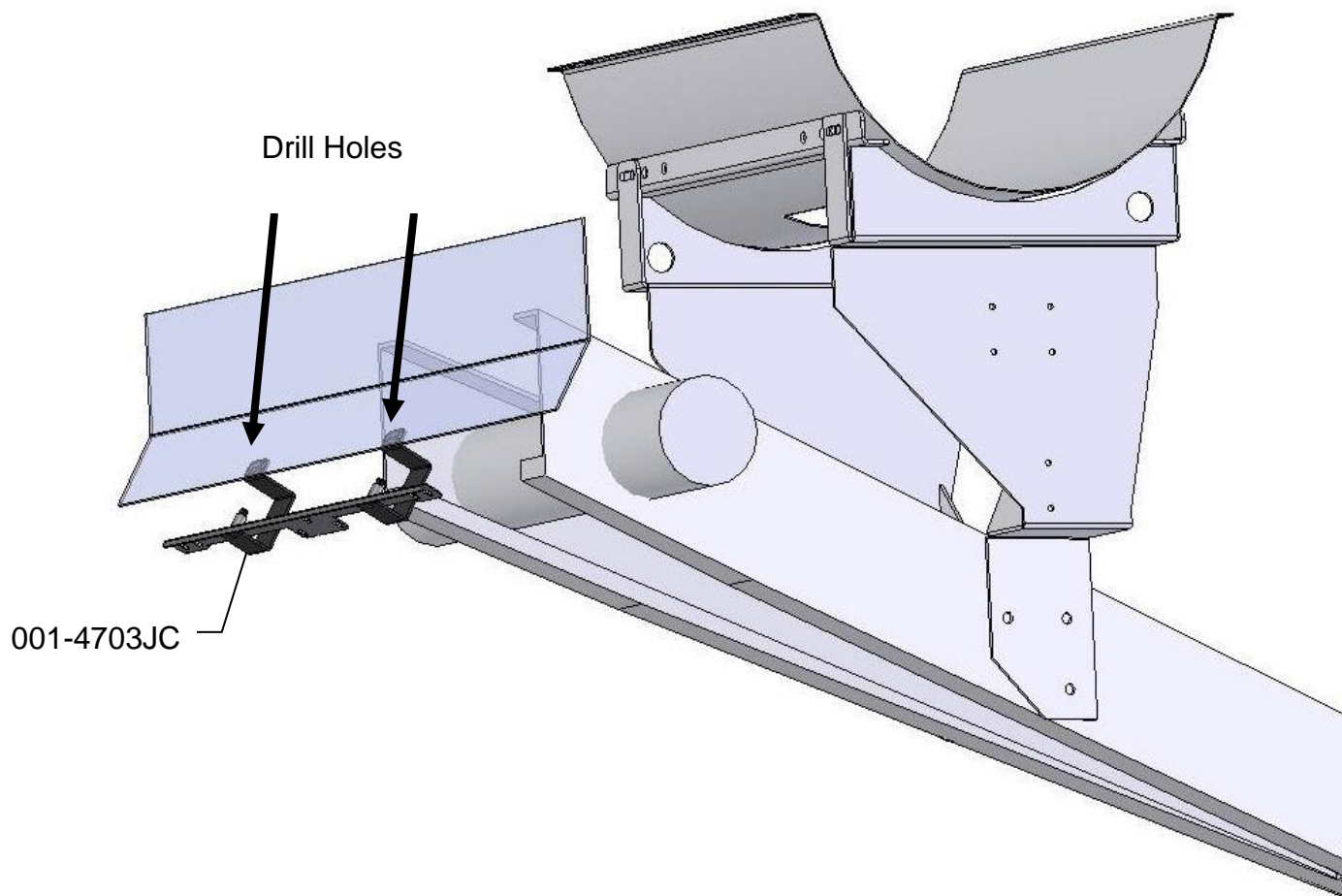

Install Kit 4516B and 4517B

Twine and Net Balers

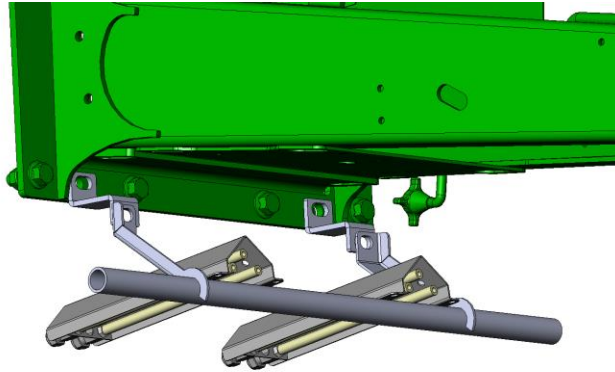

Locate the four flange head bolts where the baler hitch bolts to the bottom side of the baler frame. Remove the two outside bolts. Attach the spacers (001-4703NS) to the **hitch side** of the baler frame. Use original hardware to secure. Attach the nozzle holder (001-4703R) to the spacers with the supplied M16 x 40mm flange bolts and nuts. Attach the nozzle mount (001-4714J) to the nozzle holder (001-4703R) with 5/16" U bolts, locks, and nuts. The Nozzle mount should be about 6 inches apart for 4 foot wide balers and 9 inches apart for 5 foot wide balers. Do not fully tighten. Lift the roller baffle and position the end of the nozzle holder bracket so the tips are just above the roller baffle (if equipped) when it is lifted to its highest point. Tighten all hardware and attach the hoses.

Net Only Baler

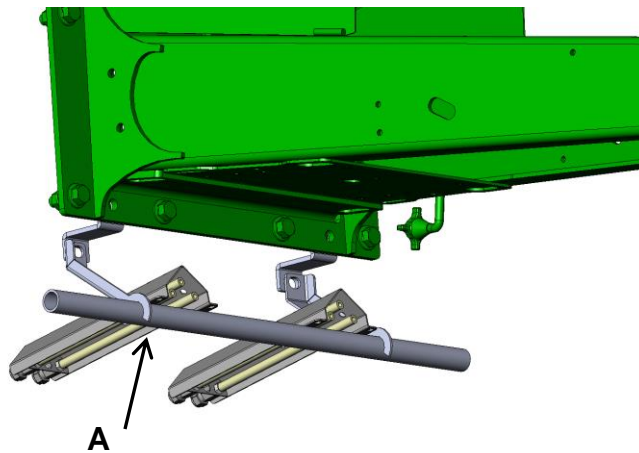

Locate the four flange head bolts where the baler hitch bolts to the bottom side of the baler frame. Remove the two bolts. Attach the spacers (001-4703NS) to the **chamber side** of the baler frame. Use original hardware to secure. Attach the nozzle holder (001-4703R) to the spacers with the supplied M16 x 40mm flange bolts and nuts. Attach the nozzle mount (001-4714J) to the nozzle holder (001-4703R) with 5/16" U bolts, locks and nuts. The nozzle mount should be about 9 inches apart with bracket **A** as close to the V-shaped stop as possible. Do not fully tighten. Lift the roller baffle (if equipped) and position the end of the nozzle holder bracket so the tips are just above the baffle when it is lifted to its highest point. Tighten all hardware and attach the hoses.

Install Kit 4523B

Locate the spray shield (001-4704G) and spray shield hangers (001-4704H). Mount the spray shield above the pickup reel and directly in front of the rotor on the baler. Use the two existing holes to mount the shield using four 3/8" x 1-1/2" bolts, locks, flats, and nuts. Tighten all hardware.

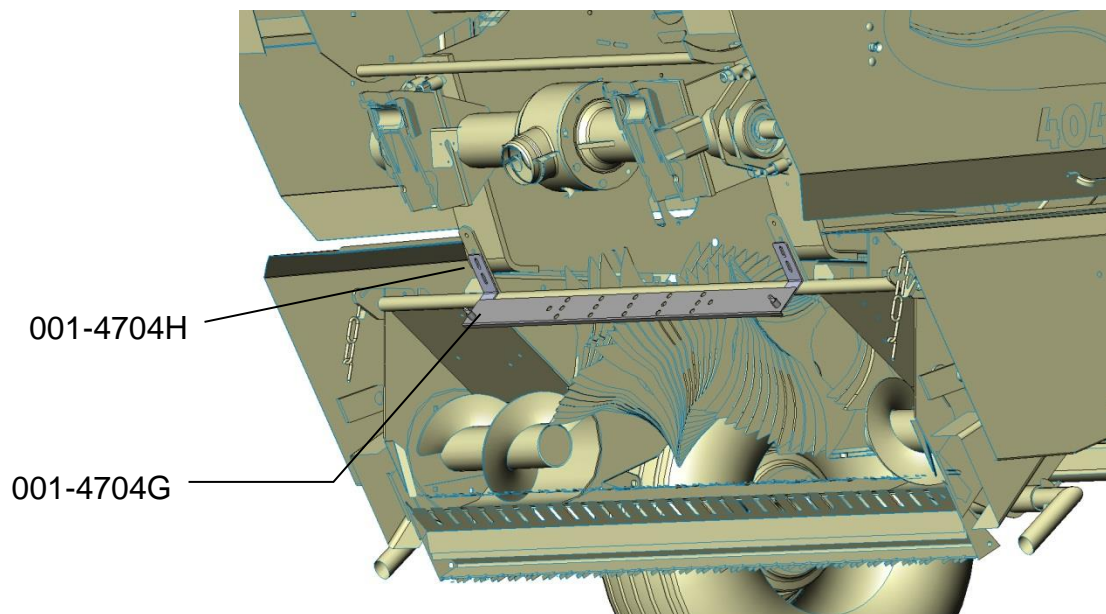

Install Kit 4524B

Locate the spray nozzle holder (001-4703T). Situate the holder, centered on the baler sheet metal and mark one hole per side. (Figure 1) Drill two 5/16" holes and attach the holder using two 3/8 x 1" bolts, locks, flats, and nuts. Install one nozzle tube in the center. The two remaining nozzle tubes, will mount one inch in from each end. Do not fully tighten. Position the nozzle tubes so that the tips will be 14 – 18 inches away from the normal path of hay. Tighten the nozzle tubes to the nozzle holder.

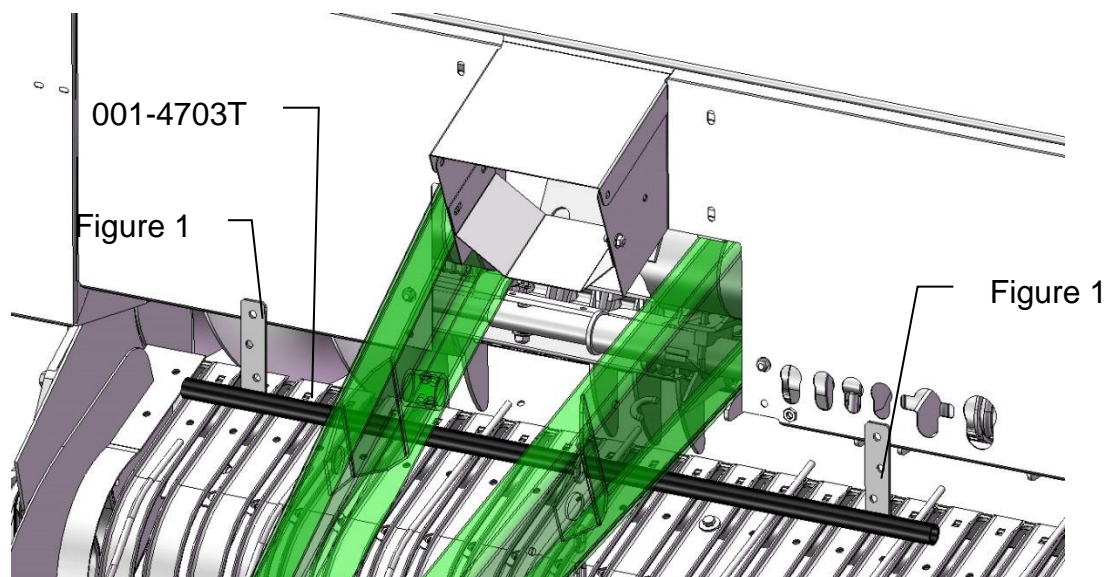

Install kit 4526B

Locate the spray shield (001-4704G) and spray shield hangers (001-4704MC). Mount the spray shield above the pickup reel as shown below. Attach the shield to the baler using the supplied two 3/8" x 1-1/2" bolts, locks, flats and nuts. Tighten all hardware.

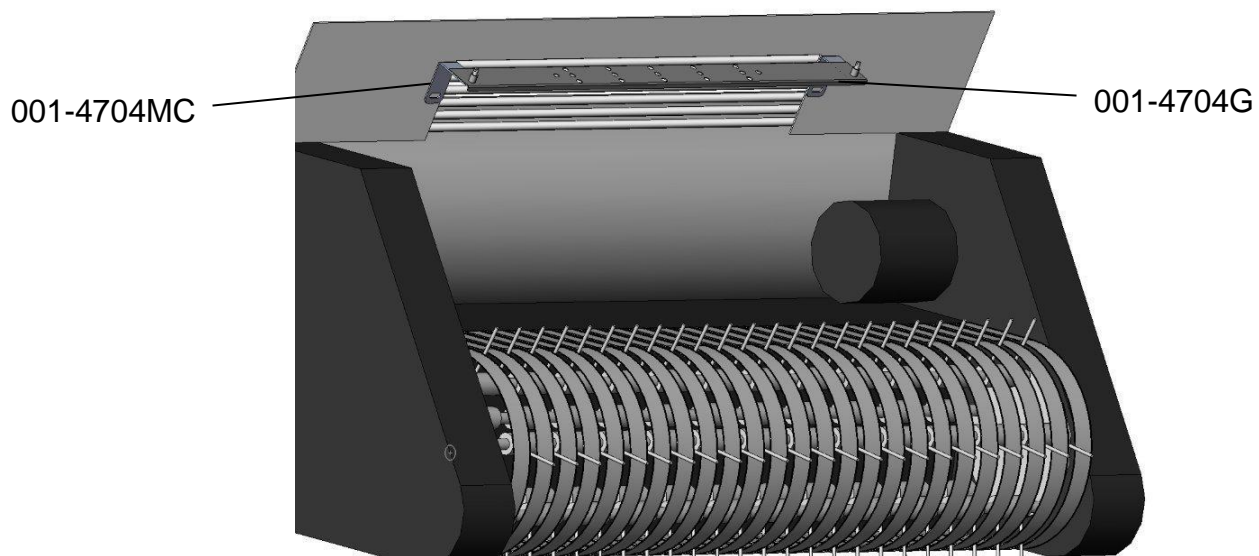

Install kit 447-SO

Locate parts bag 10. Locate the spray shield (001-4810B) and the spray shield holder (001-4810BRH). The assembly will mount as shown in figure 1. The location shown in figure 1 is directly above the balers pickup. Four 10 mm holes will need to be drilled to mount the shield holder to the baler (Figure 2). Mount the spray shield holder using four 5/16 x 1 1/2" bolts, locks, flats, and nuts. Attach the shield to the holder using the two supplied lynch pins.

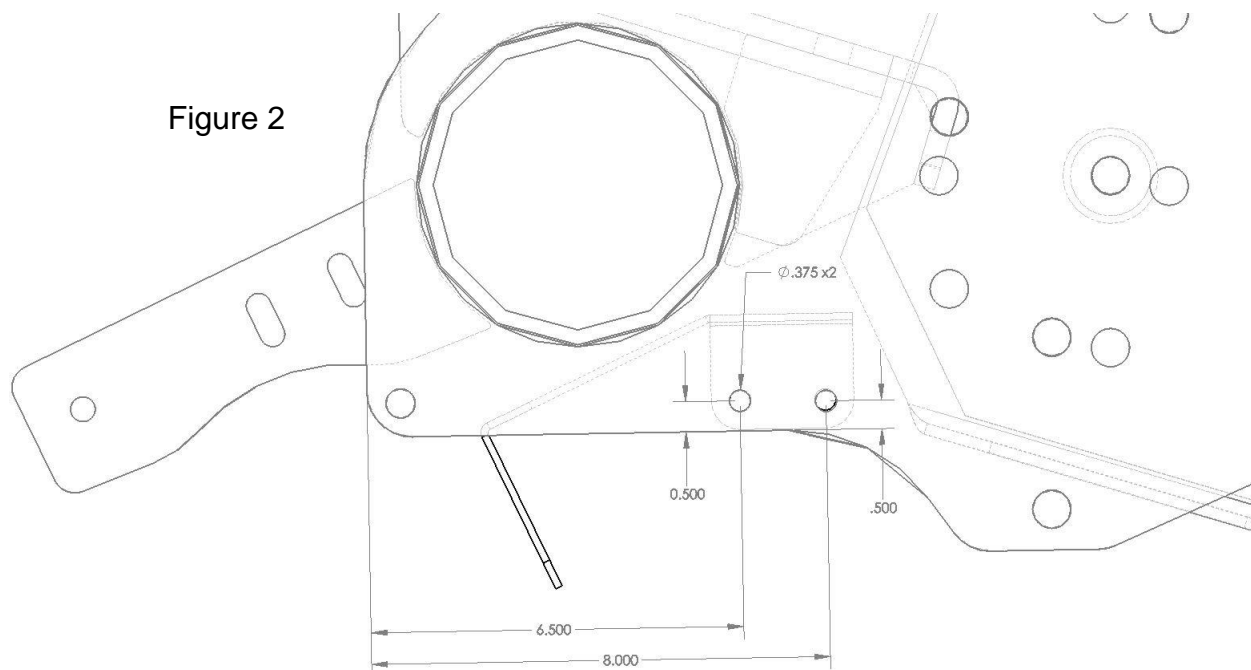
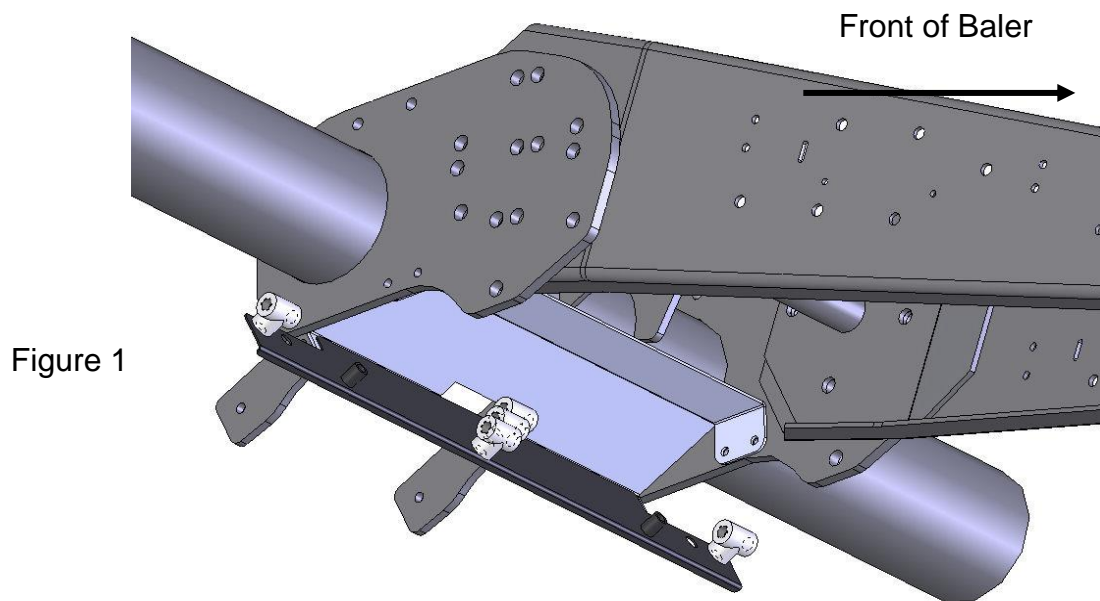

4. Installation of drain fill kit (model 447 & 449 only)

Locate parts bag 1. Thread 3/4" elbow fitting (#003-EL3434) into end of tank. Run 3/4" hose from the elbow down the frame to the bottom of the baler. Drill 6mm holes to accept the valve holder bracket and use two 5/16" x1" self-tapping screws and secure with two 5/16" flange nuts. Connect valve assembly to other end of hose. Place hose clamps on both ends. Install supplied safety decals (DCL-8001 & DCL-8005) next to the ball valve assembly.

*Secure hose to frame using cable locks.



5. Installation of plumbing

A. Intake

Use the 003-EL3412 on the bottom of the tank to route 1/2" line (002-9001) to the 003-A1212 fitting on the ball valve already attached to the pump plate. Attach hose clamps (003-9003) on both of the fittings.

B. Discharge

The three – 1/4" hose assembly will be used to attach the pumps to the spray shield. The pump order is, from closest to the filter bowl, 1,2, and 3. Pump 1 will attach to the three main nozzle tubes. This is done by connecting the hose to one of the nozzles on the end that has two hose barb fittings. Continue to connect these nozzles together with the clear hose to the end nozzle (which is capped off). Pump 2 will use the green hose and Pump 3 will use the blue hose to attach to the auxiliary nozzles.

C. High and Low Output Tips

Your baler comes with two sets of tips: a low set and a high set.

-The low set will cover outputs of 32 to 440 lbs/hr. Install the following tips for low output:

Clear hose to silver tips on all three tubes.

Green hose to green tip.

Blue hose to red tip.

-The high set will cover outputs of 84 to 632 lbs/hr. Install the following tips for high output:

Clear hose to white outside tips and orange middle tip.

Green hose to blue tip.

Blue hose to gray tip.

****Refer to Tip Output under APPLICATION RATE of the control unit to calibrate system.**

6. Installation of Latch Extension (model 447 only)

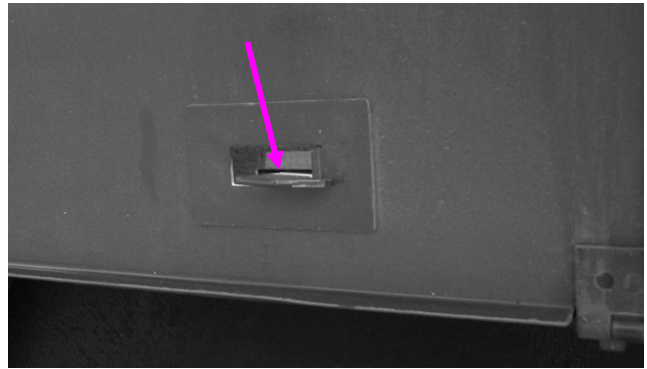
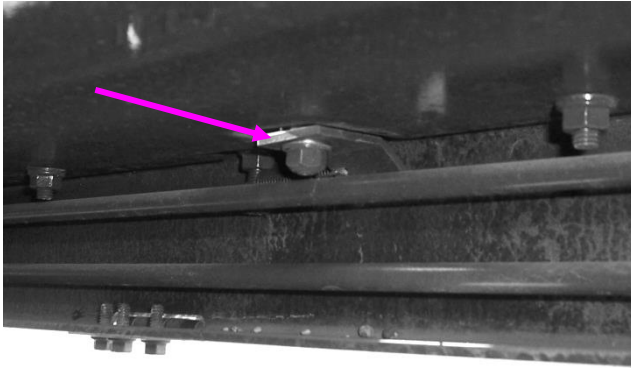

Remove the nut and spring on the existing latch. Replace with the extended latch. Retighten nut and attach the spring. The latch may need to be bent to fit through the doors opening.

7. Installation of Moisture Sensor Pads and Disks

Install kit 4484B, 4486B & 4505B, 4523B

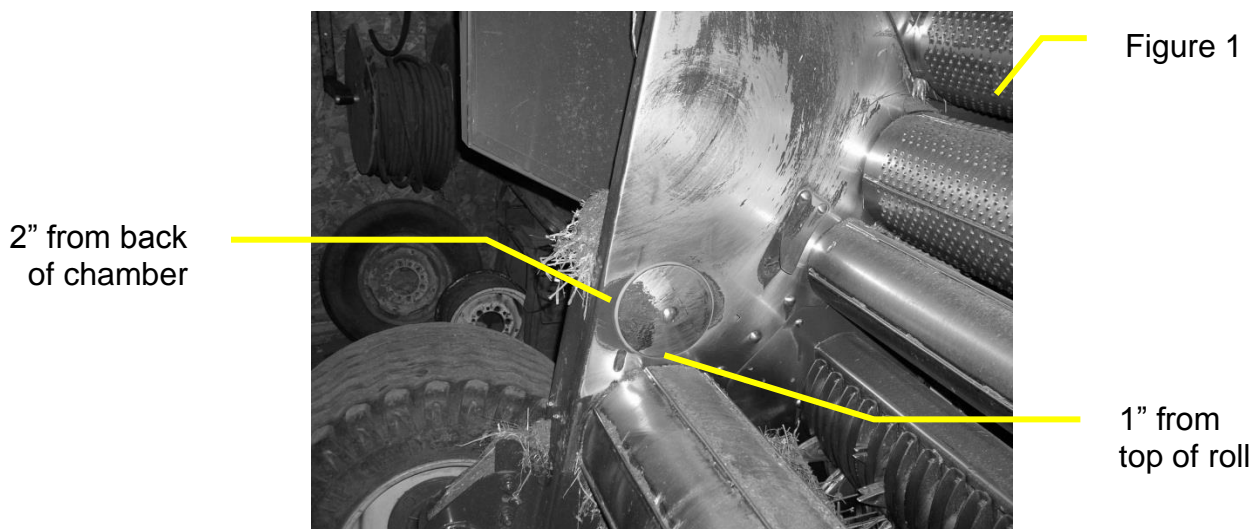

1. If your baler is equipped with bale shaping pads, remove disc and use existing hole (may need to be drilled larger, 3/4" to install new moisture sensing discs.
2. If your baler is not equipped with bale shaping pads you will need to drill a hole in the chamber directly behind and above the starting roll. (Figure 1)
3. The mounting hole will be 3/4" in diameter. Use a plastic pad (006-4641F) and place it into the baler to use as a template. The bottom edge of the pad will be placed 1" up from starting roll and 2" from the back of the bale chamber. (Figure 1)

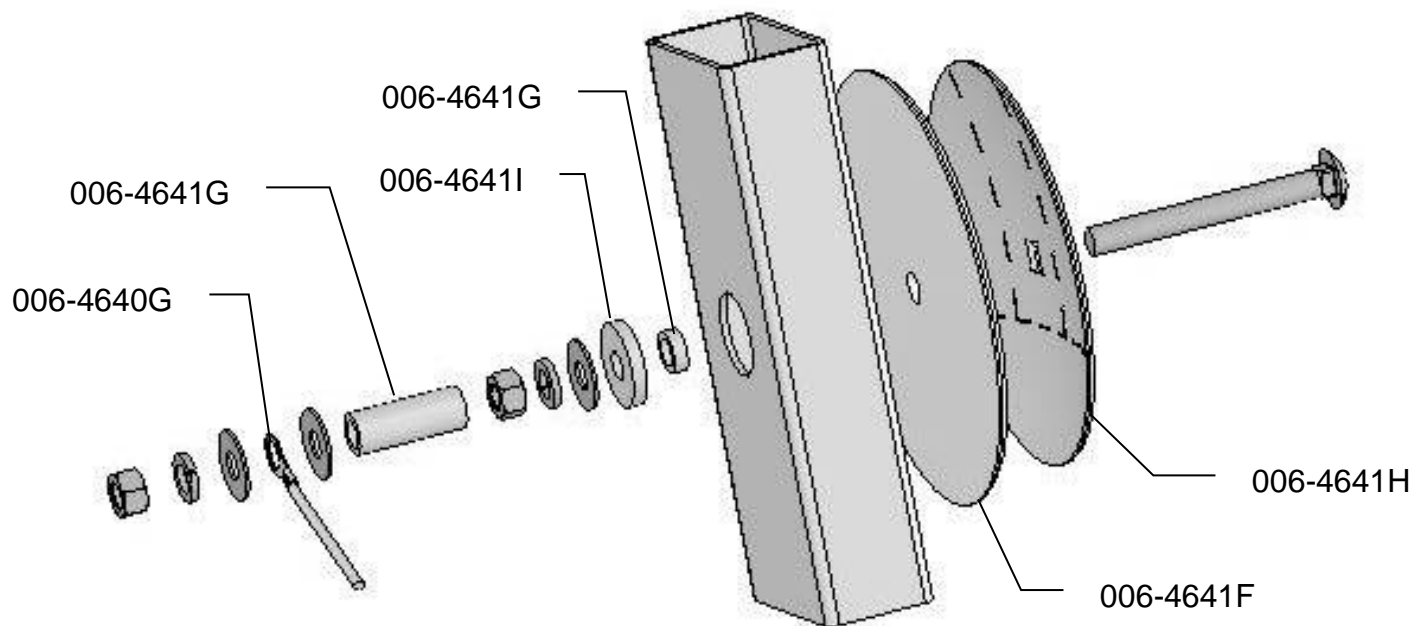

4. Locate the 006-4641G. The piece will need to be cut down to size. Use the already machined line in the bushing to cut off the small piece shown above.
5. Depending on the baler the bolt may need to be trimmed for proper fit.
6. Tighten all of the hardware to 50 ft/lbs.
7. Make sure that the plastic pad is protecting all metal surfaces of the disc from touching baler.
8. Run the moisture wire harness (006-4640G) from pump plate area to each disc securing with cable ties.
9. Apply silicone over nuts and washers.

Install kit 4483B, 4504B, 4516B & 4517B

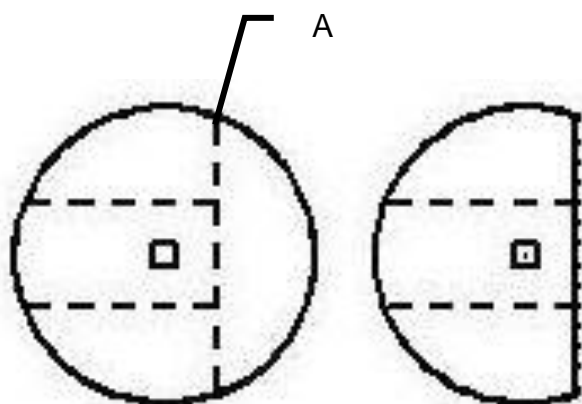

Figure 1

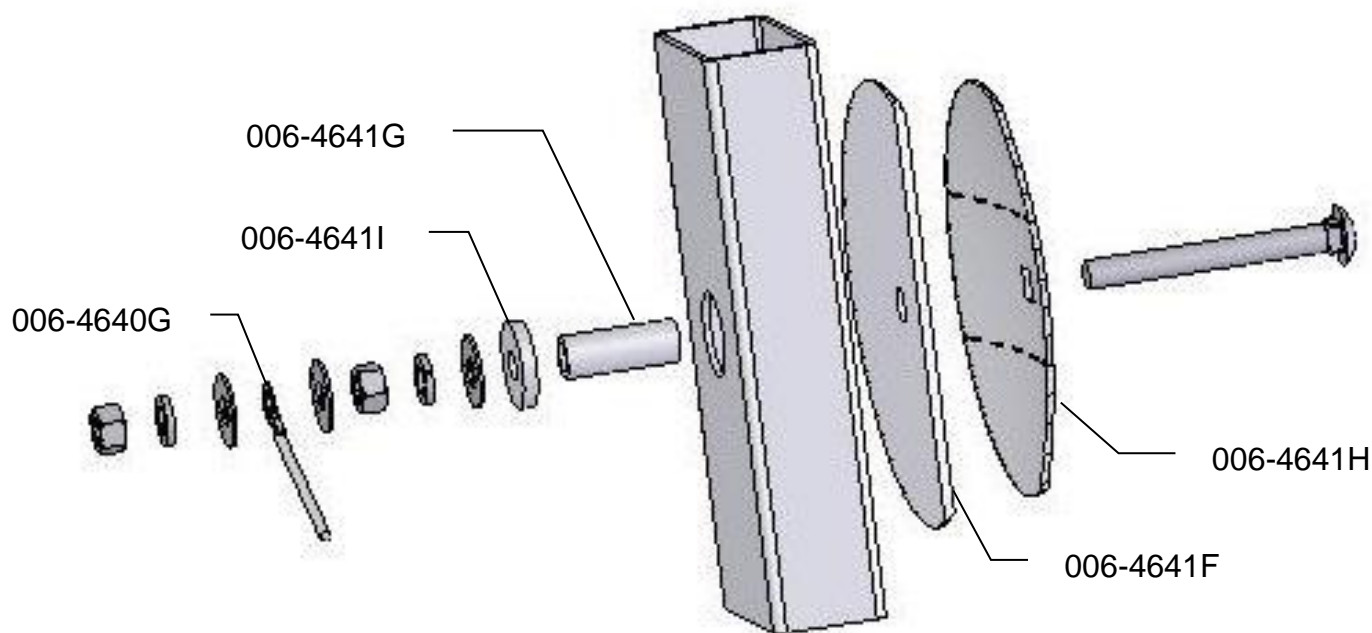

Figure 2

1/4" in
from back
of baler

1" from
Bottom

1. Both moisture discs (006-4641H) will need to be cut along the serrated line (A) shown on Figure 1. Only cut on the line shown on Figure 1, do not cut the other line.
2. The plastic pad (006-4641F) will also need to be cut 1/4" longer than the back of the disc.
3. Using the cut disc as a pattern, mark and drill a 3/4" hole in the side of the bale chamber. The disc will need to be placed on the baler 1" up from the bottom and 1/4" in from the back of the chamber. (Figure 2)



4. Make sure that plastic pad is protecting all metal surfaces of disc from touching baler.
5. Run the moisture wire harness (006-4640G) from pump plate area to each disc securing with cable ties.
6. On some balers the bolt may need to be trimmed for proper fit.
7. Tighten all hardware to 50 ft/lbs.
8. Apply silicone over nuts and washers.

Install kit 4503B for John Deere 582

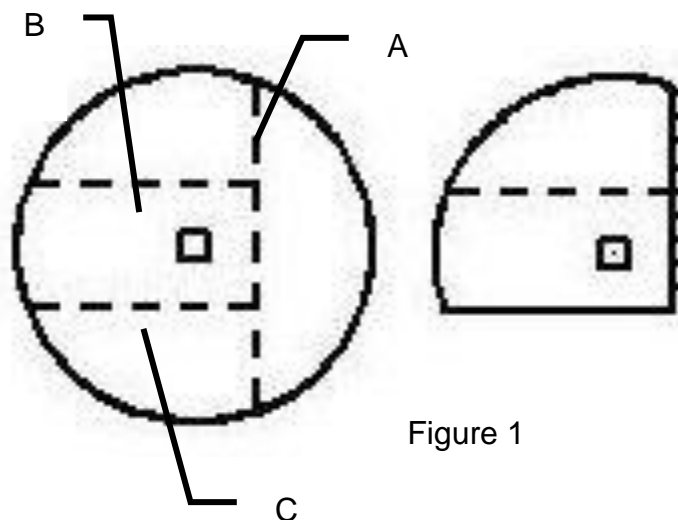

Figure 1

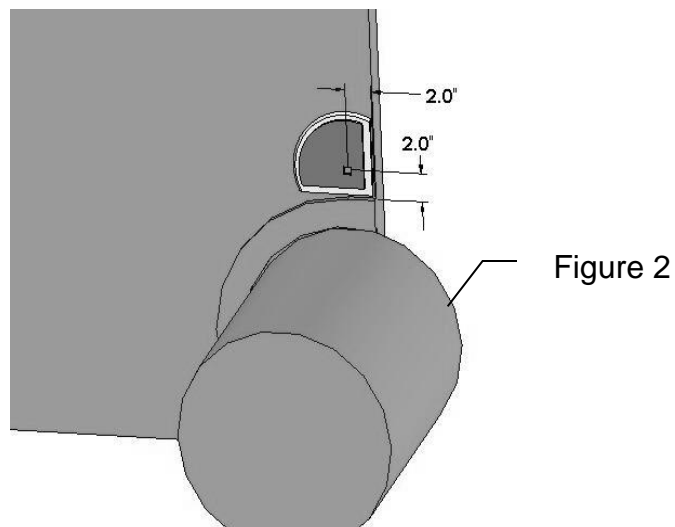
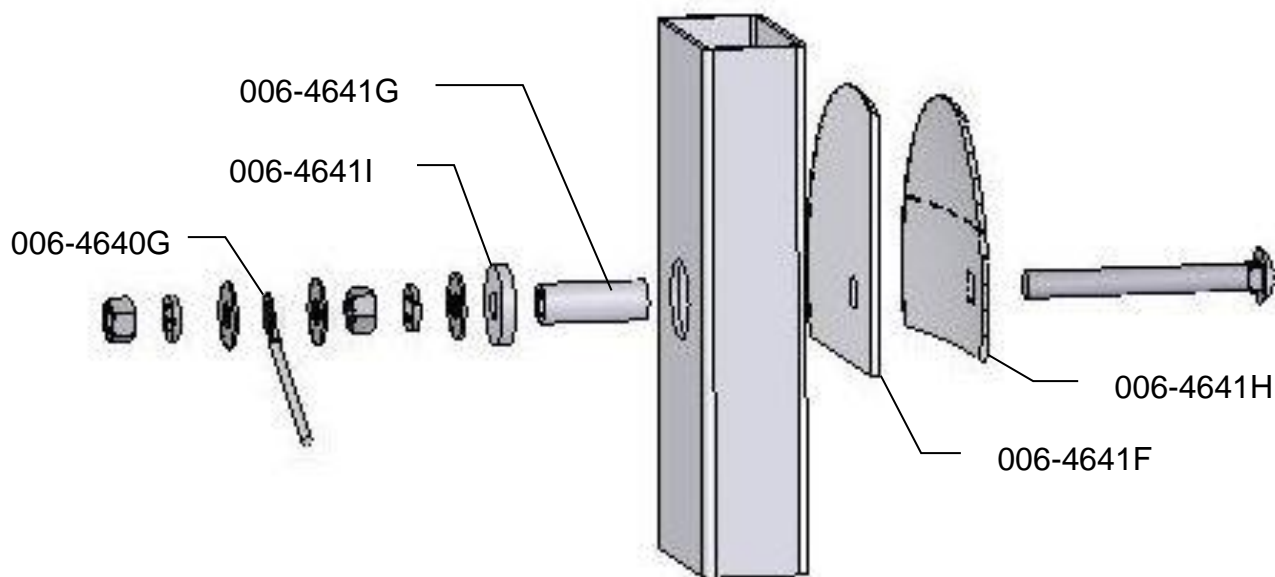

Figure 2

1. The moisture discs (006-4641H) will both need to be cut on line A. (Figure 1) One disc will need to be cut on line B and one disc on line C.
2. The plastic pad (006-4641F) will also need to be cut 1/4" longer than the back of the disc.
3. Bevel all sides of the cut discs to allow the smooth travel of crop over them.
4. The mounting hole will be 3/4" in diameter. The disc will need to be placed on the baler lining up the center of the bolt with the location 2" up from bottom and 2" in from the back of the chamber. (Figure 2)



4. Make sure that plastic pad is protecting all metal surfaces of disc from touching baler.
5. Run the moisture wire harness (006-4640G) from the BMP to each disc securing with cable ties.
6. On some balers the bolt may need to be trimmed for proper fit.
7. Tighten all hardware to 50 ft/lbs.
8. Apply silicone over nuts and washers.

Install kit 4503B for John Deere 854 balers

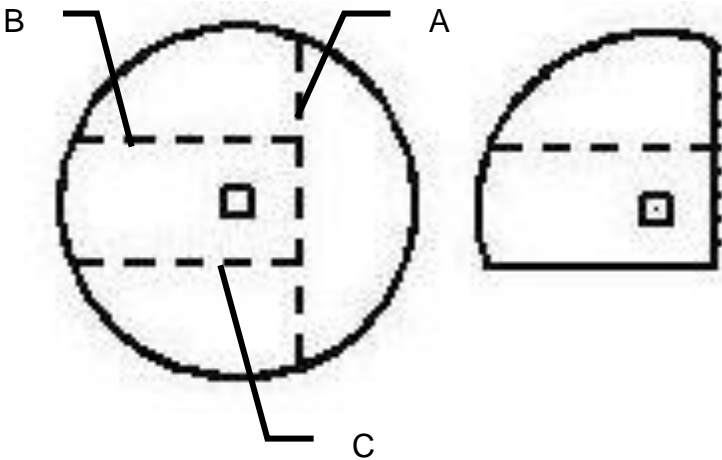

Figure 1

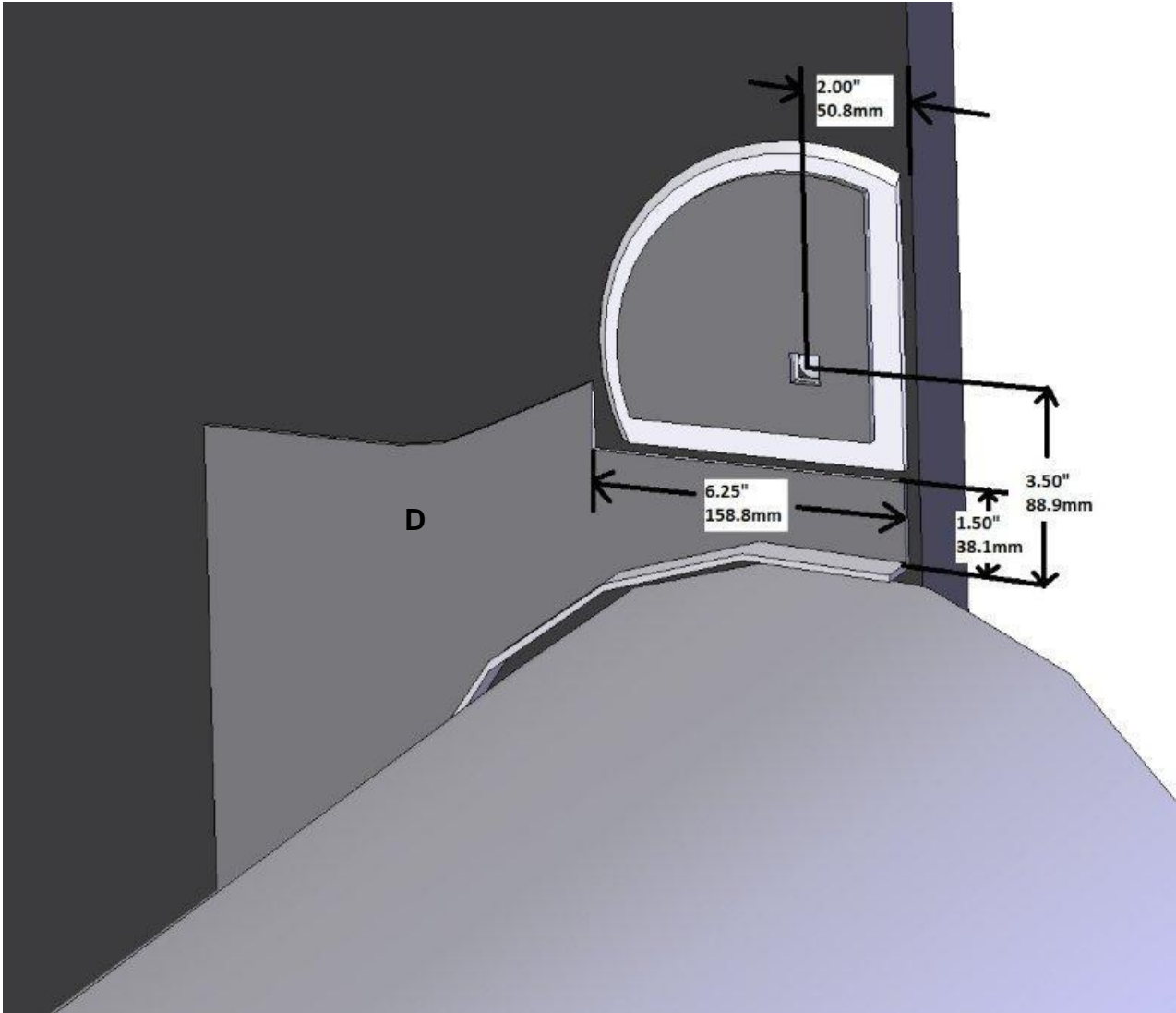
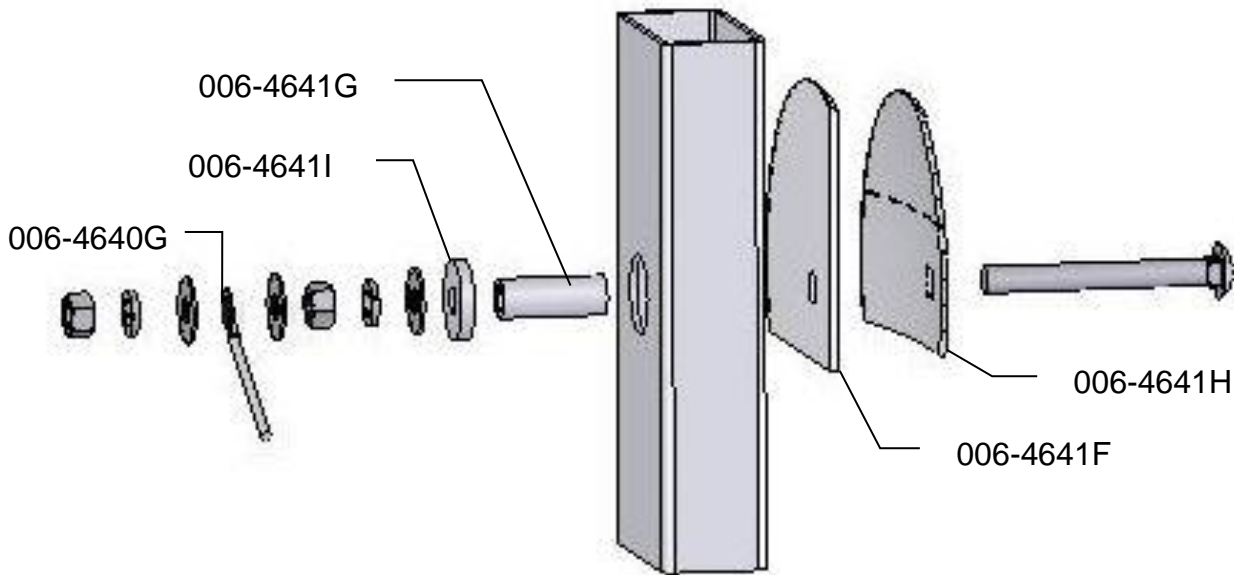

Figure 2

1. The moisture discs (006-4641H) will both need to be cut on line A. (Figure 1) One disc will need to be cut on line B and one disc on line C.
2. The plastic pad (006-4641F) will also need to be cut 1/4" longer than the back of the disc.
3. Bevel all sides of the cut discs to allow the smooth travel of crop over them.
4. Remove the shield directly above the starter roll shown as figure D on both sides of the baler. Cut the 6.25" notch out using the supplied measurements. Reinstall both sides.
5. The mounting hole will be 3/4" in diameter. The disc will need to be placed on the baler to line up the location of 3.5" up from bottom and 2" from the back of the chamber to the center of the bolt. (Figure 2)



9. Make sure that plastic pad is protecting all metal surfaces of disc from touching baler.
10. Run the moisture wire harness (006-4640G) from the BMP to each disc securing with cable ties.
11. On some balers the bolt may need to be trimmed for proper fit.
12. Tighten all hardware to 50 ft/lbs.
13. Apply silicone over nuts and washers

Install kit 4508B

1. If your baler is equipped with bale shaping pads, (745 Hesston) remove pads and use existing hole (may need to be drilled larger) to install new moisture sensing discs.
2. If your baler is not equipped with bale shaping pads you will need to drill a hole in the chamber directly behind and above the starting roll. (Figure 1)
3. You will need to remove the main chain assembly to install the disk on the right side of baler (when facing front of baler). (Figure 2)
4. The hole size is 3/4" diameter. Before drilling the hole make sure hole is accessible from opposite side of chamber to tighten down mounting hardware and to install moisture harness. (Figure 3)

Figure 1

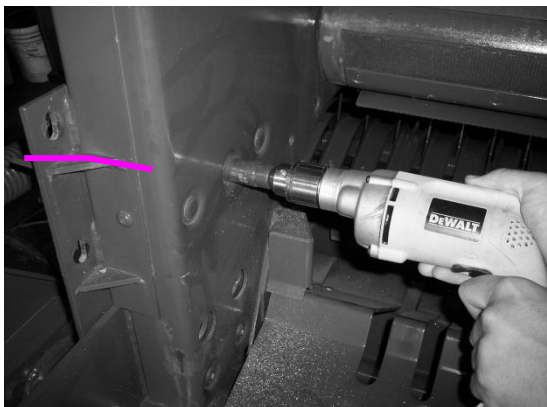

Figure 2

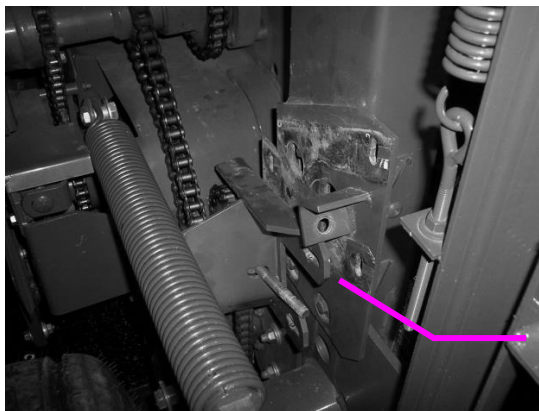

Figure 3

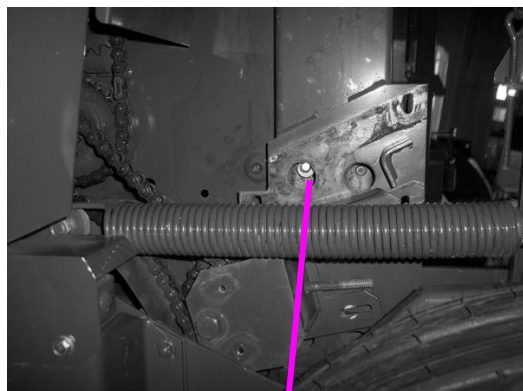
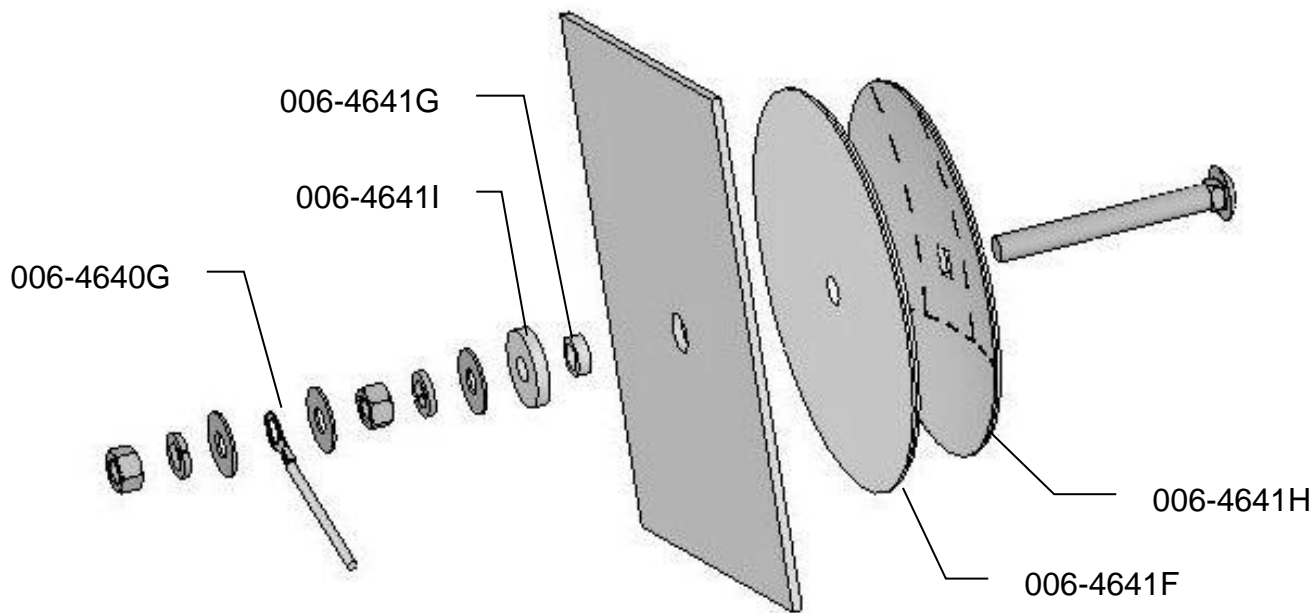

Figure 4



CONTINUED ON NEXT PAGE

Install kit 4508B cont.



5. Locate the 006-4641G. The piece will need to be cut down to size. Use the already machined line in the bushing to cut off the small piece shown above.
6. Depending on the baler the bolt may need to be trimmed for proper fit.
7. Tighten all of the hardware to 50 ft/lbs.
8. Make sure that the plastic pad is protecting all metal surfaces of the disc from touching baler. (Figure 4)
9. Run the moisture wire harness (006-4640G) from pump plate area to each disc securing with cable ties.
10. Apply silicone over nuts and washers.

Install kit 4524B

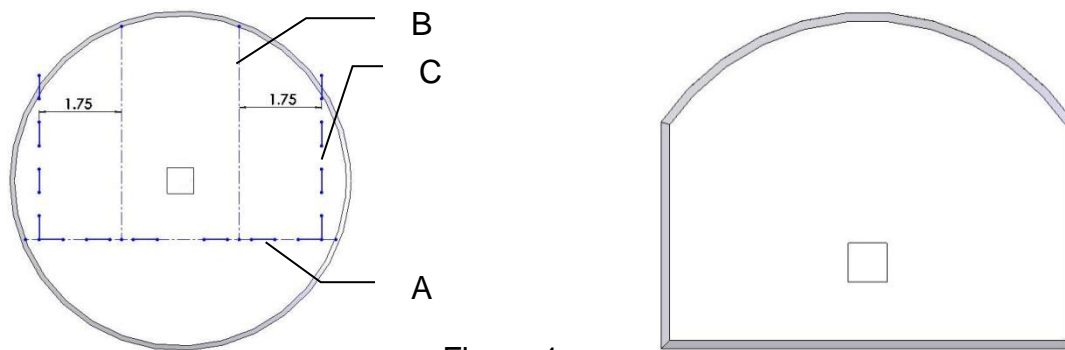

Figure 1

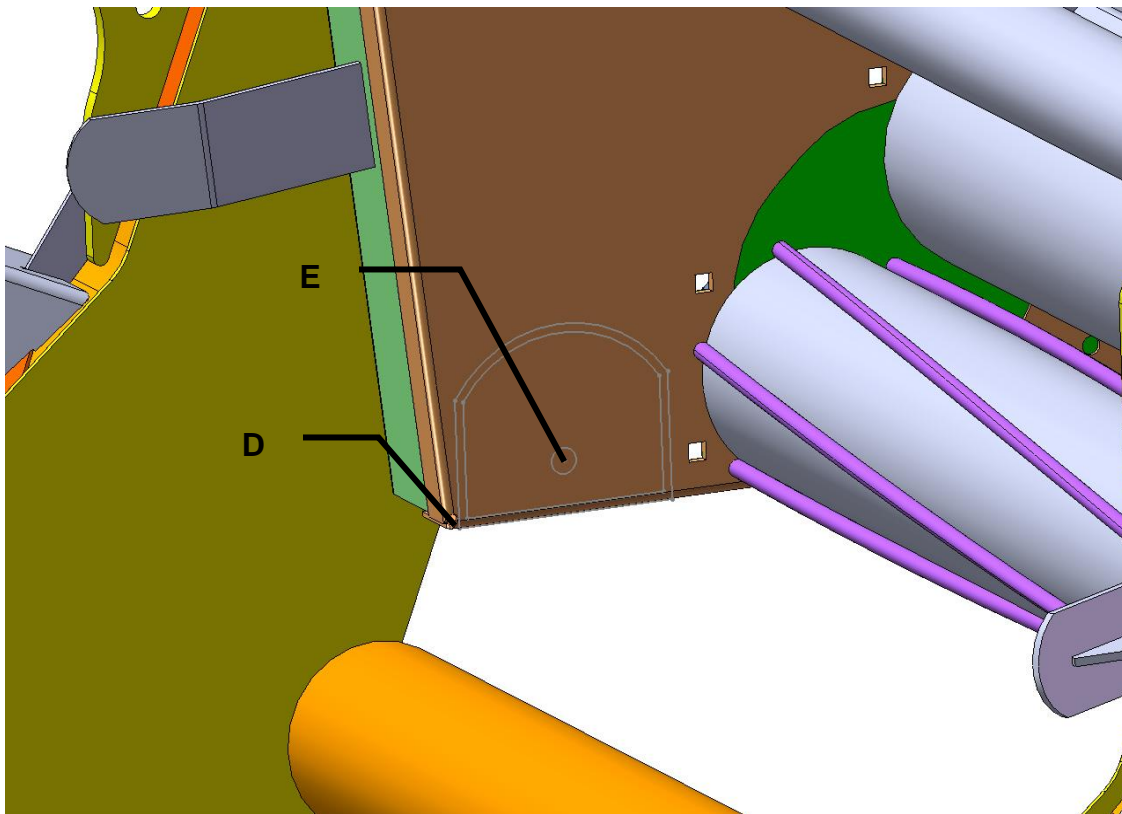
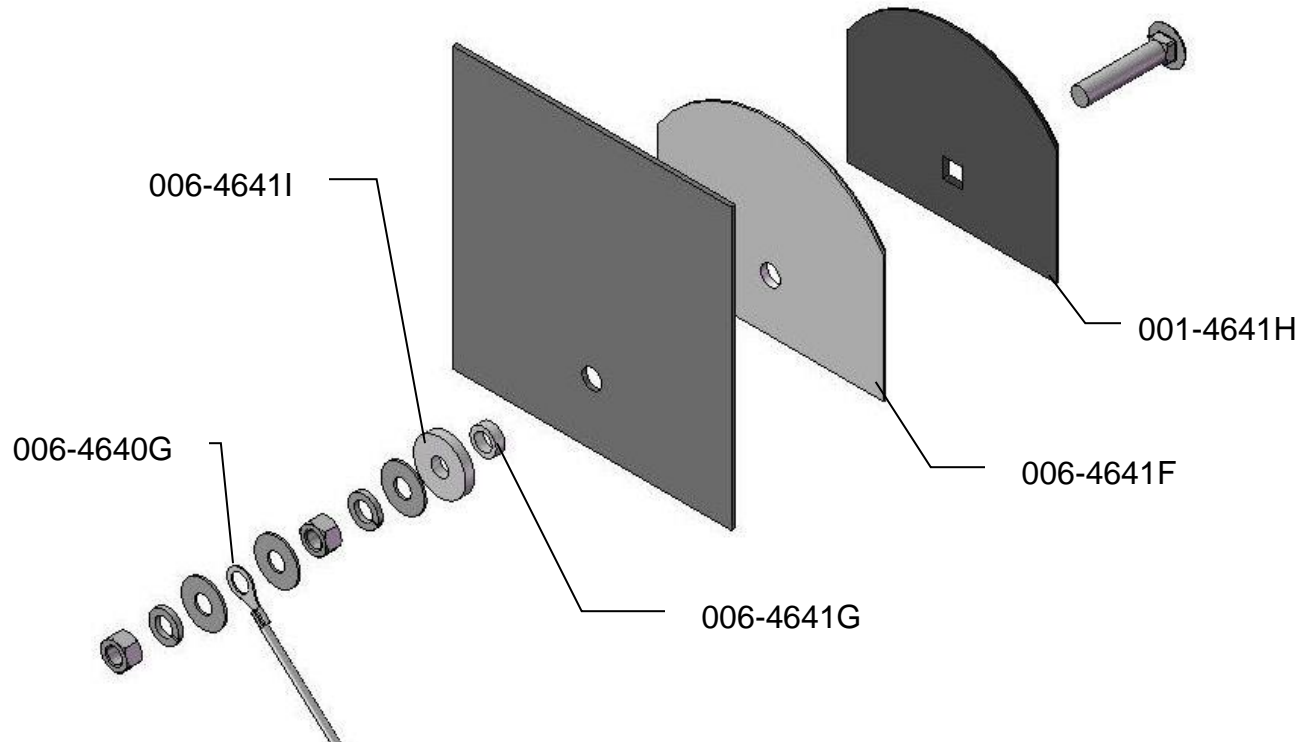

Figure 2

1. Both moisture discs (006-4641H) will need to be cut along the serrated line (A) shown on Figure 1. Measure from the laser etched line (B) 1.75 inches on both side. Mark and cut the disc. A completed disc is shown to the right.
2. The plastic pad (006-4641F) will also need to be cut 1/4" larger than the steel disc.
3. Bevel all sides of the cut discs to allow the smooth travel of crop over them.
4. Mark a line 1 1/2" up and 3 1/2" over from point D. Drill a 3/4" hole at the point (E). Repeat for the opposite side.

CONTINUED ON NEXT PAGE

Install kit 4524B cont.



5. Locate the 006-4641G. The piece will need to be cut down to size. Use the already machined line in the bushing to cut off the small piece shown above.
6. Depending on the baler the bolt may need to be trimmed for proper fit.
7. Tighten all of the hardware to 50 ft/lbs.
8. Make sure that the plastic pad is protecting all metal surfaces of the disc from touching baler.
9. Run the moisture wire harness (006-4640G) from the PIP to each disc securing with cable ties.
10. Apply silicone over nuts and washers.

Install kit 447-SO on four foot wide balers

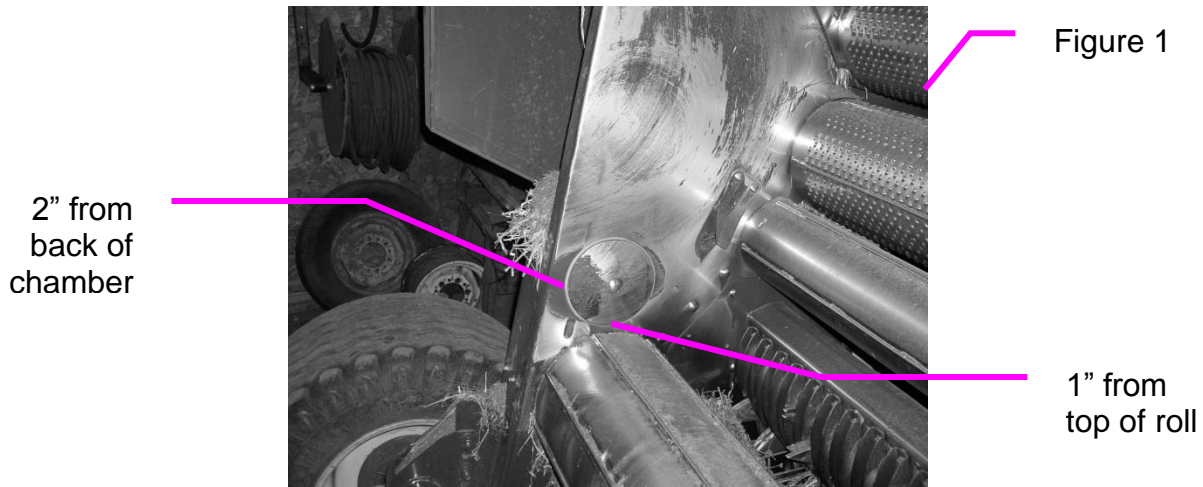

1. If your baler is equipped with bale shaping pads, remove disc and use existing hole that will need to be drilled to 3/4" to install new moisture sensing discs.
2. If your baler is not equipped with bale shaping pads you will need to drill a hole in the chamber directly behind and above the starting roll. (Figure 1)
3. The mounting hole will be 3/4" in diameter. Use a plastic pad (006-4641F) and place it into the baler to use as a template. The bottom edge of the pad will be placed 1" up from starting roll and 2" in from the back of the bale chamber. (Figure 1)

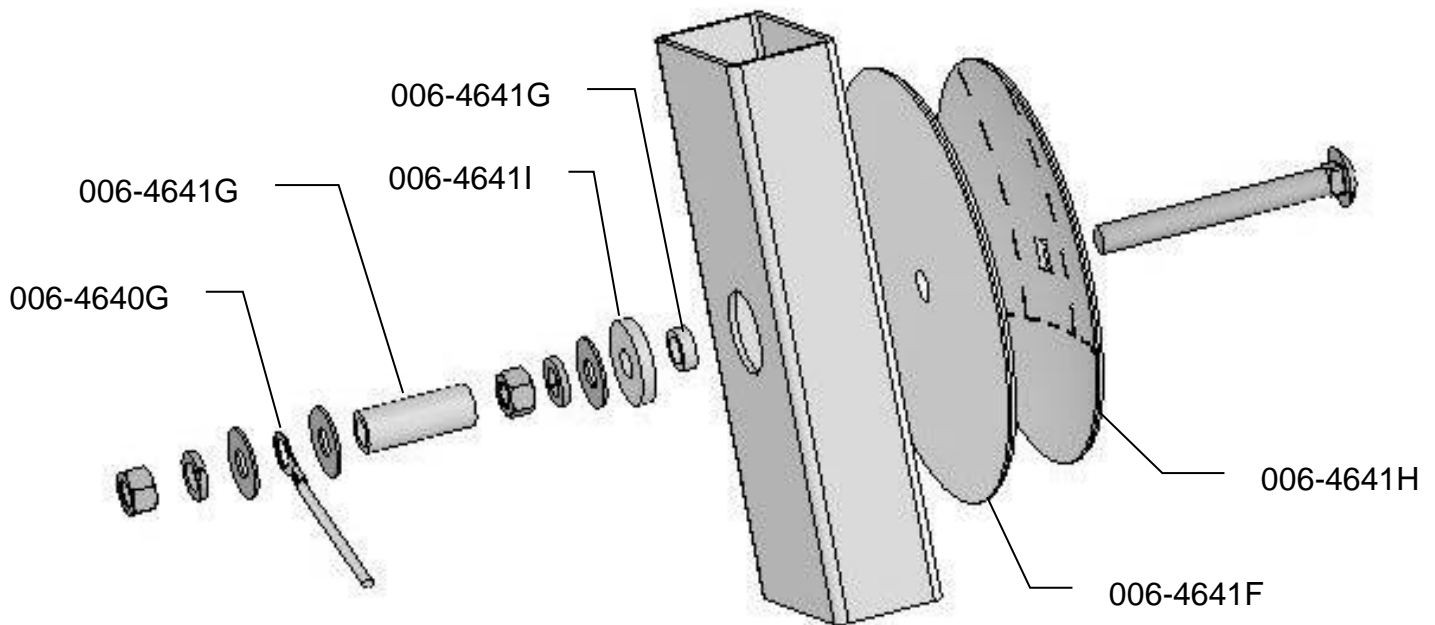

4. Locate the 006-4641G. The piece will need to be cut down to size. Use the already machined line in the bushing to cut off the small piece shown above.
5. Depending on the baler the bolt may need to be trimmed for proper fit.
6. Tighten all of the hardware to 50 ft/lbs.
7. Make sure that the plastic pad is protecting all metal surfaces of the disc from touching baler.
8. Run the moisture wire harness (006-4640G) from pump plate area to each disc securing with cable ties.
9. Apply silicone over nuts and washers.

Install kit 447-SO on five foot wide balers

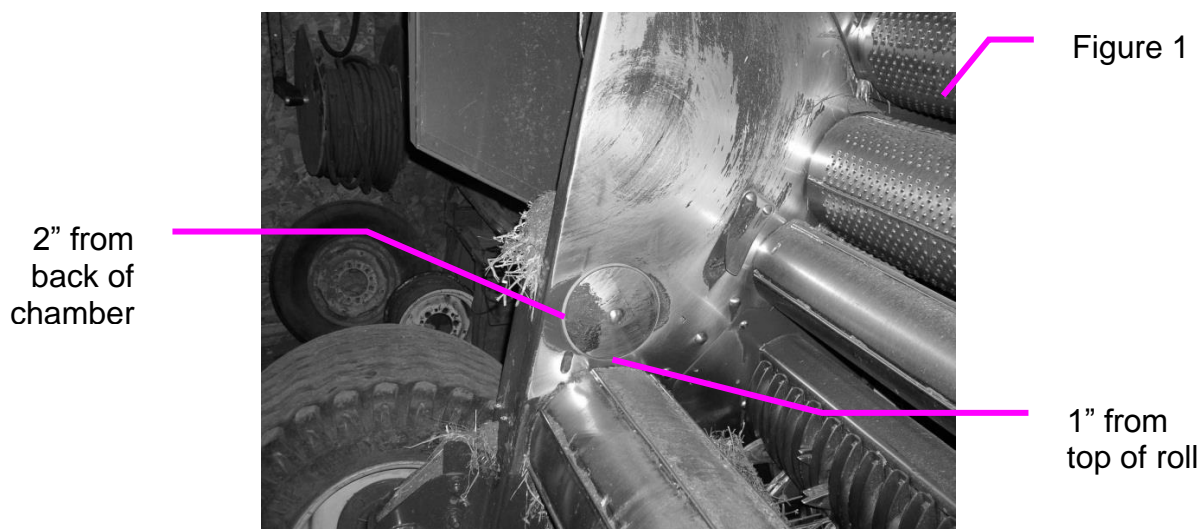

1. If your baler is equipped with bale shaping pads, remove disc and use existing that will need to be drilled to 3/4" to install new moisture sensing discs. If the discs are welded, the welds will need to ground off for disc removal.
2. If your baler is not equipped with bale shaping pads you will need to drill a hole in the chamber directly behind and above the starting roll. (Figure 1)
3. The mounting hole will be 3/4" in diameter. Use a plastic pad (006-4641F) and place it into the baler to use as a template. The bottom edge of the pad will be placed 1" up from starting roll and 2" from the back of the bale chamber. (Figure 1)

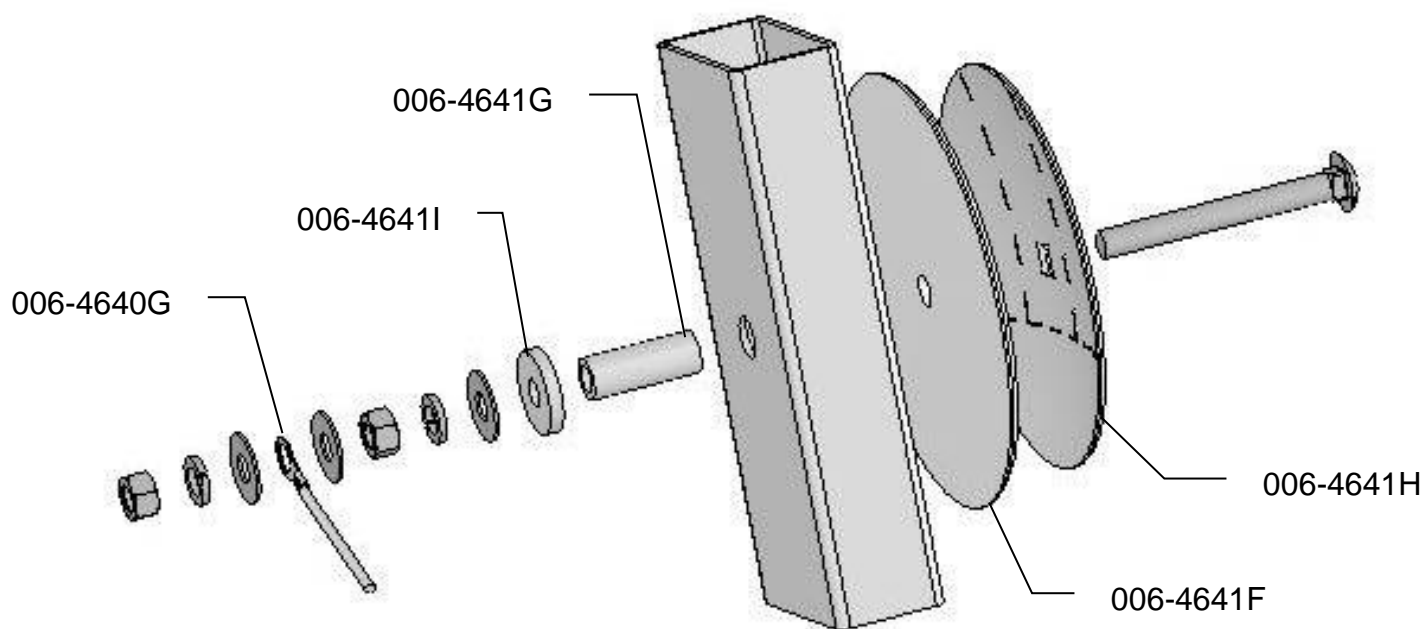

4. Depending on the baler the bolt may need to be trimmed for proper fit.
5. Tighten all of the hardware to 50 ft/lbs.
6. Make sure that the plastic pad is protecting all metal surfaces of the disc from touching baler.
7. Run the moisture wire harness (006-4640G) from pump plate area to each disc securing with cable ties.
8. Apply silicone over nuts and washers.

8. Power cable and main wiring harnesses installation

1. Connect the power harness (006-4640A) to the battery (12 volt) using the red wire with fuse to the positive side and the black wire to the negative
 - a. **The power harness must be connected to the battery!** The unit will draw more amps than convenience outlets can handle. Any modifications of the power harness will void systems warranty. **CONTACT HARVEST TEC BEFORE MODIFICATIONS.**
 - b. **This unit will not function on positive ground tractors.**
 - c. **If the unit loses power while operating it will not keep track of accumulated pounds of product used.**
2. The power harness (006-4640A) will run from the tractor battery to the hitch. The power harness (006-4660R) will connect to the tractor power harness (006-4640A) at the hitch. Run the Communication harness (006-4660N) from the cab to the hitch. This wire will connect to the Communication harness (006-4660S). These wires will run together to the Baler Mounted Processor (006-4671RB).
3. Connect Flow Meter (006-4725A) and pump harness (006-4660Z) to the Baler Mounted Processor.
4. If you have the optional Hay Indicator, connect it to the Baler Mounted Processor.
5. Attach moisture cable (006-4640G) to Baler Mounted Processor.
6. Install Baler Mounted Processor in pump plate using 5/16" lock, nut and flat washers.

NOTE: The plugs on the Baler Mounted Processor must face down. Failure to mount correctly will void systems warranty.

System wiring diagram

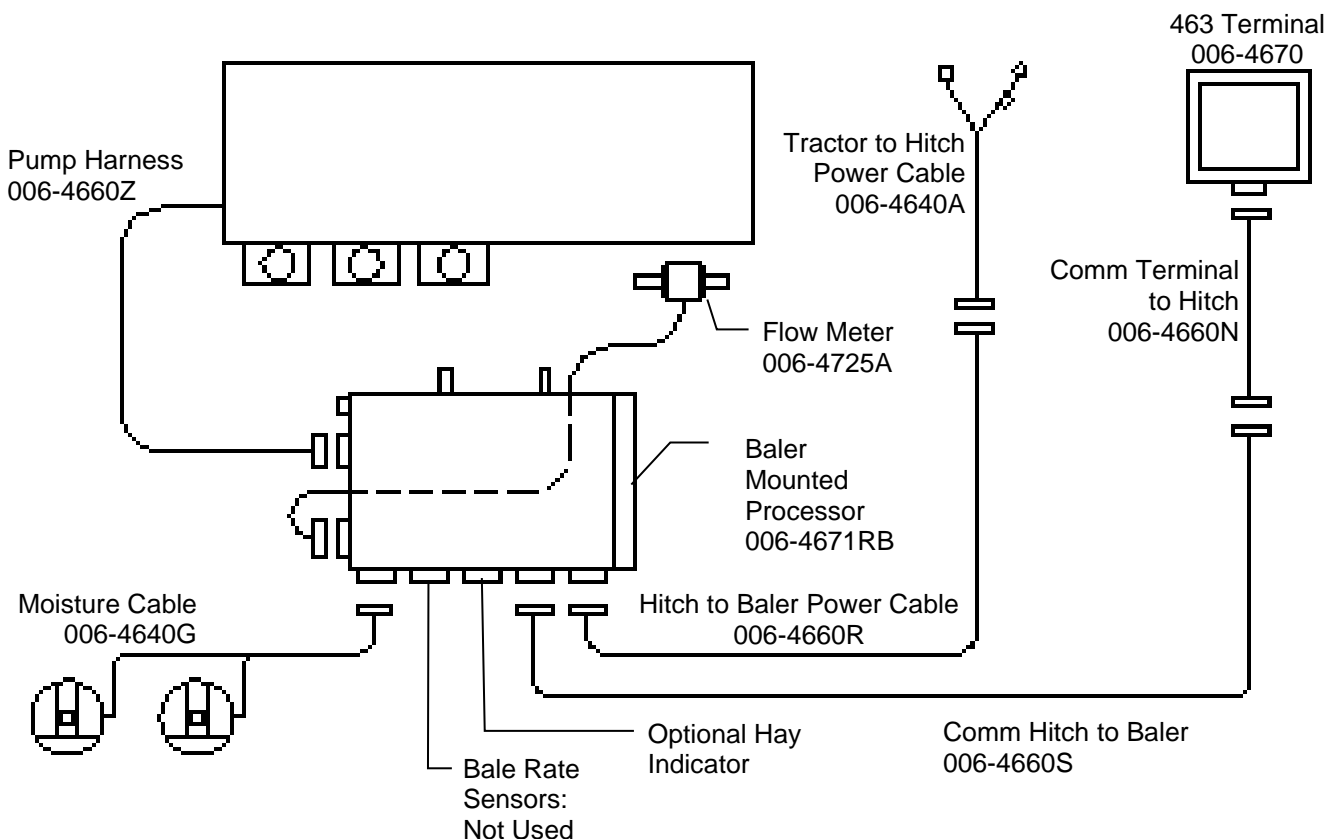

Installation of control

Use the supplied suction cup mount to position the monitor in the cab. Make sure the glass is clean before installing the suction cup mount. If a non-cabbed tractor is used, use the supplied #10 screws for installation on the fender. If unit is mounted on fender it will need to be removed at night and stored in a clean, dry area. Use the Ram mount swivel-positioning nut to tighten the entire assembly. Adjust it so that you can view the entire screen and be able to use the touch screen without interfering with other tractor functions.

Connect communication wire (006-4660N) to the bottom of the terminal.

Pin Outs

A. Main power connector mounted on battery

Pin 1	Red	+ 12 V input from tractor supply
Pin 2	Black	Ground from tractor supply
Pin 3	Not used	

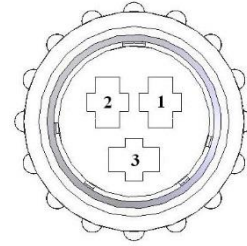

B. Main power connector mounted on BMP

Pin 1	Red	+ 12 V input from tractor supply
Pin 2	Black	Ground from tractor supply
Pin 3	Not used	

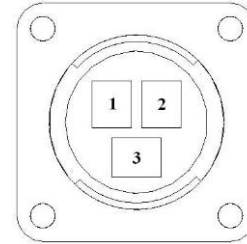

C. Pump connection colors

Pin 1	Black with orange markings	Pump 1 ground
Pin 2	Black with green markings	Pump 2 ground
Pin 3	Black with yellow markings	Pump 3 ground
Pin 4	Not used	
Pin 5	Orange with black markings	Pump 1 positive
Pin 6	Green with black markings	Pump 2 positive
Pin 7	Yellow with black markings	Pump 3 positive

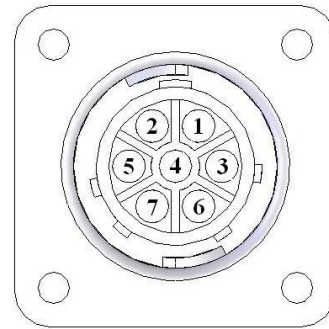

D. Flow meter connection on BMP

Pin 1	White	5 - 12 V (+) supply
Pin 2	Green	Ground
Pin 3	Brown	Signal
Pin 4	Black	Shield

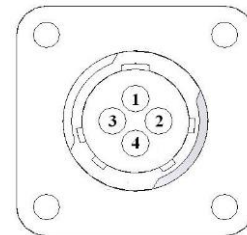

E. Connector for Hay Indicator option on BMP

Note: Hay indicators are an option that will turn the system on and off automatically as hay enters the pickup of the baler.

Pin 1	Red	+12V
Pin 2	Black	Ground
Pin 3	White	Signal wire
Pin 4	Not used	

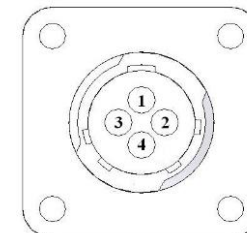

G. Star wheel connector mounted on BMP

Pin 1	Brown	Star wheel input 1
Pin 2	Blue	Star wheel input 2
Pin 3	Brown	Diagnostic 1
Pin 4	Blue	Diagnostic 2
Pin 5	Silver	Shield
Pin 6	Silver	Shield
Pin 7	Not used	
Pin 8	Not used	
Pin 9	Not used	

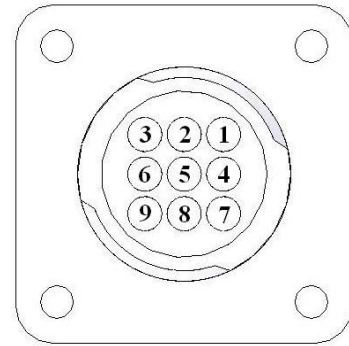

H. Communication harness display to hitch

Pin 1	Red	Power to display
Pin 2	Black	Ground to display
Pin 3	Blue	Comm channel OH
Pin 4	Orange	Comm channel OL

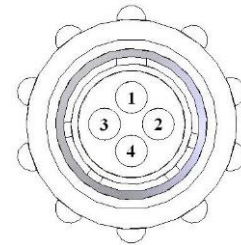

I. Communication harness hitch to baler mounted processor

Pin 1	Red	Power to display
Pin 2	Black	Ground to display
Pin 3	Blue	Comm channel OH
Pin 4	Orange	Comm channel OL

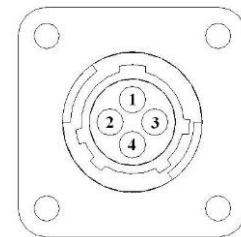

Harvest Tec Model 446 base kit

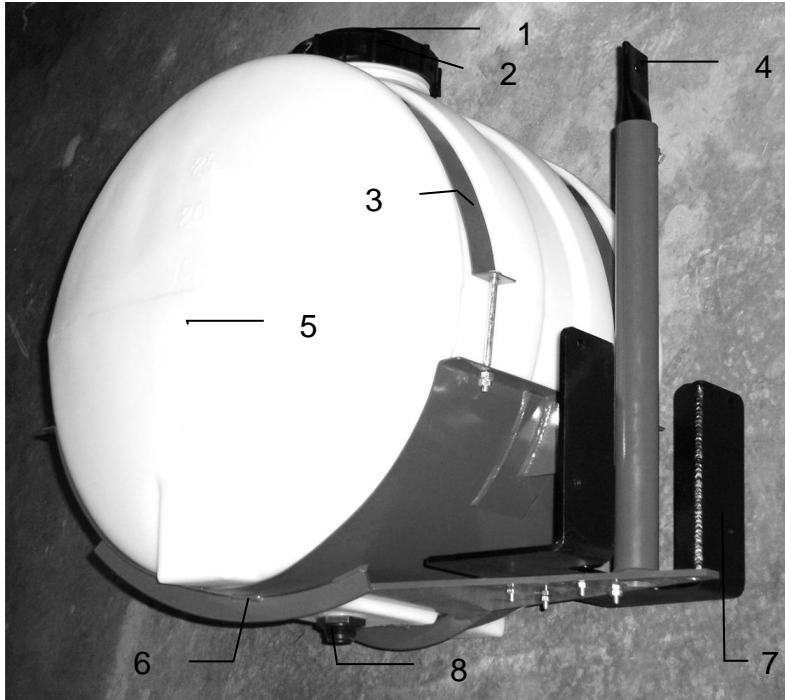

<u>Ref</u>	<u>Description</u>	<u>Part #</u>	<u>Qty</u>
1	Tank Cap	005-9022C	1
2	Tank Cap Gasket	005-9022CG	1
3	Tank Strap	001-4402	2
4	Stub Pipe	001-4403	1
5	Tank	005-9022	1
6	Saddle	001-4401	1
7	Mounting Bracket	001-4647	1
8	Tank Fitting	005-9100	1

Harvest Tec Model 447 Base Kit

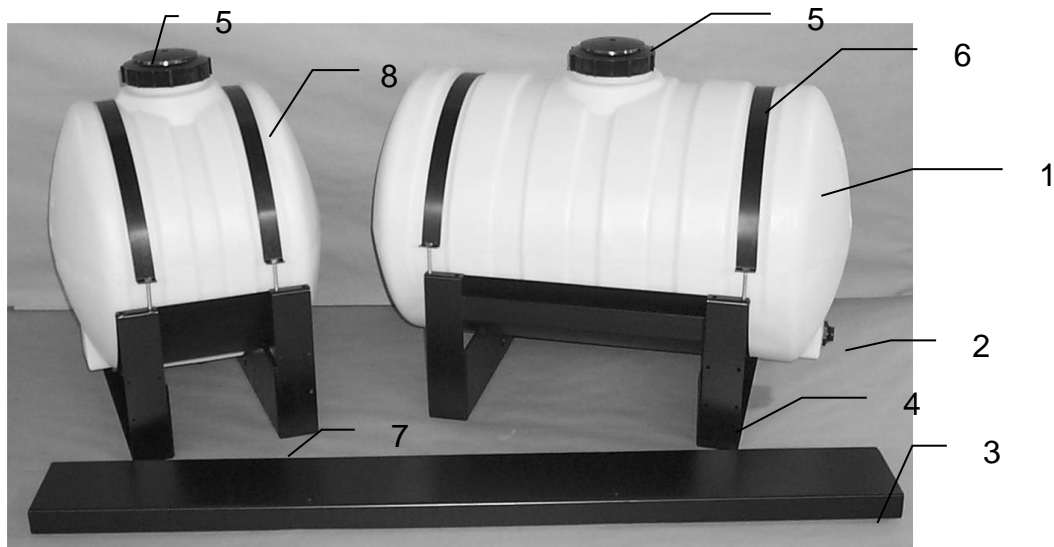

<u>Ref #</u>	<u>Description</u>	<u>Part #</u>	<u>Qty</u>
1	55 Gallon tank	005-9203	1
2	Tank fitting	005-9100	1
3	Cross support bracket	001-4445B	1
4	55 Gallon saddle	001-4445A	1
5	Tank lid	005-9022C	1
	Tank lid gasket	005-9022CG	1
6	Tank strap	001-4402	1
7	25 Gallon saddle	001-4442	1
8	25 Gallon tank	005-9022	1

Harvest Tec Model 449 base kit

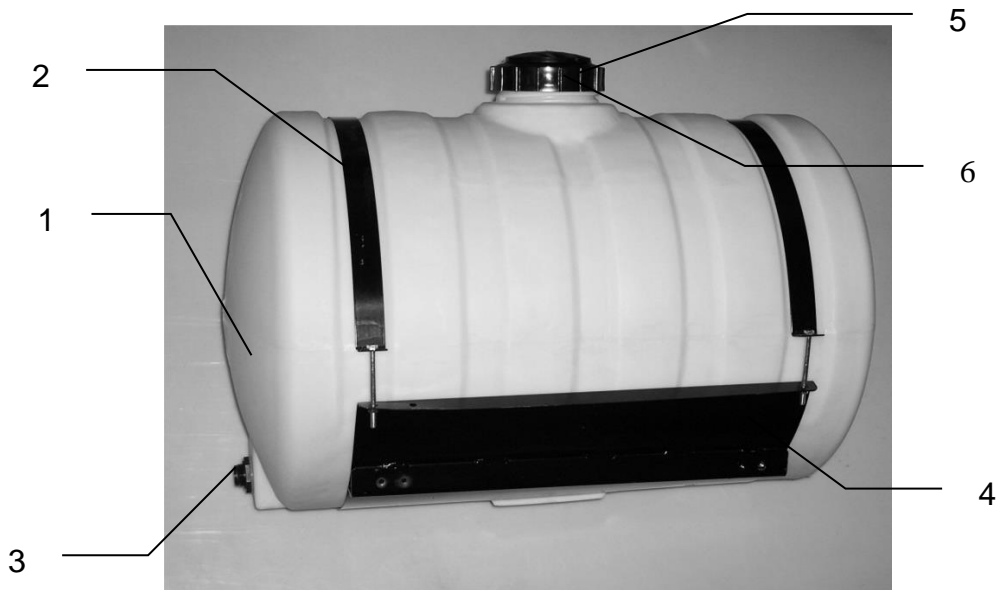

<u>Ref#</u>	<u>Description</u>	<u>Part #</u>	<u>Qty</u>
1	Tank	005-9203	1
2	Straps	001-4402	2
3	Tank Fitting	005-9100	2
4	Saddle	001-4703	1
5	Tank Cap	005-9022C	1
6	Tank Gasket	005-9022CG	1

Parts breakdown for drain fill kit (447 & 449 only)

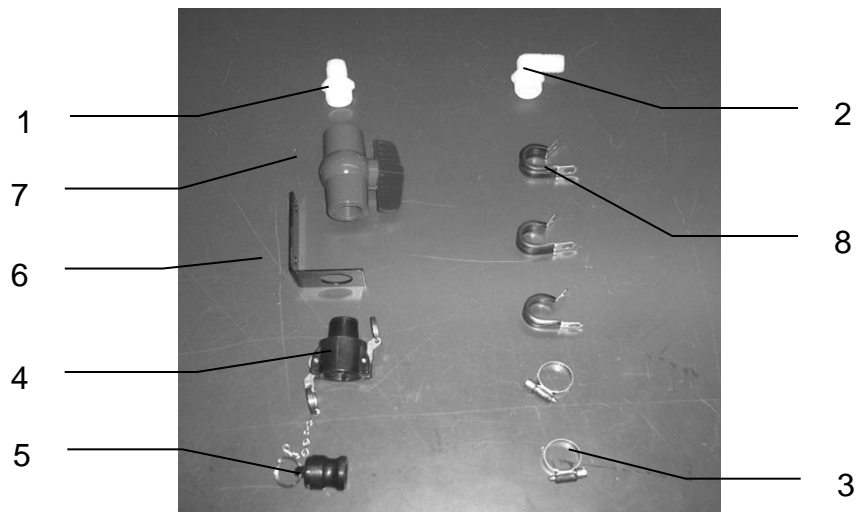

<u>Ref #</u>	<u>Description</u>	<u>Part #</u>	<u>Qty</u>	<u>Ref #</u>	<u>Description</u>	<u>Part #</u>	<u>Qty</u>
1	Straight Fitting	003-A3434	1	5	Male Coupler	002-2205G	1
2	Elbow	003-EL3434	1	6	Valve Holder	001-6702H	1
3	Hose Clamps	003-9004	2	7	Ball Valve	002-2200	1
4	Female Coupler	002-2204A	1	8	Jiffy Clip	008-9010	3

Parts Breakdown for Pump Manifold

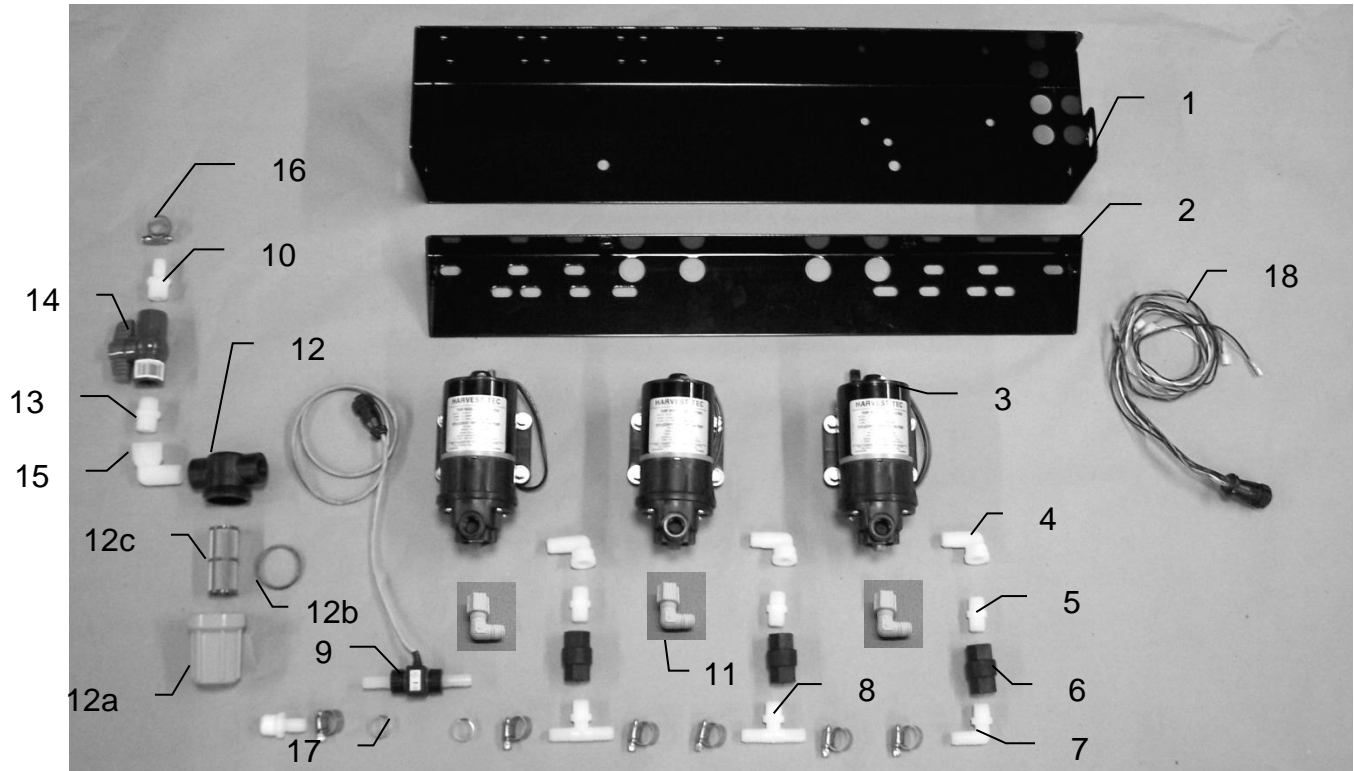

<u>Ref</u>	<u>Description</u>	<u>Part #</u>	<u>Qty</u>
1	Pump plate	001-4646D	1
2	Mounting Bracket	001-4646C	1
3	Pump	007-4120H	3
4	Street elbow fitting	003-SE38	3
5	Nipple fitting	003-M3838	3
6	Check valve	002-4566F	3
7	Elbow fitting	003-EL3812	1
8	Tee fitting	003-T3812HB	2
9	Flow meter assembly	006-4725A	1
10	Straight fitting	003-A1212	2
11	Elbow fitting	003-EL3814	3
12	Filter bowl assembly	002-4315	1
12a	Filter bowl only	002-4315F	1
12b	Filter bowl gasket	002-4315D	1
12c	Filter bowl screen	002-4315B	1
13	Nipple fitting	003-M1212	2
14	Ball valve	002-2212	1
15	Street elbow fitting	003-SE12	1
16	Hose clamp	003-9003	7
17	Hose clamp (Flow Meter)	003-9005	2
18	Pump Cable	006-4660Z	1
NP	Pump rebuild kit (1 per pump)	007-4581	1
NP	Union	003-M1212F	1
NP	Not Pictured		

Moisture Sensor and Hoses Parts Breakdown

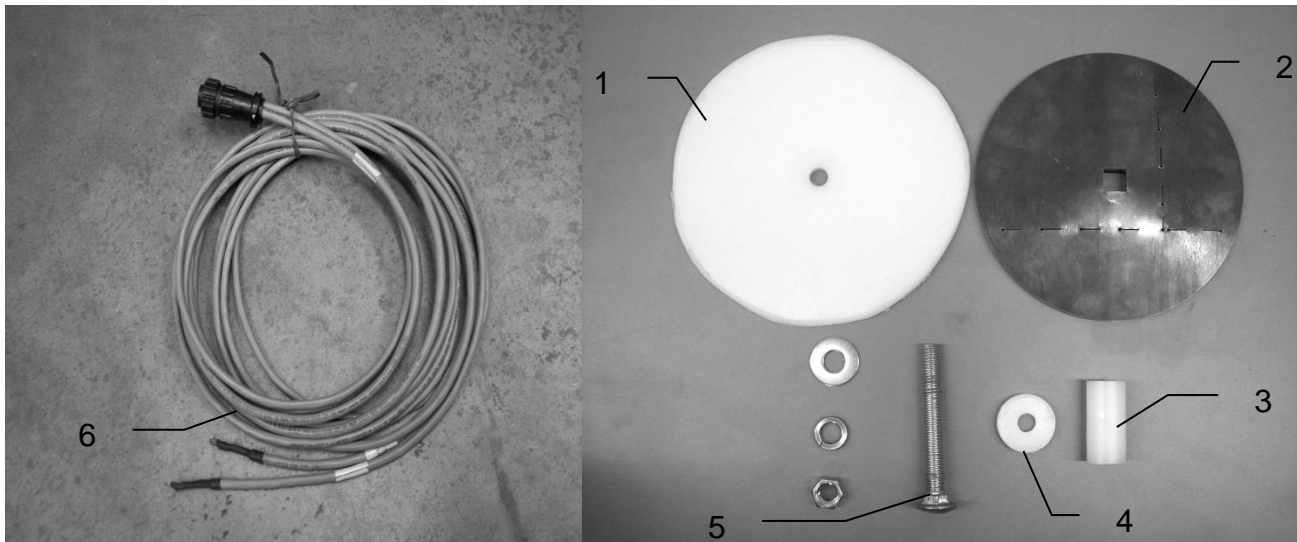

<u>Ref</u>	<u>Description</u>	<u>Part #</u>	<u>Qty</u>
1	Plastic Pad	006-4641F	2
2	Moisture Disc	006-4641H	2
3	Plastic Bushing	006-4641G	2
4	Plastic Isolator	006-4641I	2
5	1/2X4 1/2" Carriage Bolt		2
6	Moisture Cable	006-4640G	1
1-5	Moisture Pad Assembly	030-4643	2

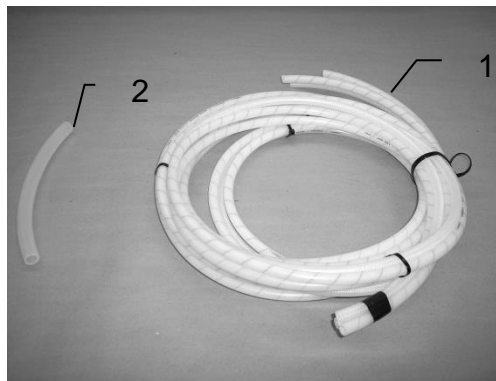

<u>Ref</u>	<u>Description</u>	<u>Part #</u>	<u>Qty</u>
1	Triple weld hose (from pumps to tips)	002-9016	15ft
		002-9016B	15ft
		002-9016G	15ft
	Hose assembly (3 hose assembly)	030-9016RB	1
2	1/2" Hose (tank to filter)	002-9001	6ft

Parts Breakdown for Control Box and Wiring Harnesses

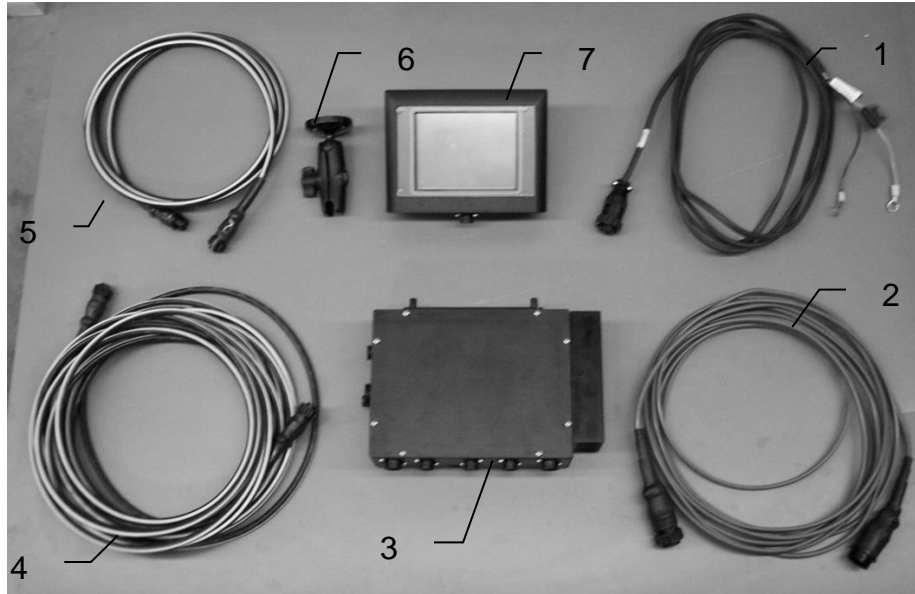

<u>Ref.</u>	<u>Description</u>	<u>Part #</u>
1	Power lead tractor	006-4640A
2	Power lead baler	006-4660R
3	Baler mounted processor	006-4671RB
4	Communication harness (baler)	006-4660S
5	Communication harness (tractor)	006-4660N
6	Ram mount	001-2012H
7	463 Terminal	006-4670

Harvest Tec Model 4400CB Installation Kit

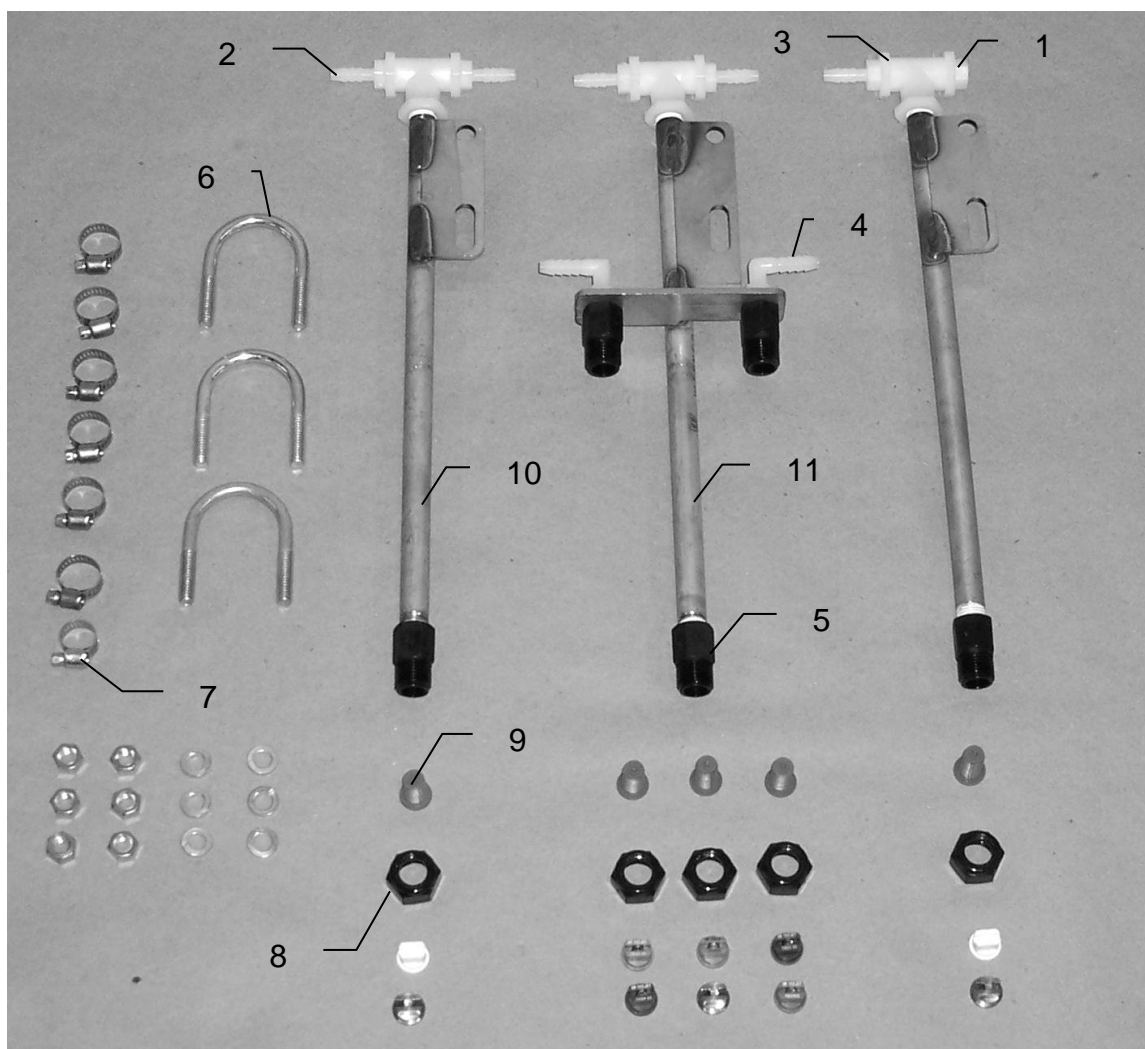

<u>Ref</u>	<u>Description</u>	<u>Part#</u>	<u>Qty</u>	<u>Description</u>	<u>Part#</u>	<u>Qty</u>
1	Plug	003-F14	1	Tip – Low – Silver	004-650033-SS	3
2	Straight fitting	003-A1414	5	Tip – Low – Green	004-XR110015VS	1
3	Tee	003-TT14	3	Tip – Low – Red	004-XR11004VS	1
4	Elbow	003-EL1414	2	Tip – High – White	004-650050-PT	2
5	Nozzle body	004-4721	5	Tip – High – Orange	004-XR11001VS	1
6	U bolt	001-4714UBS	3	Tip – High – Blue	004-XR11003VS	1
7	Hose clamp	003-9002	7	Tip – High – Grey	004-XR11006VS	1
8	Nozzle cap	004-4723	5			
9	Tip strainer with check	004-4213-200	5			
10	Nozzle tube	001-4714	2			
11	Nozzle tube auto	001-4714A	1			

Harvest Tec Model 447-SO Spray Shield Assembly

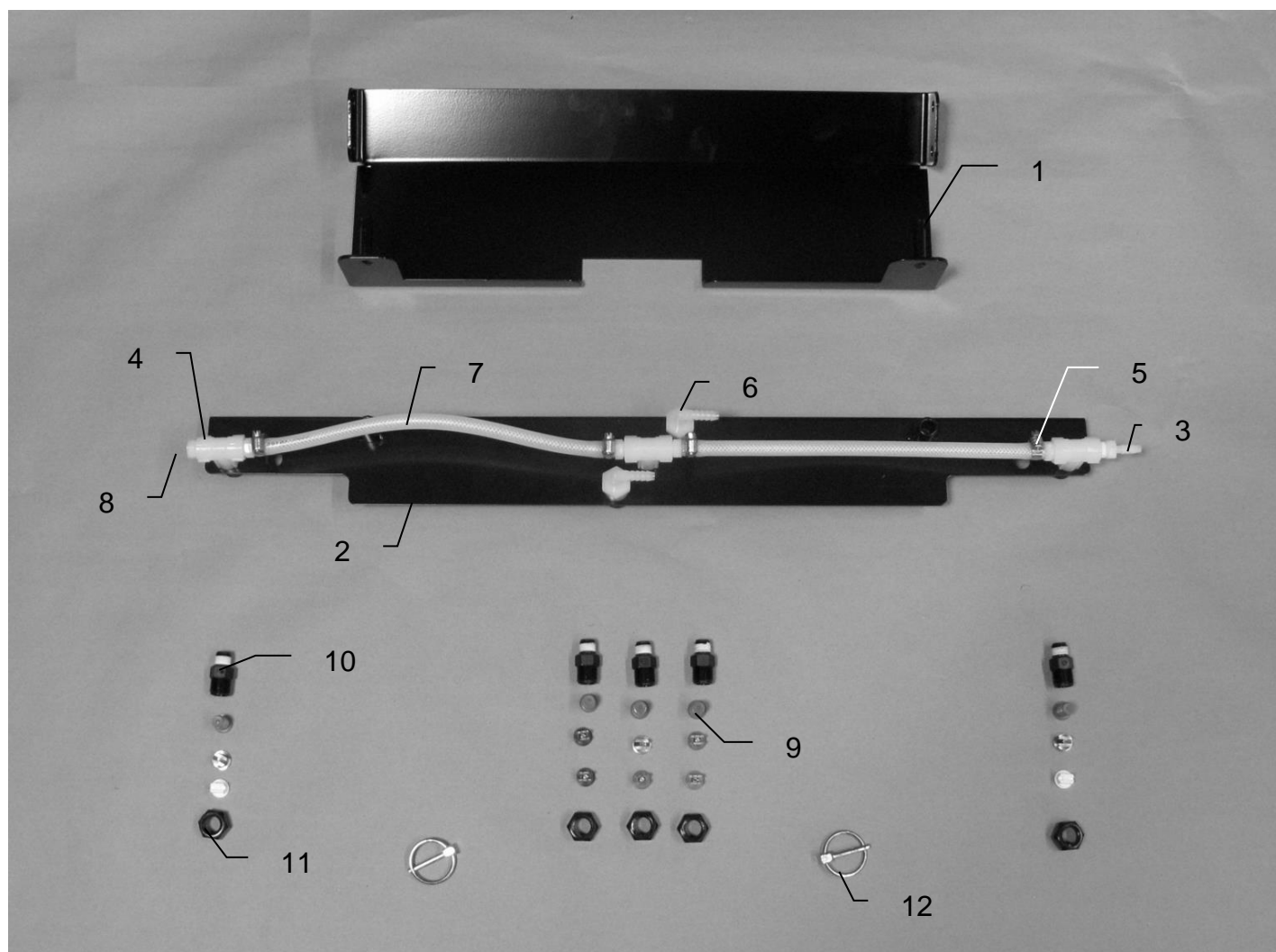

<u>Ref</u>	<u>Description</u>	<u>Part #</u>	<u>Qty</u>	<u>Ref</u>	<u>Description</u>	<u>Part #</u>	<u>Qty</u>
1	Shield bracket	001-4810BRH	1	NP	Tip – Low – Silver	004-650033-SS	3
2	Spray shield	001-4810B	1	NP	Tip – Low – Green	004-XR110015VS	1
3	Straight fitting	003-A1414	5	NP	Tip – Low – Red	004-XR11004VS	1
4	Tee	003-TT14	3	NP	Tip – High – White	004-650050-PT	2
5	Hose clamp	003-9002	7	NP	Tip – High – Orange	004-XR11001VS	1
6	Elbow	003-EL1414F	2	NP	Tip – High – Blue	004-XR11003VS	1
7	Hose	002-9016	3 ft	NP	Tip – High – Grey	004-XR11006VS	1
8	Plug	003-F14	1				
9	Tip strainer	004-4213-200	5	NP	Not Pictured		
10	Nozzle body	004-4722	5				
11	Nozzle cap	004-4723	5				
12	Lynch pin	008-4576	2				

Harvest Tec Model 4483B Installation Kit

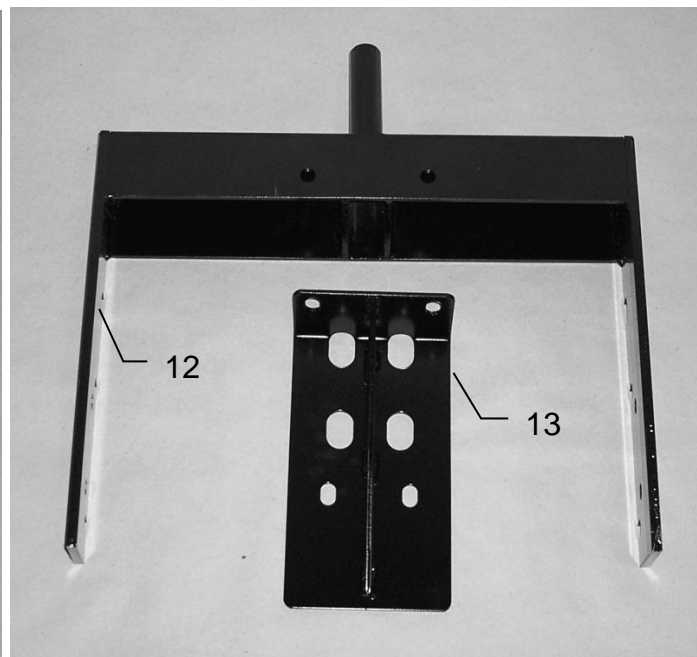
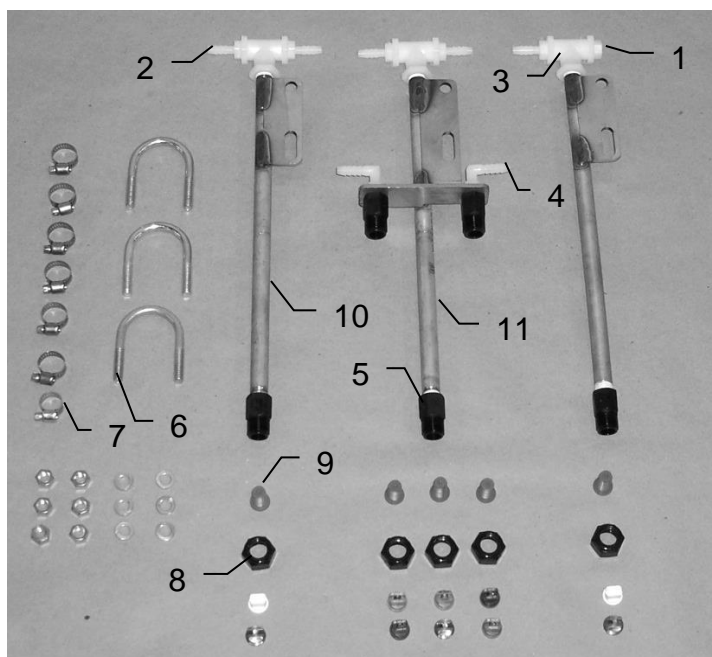

<u>Ref</u>	<u>Description</u>	<u>Part#</u>	<u>Qty</u>	<u>Description</u>	<u>Part#</u>	<u>Qty</u>
1	Plug	003-F14	1	Tip – Low - Silver	004-650033-SS	3
2	Straight fitting	003-A1414	5	Tip – Low – Green	004-XR110015VS	1
3	Tee	003-TT14	3	Tip – Low – Red	004-XR11004VS	1
4	Elbow	003-EL1414	2	Tip – High – White	004-650050-PT	2
5	Nozzle body	004-4721	5	Tip – High – Orange	004-XR11001VS	1
6	U bolt	001-4714UBS	3	Tip – High – Blue	004-XR11003VS	1
7	Hose clamp	003-9002	7	Tip – High – Grey	004-XR11006VS	1
8	Nozzle cap	004-4723	5			
9	Tip strainer with check	004-4213-200	5			
10	Nozzle tube	001-4714	2			
11	Nozzle tube auto	001-4714A	1			
12	Mounting bracket	001-4411	1			
13	Support	001-4411A	1			

Harvest Tec Model 4484B installation kit

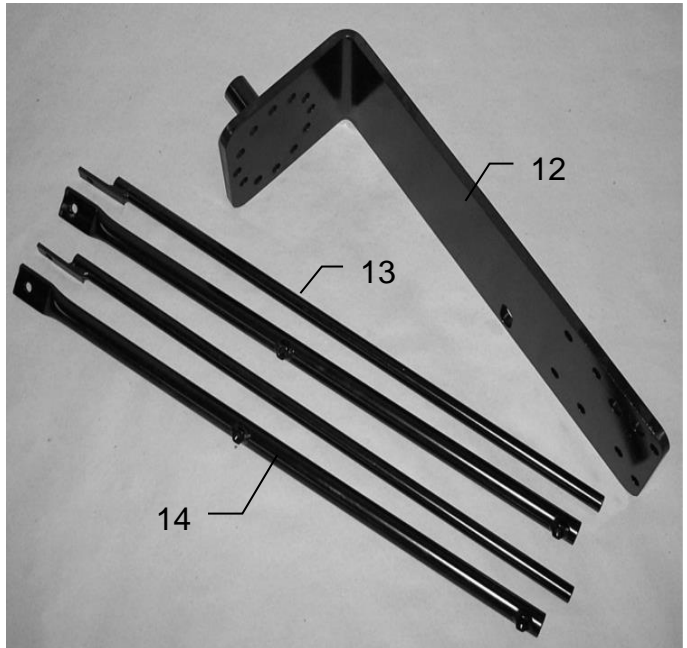
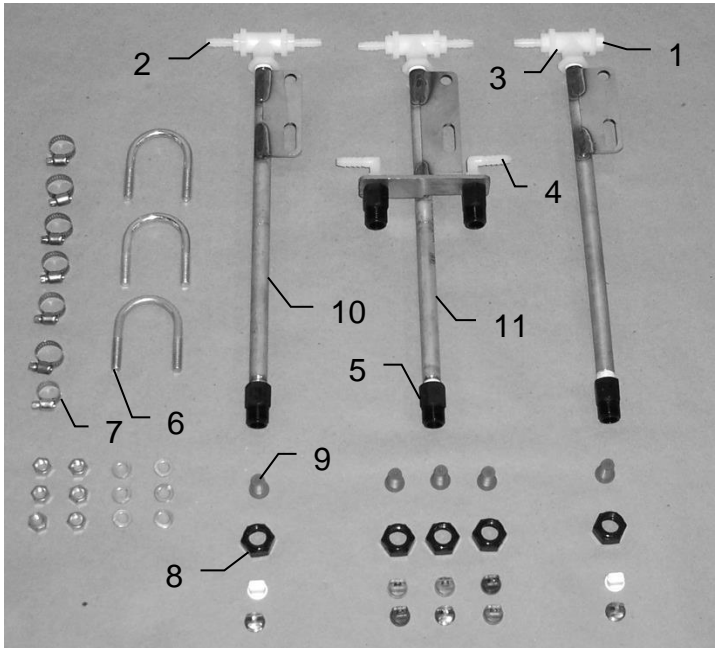

<u>Ref</u>	<u>Description</u>	<u>Part#</u>	<u>Qty</u>	<u>Description</u>	<u>Part#</u>	<u>Qty</u>
1	Plug	003-F14	1	Tip – Low – Silver	004-650033-SS	3
2	Straight fitting	003-A1414	5	Tip – Low – Green	004-XR110015VS	1
3	Tee	003-TT14	3	Tip – Low – Red	004-XR11004VS	1
4	Elbow	003-EL1414	2	Tip – High – White	004-650050-PT	2
5	Nozzle body	004-4721	5	Tip – High – Orange	004-XR11001VS	1
6	U bolt	001-4714UBS	3	Tip – High – Blue	004-XR11003VS	1
7	Hose clamp	003-9002	7	Tip – High – Grey	004-XR11006VS	1
8	Nozzle cap	004-4723	5			
9	Tip strainer with check	004-4213-200	5			
10	Nozzle tube	001-4714	2			
11	Nozzle tube auto	001-4714A	1			
12	Mounting bracket	001-4418	1			
13	Inside reach rod	001-4405	2			
14	Outside reach rod	001-4404	2			

Harvest Tec Model 4486B Installation Kit

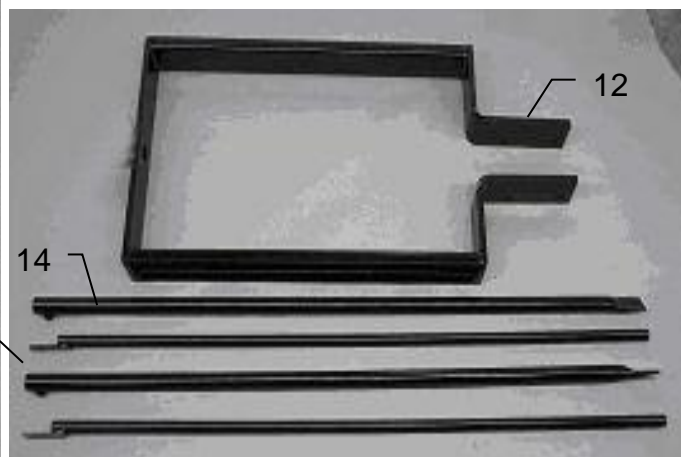
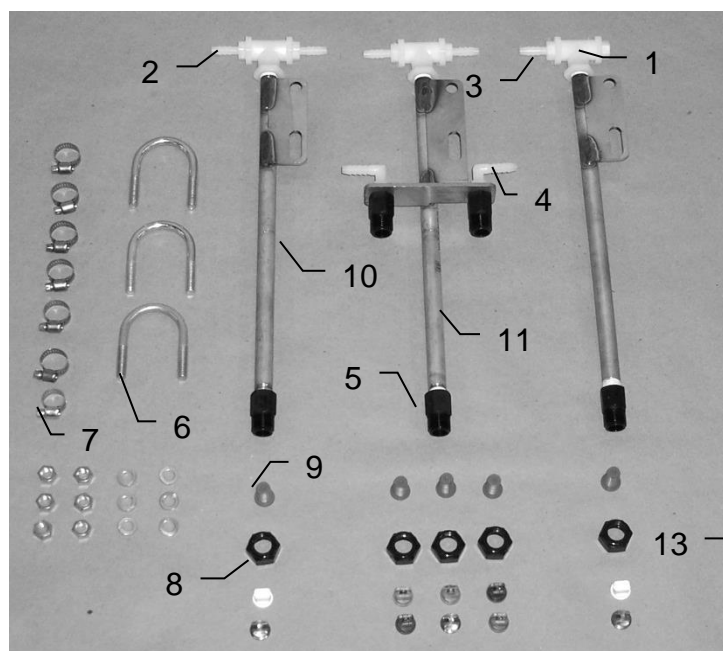

<u>Ref</u>	<u>Description</u>	<u>Part #</u>	<u>Qty</u>	<u>Description</u>	<u>Part#</u>	<u>Qty</u>
1	Plug	003-F14	1	Tip – Low – Silver	004-650033-SS	3
2	Straight fitting	003-A1414	5	Tip – Low – Green	004-XR110015VS	1
3	Tee	003-TT14	3	Tip – Low – Red	004-XR11004VS	1
4	Elbow	003-EL1414	2	Tip – High – White	004-650050-PT	2
5	Nozzle body	004-4721	5	Tip – High – Orange	004-XR11001VS	1
6	U bolt	001-4714UBS	3	Tip – High – Blue	004-XR11003VS	1
7	Hose clamp	003-9002	7	Tip – High – Grey	004-XR11006VS	1
8	Nozzle cap	004-4723	5			
9	Tip strainer with check	004-4213-200	5			
10	Nozzle tube	001-4714	2			
11	Nozzle tube auto	001-4714A	1			
12	Mounting bracket	001-4420	1			
13	Inside reach rod	001-4405A	2			
14	Outside reach rod	001-4404A	2			

Harvest Tec Model 4503B Installation Kit

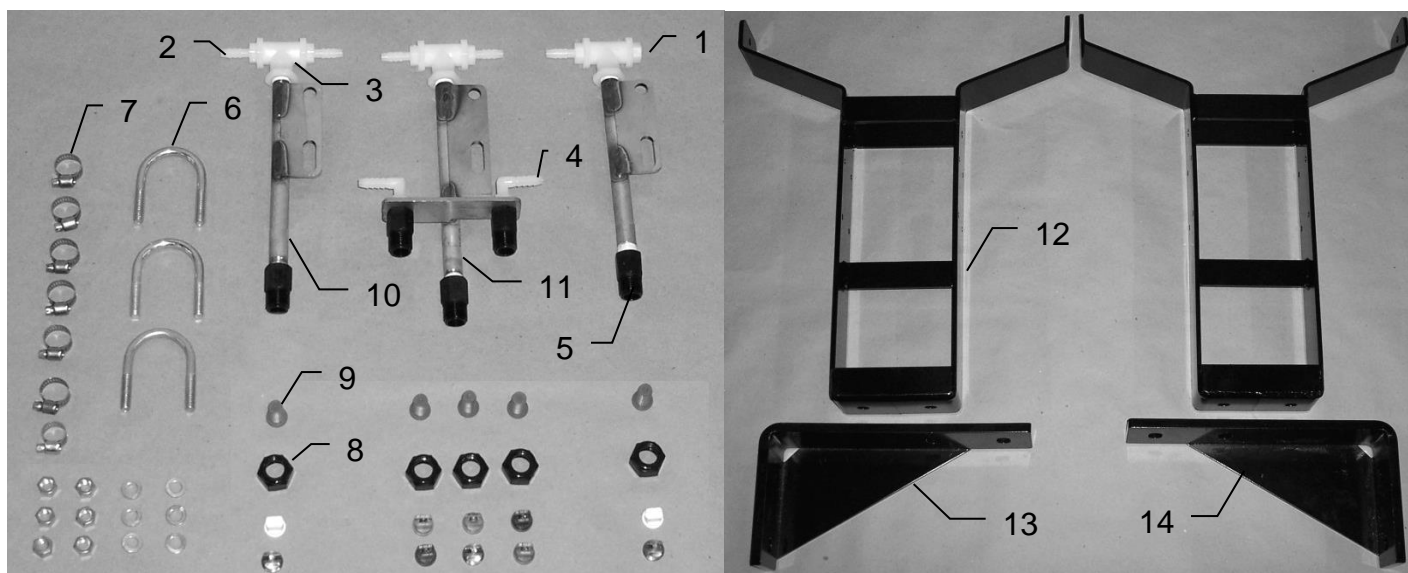

<u>Ref</u>	<u>Description</u>	<u>Part #</u>	<u>Qty</u>	<u>Description</u>	<u>Part #</u>	<u>Qty</u>
1	Plug	003-F14	1	Tip – Low – Silver	004-650033-SS	3
2	Straight fitting	003-A1414	5	Tip – Low – Green	004-XR110015VS	1
3	Tee	003-TT14	3	Tip – Low – Red	004-XR11004VS	1
4	Elbow	003-EL1414	2	Tip – High – White	004-650050-PT	2
5	Nozzle body	004-4721	5	Tip – High – Orange	004-XR11001VS	1
6	U bolt	001-4714UBS	3	Tip – High – Blue	004-XR11003VS	1
7	Hose clamp	003-9002	7	Tip – High – Grey	004-XR11006VS	1
8	Nozzle cap	004-4723	5			
9	Tip strainer with check	004-4213-200	5			
10	Nozzle tube	001-4714P	2			
11	Nozzle tube auto	001-4714AP	1			
12	Saddle legs	001-4703B	2			
13	Left mtg bracket	001-4703EL	1			
14	Right mtg bracket	001-4703ER	1			
NP	45 degree elbow	003-SE4514	5			
NP	Jack extension	001-4703EXT	1			

Harvest Tec Model 4504B Installation Kit

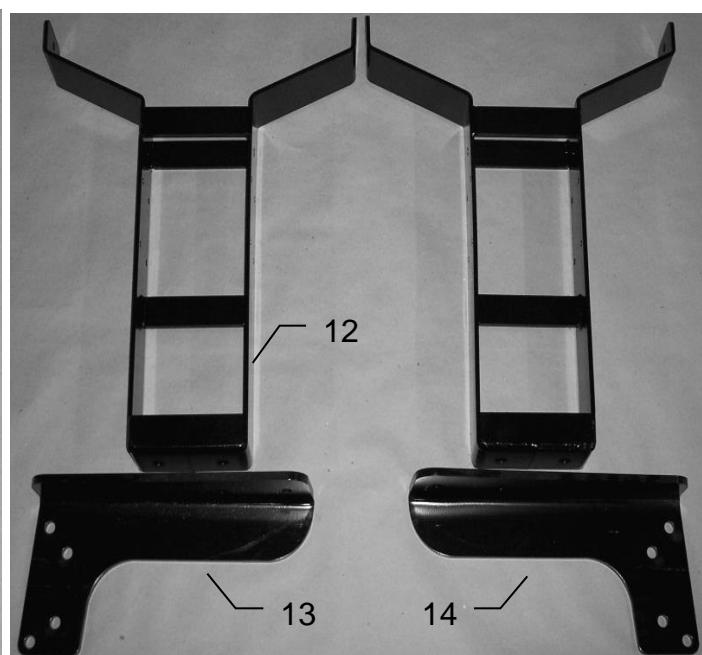
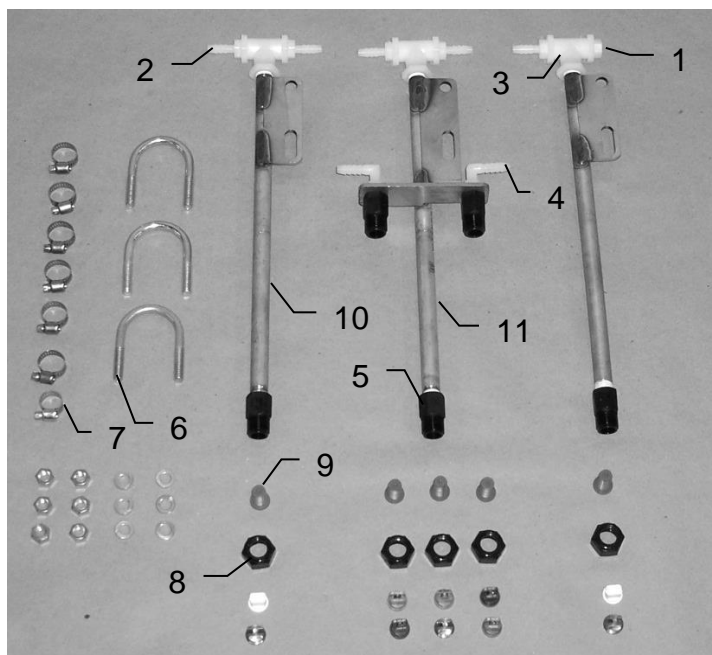

<u>Ref</u>	<u>Description</u>	<u>Part#</u>	<u>Qty</u>	<u>Description</u>	<u>Part#</u>	<u>Qty</u>
1	Plug	003-F14	1	Tip – Low – Silver	004-650033-SS	3
2	Straight fitting	003-A1414	5	Tip – Low – Green	004-XR110015VS	1
3	Tee	003-TT14	3	Tip – Low – Red	004-XR11004VS	1
4	Elbow	003-EL1414	2	Tip – High – White	004-650050-PT	2
5	Nozzle body	004-4721	5	Tip – High – Orange	004-XR11001VS	1
6	U bolt	001-4714UBS	3	Tip – High – Blue	004-XR11003VS	1
7	Hose clamp	003-9002	7	Tip – High – Grey	004-XR11006VS	1
8	Nozzle cap	004-4723	5			
9	Tip strainer with check	004-4213-200	5			
10	Nozzle tube	001-4714	2			
11	Nozzle tube auto	001-4714A	1			
12	Saddle leg	001-4703B	2			
13	Left mtg bracket	001-4703DL	1			
14	Right mtg bracket	001-4703DR	1			

Harvest Tec Model 4505B Installation Kit

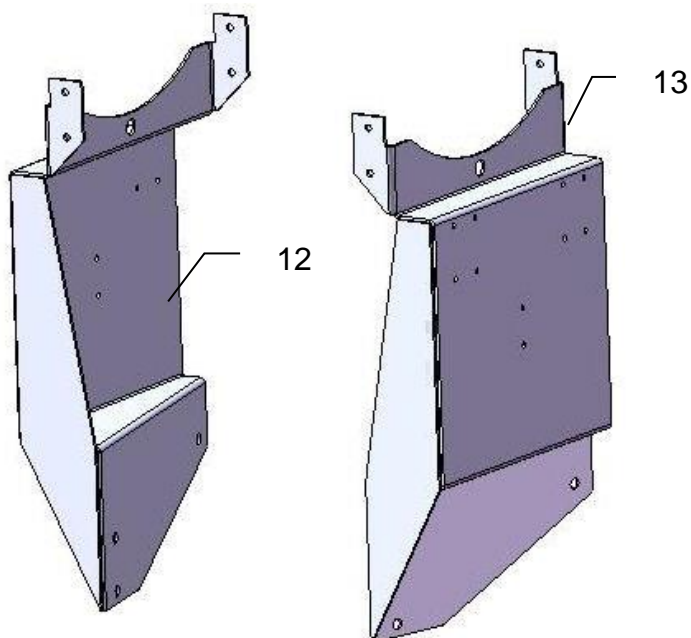
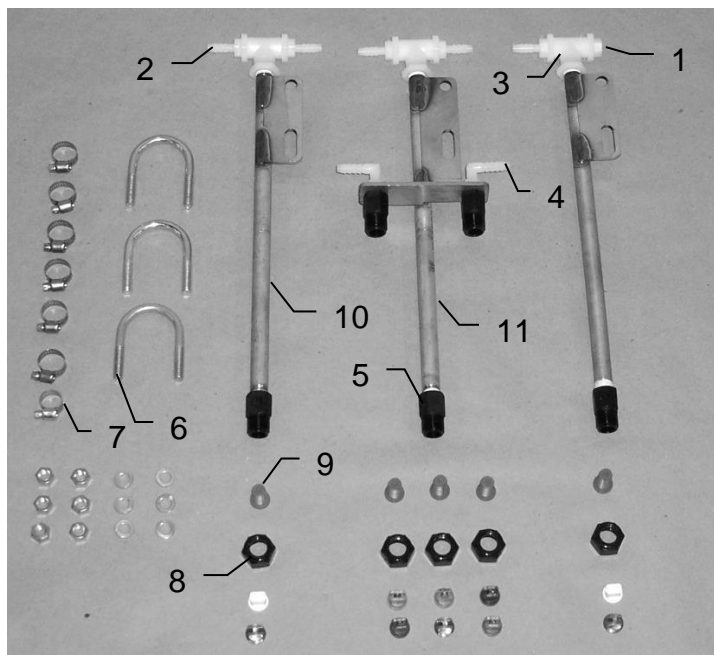

<u>Ref</u>	<u>Description</u>	<u>Part #</u>	<u>Qty</u>	<u>Description</u>	<u>Part #</u>	<u>Qty</u>
1	Plug	003-F14	1	Tip – Low – Silver	004-650033-SS	3
2	Straight fitting	003-A1414	5	Tip – Low – Green	004-XR110015VS	1
3	Tee	003-TT14	3	Tip – Low – Red	004-XR11004VS	1
4	Elbow	003-EL1414	2	Tip – High – White	004-650050-PT	2
5	Nozzle body	004-4721	5	Tip – High – Orange	004-XR11001VS	1
6	U bolt	001-4714UBS	3	Tip – High – Blue	004-XR11003VS	1
7	Hose clamp	003-9002	7	Tip – High – Grey	004-XR11006VS	1
8	Nozzle cap	004-4723	5			
9	Tip strainer with check	004-4213-200	5			
10	Nozzle tube	001-4714	2			
11	Nozzle tube auto	001-4714A	1			
12	Left saddle leg	001-4703FL	1			
13	Right saddle leg	001-4703FR	1			

Harvest Tec Model 4516B Installation Kit FOR JOHN DEERE 8 & 9 SERIES ROUND BALERS

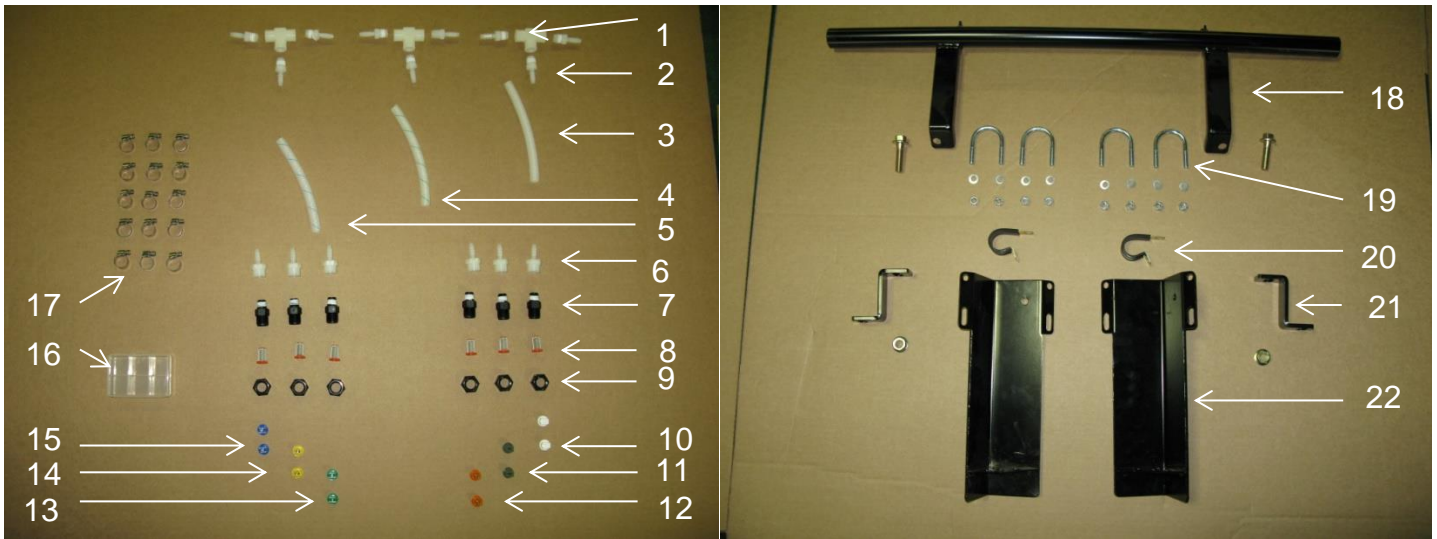

<u>Ref</u>	<u>Description</u>	<u>Part #</u>	<u>Qty</u>	<u>Ref</u>	<u>Description</u>	<u>Part #</u>	<u>Qty</u>
1	Tee	003-TT14SQ	3	13	Tip – High – Green	004-XR110015VS	2
2	Fitting	003-A1414	9	14	Tip – Low – Yellow	004-XR11002VS	2
3	Hose-White	002-9016	4 ft	15	Tip – High – Blue	004-XR11003VS	2
4	Hose-Green Stripe	002-9016G	4 ft	16	Mini Plano Box	008-9001	1
5	Hose-Blue Stripe	002-9016B	4 ft	17	Hose Clamps	003-9002	15
6	Fitting	003-A1414F	6	18	Nozzle Holder	001-4703R	1
7	Fitting	003-4722	6	19	5/16" U Bolt	001-4714UBS	4
8	Strainer	004-4213-200	6	20	Jiffy Clips	008-9009	2
9	Fitting	004-4723	6	21	Spacer	001-4703NS	2
10	Tip – Low- White	004-650050-PT	2	22	Nozzle Mount	001-4714J	2
11	Tip – Low - Olive	004-800067-PT	2	23	Mounting Bracket	001-4411	1
12	Tip – High - Orange	004-XR11001VS	2	24	Support	001-4411A	1

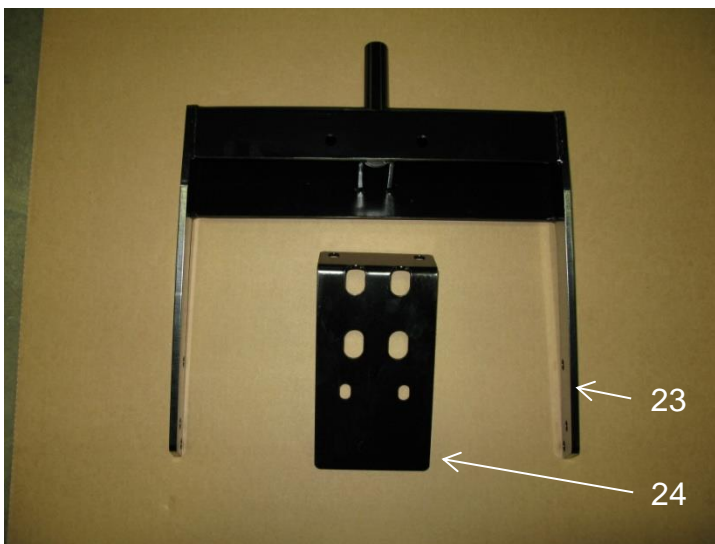

Harvest Tec Model 4517B Installation Kit FOR JOHN DEERE 8 & 9 SERIES ROUND BALERS

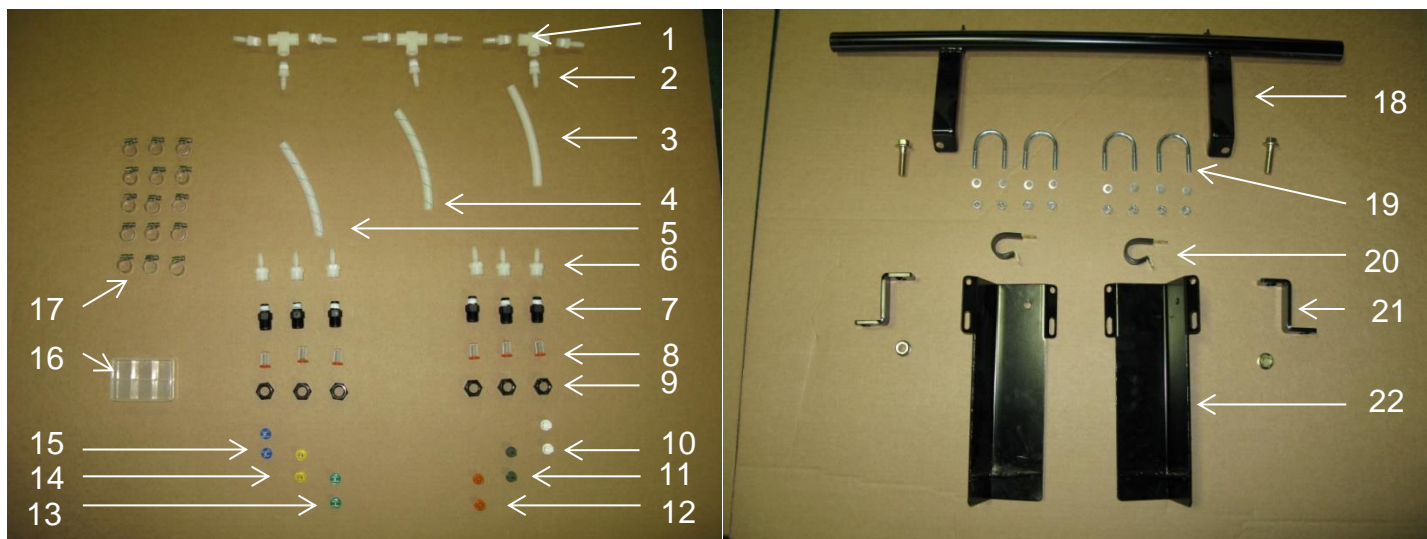

<u>Ref</u>	<u>Description</u>	<u>Part #</u>	<u>Qty</u>	<u>Ref</u>	<u>Description</u>	<u>Part #</u>	<u>Qty</u>
1	Tee	003-TT14SQ	3	13	Tip – High – Green	004-XR110015VS	2
2	Fitting	003-A1414	9	14	Tip – Low – Yellow	004-XR11002VS	2
3	Hose-White	002-9016	4 ft	15	Tip – High – Blue	004-XR11003VS	2
4	Hose-Green Stripe	002-9016G	4 ft	16	Mini Plano Box	008-9001	1
5	Hose-Blue Stripe	002-9016B	4 ft	17	Hose Clamps	003-9002	15
6	Fitting	003-A1414F	6	18	Nozzle Holder	001-4703R	1
7	Fitting	003-4722	6	19	5/16" U Bolt	001-4714UBS	4
8	Strainer	004-4213-200	6	20	Jiffy Clips	008-9009	2
9	Fitting	004-4723	6	21	Spacer	001-4703NS	2
10	Tip – Low – White	004-650050-PT	2	22	Nozzle Mount	001-4714J	2
11	Tip – Low – Olive	004-800067-PT	2	23	Saddle Leg	001-4703B	2
12	Tip – High – Orange	004-XR11001VS	2	24	Right Mtg Bracket	001-4703DR	1
				25	Left Mtg Bracket	001-4703DL	1

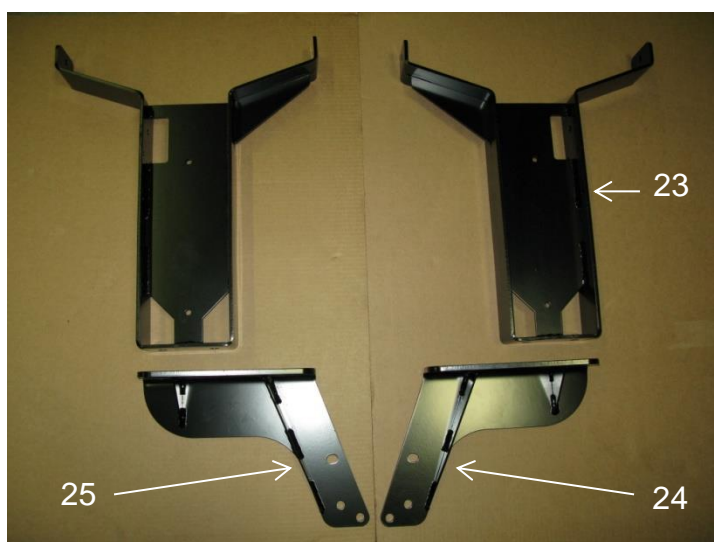

Harvest Tec Model 4523B Installation Kit

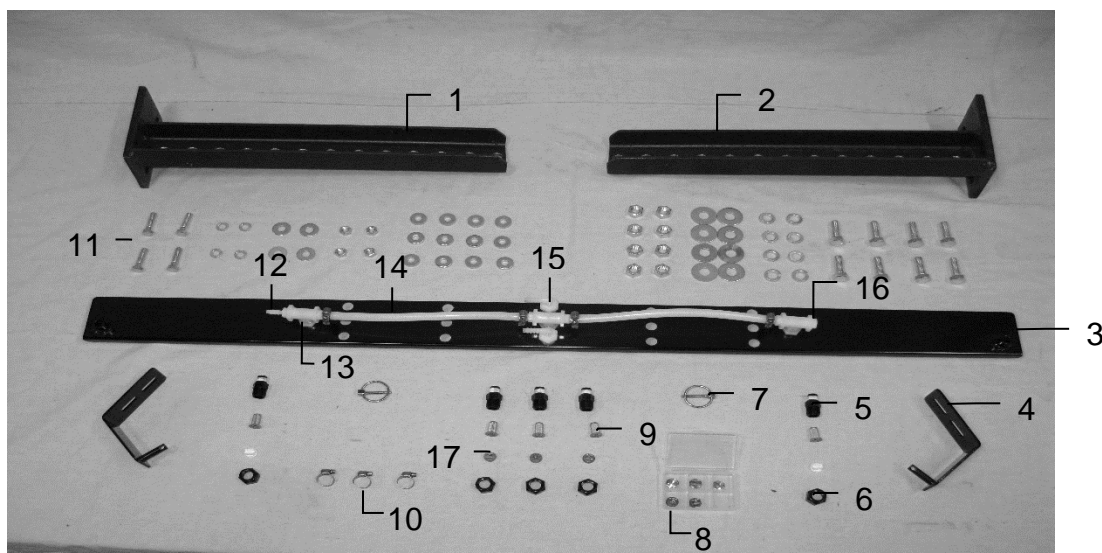

<u>Ref</u>	<u>Description</u>	<u>Part#</u>	<u>Qty</u>	<u>Ref</u>	<u>Description</u>	<u>Part#</u>	<u>Qty</u>
1	Left Support Leg	001-4704JL	1	15	1/4" Elbow FPT	003-EL1414F	2
2	Right Support Leg	001-4704JR	1	16	Hex Plug	003-F14	1
3	Spray Shield	001-4704G	1				
4	Lynch Pin	001-4704H	2	17	Tips		
5	Nozzle Body	004-4722	5		Low – Silver	004-650033-SS	3
6	Nozzle Cap	004-4723	5		Low – Green	004-XR11015VS	1
7	Lynch Pin	008-4576	2		Low – Red	004-XR11004VS	1
8	Plano Box	008-9001	1		High – White	004-650050-PT	2
9	Strainer w/Check	004-4213-200	5		High – Orange	004-XR11001VS	1
10	Hose Clamp	003-9002	7		High – Blue	004-XR11003VS	1
11	Hardware				High – Grey	004-XR11006VS	1
12	Straight Fitting	003-A1414	5				
13	Tee	003-TT14	3				
14	1/4" Hose	002-9016	2 ft				

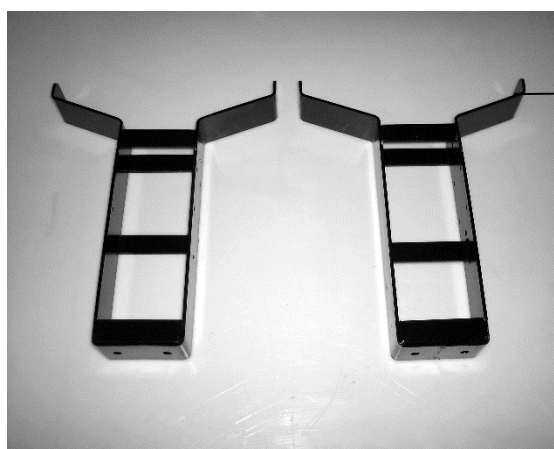

Tank Mounting Legs
001-4703B (x2)

Harvest Tec Model 4524B Installation Kit

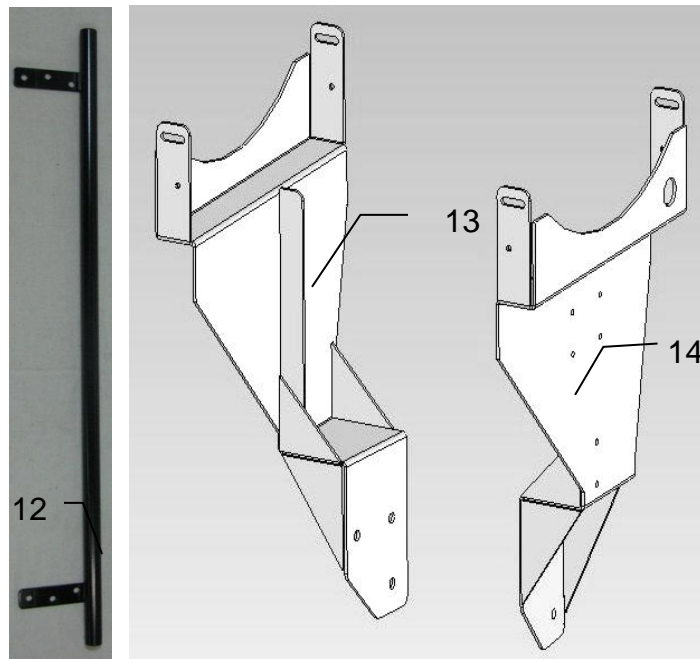
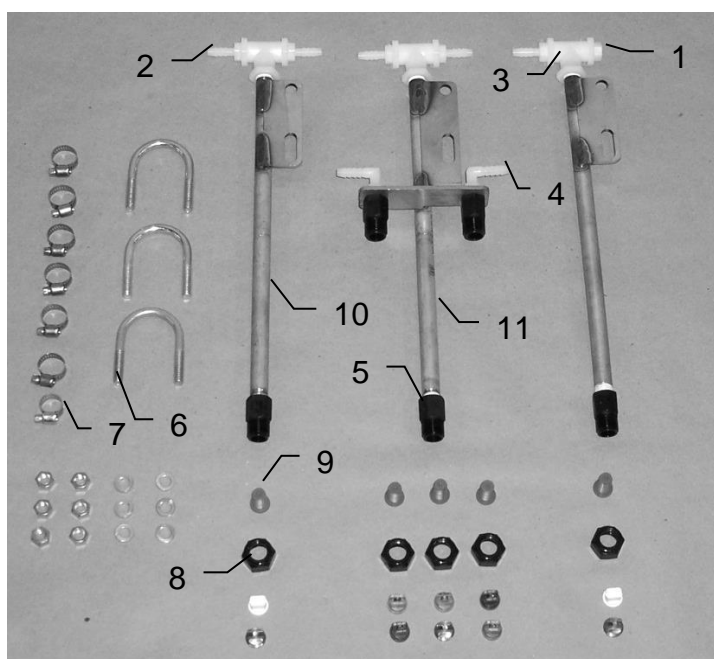

<u>Ref</u>	<u>Description</u>	<u>Part#</u>	<u>Qty</u>	<u>Description</u>	<u>Part#</u>	<u>Qty</u>
1	Plug	003-F14	1	Tip – Low – Silver	004-650033-SS	3
2	Straight fitting	003-A1414	5	Tip – Low – Green	004-XR110015VS	1
3	Tee	003-TT14	3	Tip – Low – Red	004-XR11004VS	1
4	Elbow	003-EL1414	2	Tip – High – White	004-650050-PT	2
5	Nozzle body	004-4721	5	Tip – High – Orange	004-XR11001VS	1
6	U bolt	001-4714UBS	3	Tip – High – Blue	004-XR11003VS	1
7	Hose clamp	003-9002	7	Tip – High – Grey	004-XR11006VS	1
8	Nozzle cap	004-4723	5			
9	Tip strainer with check	004-4213-200	5			
10	Nozzle tube	001-4714	2			
11	Nozzle tube auto	001-4714A	1			
12	Nozzle holder	001-4703T	1			
13	Left leg	001-4703L	1			
14	Right leg	001-4703K	1			

Harvest Tec Model 4526B Installation Kit

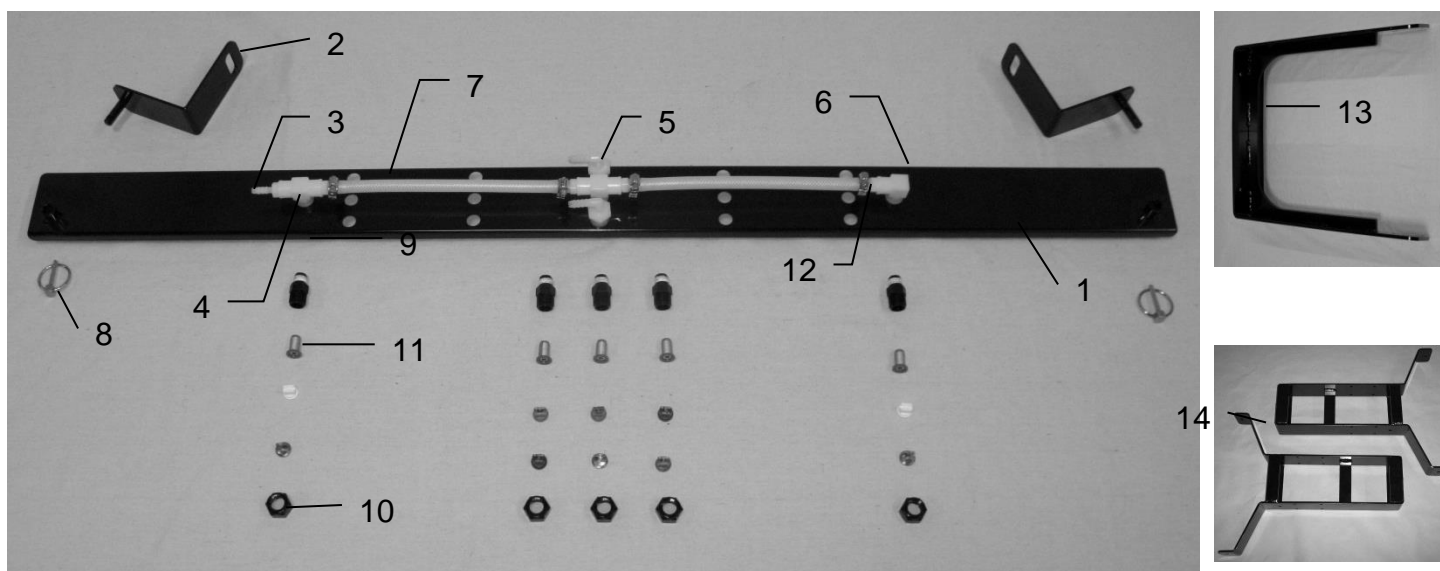

<u>Ref #</u>	<u>Description</u>	<u>Part #</u>	<u>Qty</u>	<u>Description</u>	<u>Part #</u>	<u>Qty</u>
1	Spray shield	001-4704G	1	Tip – Low – Silver	004-650033-SS	3
2	Shield hangers	001-4704MC	2	Tip – Low – Green	004-XR110015VS	1
3	Straight fitting	003-A1414	5	Tip – Low – Red	004-XR11004VS	1
4	Tee	003-TT14	3	Tip – High – White	004-650050-PT	2
5	Elbow	003-EL1414F	2	Tip – High – Orange	004-XR11001VS	1
6	Plug	003-F14	1	Tip – High – Blue	004-XR11003VS	1
7	Hose	002-9016	2	Tip – High – Grey	004-XR11006VS	1
8	Lynch pin	008-4576	2			
9	Nozzle body	004-4722	5			
10	Nozzle cap	004-4723	5			
11	Strainer	004-4213-200	5			
12	Hose clamps	003-9002	7			
13	Mounting bracket	001-4704MA	1			
14	Saddle legs	003-4703B	2			

Selecting Tips-Reference Guide

The applicator is sent from the factory with High output tips installed. The tips used are determined by how many ton per hour you are baling. You can see this on either the automatic or manual screen.

1 – 7 Tons of hay per hour

- Too low for system to apply at. Increase baling speed or rake more hay together. System will show over application when at these tonnages.

8 – 27 Tons of hay per hour (32 – 440 lbs of hay preservative per hour)

- Use low output tips
 - For most balers
 - Pump 1 = Qty 3 - (650033-SS) Silver
 - Pump 2 = Qty 1 - (XR110015VS) Green
 - Pump 3 = Qty 1 - (XR11004VS) Red
 - For John Deere 8 and 9 Series balers (2013 and newer)
 - Pump 1 = Qty 2 – (650050-PT) White
 - Pump 2 = Qty 2 – (800067-PT) Olive
 - Pump 3 = Qty 2 – (XR11002VS) Yellow

21 – 40 Tons of hay per hour (84 – 632 lbs or hay preservative per hour)

- Use high output tips
 - For most balers
 - Pump 1 = Qty 2 - (650050-PT) White and Qty 1 (XR11001VS) Orange in the center
 - Pump 2 = Qty 1 - (XR11003VS) Blue
 - Pump 3 = Qty 1 - (XR11006VS) Gray
 - For John Deere 8 and 9 Series balers (2013 and newer)
 - Pump 1 = Qty 2 – (XR11001VS) Orange
 - Pump 2 = Qty 2 – (XR110015VS) Green
 - Pump 3 = Qty 2 – (XR11003VS) Blue

Harvest Tec, LLC. Warranty and Liability Agreement.

Harvest Tec, LLC. will repair or replace components that are found to be defective within 12 months from the date of manufacture. Under no circumstances does this warranty cover any components which in the opinion of Harvest Tec, LLC. have been subjected to negligent use, misuse, alteration, accident, or if repairs have been made with parts other than those manufactured and obtainable from Harvest Tec, LLC.

Our obligation under this warranty is limited to repairing or replacing free of charge to the original purchaser any part that in our judgment shows evidence of defective or improper workmanship, provided the part is returned to Harvest Tec, LLC. within 30 days of the failure. Parts must be returned through the selling dealer and distributor, transportation charges prepaid.

This warranty shall not be interpreted to render Harvest Tec, LLC. liable for injury or damages of any kind, direct, consequential, or contingent, to persons or property. Furthermore, this warranty does not extend to loss of crop, losses caused by delays or any expense prospective profits or for any other reason. Harvest Tec, LLC. shall not be liable for any recovery greater in amount than the cost or repair of defects in workmanship.

There are no warranties, either expressed or implied, of merchantability or fitness for particular purpose intended or fitness for any other reason.

This warranty cannot guarantee that existing conditions beyond the control of Harvest Tec, LLC. will not affect our ability to obtain materials or manufacture necessary replacement parts.

Harvest Tec, LLC. reserves the right to make design changes, improve design, or change specifications, at any time without any contingent obligation to purchasers of machines and parts previously sold.

Note: The warranty registration card supplied with the installation manual must be filled out and returned to the manufacturer within fifteen days of purchase. Without record of receipt of warranty registration at the manufacturer, the warranty is not valid.

Revised 5/22

HARVEST TEC, LLC.
P.O. BOX 63
2821 HARVEY STREET
HUDSON, WI 54016 USA
PHONE: 715-386-9100
FAX: 715-381-1792
Email: info@harvesttec.com