

Installation Manual

Model 596BB

***115 Gallon Preservative Applicator
For New Holland BigBaler and Case IH LB 4***



*Equipment and Products
for Quality Hay.™*

P.O. Box 63 • 2821 Harvey Street • Hudson, WI 54016
800-635-7468 • www.harvesttec.com

Harvest Tec Model 596 Installation Table of Contents

	<u>Page number</u>
Installation kit reference chart	3
Tools needed	3
Installation of applicator	4-16
1. Removal of tank straps and tank	4
2. installation of saddle legs and saddle	5
3. Installation of pump manifold and handrail	6
4. Installation of Precision Information Processor (PIP)	7
5. Installation of star wheel moisture sensors	8
6. Installation of end of bale sensor	9
7. Installation of the drain fill line	10
8. Installation of the spray shield	11
High and low output tips description	11
For standard and packer cut balers	12
For roto-cut balers	13
9. Plumbing	14
10. Installation of star wheel and bale rate harness	15
11. Installation of controls	15
12. Installation of display cable harness	15
13. Main wiring harness and power cord installation	15
Wiring installation	16
Wiring diagrams	17-18
Parts breakdown	19-24
Tank, Saddle, & Saddle legs	19
Pump manifold	20
Star wheels	21
Control boxes and wiring harnesses	22
Hose and drain fill line	23
4533B Installation Kit	24
4534B Installation Kit	25
4535B Installation Kit	26
4536B Installation Kit	27
Notes	28
Warranty statement	Back Page

Introduction

Please read this manual carefully to ensure correct steps are taken to attach the applicator to the baler. This applicator is designed to apply Harvest Tec buffered propionic acid. The model 596 base kit includes the following parts: Tank, Frame, Pumps, Hose, Baler Mounted Processor, Touchscreen Display, Moisture Sensors, and Miscellaneous Hardware. The applicator is designed for New Holland BB 330-340 & Case IH LB 334-434 balers. Before installing the unit on the baler, make sure you have the proper installation kit. (See the chart below.) If you are unsure about your installation kit, contact your local authorized dealer for specifications. For your convenience we have included a parts break down for the model 596 applicator.

Left and Right sides are determined by facing in the direction of forward travel.

Installation kit reference chart

BALER MAKE	MODEL	INSTALL KIT
Case IH	LB 334 Standard or Packer	030-4533B
	LB 334 Roto Cut	030-4535B
	LB 434 Standard or Packer	030-4534B
	LB 434 Roto Cut	030-4536B
New Holland	BB 330 Standard or Packer	030-4533B
	BB 330 Roto Cut	030-4535B
	BB 340 Standard or Packer	030-4534B
	BB 340 Roto Cut	030-4536B

Tools Needed:

- Standard wrench set
- Electric drill and bits
- Side cutter
- Crescent wrench
- Standard screwdriver
- Standard nut driver set
- Standard socket set
- Hammer
- Metal cutting tools
- Hose cutter
- Center punch

Installation of applicator

1. Removal of tank straps and tank

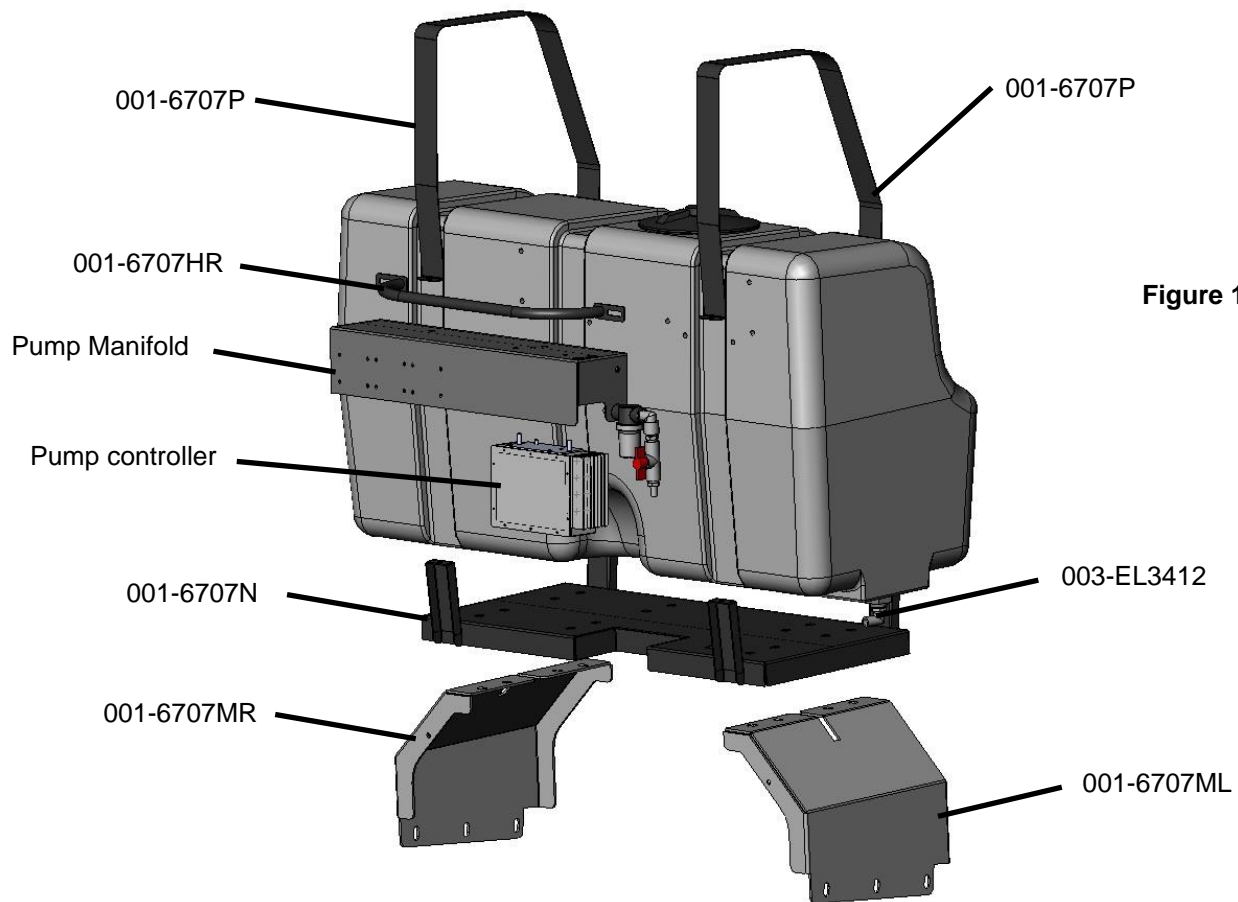

Figure 1

1. Remove the two tank straps (001-6707P) by removing all eight 3/8" hex nuts. Figure 1
2. Lift the tank (005-9218) away from the saddle (001-6707N) and place the tank on a smooth flat surface.
3. Install the pump supply elbow (003-EL3412) on the bottom of the tank. Figure 1
4. Install the drain/fill elbow (003-EL3434) on the side of the tank below the sight gauge.

2. Installation of saddle legs and saddle

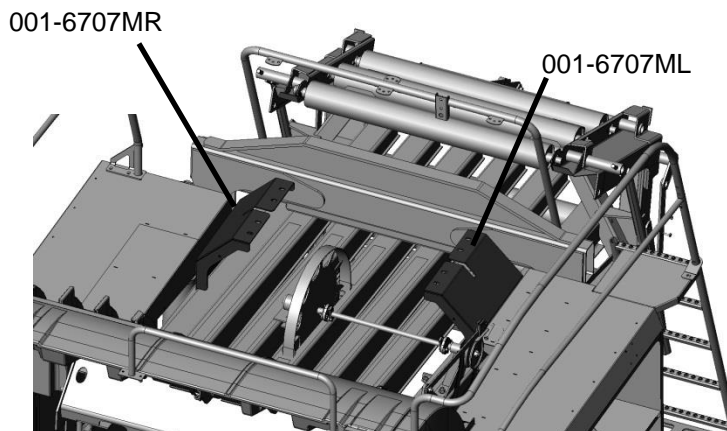

Figure 2

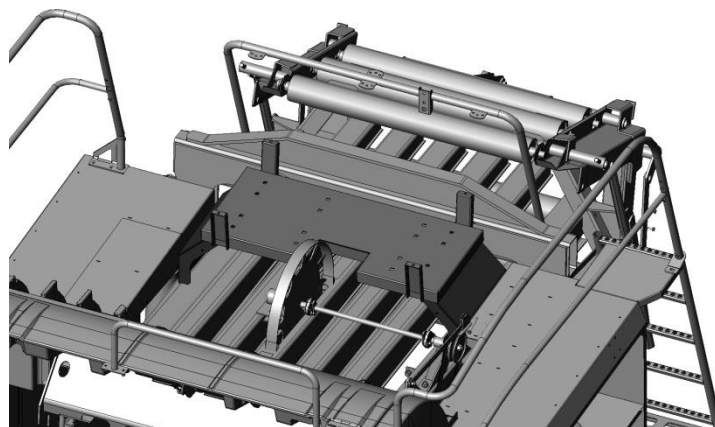

Figure 3

1. Install the two saddle legs (001-6707MR & 001-6707ML) on to the top of the baler chute as shown. Figure 2
2. Secure the two legs with six (three per side) 1/2" x 1-3/4" carriage bolts, flats washers, locks washers, and hex nuts. The six holes will be already punched out of the baler frame and will line up with the saddle legs. Make sure the bolt head is in the chamber.
3. Install the tank saddle (001-6707N) on top of the saddle legs. Figure 3
4. Secure the tank saddle to the saddle legs using eight (four per side) 1/2" x 1-3/4" carriage bolts, flat washers, lock washers, and hex nuts. Use the outside set of holes for four foot wide balers and the inside set of holes for three foot wide balers. Figure 3
5. Make sure the carriage bolt heads are on top of the saddle and the bolt points towards the bale chamber.
6. Install the tank and secure with the straps and hardware removed from before. The tank straps will need to be secured with a double nut.

3. Installation of pump manifold and hand rail

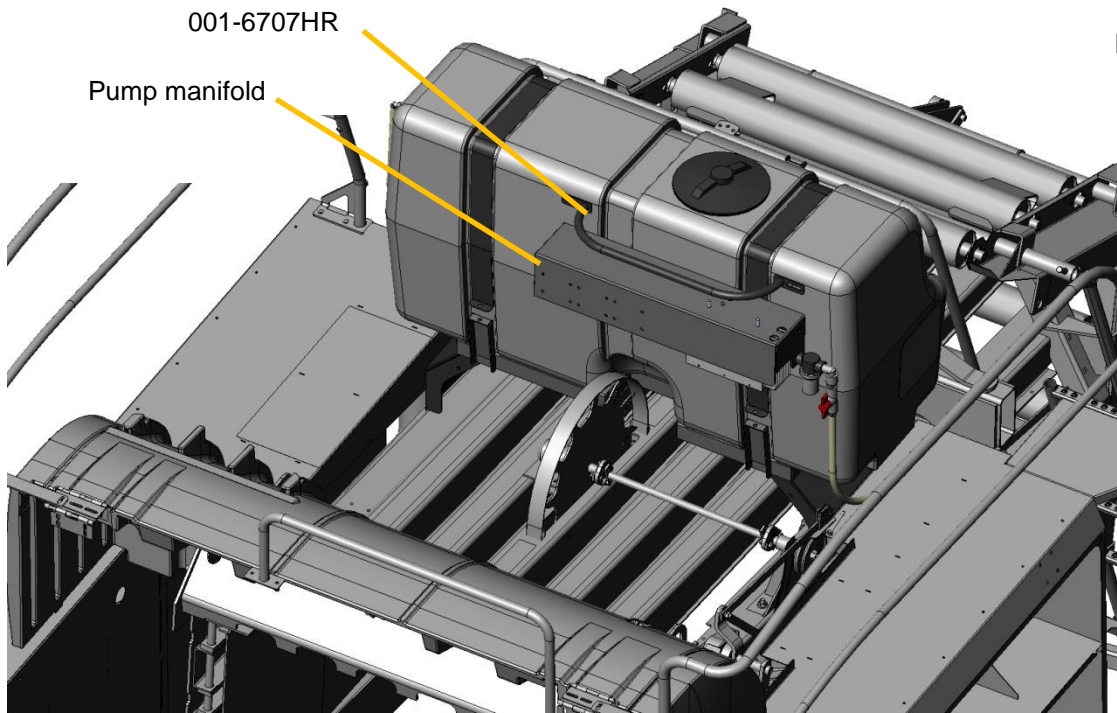

Figure 4

1. Locate and attach the filter bowl assembly to the outside of the pump manifold. Remove the four flange bolts that connect the two parts of the pump manifold together. Figure 4
2. Connect the pump manifold mounting bracket to the tank and secure with six 3/8" x 3/4" flange bolts. Reinstall the other half of the pump manifold and secure with four 3/8" x 3/4" flange bolts. Figure 4
3. Install the handrail (001-6707HR) above the pump manifold using two 3/8" x 3/4" flange bolts. Figure 4
4. Install the Pump Controller (006-5672) in to the pump manifold. Secure using two 5/16" lock washers, flat washers and hex nuts. Figure 1
5. Locate the 1/2" hose and connect the filter bowl assembly to the tank fitting using the supplied two hose clamps. Figure 4

The Pump Controller and pump heads must be pointing down. Failure to mount the pump plate assembly in this specified direction will void all warranty of the Pump Controller and pumps

4. Installation of Precision Information Processor (PIP)

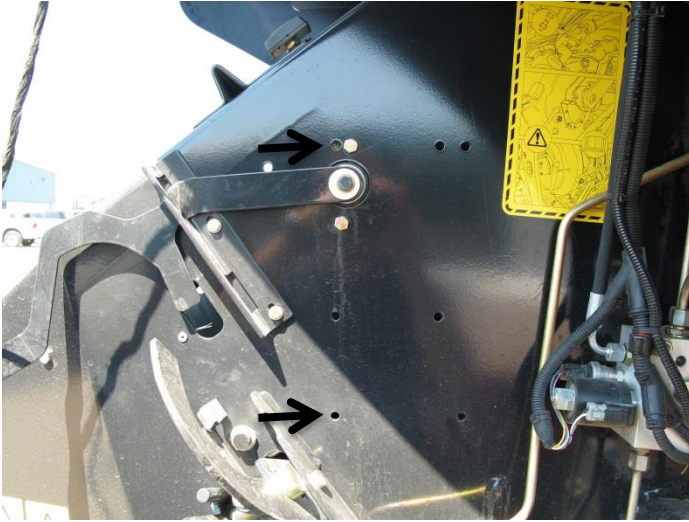

Figure 5

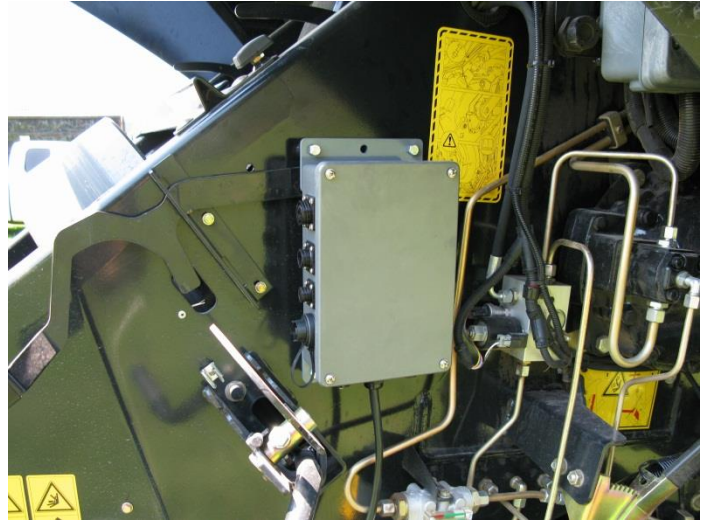

Figure 6

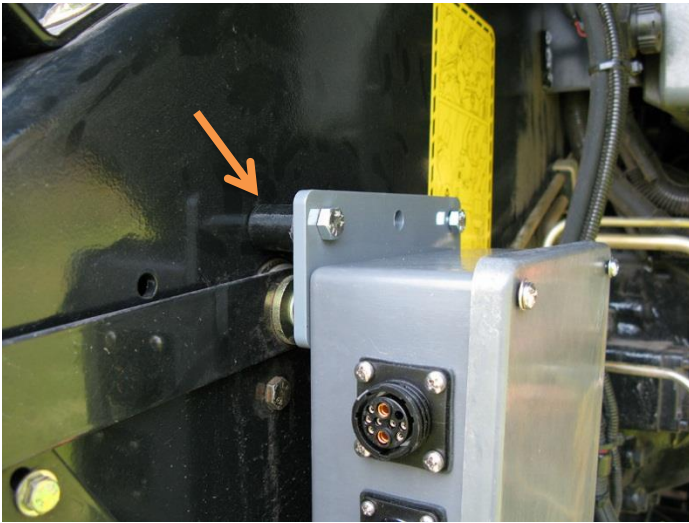

Figure 7

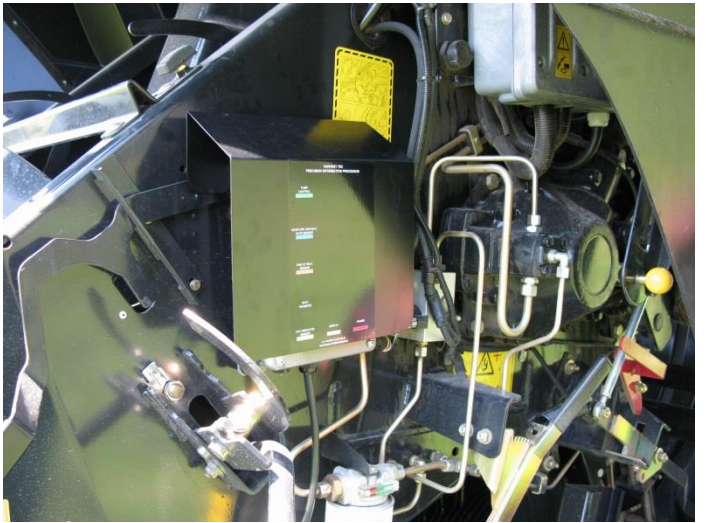

Figure 8

1. Locate the Precision Information Processor (006-5671LS2).
2. Lock the balers flywheel brake and lift open the front hood.
3. Locate the four holes by the fly wheel brake. Figure 5
4. Mount the PIP with the display cable pointed down to the baler. Figure 6
5. Use four 5/16" x 3" hex bolts with four lock washers, four flat washers (on between the hex bolt and PIP), four fender washers (between the PIP and standoffs) and hex nuts to mount the PIP to the baler. A 1-1/8" standoff will go between the PIP and baler to allow the movement of the hood latch. Figure 7
6. Before tightening hardware install the PIP shield (001-5650X) over the top two 5/16" bolts. Figure 8

5. Installation of star wheel moisture sensors

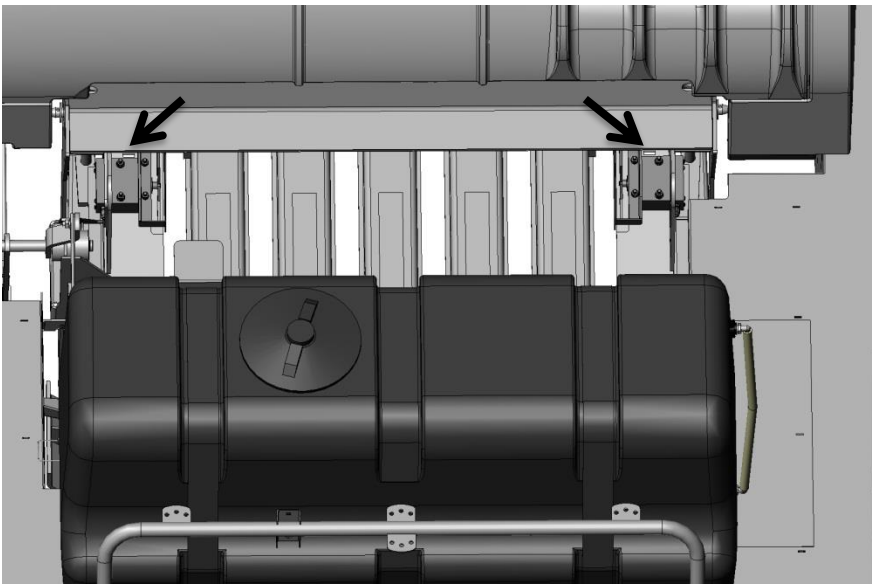

Figure 8

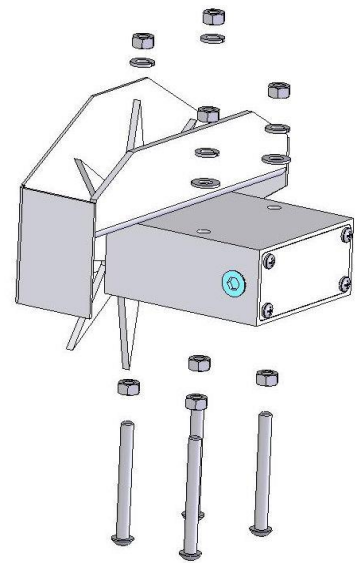
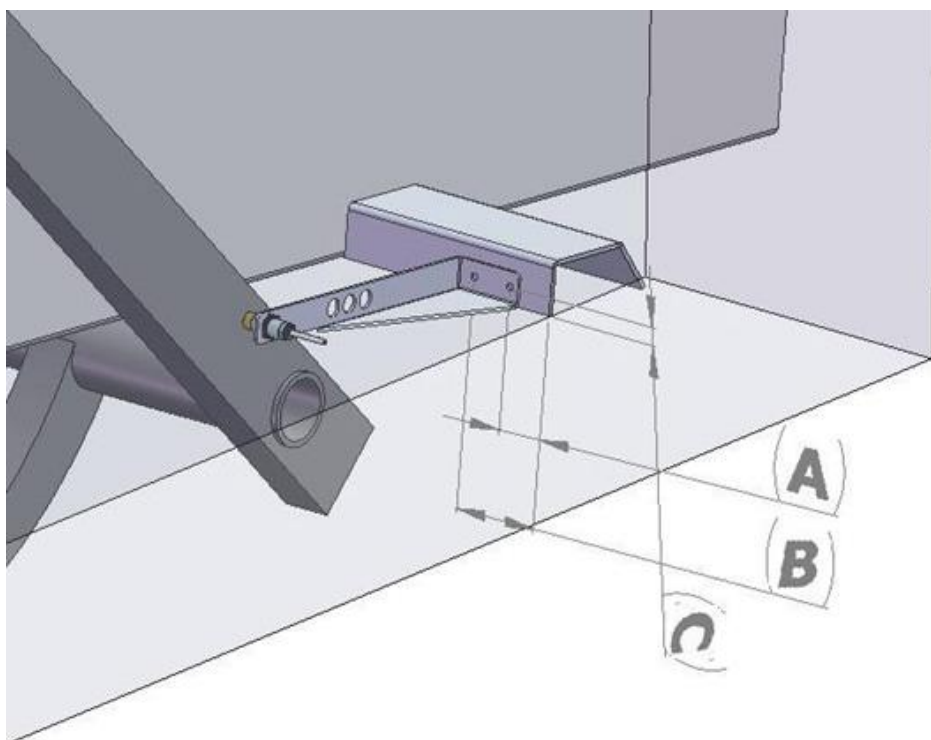

Figure 9

1. Locate the two star wheel moisture sensors (030-4641) and twine diverters (001-4644 & 001-4645)
2. Directly behind the knotters, locate the four predrilled holes per side shown at the arrows. This location is also beneath the lift points on top of the baler. Figure 8
3. Install the eight (four per side) 5/16" x 3" Allen head cap screws. Make sure the Allen heads are in the bale chamber. Secure using eight 5/16" hex nuts. Figure 9
4. Install the star wheels below the lift points on the baler. Figure 8 & 9
5. Install the twine diverters over the star wheel sensor. The twine diverter with two extra sensors will be installed on the right star wheel.
6. Secure the star wheels and twine diverters with four 5/16" hex nuts, lock washers, and two flat washers. Figure 9

6. Installation of end of bale sensor

The end of bale sensor determines the position of the needles on the baler. When the needles cycle, the sensor communicates this information to the Precision Information Processor. This information is used for job records and will be used by the optional Bale Identification system.



Sensor hole location	A	B	C
12"	2-7/9"	4-3/8"	5/8"

Mount the end of bale sensor bracket (001-4648) as shown on the ladder side of the baler. Mark and drill two 3/8" holes and attach the bracket using two 5/16" x 1" self-tapping screws, and 5/16" flange nuts. Mount the sensor in the 12" hole location, keep the sensor 1/4" from the needle and tighten both nuts. Run the sensor cable (006-7400) and extension (006-7400BBEXT) up to the Precision Information Processor down the ladder side of the baler and secure it properly out of the way of any moving parts and hydraulics.

7. Installation of the drain fill line

1. Thread 3/4" elbow fitting into end of tank.
2. Run hose from the elbow down the frame to the bottom of the baler.
3. Drill 1/4" holes to accept the valve holder bracket and use 5/16" x 1" self-tapping screws.
4. Connect valve assembly to other end of hose. Place hose clamps on both ends.
5. Secure hose to frame using cable locks.

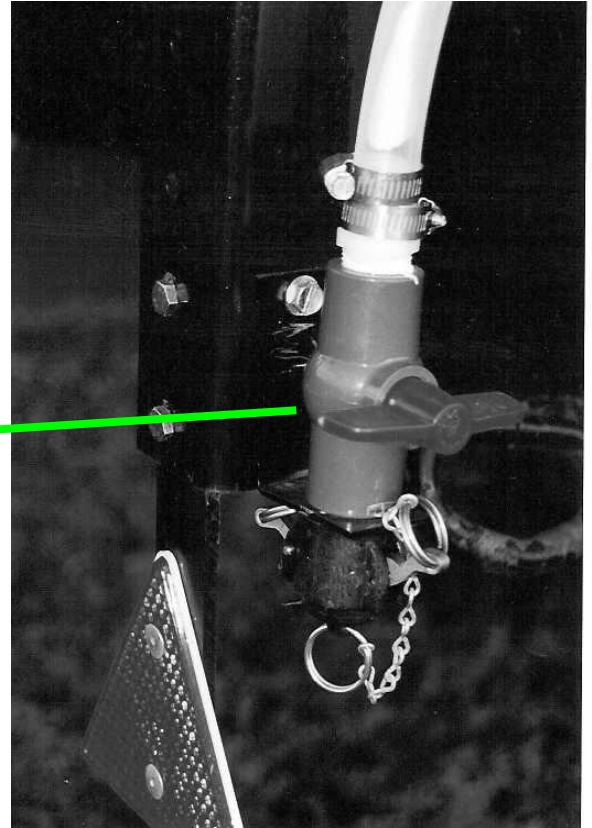

8. INSTALLATION OF THE SPRAY SHIELD

The spray shield assembly is designed to spray the hay evenly as the baler picks it up. A sketch of the spray shield nozzle holder is shown below.

For Standard and Packer models the 4533B and 4534B

High Output Tips for Rates Requiring 84-632 lbs/hr. (Approximately 21-63 tons/hr)

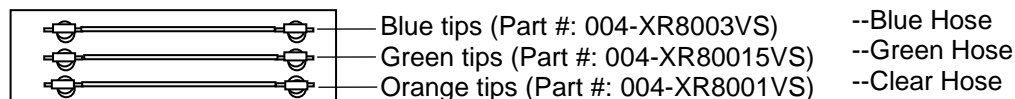

Low Output Tips for Rates Requiring 44-400 lbs/hr. (Approximately 11-40 tons/hr)

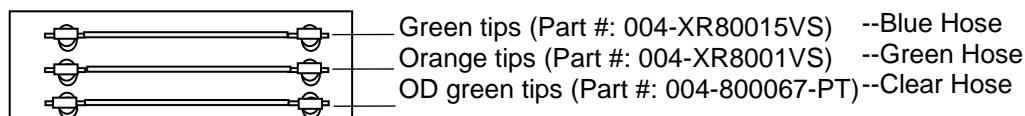

For Roto-Cut models the 4535B and 4536B

High Output Tips for Rates Requiring 84-632 lbs/hr. (Approximately 21-63 tons/hr)

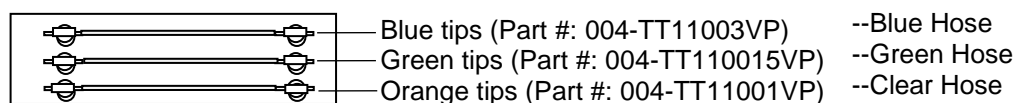

Low Output Tips for Rates Requiring 44-400 lbs/hr. (Approximately 11-40 tons/hr)

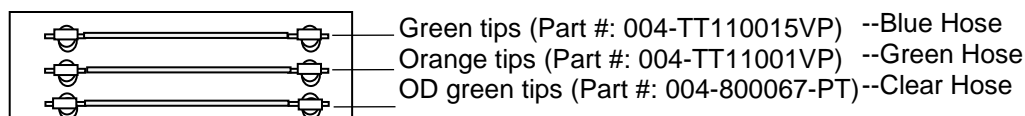

Spray shield showing nozzle placement and tubing.

Installation kit 4533B & 4534B

For all Standard and Packer Cut balers

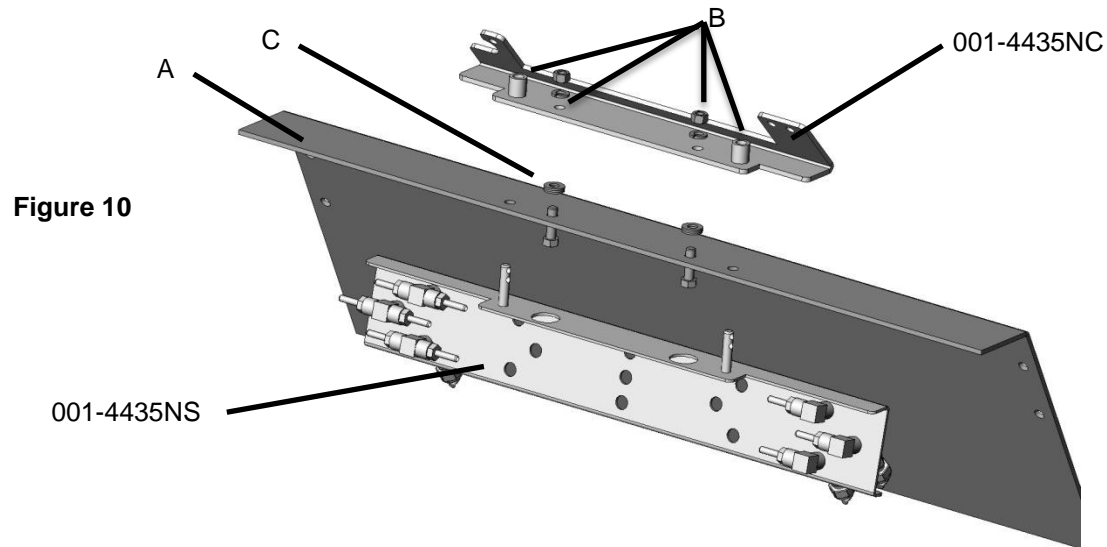

1. Locate the flat steel directly above the stuffer forks. Figure 10, Point A
2. Align the spray shield holder (001-4435NC) to the center of the flat steel.
3. Clamp the holder to the baler and mark four 7/16" holes to be drilled. Figure 10, Point B
4. Attach the shield holder (001-4435NC) to the baler using two 3/8" x 1-1/4" hex bolts, six flat washers, two lock washers, and two hex nuts. The six washers (three per side) will be between the baler and the spray shield holder. Figure 10, Point C.
5. Install the spray shield (001-4435NS) to the holder and secure by using two lynch pins. Remove washers if necessary (Point C), but allow for a tight fit.

Installation kit 4535B & 4536B

For all Roto-Cut balers

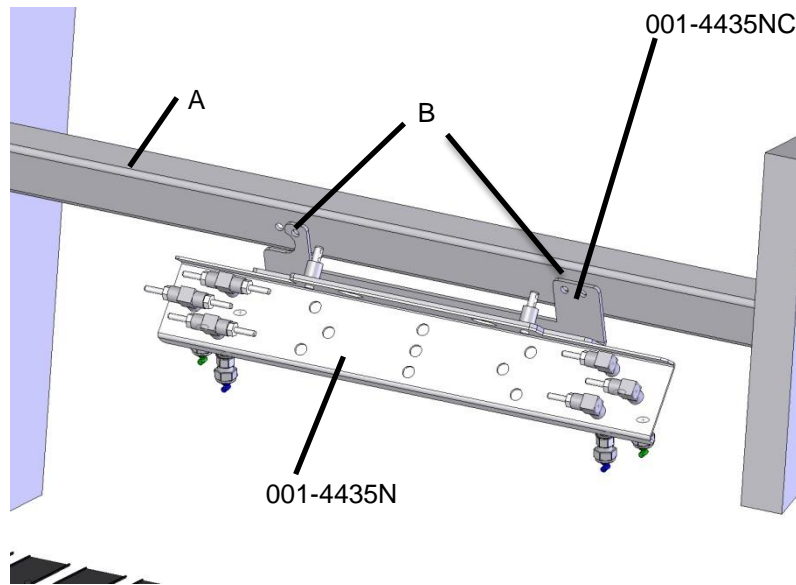

Figure 11

1. Locate the baler cross member directly above the rotor. Figure 11, Point A
2. Locate the four pre-drilled holes on the cross member. Figure 11, Point B
3. Install the spray shield holder (001-4435NC) to baler using three 5/16" x 1" bolts, lock washers, and hex nuts.
4. Install the spray shield (001-4435N) to the the shield holder (001-4435NC) and secure with supplied lynch pins.

9. Plumbing

- A. Locate the three ¼” hoses colored clear, blue, and green. The pumps will need to be connected to specific tips so the pump numbers are as follows: Pump 1 is closest to the filter bowl, pump 2 is in the middle, and pump 3 is the outside pump.
- B. Slide the jaco nut over the end the hose and insert the hose into the jaco fitting and tighten the jaco nut. Because all nozzles on the spray shield are different, the operator will need to install pump 1 to the orange tips using the clear hose, pump 2 to the green tips using the green hose and pump 3 to the blue tips using the blue hose.
- C. **KEEP HOSE AWAY FROM: MOVING PARTS, SHARP METAL, AND HYDRAULIC LINES. WORKING TEMPERATURE FOR THE HOSE IS 140 °F AND UNDER.**
- D. Tie the hose down at secure locations on the baler using the enclosed tie straps and cable clamps.

High and Low Output Tips

Your baler comes with two sets of tips: a low set and a high set. The high set comes factory installed.

-The high set will cover outputs of 84 to 632 lbs/hr (Apprx. 21-63 tons/hr) Install the following tips for high output:

- Clear hose to orange tips
- Green hose to green tips.
- Blue hose to blue tips.

-The low set will cover outputs of 44 to 400 lbs/hr (Apprx. 11-40 tons/hr) Install the following tips for low output:

- Clear hose olive tips.
- Green hose to orange tips.
- Blue hose to green tips.

****Refer to Tip Output under APPLICATION RATE in the Operations Manual for further information.****

10. Installation of star wheel and bale rate harness

First, remove the cover from the star wheel block and use a ¼" nut driver to remove the nut from the electronic swivel. Next, run the star wheel sensor wire through the black grommet and place the eye terminal on the star wheel sensor. Tighten the eye loop with the nut on the sensor and put the star wheel cover back on the base. Next, tighten the grommet to form a tight seal around the wire. The bale rate sensors will be factory installed on the right side twine guard in the correct position. The sensor with the longer sensor wire should say "FRONT", which indicates it should be placed in the front sensor hole. The sensor wire with the shorter wire should say "BACK." The tip of the sensor should be placed no more than ¼" away from the star wheel teeth and no less than 1/8" from the star wheel teeth. Each sensor will have an LED light located on the sensor by the diverter. Once the unit is powered up spin the wheel and make sure that both led lights turn on and off. If they don't turn on and off, adjustments may need to be made.

Once the star wheel connection is complete, run the harness along the left side baler frame to the Precision Information Processor (PIP). The Precision Information Processor is located on the next to the flywheel brake.

11. Installation of controls

Use the supplied suction cup mount to position the monitor in the cab. Make sure the glass is clean before installing the suction cup mount. If a non-cabbed tractor is used, use the supplied #10 screws for installation on the fender. If unit is mounted on fender it will need to be removed at night and stored in a clean, dry area. Use the Ram mount swivel-positioning nut to tighten the entire assembly. Adjust it so that you can view the entire screen and be able to use the touch screen without interfering with other tractor functions.

12. Installation of display cable harness

On the bottom of the touch screen display you will find the main display wire plug. The harness (006-5650TM) will need to be attached to this plug and run through the cab towards the hitch where it will connect with its matching harness (006-5650LSM) from the PIP

13. Main wiring harness and power cord installation

The power harness (006-5650TM) will need to be connected to the battery. This harness will then be routed towards the hitch to connect with its matching harness (006-5650LSM) from the PIP.

WIRING INSTALLATION

1. Locate the power harness.
2. Connect the tractor communication & power harness (006-5650TM) to the battery (12 volt) using the red wire with fuse to the positive side and the black wire to the negative.
 - a. **The power harness must be connected to the battery!** The unit will draw more amps than convenience outlets can handle. Any modifications of the power harness will void systems warranty. IF MODIFICATIONS ARE REQUIRED CONTACT HARVEST TEC FIRST!
 - b. **This unit will not function on positive ground tractors.**
 - c. **If the unit loses power while operating it will not keep track of accumulated pounds of product used and individual bale records.**
3. Connect the tractor communication & power harness (006-5650TM) amp connector to the bottom of the 565 terminal, and connect the keyed power harness to a keyed power source.
4. Connect the baler power and communication harness (006-5650LSM) to the power port on the PIP and to the display port on the PIP. Run this harness through the balers grommet next to the PIP and route towards the hitch.
5. Connect flow meter (006-4725A) and pump harness (006-4660Z) to the Pump Controller.
6. Connect the Pump Controller harness (006-5650F3M) to the PIP and Pump Controller. This harness will run down the left side of the baler.
7. Install one terminating resistor to the pump controller (006-5650Z).
8. If you have the optional Hay Indicator kit (006-7502H), connect it to the PIP.
9. Attach moisture and bale rate harness (006-7303HL) to the PIP. This harness will travel down the left side of the baler to the PIP.
10. Attach the End of bale sensor (006-7400) to the harness extension (006-7400BBEXT). Connect the extension to the PIP. This harness will run up and along the ladder side of the baler.
11. Install the Pump Controller in pump plate using 5/16" lock, nut and flat washers.

SYSTEM WIRING DIAGRAM

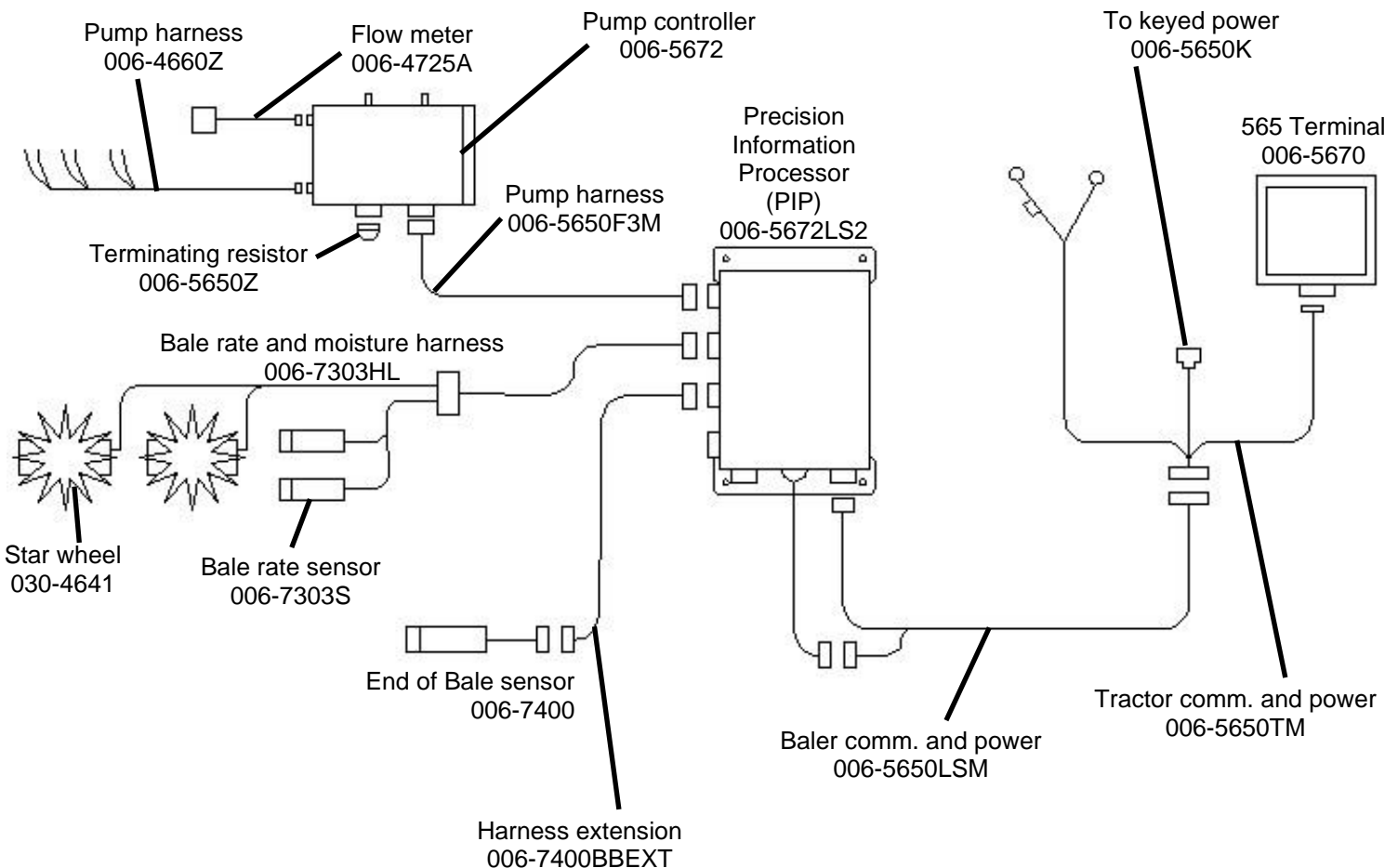

Wiring diagrams

A. Communication and power harness

Pin 1	Red	Can 12 volt
Pin 2	Red	Battery 12 volt
Pin 3	Orange	Keyed power
Pin 4	Not Used	
Pin 5	Yellow	Comm channel OL
Pin 6	Green	Comm channel OH
Pin 7	Not used	
Pin 8	Black	Can ground
Pin 9	Black	Battery ground
Pin 10	Not used	

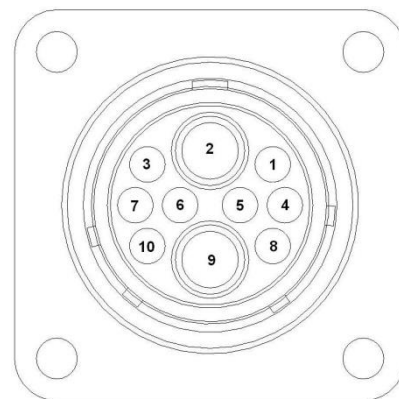

B. Main power connector mounted on PIP

Pin 1	Red	+ 12 V input from tractor supply
Pin 2	Black	Ground from tractor supply
Pin 3	Orange	Keyed power

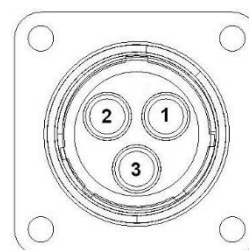

C. Pump connection colors

Pin 1	Black with orange markings	Pump 1 ground
Pin 2	Black with green markings	Pump 2 ground
Pin 3	Black with yellow markings	Pump 3 ground
Pin 4	Not used	
Pin 5	Orange with black markings	Pump 1 positive
Pin 6	Green with black markings	Pump 2 positive
Pin 7	Yellow with black markings	Pump 3 positive

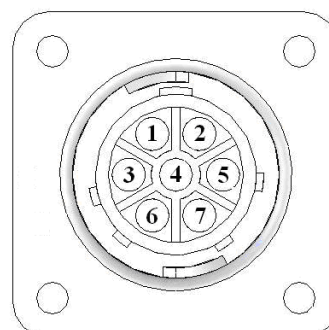

D. Flow meter connection on Pump Controller

Pin 1	White	5 - 12 V (+) supply
Pin 2	Green	Ground
Pin 3	Brown	Signal
Pin 4	Black	Shield

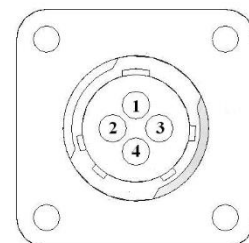

E. Connector for Hay Indicator option on PIP

Note: Hay indicators are an option that will turn the system on and off automatically as hay enters the pickup of the baler.

Pin 1	Red	+12V
Pin 2	Black	Ground
Pin 3	White	Signal wire
Pin 4	Not used	

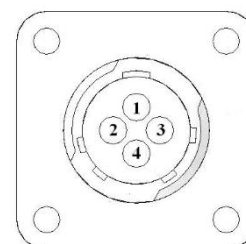

F. End of bale sensor on PIP

Pin1	Brown	Sensor power
Pin2	Blue	Sensor ground
Pin3	Not used	
Pin4	Black	Signal from sensor

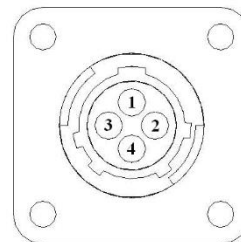

G. Star wheel and Bale rate sensor connector on PIP

Pin 1	Blue	12 volt power
Pin 2	Orange	Ground
Pin 3	Black	Signal for sensor 1
Pin 4	White	Signal for sensor 2
Pin 5	Not used	
Pin 6	Not used	
Pin 7	Not used	
Pin 8	Violet	Star wheel input 1
Pin 9	Brown	Star wheel input 2

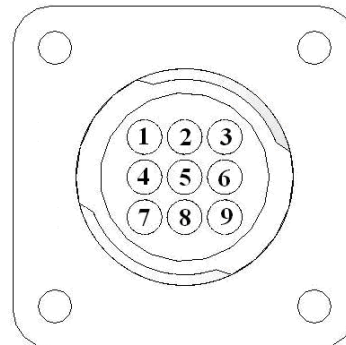

H. Display communication harness on PIP

Pin 1	Orange	Power to display
Pin 2	Blue	Ground to display
Pin 3	Green	Comm channel OH
Pin 4	Silver	Shield
Pin 5	Yellow	Comm channel OL
Pin 6	Not used	
Pin 7	Not used	

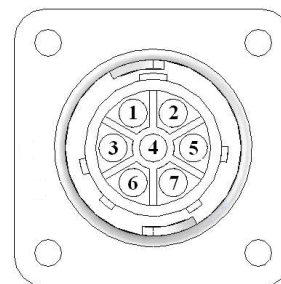

I. Communication harness on PIP and Pump Controller

Pin 1	Red	Can 12 volt
Pin 2	Red	Battery 12 volt
Pin 3	Grey	Shield
Pin 4	Green	Comm channel OH
Pin 5	Yellow	Comm channel OL
Pin 6	Blue	Comm channel IH
Pin 7	Orange	Comm channel IL
Pin 8	Black	Can ground
Pin 9	Black	Battery ground
Pin 10	Not used	

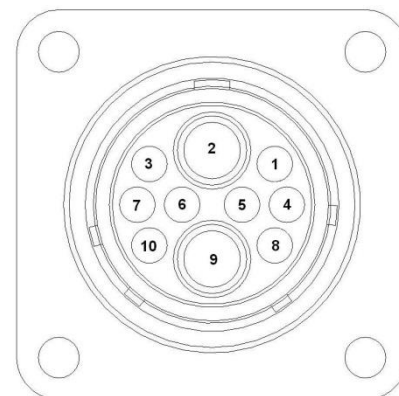

Parts Breakdown

Tank, Saddle & Saddle Legs Parts Breakdown

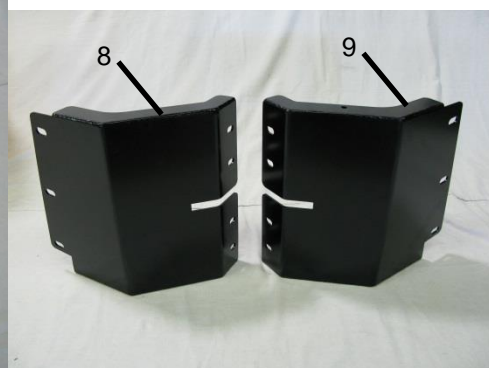

<u>Ref</u>	<u>Description</u>	<u>Part#</u>	<u>Qty</u>	<u>Ref</u>	<u>Description</u>	<u>Part#</u>	<u>Qty</u>
1	Tank	005-9218	1	9	Right saddle leg	001-6707MR	1
2	1/2" tank fitting	005-9104	2	10	1/2" hose	002-9001	2
3	Elbow	003-EL1212	2	NP	Elbow	003-EL3434	1
4	Tank straps	001-6707P	2	NP	Elbow	003-EL3412	1
5	Tank saddle	001-6707N	1	NP	3/4" tank fitting	005-9100	2
6	Handrail	001-6707HR	1		Optional:		
7	Tank lid	005-9022H	1				
8	Left saddle leg	001-6707ML	1	NP	Tank lid strainer	005-9022HBS	1

Parts Breakdown for Pump Manifold

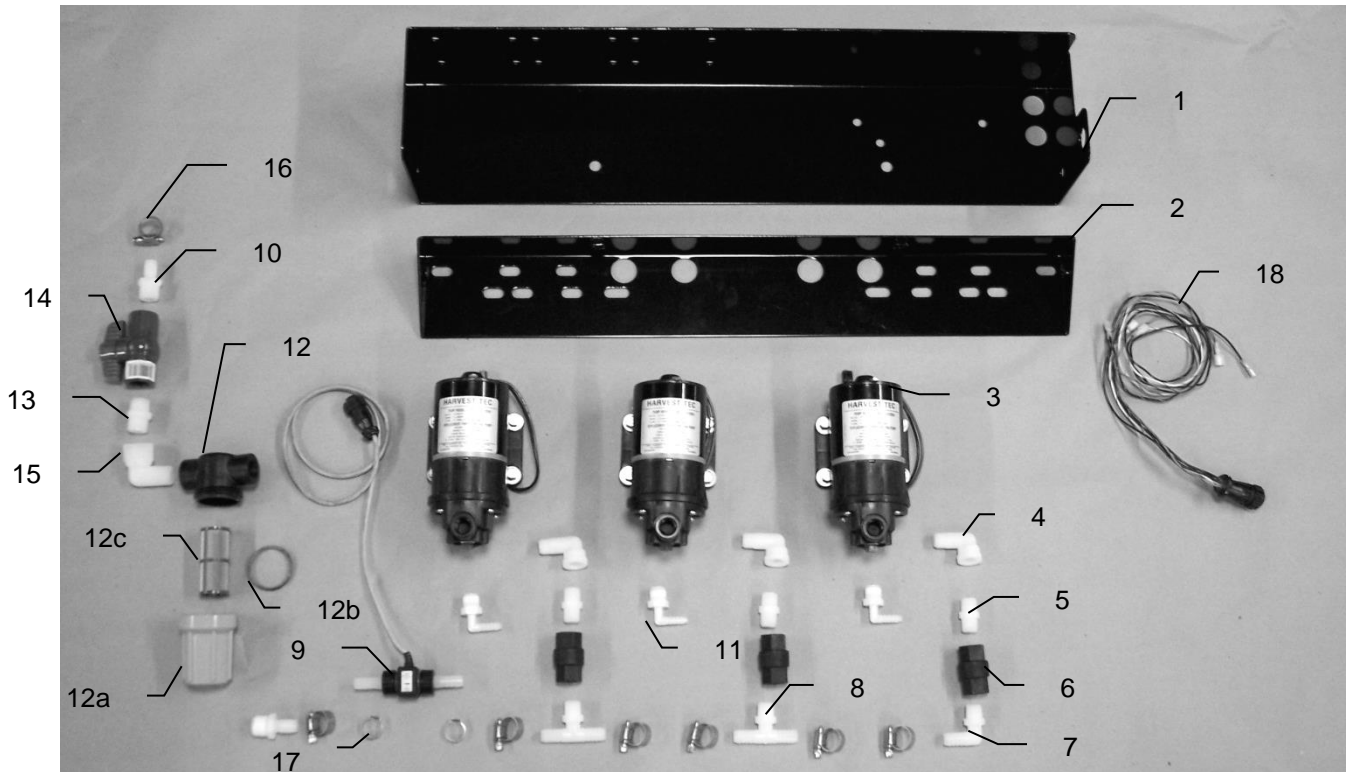

<u>Ref#</u>	<u>Description</u>	<u>Part#</u>	<u>Qty</u>
1	Pump plate	001-4646D	1
2	Mounting Bracket	001-4646C	1
3	Pump	007-4120H	3
4	Street elbow fitting	003-SE38	3
5	Nipple fitting	003-M3838	3
6	Check valve	002-4566F	3
7	Elbow fitting	003-EL3812	1
8	Tee fitting	003-T3812HB	2
9	Flow meter assembly	006-4725A	1
10	Straight fitting	003-A1212	2
11	Jaco fitting	003-JEL1238	3
12	Filter bowl assembly	002-4315	1
12a	Filter bowl only	002-4315F	1
12b	Filter bowl gasket	002-4315D	1
12c	Filter bowl screen	002-4315B	1
13	Nipple fitting	003-M1212	1
14	Ball valve	002-2212	1
15	Street elbow fitting	003-SE12	1
16	Hose clamp	003-9003	7
17	Hose clamp (Flow Meter)	003-9005	2
18	Pump Cable	006-4660Z	1
NP	Elbow	003-EL1212	1
NP	Pump rebuild kit (1 per pump)	007-4581	1
NP	Not Pictured		

Parts Breakdown for Star Wheel Moisture Sensor

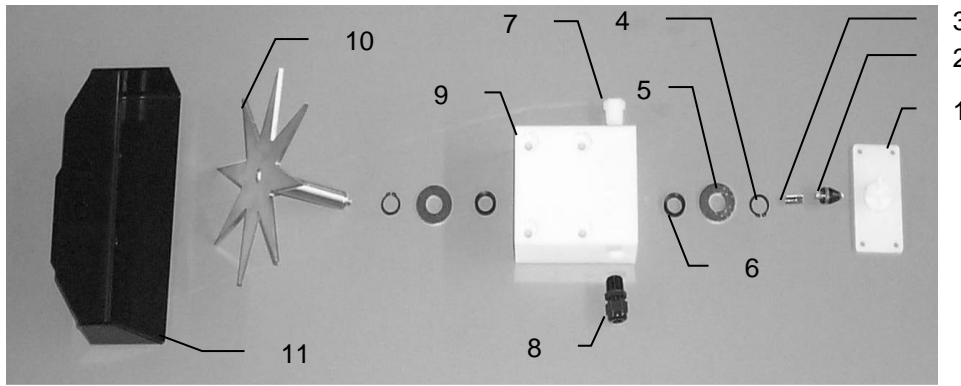

<u>Ref</u>	<u>Description</u>	<u>Part#</u>	<u>Qty</u>	<u>Ref</u>	<u>Description</u>	<u>Part#</u>	<u>Qty</u>
1.	Block cover	006-4641B	2	9.	Star wheel block	006-4641A	2
2.	Electronic swivel	006-4642A	2	10.	Star wheel sensor	030-4641C	2
3.	Swivel insert	w/ Ref # 10	2	11.	Twine guard-left	001-4645	1
4.	Snap ring (per side)	006-4641K	2		Twine guard-right (prox)	001-4644	1
5.	Washer (per side)	w/006-4641K	2				
6.	Dust seal (per side)	w/006-4641K	2				
7.	Plug fitting	003-F38	2	1-10	Star wheel assembly	030-4641	2
8.	Wiring grommet	008-0821A	2				

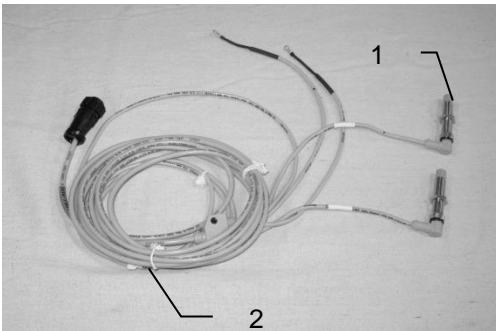

<u>Ref</u>	<u>Description</u>	<u>Part#</u>	<u>Qty</u>
1	Bale rate sensor	006-7303S	2
2	Moisture and bale rate harness	006-7303HL	1

Parts Breakdown for Control Boxes and Wiring Harnesses

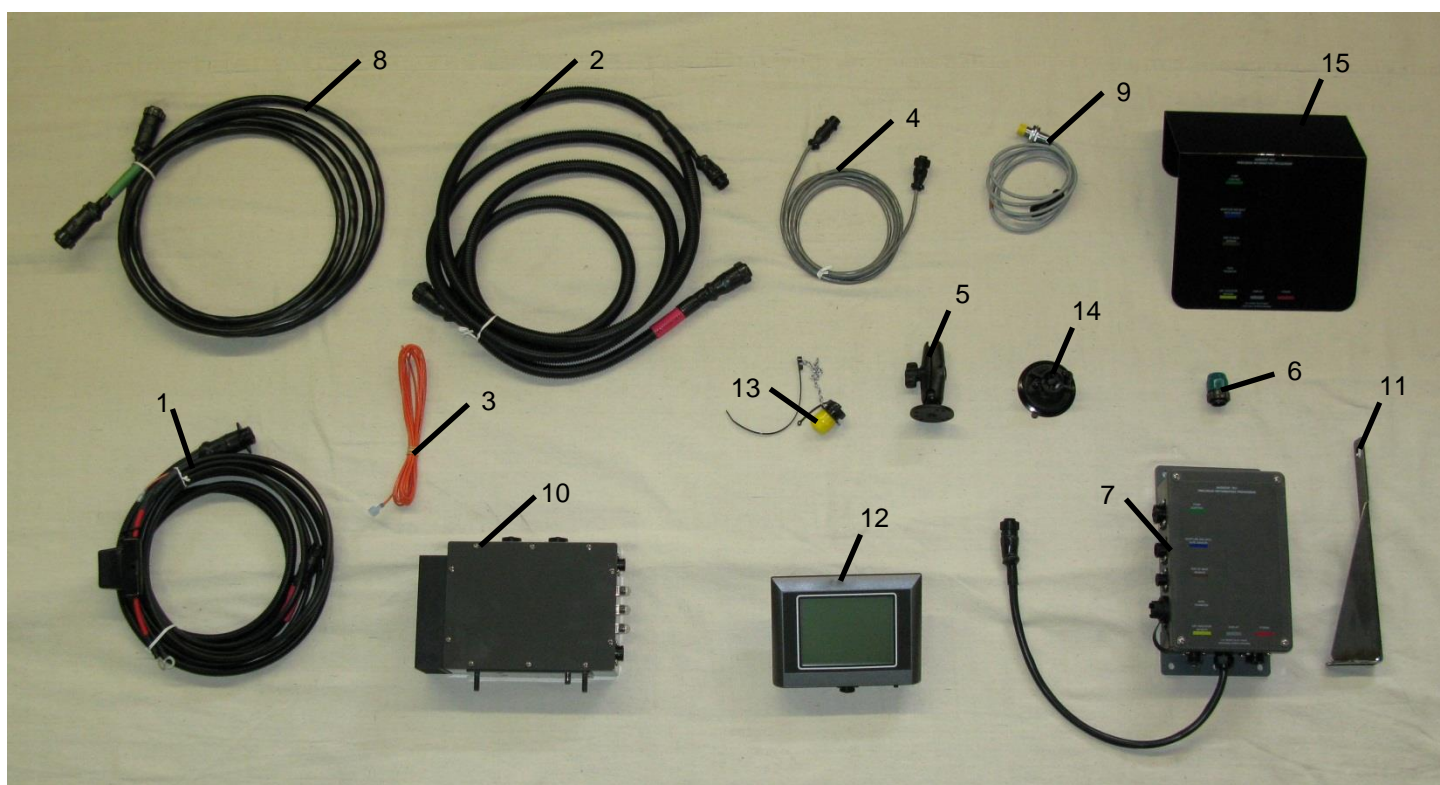

<u>Ref</u>	<u>Description</u>	<u>Part#</u>	<u>Qty</u>
1	Power and comm. tractor	006-5650TM	1
2	Power and comm. baler	006-5650LSM	1
3	Keyed power lead	006-5650K	1
4	End of bale extension	004-7400BBEXT	1
5	Ram mount	001-2012H	1
6	Terminating resistor	006-5650Z	1
7	Precision information processor	006-5671LS2	1
8	Pump controller harness	006-5650F3M	1
9	End of bale sensor	006-7400	1
10	Pump controller	006-5672	1
11	End of bale sensor bracket	001-4648	1
12	Display	006-5670	1
13	Dust plug kit	006-5651PLUGS	1
14	Suction cup mount	001-2012SCM	1
15	PIP shield	001-5650X	

Parts Breakdown for Hose and Drain Fill Line

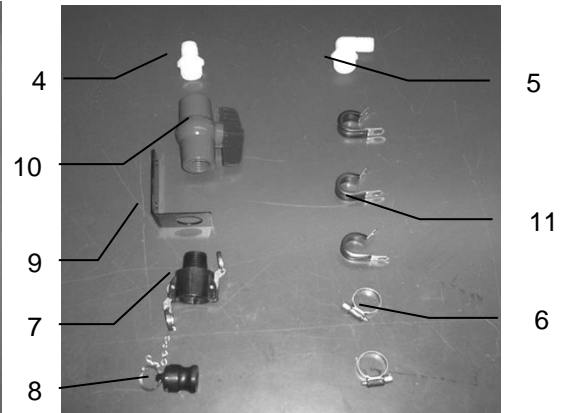
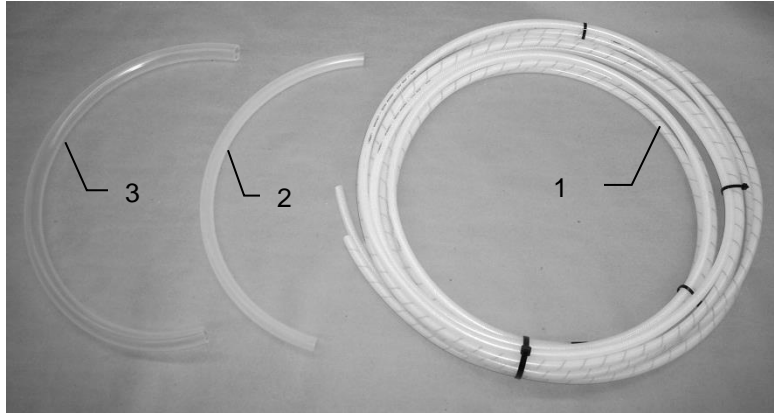

<u>Ref</u>	<u>Description</u>	<u>Part#</u>	<u>Qty</u>	<u>Ref</u>	<u>Description</u>	<u>Part#</u>	<u>Qty</u>
1	Triple weld hose (from pumps to tips)	002-9016	25ft	7	Female Coupler	002-2204A	1
		002-9016B	25ft				
		002-9016G	25ft				
	Three hose assembly	030-9016LS	1				
2	1/2" Hose (tank to filter)	002-9001	6ft	8	Male Coupler	002-2205G	1
3	3/4" Hose (tank to drain/fill valve)	002-9002	10ft	9	Valve Holder	001-6702H	1
4	Straight Fitting	003-A3434	1	10	Ball valve	002-2200	1
5	Elbow	003-EL3434	1	11	Jiffy Clip	008-9010	3
6	Hose Clamps	003-9004	2				

Harvest Tec Model 4533B Installation Kit

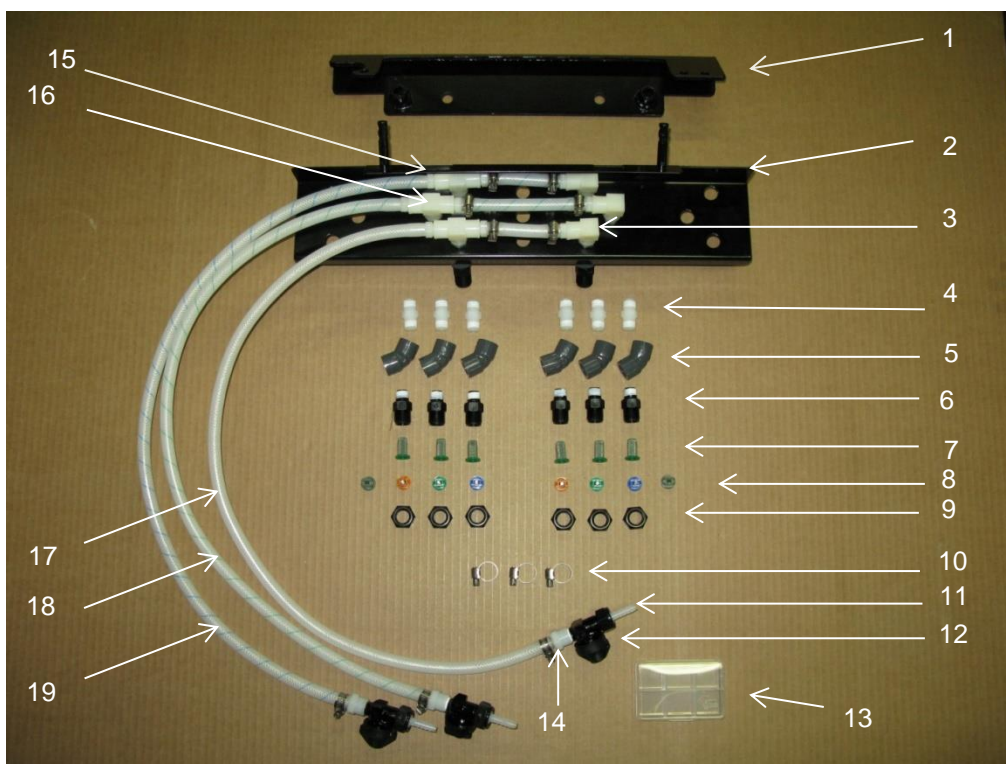

<u>Ref</u>	<u>Description</u>	<u>Part #</u>	<u>Qty</u>	<u>Ref</u>	<u>Description</u>	<u>Part #</u>	<u>Qty</u>
1	Holder	001-4435NC	1	11	Fitting	003-A1414VB	3
2	Shield	001-4435NS	1	12	Check Valve	004-1207VB	3
3	Fitting	003-SE14F	1	13	Plastic Box	008-9000	1
4	Fitting	003-M1414	6	14	Fitting	003-A1414F	3
5	Fitting	003-SE4514F	6	15	Fitting	003-A1414	3
6	Fitting	004-4722	6	16	Tee	003-TT14SQ	3
7	Strainer	004-1203-100	6	17	Clear White Hose	002-9016	3 ft
8	Tips:		1	18	Green Stripe Hose	002-9016G	3 ft
	Tip-Orange	004-XR8001VS	2	19	Blue Stripe Hose	002-9016B	3 ft
	Tip-Green	004-XR80015VS	2	NP	Lynch Pins	008-4576	2
	Tip-Blue	004-XR8003VS	2				
	Tip-Olive	004-800067PT	2				
9	Cap	004-4723	9				
10	Hose Clamps	003-9002	15				

Harvest Tec Model 4534B Installation Kit

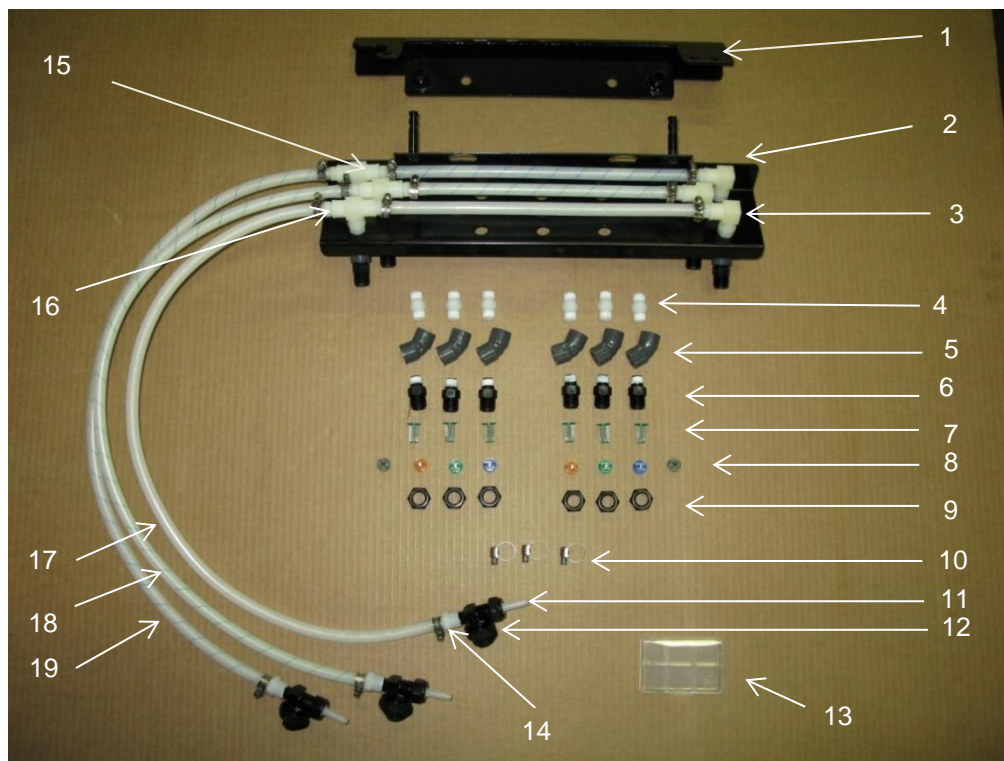

Ref	Description	Part #	Qty	Ref	Description	Part #	Qty
1	Holder	001-4435NC	1	11	Fitting	003-A1414VB	3
2	Shield	001-4435NS	1	12	Check valve	004-1207VB	3
3	Fitting	003-SE14F	1	13	Plastic Box	008-9000	1
4	Fitting	003-M1414	6	14	Fitting	003-A1414F	3
5	Fitting	003-SE4514F	6	15	Tee	003-TT14SQ	3
6	Fitting	004-4722	6	16	Fitting	003-A1414	3
7	Strainer	004-1203-100	6	17	Clear White Hose	002-9016	3.5 ft
8	Tips:			18	Green Stripe Hose	002-9016G	3.5 ft
	Tip-Orange	004-XR8001VS	2	19	Blue Stripe Hose	002-9016B	3.5 ft
	Tip-Green	004-XR80015VS	2	NP	Lynch Pins	008-4576	2
	Tip-Blue	004-XR8003VS	2				
	Tip-Olive	004-800067PT	2				
9	Cap	004-4723	9				
10	Hose Clamps	003-9002	15				

Harvest Tec Model 4535B Installation Kit

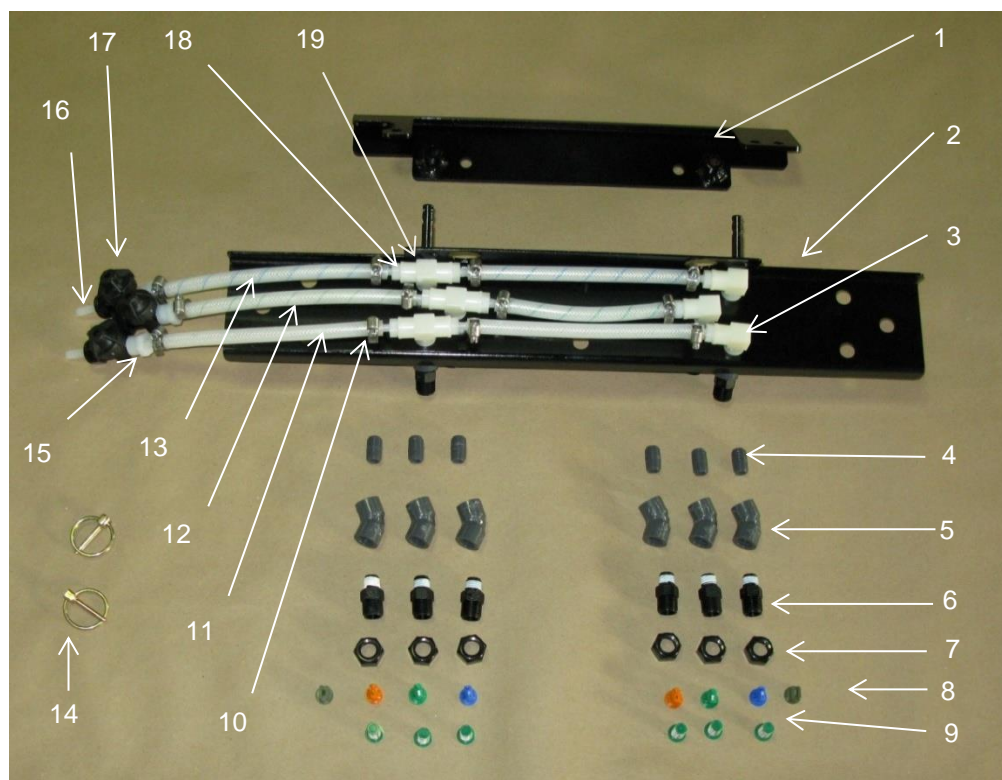

<u>Ref</u>	<u>Description</u>	<u>Part #</u>	<u>Qty</u>	<u>Ref</u>	<u>Description</u>	<u>Part #</u>	<u>Qty</u>
1	Holder	001-4435NC	1	9	Strainer	004-1203-100	6
2	Shield	001-4435N	1	10	Hose Clamps	003-9002	15
3	Elbow	003-SE14F	1	11	Clear White Hose	002-9016	3 ft
4	Fitting	003-M1414	6	12	Green Stripe Hose	002-9016G	3 ft
5	Fitting	003-SE4514F	6	13	Blue Strip Hose	002-9016B	3 ft
6	Fitting	004-4722	6	14	Lynch Pins	008-4576	2
7	Cap	004-4723	9	15	Fitting	003-A1414F	3
8	Tips:			16	Fitting	003-A1414VB	3
	Tip-Orange	004-TT11001VP	2	17	Check Valve	004-1207VB	3
	Tip-Green	004-TT110015VP	2	18	Tee	003-TT14SQ	3
	Tip-Blue	004-TT11003VP	2	19	Fitting	003-A1414	9
	Tip-Olive	004-800067PT	2				

Harvest Tec Model 4536B Installation Kit

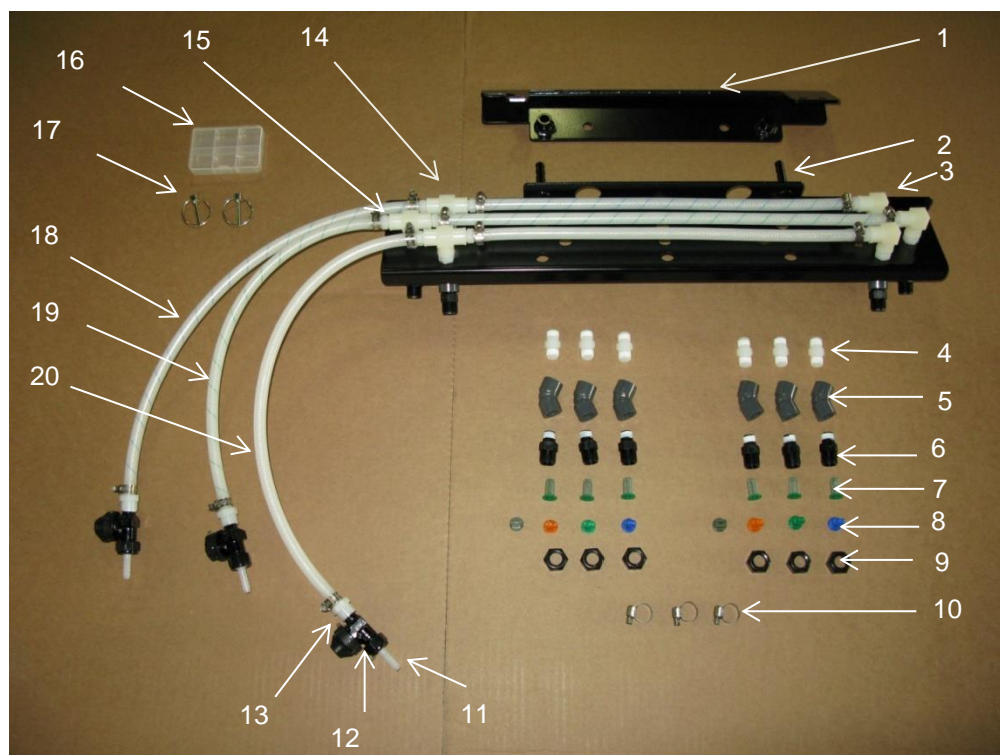

<u>Ref</u>	<u>Description</u>	<u>Part #</u>	<u>Qty</u>	<u>Ref</u>	<u>Description</u>	<u>Part #</u>	<u>Qty</u>
1	Holder	001-4435NC	1	9	Cap	004-4723	6
2	Shield	001-4435N	1	10	Hose Clamps	003-9002	15
3	Elbow	003-SE14F	3	11	Fitting	003-A1414VB	3
4	Fitting	003-M1414	6	12	Check Valve	004-1207VB	3
5	Fitting	003-SE4514F	6	13	Fitting	003-A1414F	3
6	Fitting	004-4722	6	14	Tee	003-TT14SQ	3
7	Strainer	004-1203-100	6	15	Fitting	003-A1414	9
8	Tips:			16	Plastic Box	008-9001	1
	Tip-Orange	004-TT11001VP	2	17	Lynch Pins	008-4576	2
	Tip-Green	004-TT110015VP	2	18	Blue Stripe Hose	002-9016B	3.5ft
	Tip-Blue	004-TT11003VP	2	19	Green Stripe Hose	002-9016G	3.5ft
	Tip-Olive	004-800067PT	2	20	Clear White Hose	002-9016	3.5ft

Harvest Tec, LLC. Warranty and Liability Agreement

Harvest Tec, LLC. will repair or replace components that are found to be defective within 12 months from the date of manufacture. Under no circumstances does this warranty cover any components which in the opinion of Harvest Tec, LLC. have been subjected to negligent use, misuse, alteration, accident, or if repairs have been made with parts other than those manufactured and obtainable from Harvest Tec, LLC.

Our obligation under this warranty is limited to repairing or replacing free of charge to the original purchaser any part that in our judgment shows evidence of defective or improper workmanship, provided the part is returned to Harvest Tec, LLC. within 30 days of the failure. Parts must be returned through the selling dealer and distributor, transportation charges prepaid.

This warranty shall not be interpreted to render Harvest Tec, LLC. liable for injury or damages of any kind, direct, consequential, or contingent, to persons or property. Furthermore, this warranty does not extend to loss of crop, losses caused by delays or any expense prospective profits or for any other reason. Harvest Tec, LLC. shall not be liable for any recovery greater in amount than the cost or repair of defects in workmanship.

There are no warranties, either expressed or implied, of merchantability or fitness for particular purpose intended or fitness for any other reason.

This warranty cannot guarantee that existing conditions beyond the control of Harvest Tec, LLC. will not affect our ability to obtain materials or manufacture necessary replacement parts.

Harvest Tec, LLC. reserves the right to make design changes, improve design, or change specifications, at any time without any contingent obligation to purchasers of machines and parts previously sold.

Revised 5/22

HARVEST TEC, LLC.
P.O. BOX 63
2821 HARVEY STREET
HUDSON, WI 54016
PHONE: 715-386-9100
1-800-635-7468
FAX: 715-381-1792
Email: info@harvesttec.com