

4500A INSTALLATION KIT

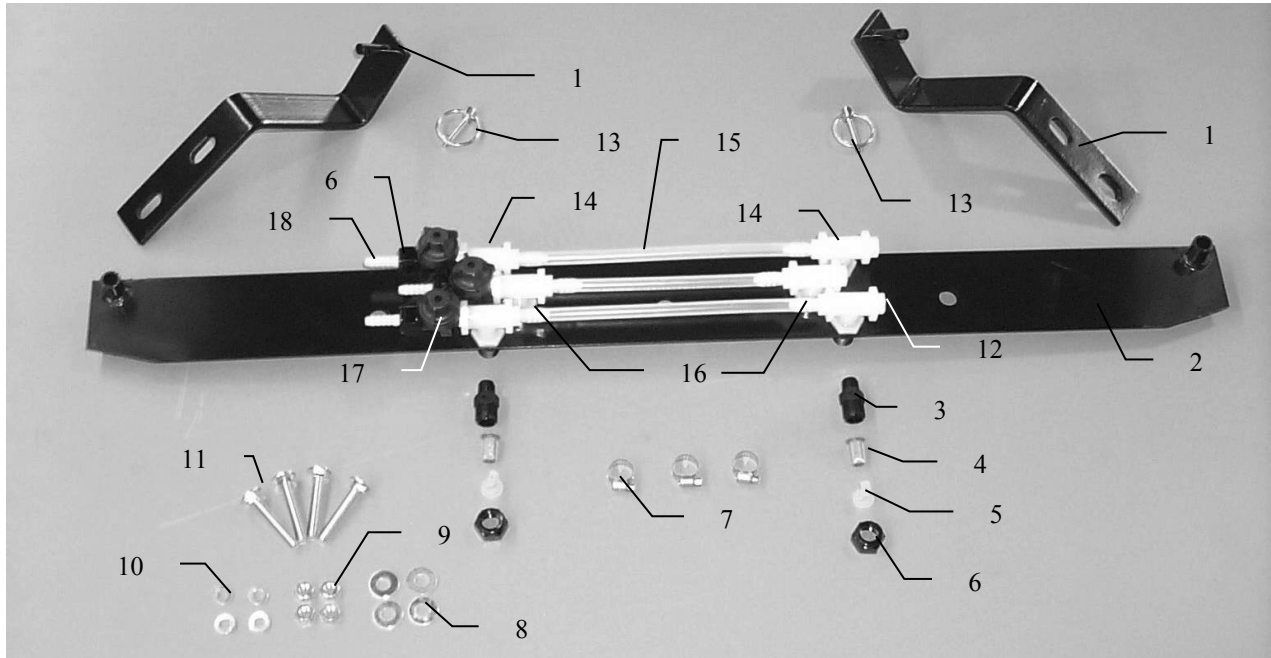

<u>Ref</u>	<u>Description</u>	<u>Part#</u>
1.	Spray shield holder	001-4811B
2.	Spray shield	001-4811A
3.	Nozzle body	004-4722
4.	Tip screen	004-1203-100
5.	Tip	004-TT11001VP
	Tip	004-TT11002VP
	Tip	004-TT110015VP
6.	Nozzle and hose barb cap	004-4723
7.	Mini hose clamp	003-9002
8.	Washer-3/8"	
9.	Nut-3/8"	
10.	Lock washer-3/8"	
11.	Bolts-3/8"x11/4"	
12.	Plug	003-F14
13.	Lynch pin	008-4576
14.	Tee	003-TT14
15.	Hose-1/4"	002-9006
16.	Hose barb fitting	003-A1414
17.	Check valve assembly	004-1207VB
18.	Hose barb fitting	004-A1414VB
19NP.	Spacer plate	001-6702S
NP	Not pictured	