

## Optional Android Display Kit (030-1670DK)

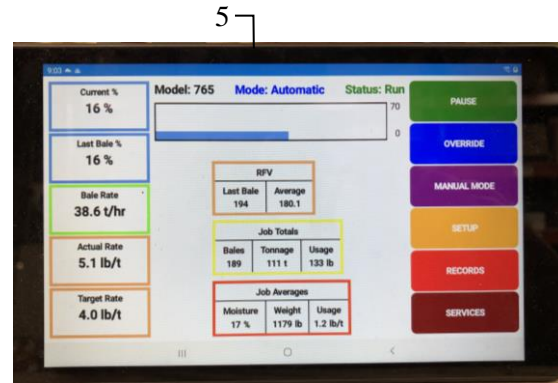
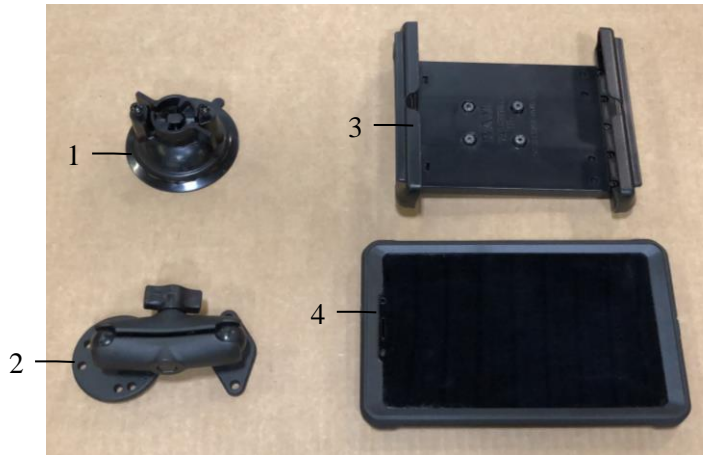

<u>Ref</u>	<u>Description</u>	<u>Part #</u>	<u>Qty</u>
1	Suction Cup Mount	001-2012SCM	1
2	Ram Mount	001-2012H	1
3	Spring Load Cradle	001-2012SLC	1
4	Android Case	001-2012A1	1
5	Android Tablet	006-1670AT	1

### Installation Instructions

1. Assemble Cradle (001-2012SLC)
2. Attach round base from ram mount to cradle
3. Attach trapezoid end of ram mount to suction mount
4. Clean glass or metal surface that unit will be attaching to.
5. Add a small amount of water to suction cups rubber surface and attach to surface
6. Turn lock on suction cup mount to secure.
7. Place tablet in cradle and hook USB cable that came with system into it.
8. Run USB cable over to (006-765ICM) control module and plug into USB port that show's a tablet