

Control Box and Wiring Harnesses

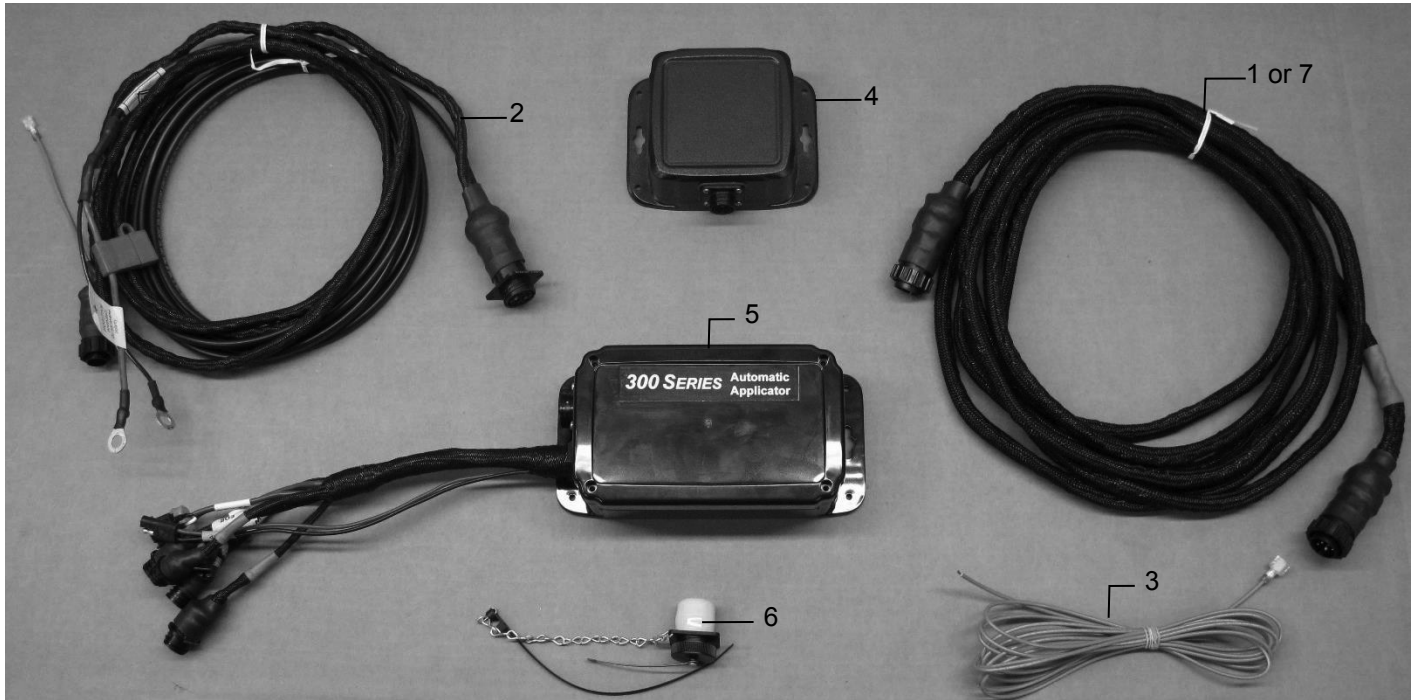

<u>Ref</u>	<u>Description</u>	<u>Part#</u>	<u>Qty</u>	<u>Ref</u>	<u>Description</u>	<u>Part#</u>	<u>Qty</u>
1	Power lead baler 20'	006-3650B1	1	5	300 Series Controller	006-3671SS	1
2	Power lead tractor	006-3650T	1	6	Dust Plugs	006-5651Plugs	1
3	Key Switch Wire	006-5650K	1	7	Power lead baler 30' (AGCO)	006-3650B2	1
4	Bluetooth Receiver	006-6672A	1		Complete Assembly (1-6)	030-362CPA	
					Complete Assembly (2-7)	030-362CPB	

End of Bale Sensor Kit A

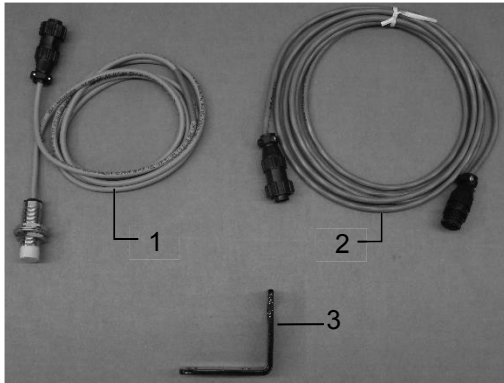

<u>Ref</u>	<u>Description</u>	<u>Part #</u>	<u>Qty</u>
1	End of Bale Sensor	006-7400	1
2	EOB Extension	006-7400EXT	1
3	End of Bale Bracket	001-4648SS	1
	Complete Assembly	EOB-SS-A	

End of Bale Sensor Kit B

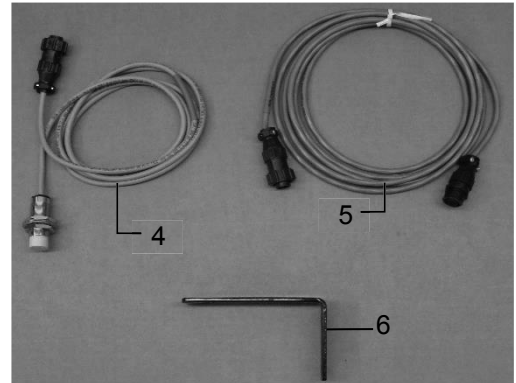

<u>Ref</u>	<u>Description</u>	<u>Part #</u>	<u>Qty</u>
4	End of Bale Sensor	006-7400	1
5	EOB Extension	006-7400EXT	1
6	End of Bale Bracket	001-4648SI	1
	Complete Assembly	EOB-SS-B	

Star Wheel Sensors

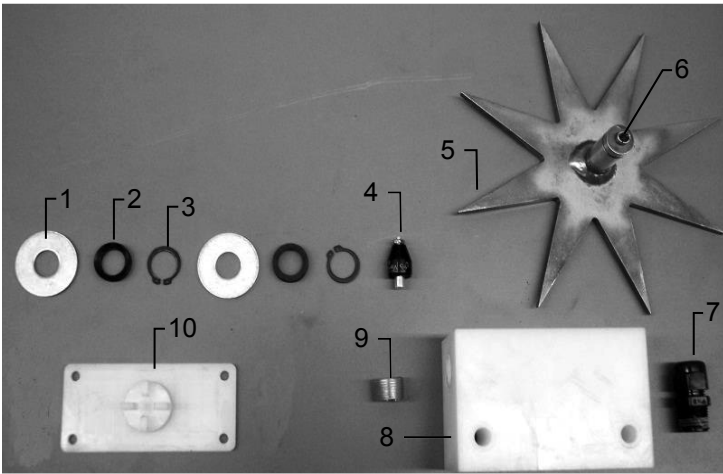

<u>Ref</u>	<u>Description</u>	<u>Part#</u>	<u>Qty</u>
1	Washer (per side)	006-4642K	2
2	Dust Seal (per side)	w/006-4642K	1
3	Snap Ring (per side)	w/006-4642K	2
4	Swivel	006-4642A	2
5	Star Wheel	030-4641E	2
6	Insert	w/ Ref # 5	2
7	Wiring grommet	008-0821A	2
8	Star wheel block	006-4641A	2
9	Plug Fitting	003-F38	2
10	Block Cover	006-4641B	2
1-10	Star wheel assembly	030-4642	2

Moisture Harness



<u>Ref</u>	<u>Description</u>	<u>Part #</u>	<u>Qty</u>
NP	Moisture Harness (10')	006-4640D2	1
NP	Moisture Harness (15')	006-4640K2	1