

# Parts Breakdown Model Specific Installation Kits

## Harvest Tec Model 442C Installation Kit

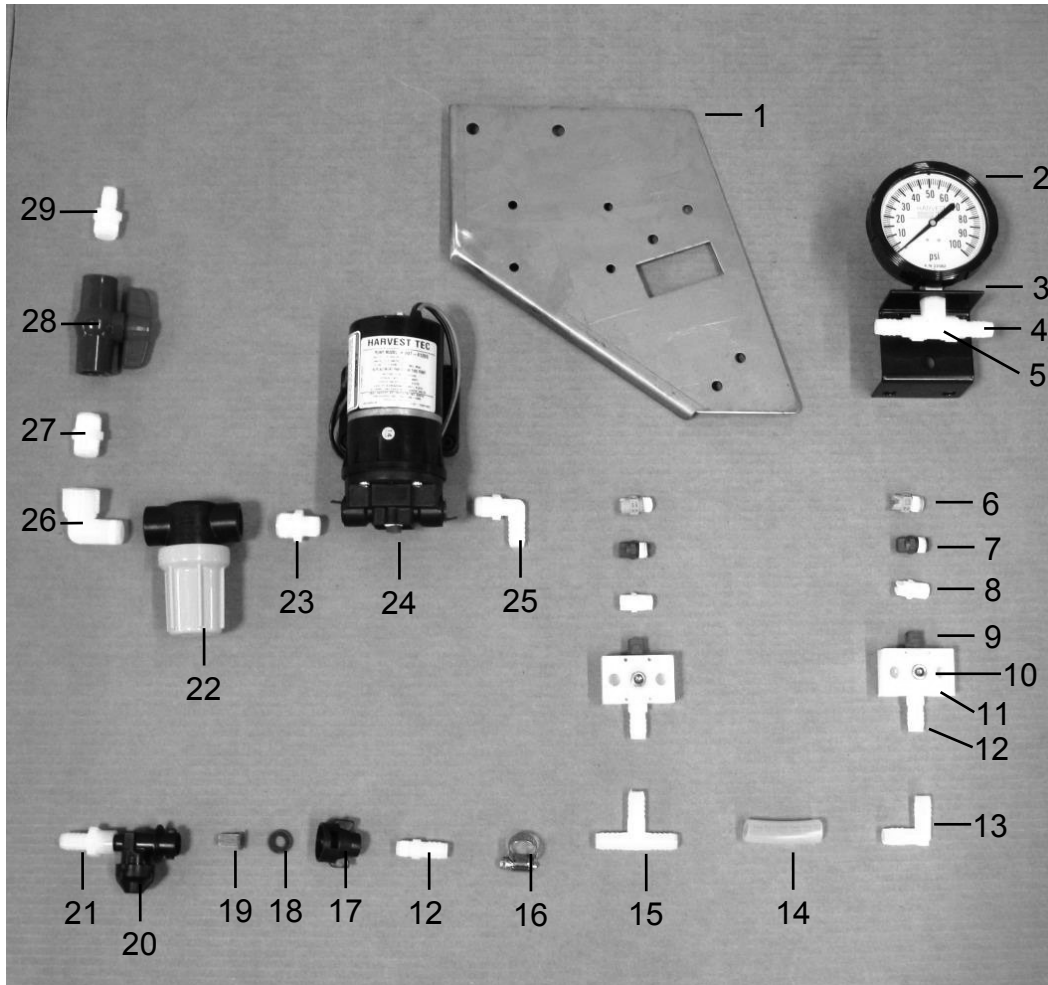

<u>Ref #</u>	<u>Description</u>	<u>Part #</u>	<u>Qty</u>	<u>Ref #</u>	<u>Description</u>	<u>Part #</u>	<u>Qty</u>
1	Valve Mount	001-4703XE	1	17	Female Disconnect 1/4"	004-1207H	1
2	Gauge-4"	002-2208Z	1	18	Washer	004-1207W	1
3	Gauge Holder	001-4717	1	19	Tip Strainer	004-1203-100	1
4	Fitting 1/4" x 1/2"	003-EL1412	2	20	Diaphragm Check Valve	004-1207V	1
5	Tee 1/4"	003-TT14	1	21	Fitting	003-A1412F	1
6	Tip-Pink	004-T8001-PT	2	22	Filter Bowl Assembly	002-4315	1
7	Tip-Brown	004-T80015-PT	2	23	Nipple	003-M1238	1
8	Tip-Yellow	004-T8005-PT	2	24	Pump 12V	007-4120SE	1
9	Tip-Red	004-T8003-PT	2	25	Elbow	003-EL3812	1
10	Plug Allen	003-F14A	2	26	Elbow	003-SE12	1
11	Manifold Block	001-4435NSB	2	27	Fitting	003-M1212	1
12	Fitting 1/4" x 1/2"	003-A1412	2	28	Ball Valve	002-2212	1
13	1/2" HB Elbow	003-EL12	1	29	Fitting	003-A1212	1
14	EVA Tubing 1/2"	002-9002	26ft	NP	Spray Block Holder	001-4703XD	2
15	Barb Tee 1/2"	003-T1212	1				
16	Hose Clamps	003-9003	14		Shield Only Assembly	030-0442C-SO	
						(Includes Ref # 6-21, NP)	