

# Parts Breakdown- Cross Tube Assembly & PTO Shaft and Hydraulic Ram

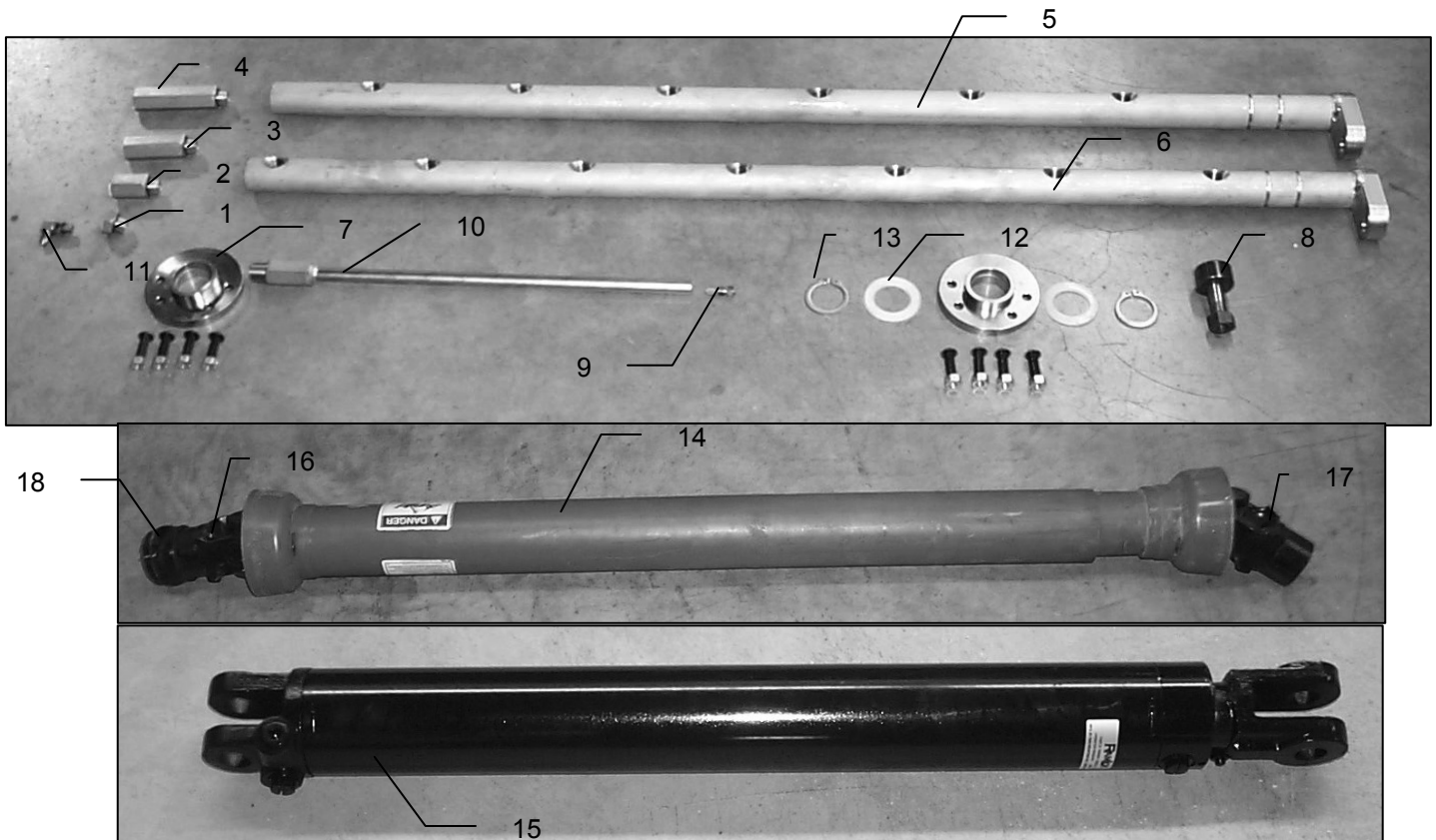

<u>Ref #</u>	<u>Description</u>	<u>Part #</u>	<u>Qty</u>
1	Brass standoff 3/8"	001-7105A	4
2	Brass standoff 1 1/2"	001-7105B	6
3	Brass standoff 2 5/8"	001-7105C	6
4	Brass standoff 3 3/4"	001-7105D	4
5	Six tine cross tube	001-7106	5
6	Seven tine cross tube	001-7107	5
7	Cross tube bearing insert	001-7143B	40
7	Cross tube bearing holder left	001-7143AL	20
7	Cross tube bearing holder right	001-7143AR	20
8	Cam bearing 1-1/2"	008-7121	10
9	Tip for tine	004-7123	65
10	Tines	001-7102	65
11	1/4" high pressure elbow	003-DSL1414EL	30
12	Plastic bearing	008-4527	22
13	1 1/2" snap ring roto clip	008-4577	20
14	PTO shaft	008-7126	1
15	Hydraulic ram	008-7132	1
16	PTO cross bearing	008-7126CB	1
17	PTO machine yoke	008-7126MY	1
18	PTO tractor yoke	008-7126TY	1
NP	1 1/2" hydraulic swivel elbow	003-DSEL1212	2