

Star Wheel Sensors

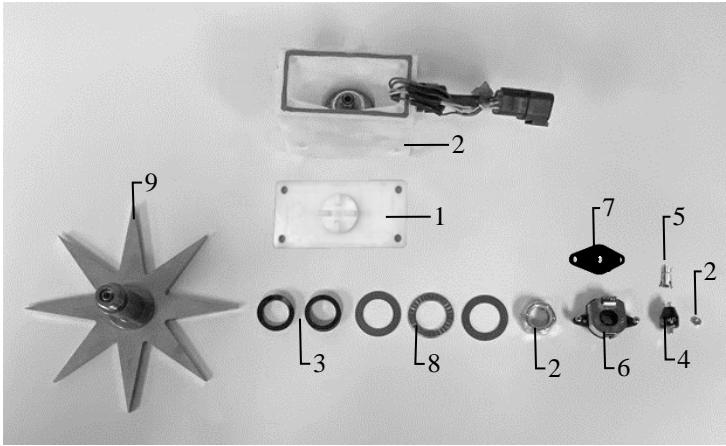

| <u>Ref</u> | <u>Description</u> | <u>Part#</u> | <u>Qty</u> |
|-------------|--------------------------------------|--------------|------------|
| 1 | Block Cover | 006-4642UC | 1 |
| 2 | Star Wheel Block | 006-4642UB | 1 |
| 3 | Star Wheel Gasket | 006-4642UG | 1 |
| 4 | Electric Swivel | 006-4642A | 1 |
| 5 | Swivel Insert | 006-4642B | 1 |
| 6 | Encoder | 006-4512E | 1 |
| 7 | Encoder Mount | 006-4512P | 1 |
| 8 | Washers | 006-4642K | 1 |
| 9 | Star Wheel | 006-4642US | 1 |
| 10 | Encoder Harness (6 pin) | 006-7307EM | 1 |
| NP | Moisture Harness (2-pin) | 006-7307M | 1 |
| 1-10 | Star wheel assembly (w/ Encoder) | 030-4642UE | 1 |
| 1-5 8,9, | Star wheel assembly (w/o Encoder) | 030-4642U | 1 |

Moisture Harness



| <u>Ref</u> | <u>Description</u> | <u>Part #</u> | <u>Qty</u> |
|------------|--------------------|---------------|------------|
| 11 | Moisture Harness | 006-7307EM2 | 1 |